

**FORD F-450 CHASSIS**

**STANDARD OPTIONS:**

- SMOOTH COMPARTMENTS - VENTED w/ DRAIN HOLES
- EXTRUDED DOORS w/ DRIP RAILS
- D/P RUNNING BOARDS / KICK PANEL / STONE GUARDS / REAR BUMPER
- SMOOTH DOOR PANELS
- EBERHARD DOOR HANDLES
- SPLASH GUARDS
- ALUMINUM FENDERETTES
- C-CHANNEL w/ RED / WHITE REFLECTIVE
- CAST GRABBERS
- MUD FLAPS
- POLYFIBER INSULATION

- WOOD CONSOLE w/ ARM RESTS
- SCORPION COAT GRAY
- LAPTOP SLOT IN FRONT
- RC TRONICS SWITCH PANEL
- SPOTLIGHT
- INTERCOM SWITCH w/ CODE LIGHTS
- DIGITAL AMP / VOLT METER
- (2) WHELEN 295HFS2 w/ NCM SIRENS
- (1) 110V OUTLET
- MIRROR MOUNTED CAMERA MONITOR
- UPPER WARNING LIGHTS ON ONE SWITCH
- LOWER WARNING LIGHTS ON ONE SWITCH
- TWO POSITION STAINLESS GLOVE BOX BETWEEN SEATS ON BACK WALL

ION RED MOUNTED ON RANCH HAND

ION RED

KEYLESS ENTRY

SPARE TIRE  
#10 FIRE EXTINGUISHER  
SHIP LOOSE

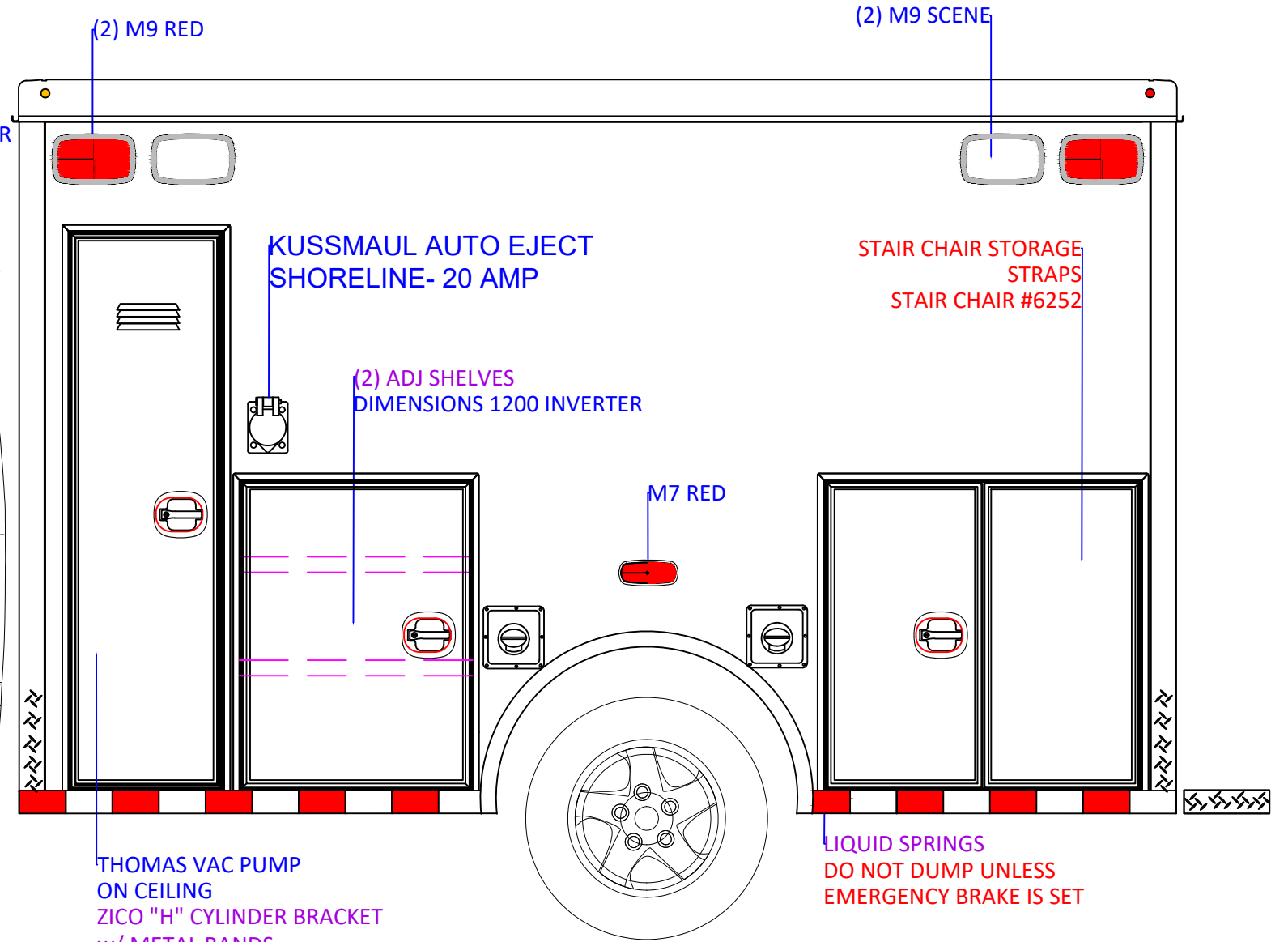

		BULLOCH COUNTY	
		WORK ORDER	
	SIZE <b>B</b>	PART DRIVER EXTERIOR	REVISION
WO#1	SCALE	DRAWN BY	DATE

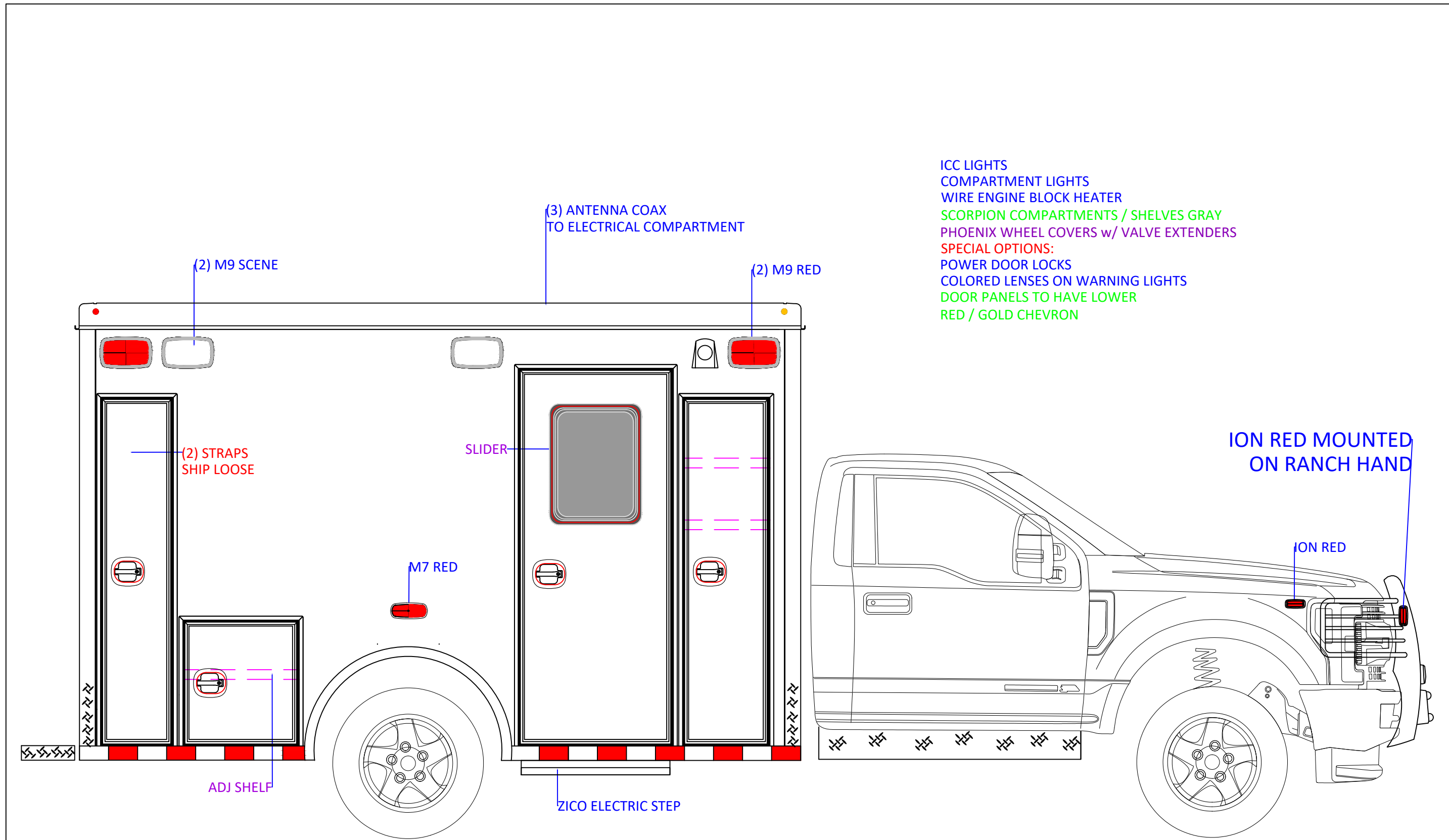

- ICC LIGHTS
- COMPARTMENT LIGHTS
- WIRE ENGINE BLOCK HEATER
- SCORPION COMPARTMENTS / SHELVES GRAY
- PHOENIX WHEEL COVERS w/ VALVE EXTENDERS
- SPECIAL OPTIONS:
- POWER DOOR LOCKS
- COLORED LENSES ON WARNING LIGHTS
- DOOR PANELS TO HAVE LOWER
- RED / GOLD CHEVRON

		BULLOCH COUNTY	
		WORK ORDER	
	SIZE <b>B</b>	PART PASSENGER INTERIOR	REVISION
WO#2	SCALE	DRAWN BY	DATE

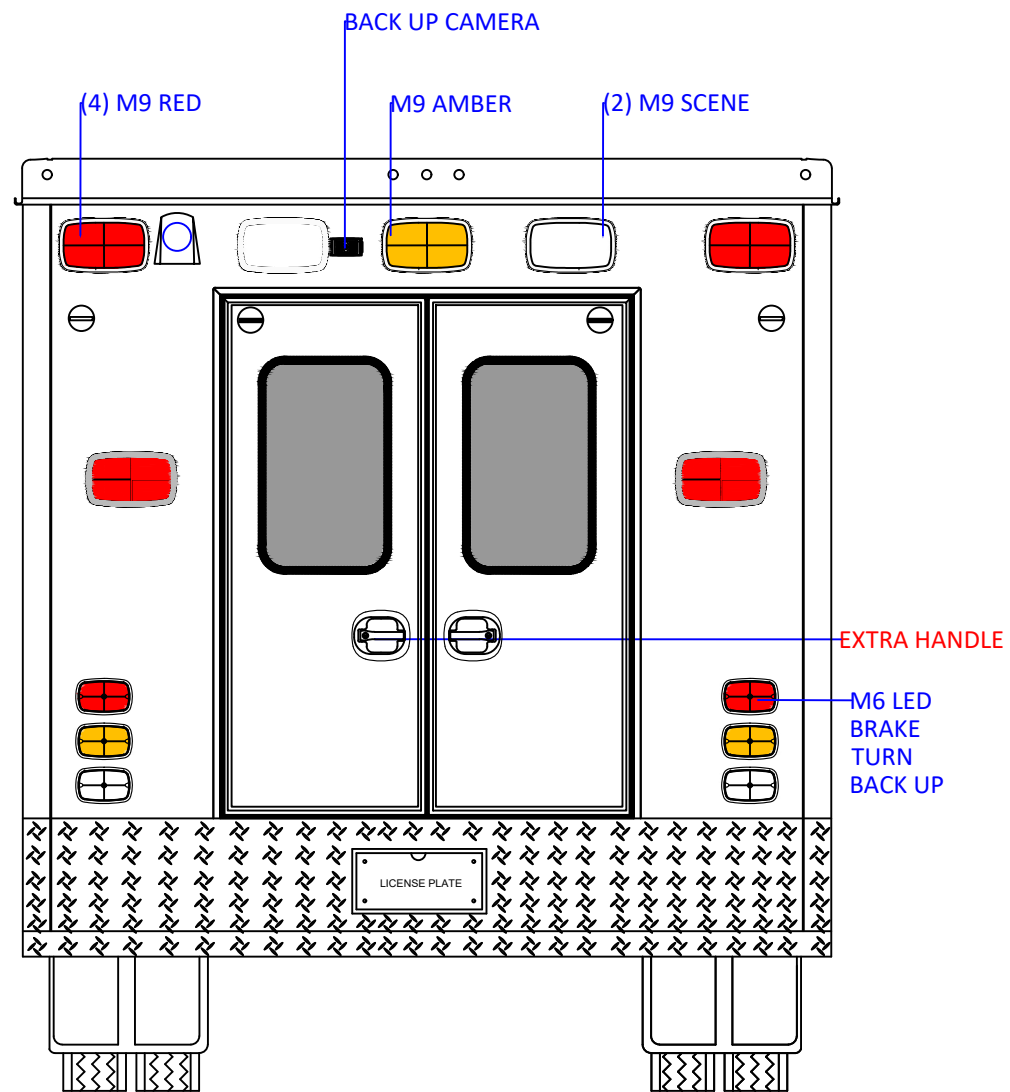
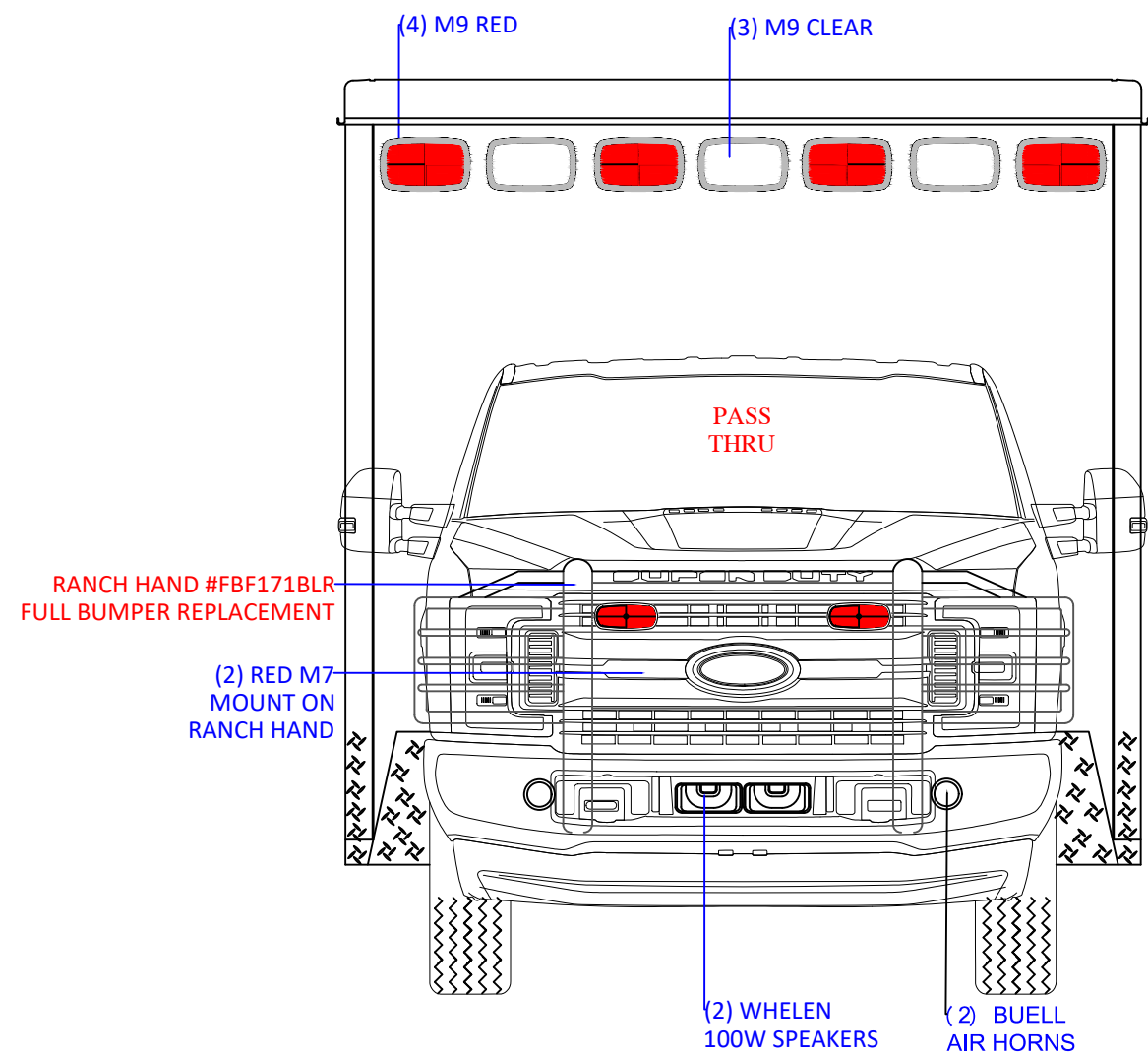

		BULLOCH COUNTY	
		WORK ORDER	
	SIZE <b>B</b>	PART FRONT/ REAR EXTERIOR	REVISION
WO#3	SCALE	DRAWN BY	DATE

CPR SEAT WITH FOLD-DOWN BACK  
NO 6PT HARNESS

IV POLE  
ELECT O2 SOLENOID

RICO SUCTION  
DO NOT MOUNT  
SHIP LOOSE

SWITCH PANEL

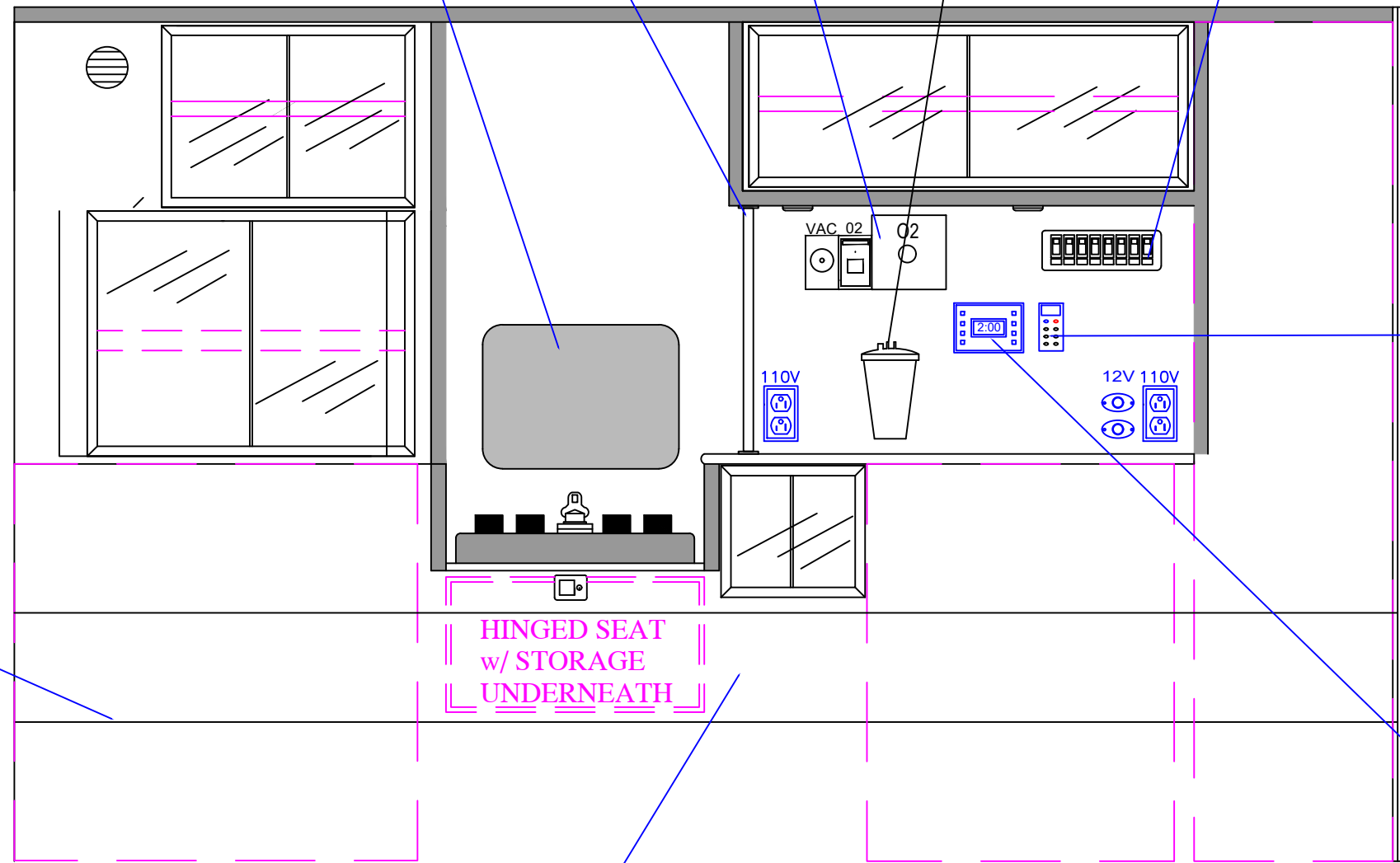

DIGITAL THERMOSTAT

DUAL COT MOUNT

HINGED SEAT  
w/ STORAGE  
UNDERNEATH

INTELLITEC

SS RISER

GLOSSY GRAY / WHITE FORMICA  
GUNMETAL UPHOLSTERY  
LONPLATE FLOORING  
WHITE COUNTERTOPS

		BULLOCH COUNTY	
		WORK ORDER	
	SIZE	PART	REVISION
	<b>B</b>	DRIVER INTERIOR	
WO#4	SCALE	DRAWN BY	DATE

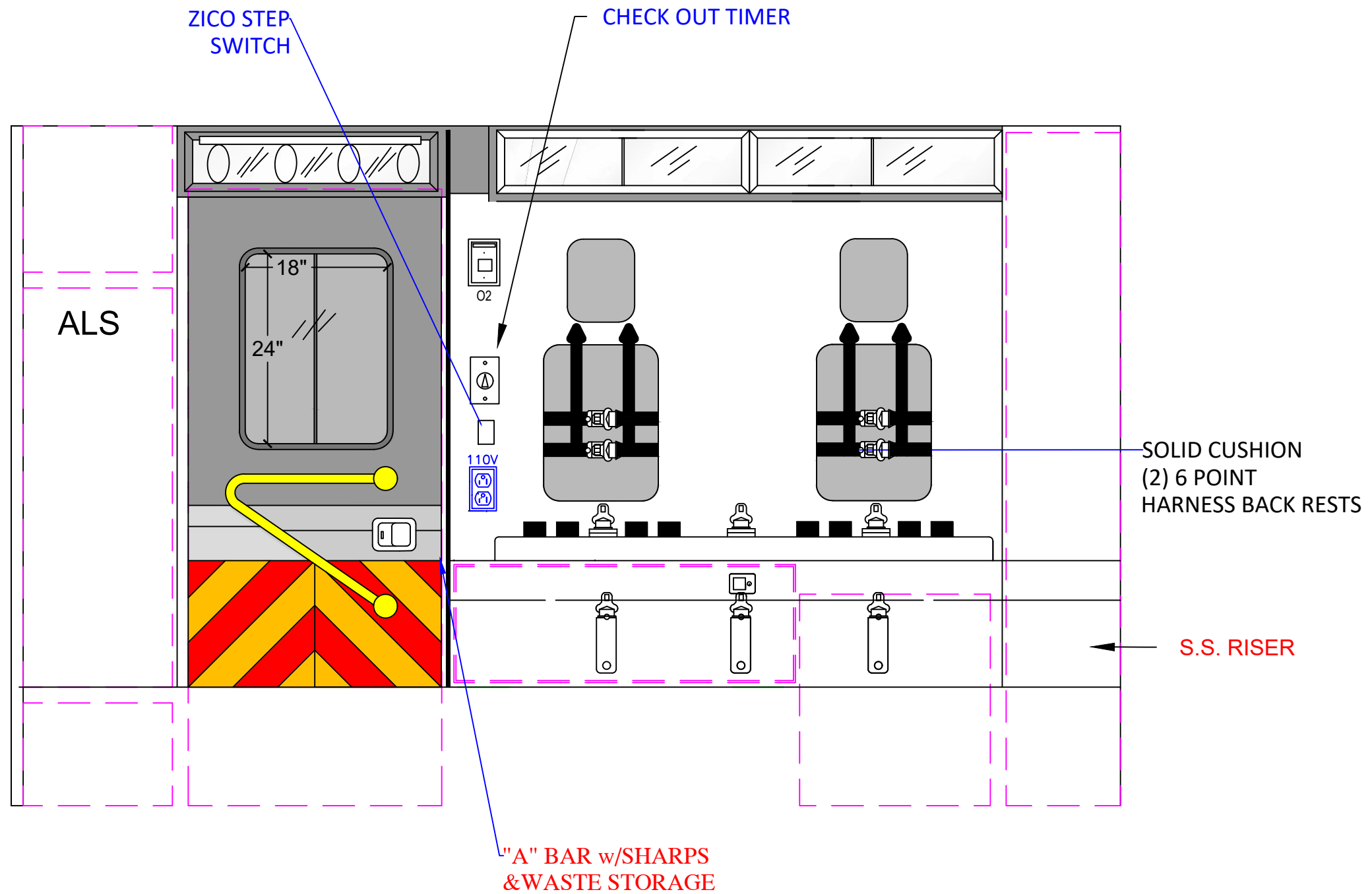

		BULLOCH COUNTY	
		WORK ORDER	
	SIZE	PART	REVISION
	<b>B</b>	PASSENGER INTERIOR	
WO#5	SCALE	DRAWN BY	DATE

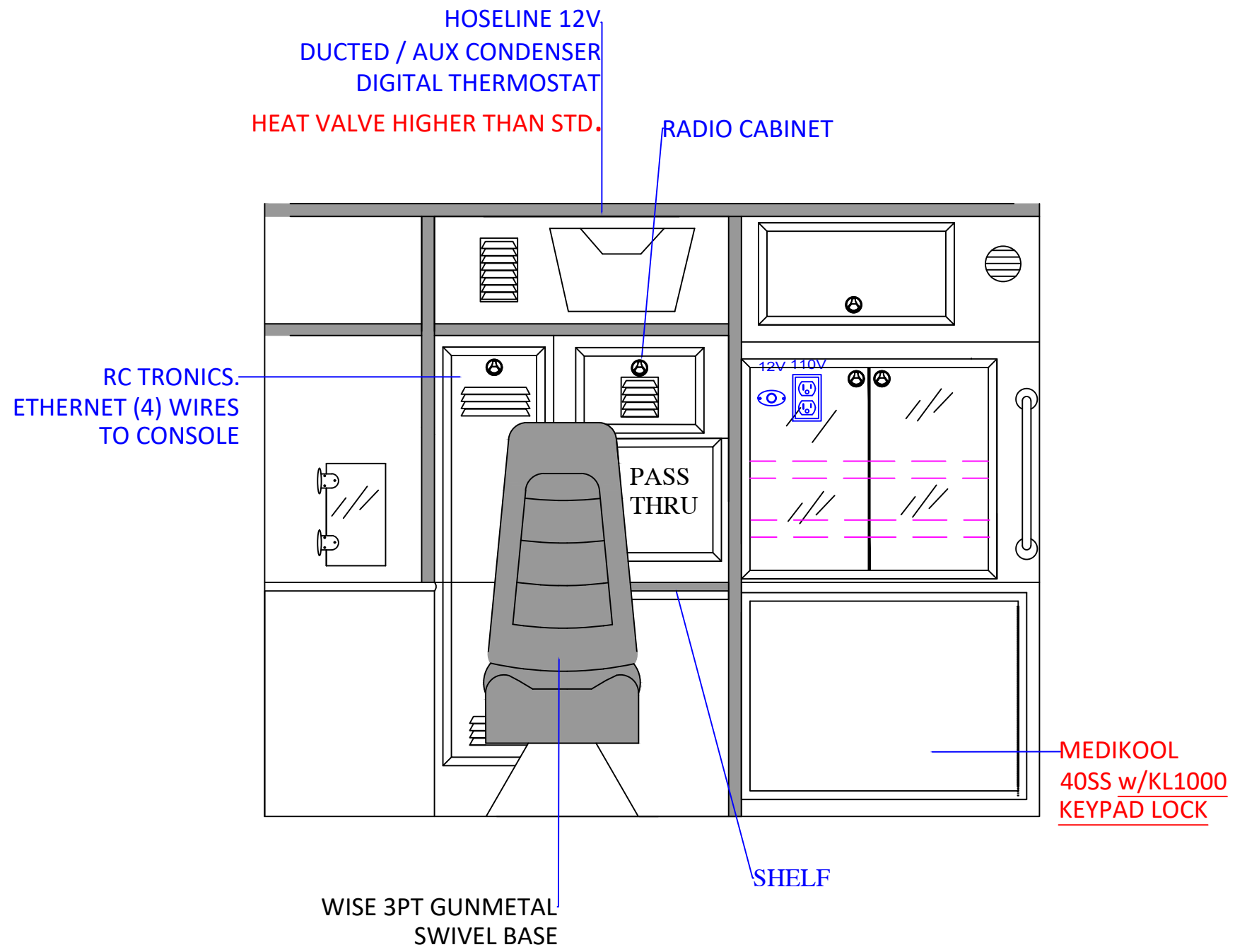

	BULLOCH COUNTY		
	WORK ORDER		
	SIZE <b>B</b>	PART	REVISION
	FRONT INTERIOR		
WO#6	SCALE	DRAWN BY	DATE

DRY ERASE  
MARKER BOARD  
30"x15"  
MOUNTED 12" DOWN FROM TOP  
AND 3" BACK FROM THE FACE

DUMP SWITCH  
ON DOOR

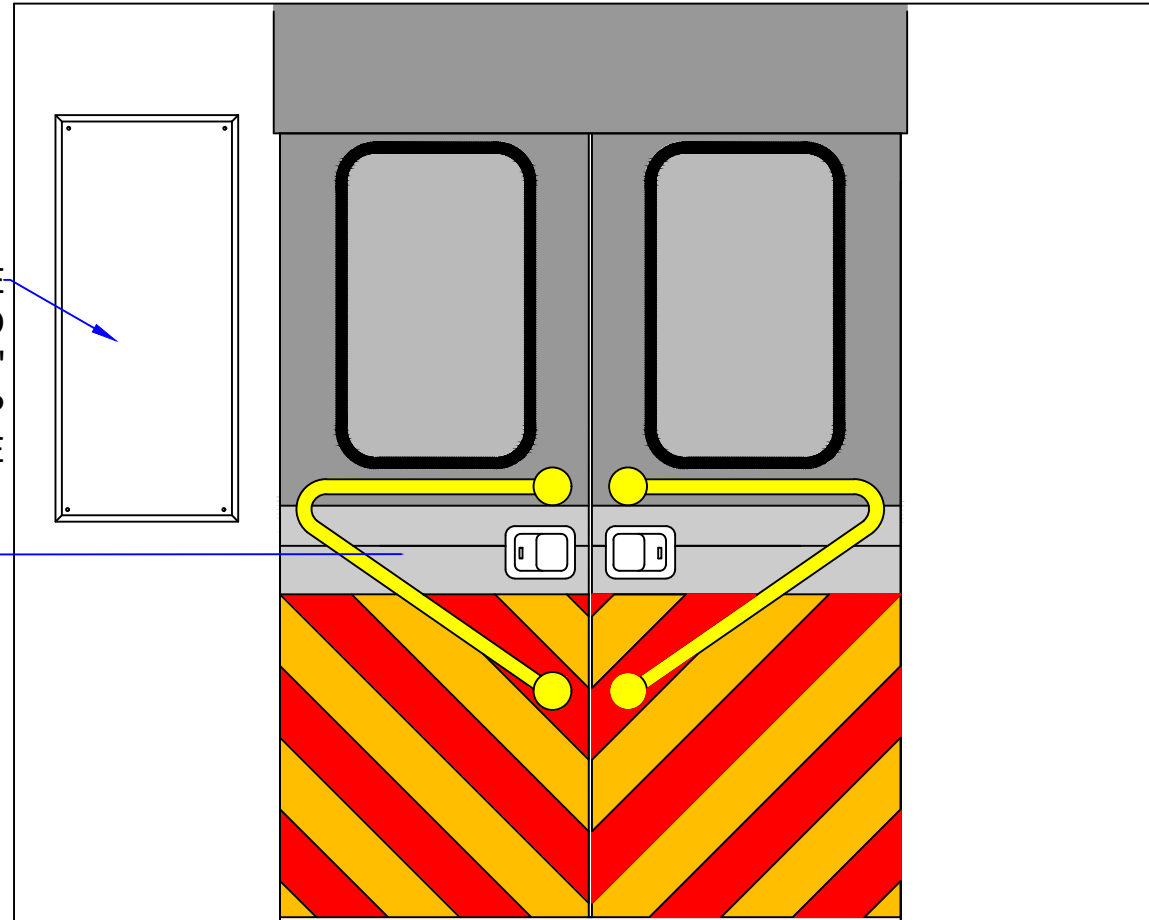

	BULLOCH COUNTY		
	WORK ORDER		
	SIZE <b>B</b>	PART REAR INTERIOR	REVISION
WO#7	SCALE	DRAWN BY	DATE

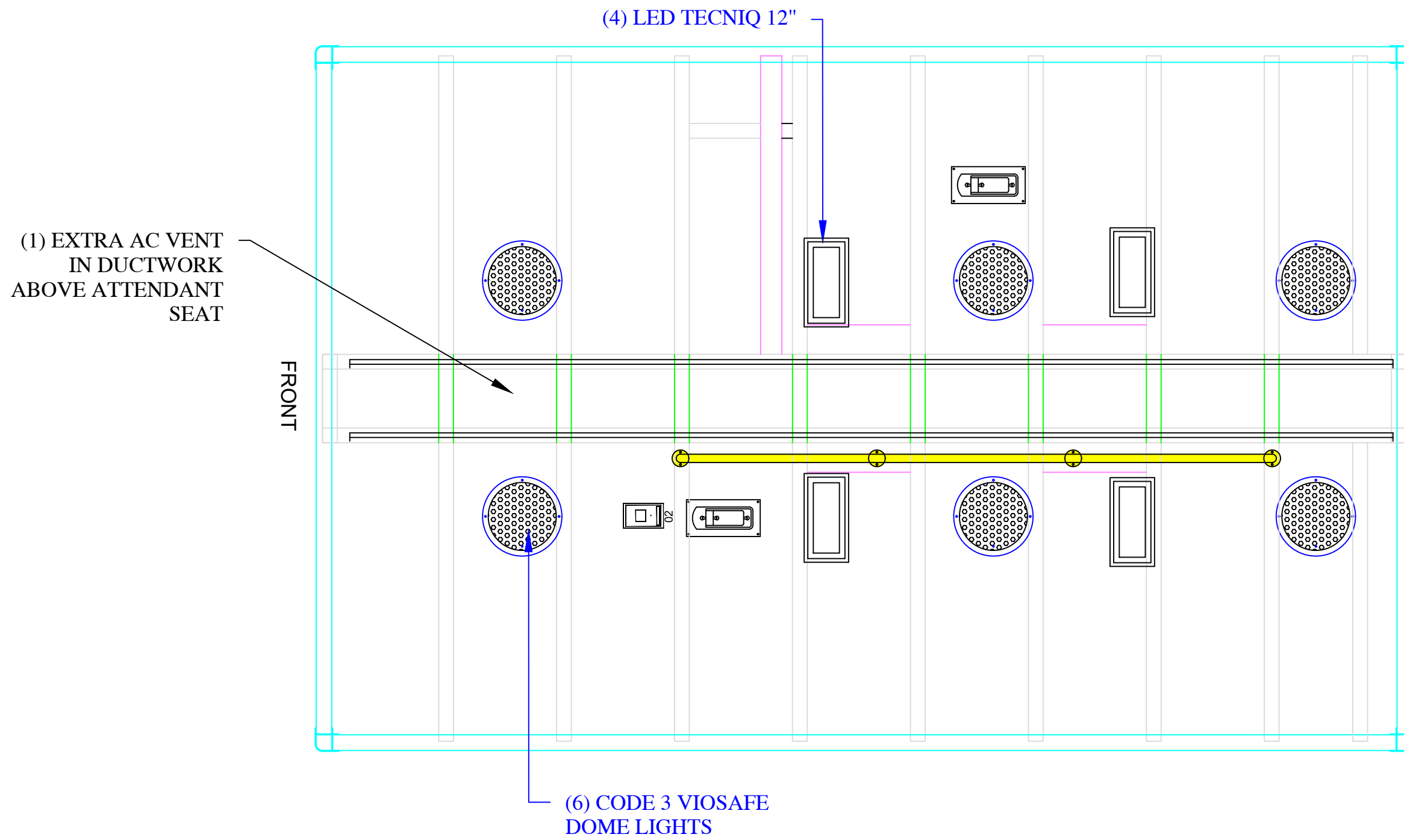

		BULLOCH COUNTY	
		WORK ORDER	
	SIZE	PART	REVISION
	<b>B</b>	CEILING	
WO#8	SCALE	DRAWN BY	DATE