

### NOTICE TO BIDDERS

**This Addendum is issued pursuant to the Conditions of the Contract and is hereby made part of the Contract Documents. The addendum serves to clarify, revise, and supersede information in the Project Manual, the Drawings, and previously issued Addenda. The Bidder shall acknowledge receipt of this Addendum in the appropriate space on the Bid Form. Failure to do so may subject the Bidder to disqualification. A list of attachments, if any, is part of this document.**

**The date for receipt of bids for this project is unchanged by this Addendum.**

**A. PRIOR APPROVALS**

1. Constant volume packaged heating and cooling unit (with hot gas reheat):
  - a. Add Valent as an approved manufacturer.
2. Single zone VAV packaged heating and cooling unit (with hot gas reheat):
  - a. Add Valent as an approved manufacturer.

**B. GENERAL CONSTRUCTION DRAWINGS**

1. Sheet GC-104
  - a. See revised sheet.

**ATTACHMENTS:**

1. Drawing GC-104

- End of Addendum -

Project Engineer:	JJB		
Drawn By:	LAM		
Revisions:			
No.	1	Desc.	02/09/2021
No.		Desc.	
No.		Desc.	
No.		Desc.	
No.		Desc.	
No.		Desc.	
No.		Desc.	
No.		Desc.	
No.		Desc.	
No.		Desc.	
No.		Desc.	
No.		Desc.	
No.		Desc.	

This drawing and the design shown are the property of Buford Goff & Associates. This information is to be used for the project only and is not to be reproduced or used in any other project without the written consent of Buford Goff & Associates. Any reuse of this information is prohibited and any infringement will be subject to legal action.

**FORT MILL HIGH SCHOOL DISTRICT  
FORT MILL HIGH SCHOOL HVAC RENOVATIONS  
LADDER REPLACEMENT PLAN AND DETAILS**

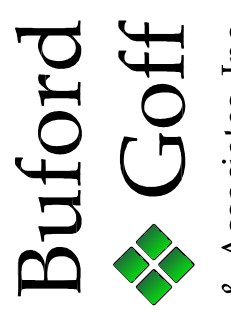
**Buford Goff & Associates, Inc.**  
 Engineers & Planners  
 1331 Elmwood Ave.  
 Suite 200  
 Columbia, SC 29201  
 Phone: (803) 254-6302

Sheet Title: LADDER REPLACEMENT PLAN AND DETAILS  
 Project: FORT MILL HIGH SCHOOL HVAC RENOVATIONS  
 Date: DECEMBER 14, 2020  
 Scale: As Noted  
 ECG PROJECT NUMBER: 2001  
 CONSTRUCTION DOCUMENTS

**GENERAL CONSTRUCTION KEY NOTES**

- INSTALL NEW LADDER IN APPROXIMATE LOCATION OF EXISTING LADDER. COORDINATE LOCATION OF LADDER WITH EXISTING CONDITIONS AND ROOF ACCESS LOCATIONS. PROVIDE OFFSETS AS REQUIRED.
- FIELD VERIFY ALL DIMENSIONS AND LADDER LENGTHS PRIOR TO ORDERING.

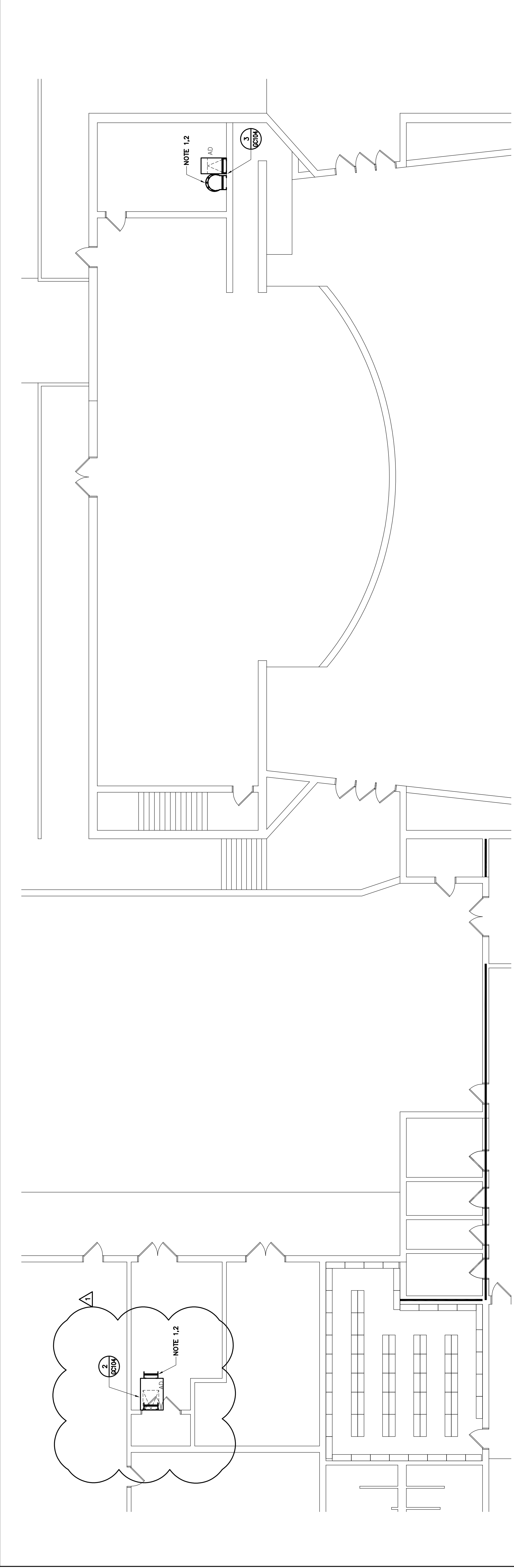

**1 LADDER REPLACEMENT PLAN**  
SCALE: 1/8"=1'-0"

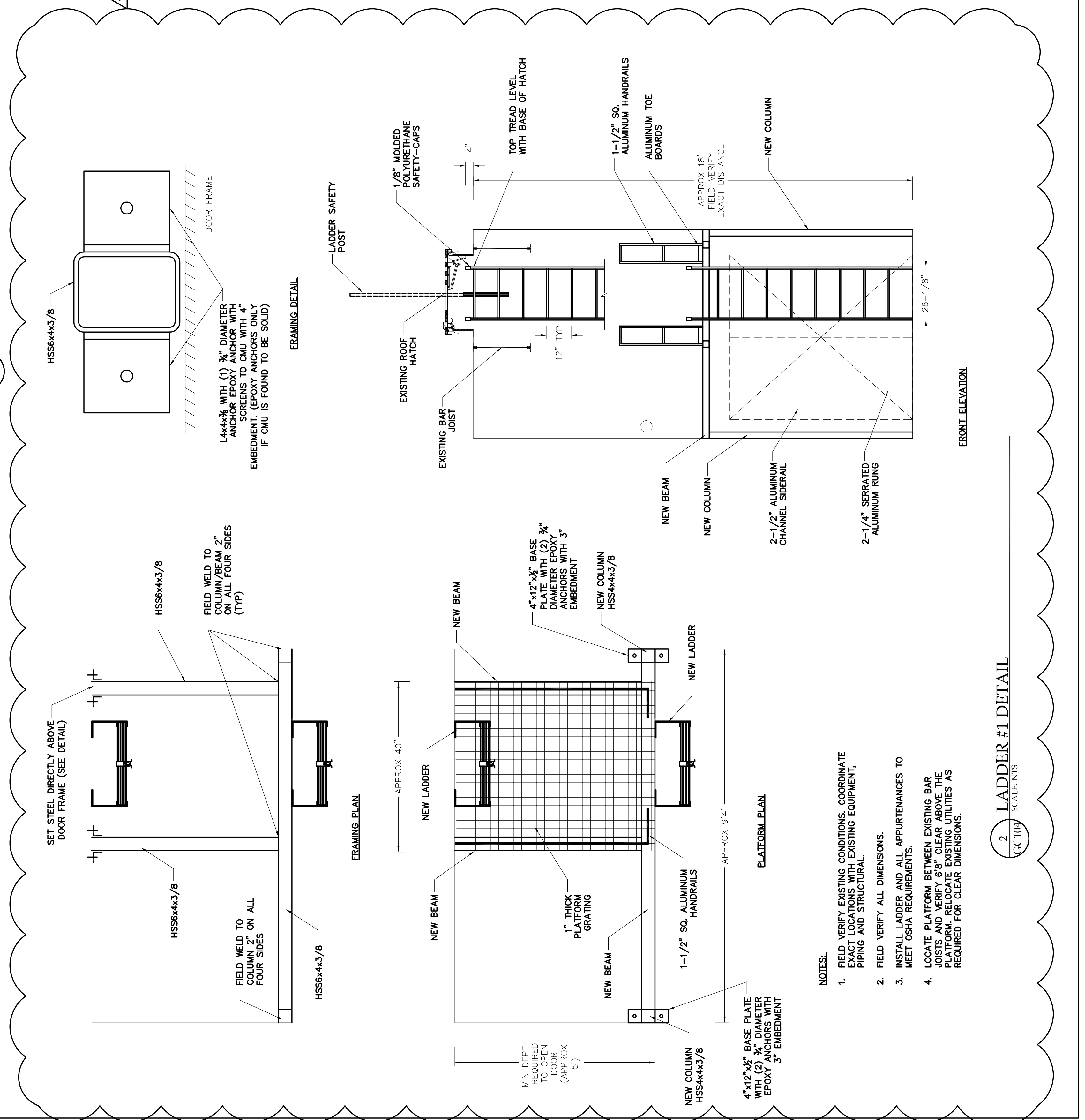

- NOTES:**
- FIELD VERIFY EXISTING CONDITIONS. COORDINATE EXACT LOCATIONS WITH EXISTING EQUIPMENT, FRING AND STRUCTURE.
  - FIELD VERIFY ALL DIMENSIONS.
  - INSTALL LADDER AND ALL APPURTENANCES TO MEET OSHA REQUIREMENTS.
  - LOCATE PLATFORM BETWEEN EXISTING BAR JOISTS AND VERIFY 6\"/>

**2 LADDER #1 DETAIL**  
SCALE: NTS

**3 LADDER #2 DETAIL**  
SCALE: NTS

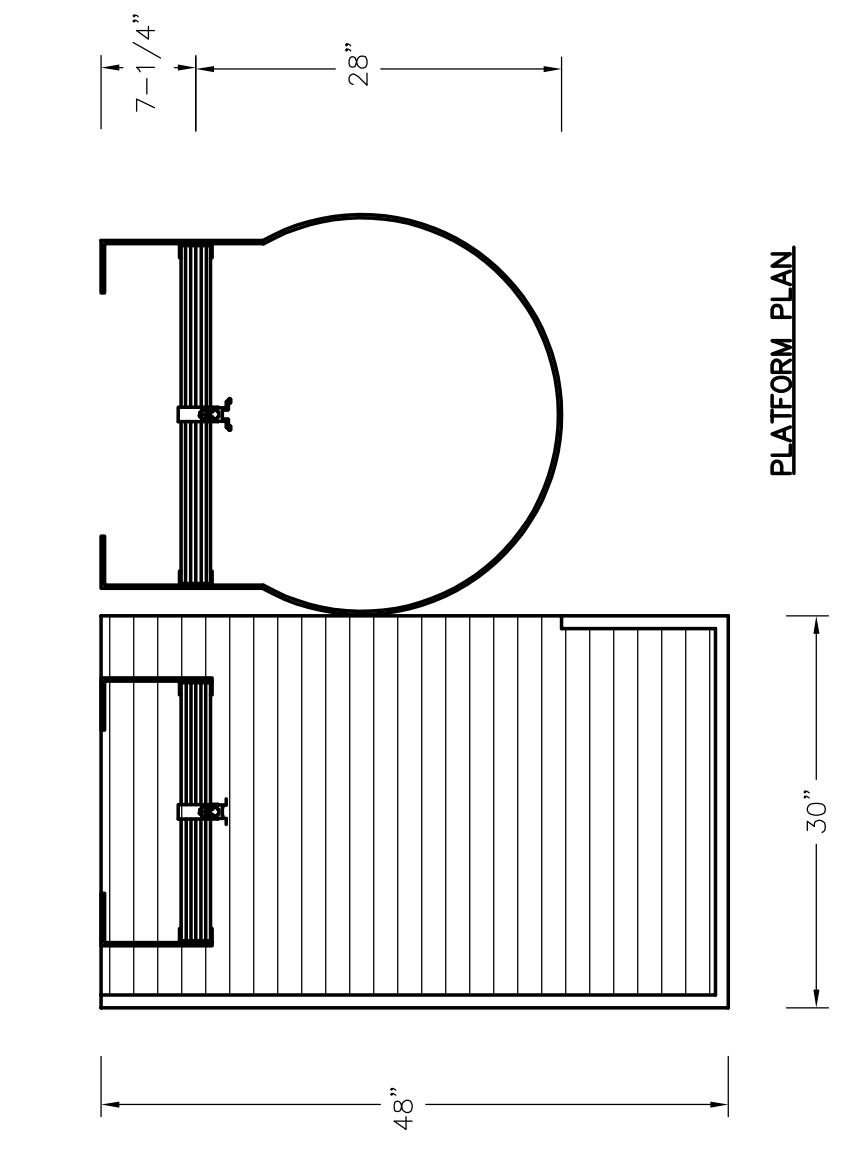

**KEYPLAN**

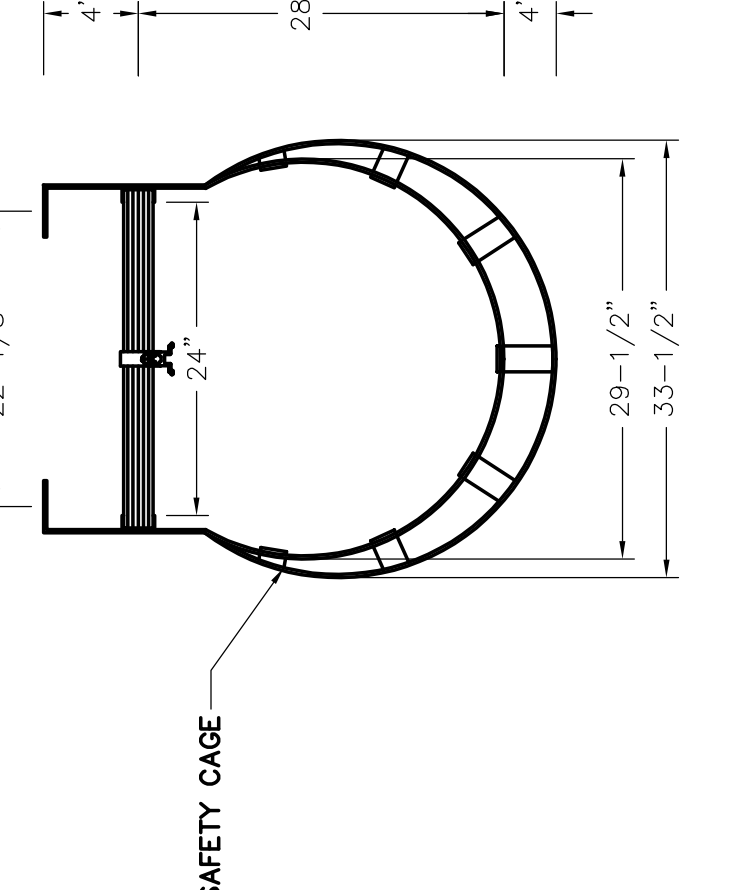
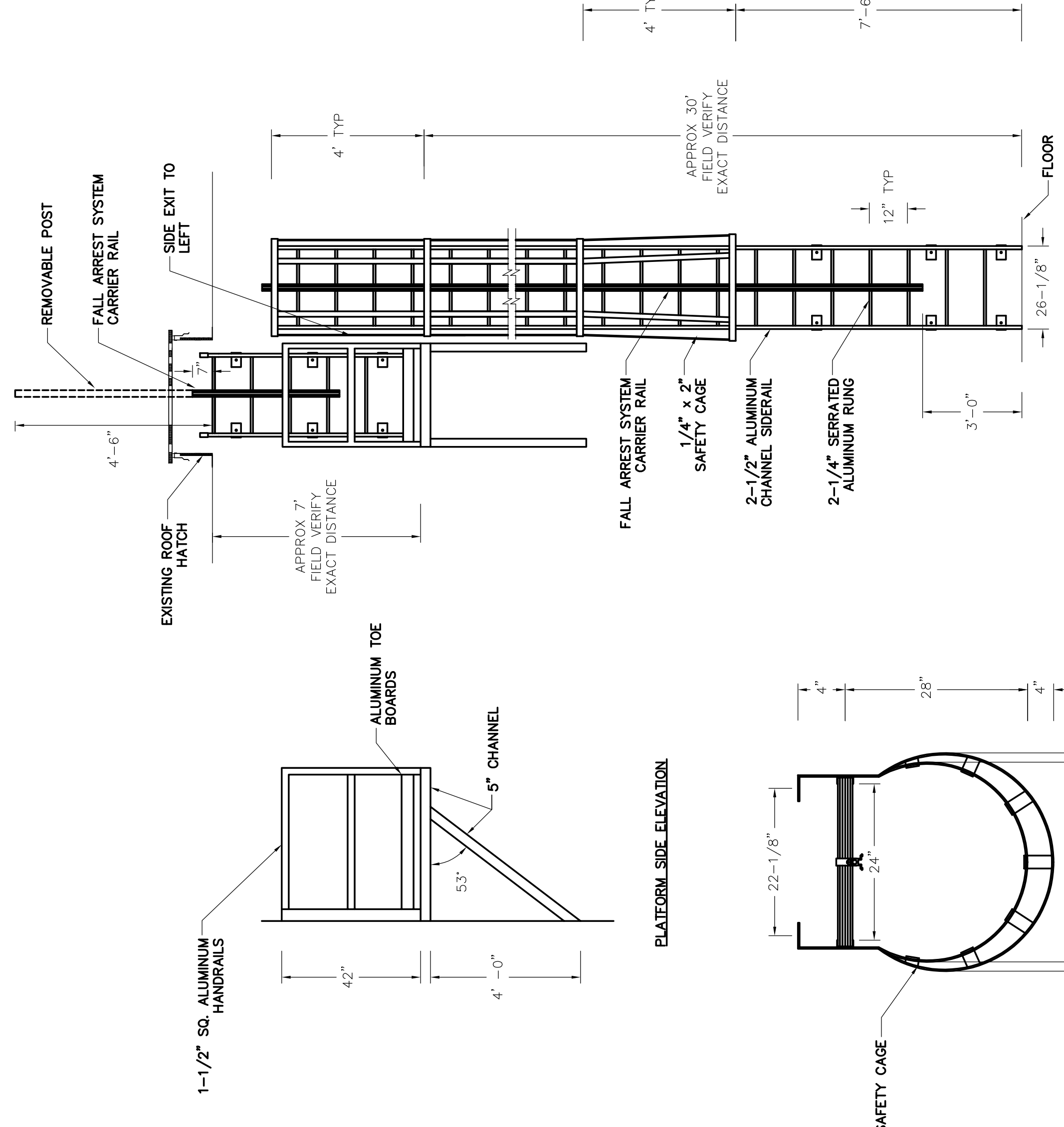
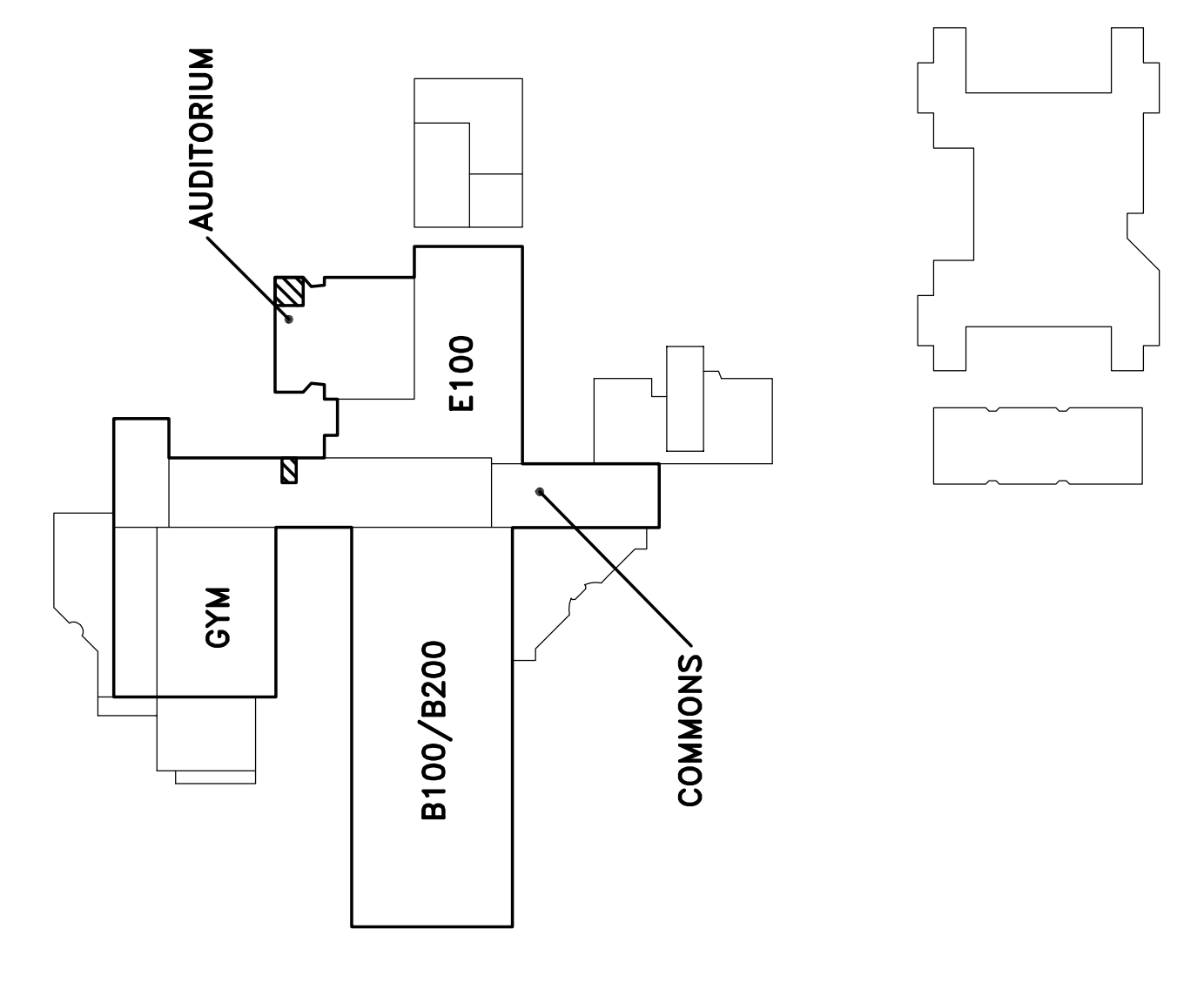

**ERECTOR ELEVATION**

### NOTICE TO BIDDERS

**This Addendum is issued pursuant to the Conditions of the Contract and is hereby made part of the Contract Documents. The addendum serves to clarify, revise, and supersede information in the Project Manual, the Drawings, and previously issued Addenda. The Bidder shall acknowledge receipt of this Addendum in the appropriate space on the Bid Form. Failure to do so may subject the Bidder to disqualification. A list of attachments, if any, is part of this document.**

**The date for receipt of bids for this project is unchanged by this Addendum.**

**A. PRIOR APPROVALS**

1. Constant volume packaged heating and cooling unit (with hot gas reheat):
  - a. Add Valent as an approved manufacturer.
2. Single zone VAV packaged heating and cooling unit (with hot gas reheat):
  - a. Add Valent as an approved manufacturer.

**B. GENERAL CONSTRUCTION DRAWINGS**

1. Sheet GC-104
  - a. See revised sheet.

**ATTACHMENTS:**

1. Drawing GC-104

- End of Addendum -



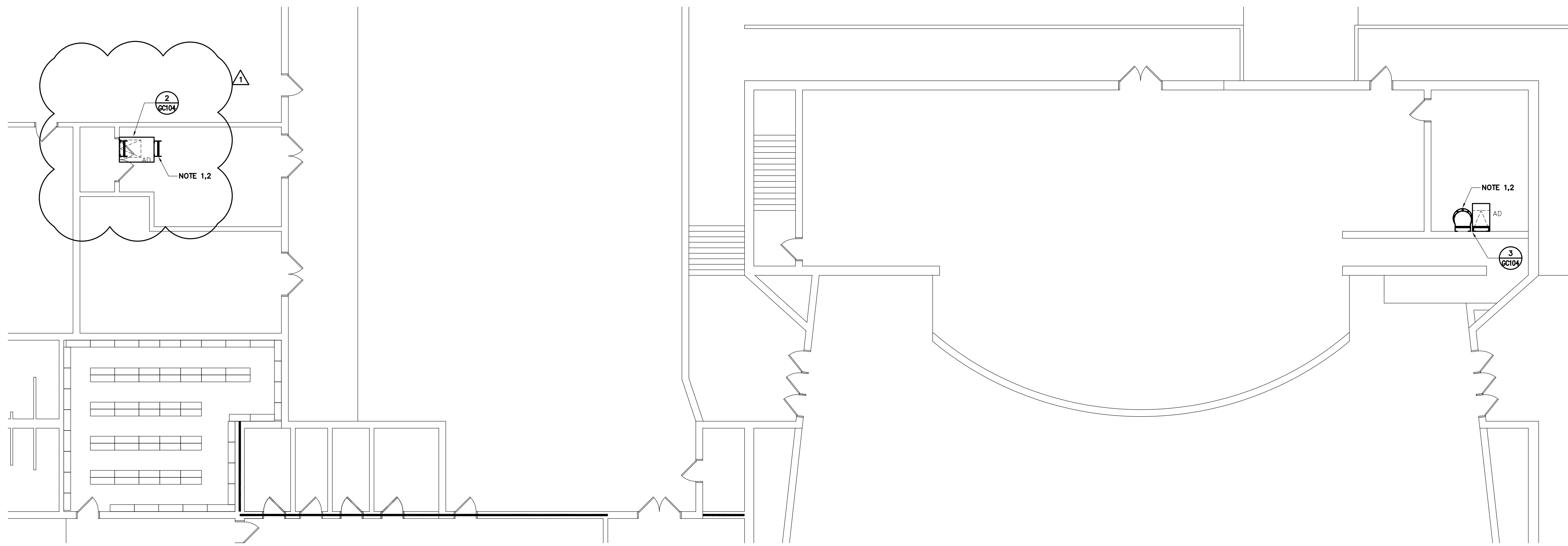

1 LADDER REPLACEMENT PLAN  
GC104 SCALE: 1/8"=1'-0"

**GENERAL CONSTRUCTION KEY NOTES**

- INSTALL NEW LADDER IN APPROXIMATE LOCATION OF EXISTING LADDER. COORDINATE LOCATION OF LADDER WITH EXISTING CONDITIONS AND ROOF ACCESS LOCATIONS. PROVIDE OFFSETS AS REQUIRED.
- FIELD VERIFY ALL DIMENSIONS AND LADDER LENGTHS PRIOR TO ORDERING.

Project Engineer: JEB  
 Drawn By: LAM

Revisions:

No. 1	Date: 02/05/2021
No. _____	Date: _____
No. _____	Date: _____
No. _____	Date: _____
No. _____	Date: _____
No. _____	Date: _____
No. _____	Date: _____
No. _____	Date: _____

This drawing and the design shown are the property of:  
 Buford Goff & Associates.  
 The reproduction, copying or other use of this drawing without their written consent is prohibited and any infringement will be subject to legal action.

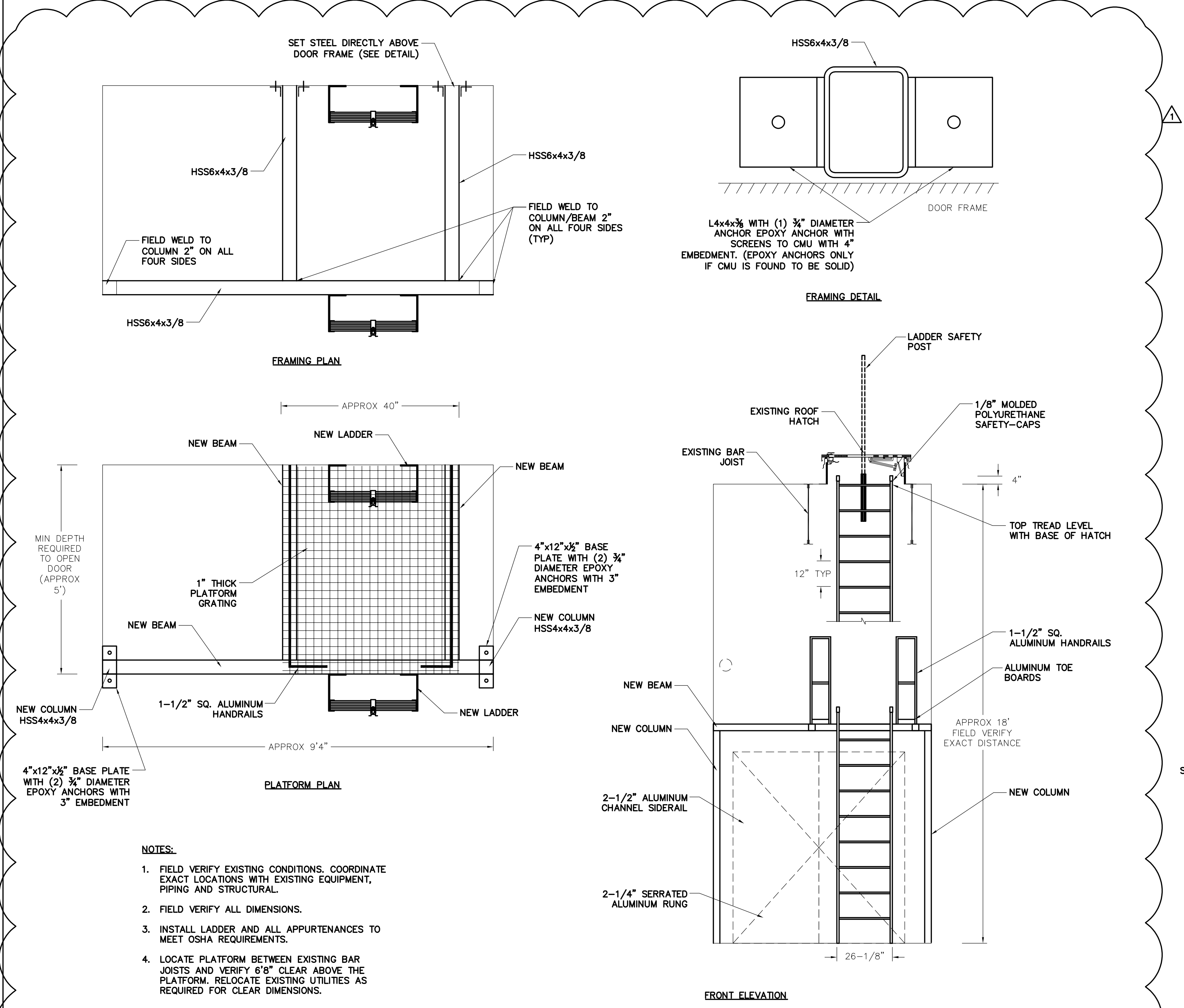

2 LADDER #1 DETAIL  
GC104 SCALE: NTS

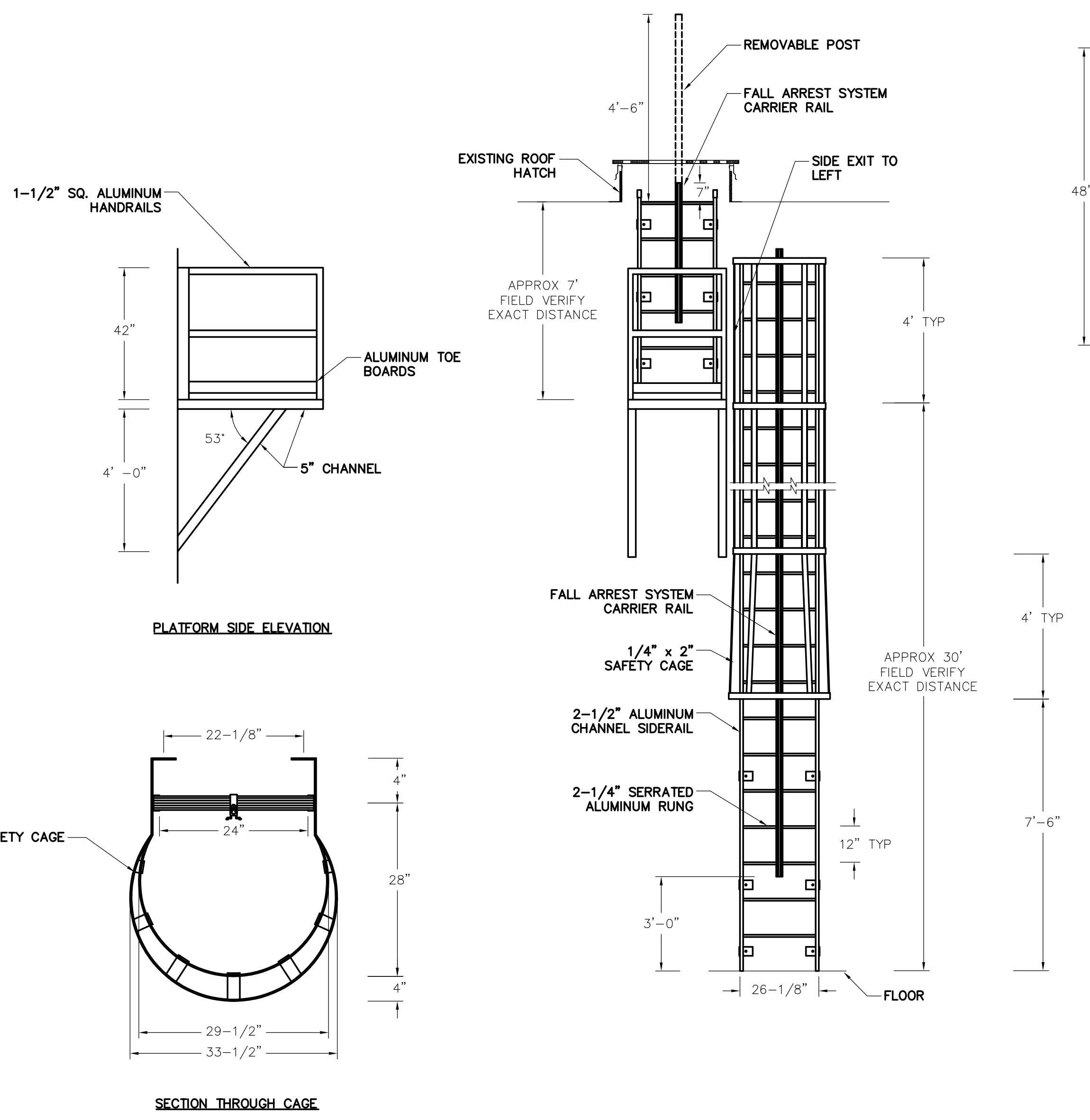

3 LADDER #2 DETAIL  
GC104 SCALE: NTS

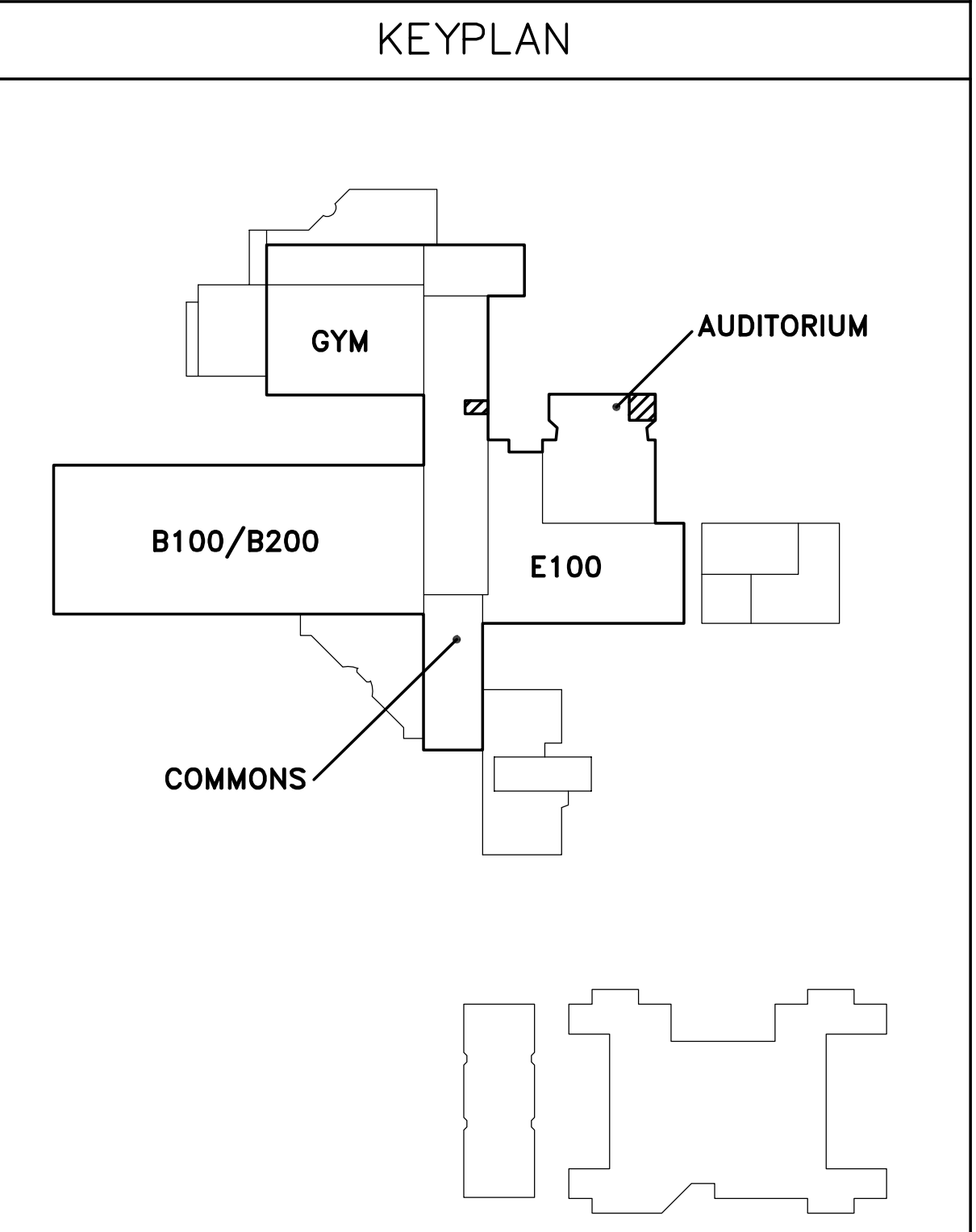

FORT MILL SCHOOL DISTRICT  
 FORT MILL HIGH SCHOOL HVAC RENOVATIONS  
 LADDER REPLACEMENT PLAN AND DETAILS

Project: \_\_\_\_\_  
 Sheet Title: \_\_\_\_\_

**Buford Goff**  
 & Associates, Inc.  
 Engineers & Planners

1331 Elmwood Ave.  
 Suite 200  
 Columbia, SC 29201  
 Phone: (803) 254-6302

Sheet Number:  
**GC104**

Date: DECEMBER 14, 2020  
 Scale: As Noted  
 BGA PROJECT NUMBER: 20051  
 CONSTRUCTION DOCUMENTS