

Owner:
City of Avondale
11465 W. Civic Center Drive
Avondale, AZ 85323

SmithGroup
SmithGroup Incorporated
455 N. Third Street
Suite 250
Phoenix, Arizona 85004
t: 602.265.2200
f: 602.265.2244
www.smithgroup.com

SHEET NOTES

- A. REFER TO SHEETS A4X FOR ARCHITECTURAL DRAWING, REFERENCE AND MATERIAL SYMBOLS AS WELL AS ABBREVIATIONS USED ON THIS DRAWING.
- B. FINISH FLOOR ELEVATION FOR THIS LEVEL IS 1'-0" 0". ALL FINISH FLOOR ELEVATIONS ARE TO BE SHOWN AS USED ON THIS SHEET. REFER TO THE RELEVANT ELEVATION DEFINITIONS NOTES LOCATED ON SHEET A4.1.
- C. FOR BASIC LIFE SAFETY AND CODE INFORMATION APPLYING TO THIS PLAN, REFER TO THE CODE COMPLIANCE DRAWINGS ON SHEET(S) C4X.
- D. REFER TO THE "A" SERIES SHEETS FOR PARTITION SYSTEM INFORMATION.
- E. REFER TO THE A8.2X SERIES SHEETS FOR PARTITION SYSTEM INFORMATION.
- F. ALL PARTITION WALLS SHALL BE TYPE "D85" UNLESS OTHERWISE NOTED.
- G. REFER TO THE A3.3X SERIES SHEETS FOR DOOR AND INTERIOR OPENING SYSTEM INFORMATION.
- H. REFER TO SHEET A2.1A FOR EDGE OF SLAB PLAN.
- I. ALL COLUMN ENCLOSURES \neq OFF CENTERLINE, TYP. UNLESS NOTED OTHERWISE.
- J. UNLESS NOTED OTHERWISE.

KEYED NOTES

- KEY NOTES APPLY TO ALL FLOOR PLAN SHEETS AND REFERENCE INDIVIDUAL NOTES MAY NOT APPLY TO ALL SHEETS.
- 1. SEMI-RECESSED FIRE EXTINGUISHER - REF. DET. 34/A8.9.1
- 2. LINE OF ROOF ABOVE
- 3. ROOF DRAIN LEADER
- 4. LADDER TO ROOF HATCH - REF. DET. 32/A8.8.1
- 5. PAINTED W/L. CANOPY ABOVE.
- 6. ANTI-THEFT SECURITY SYSTEM
- 7. LINE OF SOFFIT ABOVE.
- 8. METAL LOCKERS - 12" x 12" x 36"
- 9. CONCRETE EQUIPMENT PAD
- 10. CMU WALL CONSTRUCTION - SEE ELEVATION FOR CMU TYPE
- 11. EPS OVER MET. STUD FRAMING
- 12. NOT USED
- 13. COLUMN COVER - REF. DET. 20/A8.1.1
- 14. EQUIPMENT N.L.C.
- 15. INFORMATION DESK FURNITURE
- 16. CASEWORK - SEE INTERIOR DIMS.
- 17. STEEL CORNER GUARDS
- 18. CONCRETE FILL PIPE ROLLARD - SEE DETAIL 40/A1.7
- 19. ROUGH OPENING FOR CHECK IN EQUIPMENT - VERIFY WITH MFR. (4) $3/4$ " (4) x 29 1/2" (4) WITH BOTTOM OF SL. AT 25' (A1.7)

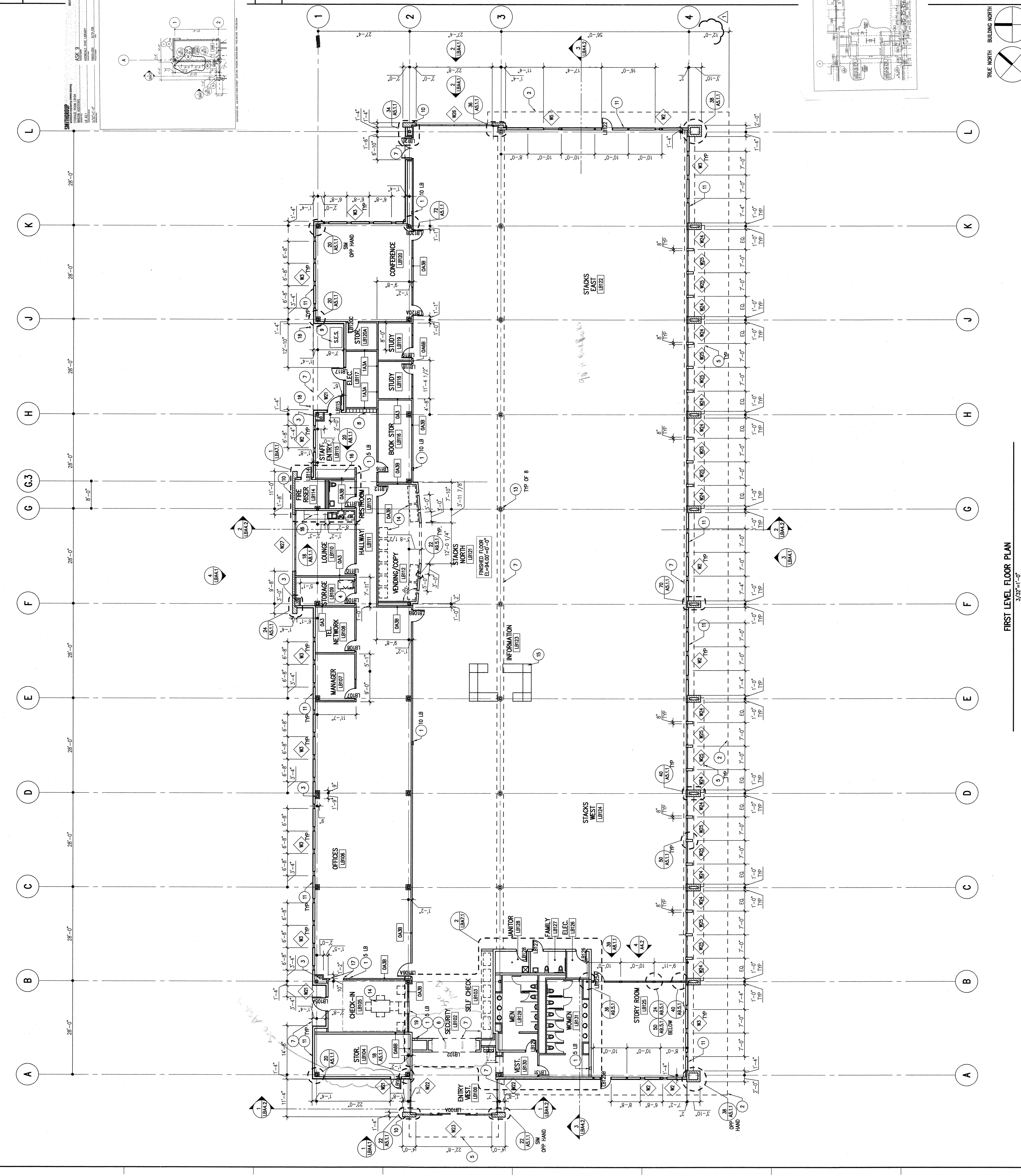

Professional Engineer
Arizona Professional Seal
AIA Document G710 - 1992

Seals and Signatures

City Comments	1	02/26/05
City Permit	1	2002/05

Key Plan

