

CONSTRUCTION PLANS for

SAXONY DRIVE CULVERT REPLACEMENT

1309 Saxony Drive SE, Conyers, GA 30013 Land Lot 237, 10th District, Rockdale County

Prepared By:

Rockdale County Department of Stormwater Management

958 Milstead Avenue NE, Conyers, GA 30012 Phone: 770-278-7155

PROJECT MANAGER / 24-HR CONTACT: TODD A. COSBY, PE (678) 281-4848

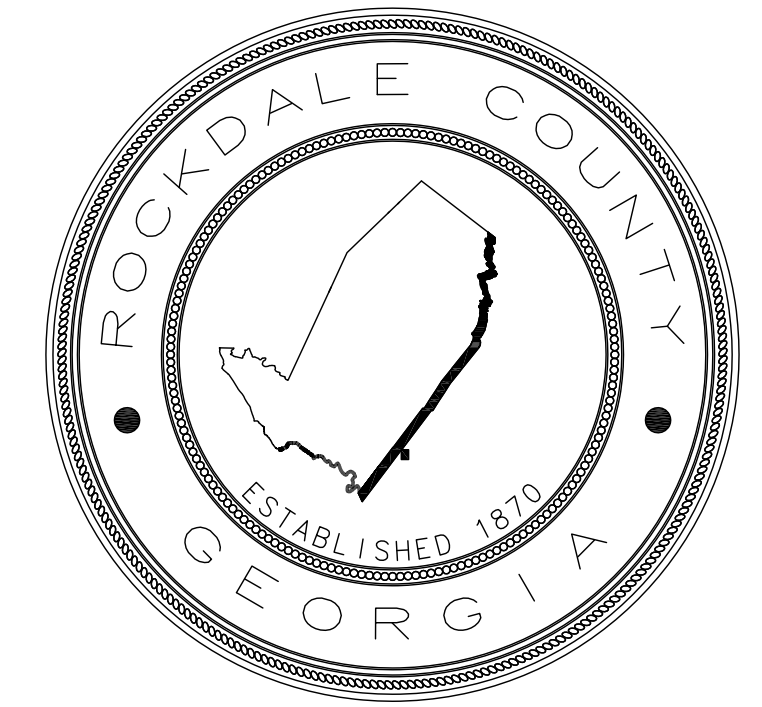

GENERAL NOTES:

PROJECT NAME: SAXONY DRIVE CULVERT REPLACEMENT

SITE ADDRESS: 1309 SAXONY DRIVE SE, CONYERS, GA

SITE LOCATION: LATITUDE: 33°38'04.69"N LONGITUDE: 84°00'27.46"W
LAND LOT 237, 10th DISTRICT, ROCKDALE COUNTY

SITE OPERATOR: ROCKDALE COUNTY
DEPARTMENT OF STORMWATER MANAGEMENT
958 MILSTEAD AVENUE NE
CONYERS, GA 30012
PHONE: (770) 278-7155

PROJECT MANAGER / 24-HR CONTACT: TODD A. COSBY, PE (678) 281-4848

PROPOSED TOTAL DISTURBED AREA = 0.60 ACRES
PROPOSED NET IMPACT TO STREAM = 57 LINEAR FEET, 0.014 ACRES

UTILITY, TOPOGRAPHIC, BOUNDARY, AND OTHER DATA TAKEN FROM GROUND RUN SURVEY AND FROM ROCKDALE COUNTY GIS DATA, AND SHALL BE CONSIDERED AS APPROXIMATE. CONTRACTOR SHALL STOP CONSTRUCTION AND NOTIFY THE COUNTY PROJECT MANAGER IMMEDIATELY IF ANY DISCREPANCIES OR UNFORESEEN CONDITIONS ARE ENCOUNTERED DURING CONSTRUCTION. THE CONTRACTOR SHALL NOT MAKE ANY FIELD ADJUSTMENTS TO THE PLANS WITHOUT PRIOR WRITTEN APPROVAL FROM THE COUNTY PROJECT MANAGER.

STATE WATERS OF GEORGIA AND WATERS OF THE UNITED STATES ARE LOCATED WITHIN THE PROJECT SITE, AND SHALL BE AVOIDED AND PROTECTED AS MUCH AS PRACTICABLE.

THE PROJECT SITE IS LOCATED WITHIN THE LIMITS OF A FLOOD HAZARD ZONE, PER FEMA FIRM PANEL NUMBER 13247C0094 D, DATED DECEMBER 8, 2016.

EXISTING WATER SUPPLY, SANITARY SEWER, ELECTRICAL POWER, NATURAL GAS, AND COMMUNICATION UTILITIES ARE LOCATED WITHIN PROPOSED DISTURBED AREA. THE EXISTING LOCATIONS SHOWN ARE APPROXIMATE AND SHOWN FOR CONCEPTUAL PURPOSES ONLY. CONTRACTOR SHALL NOT BEGIN CONSTRUCTION UNTIL A UTILITY LOCATION HAS BEEN PERFORMED, AND UTILITY OWNERS ARE CONTACTED ABOUT NECESSARY RELOCATION EFFORTS. CONTRACTOR SHALL STOP CONSTRUCTION AND NOTIFY THE COUNTY PROJECT MANAGER IMMEDIATELY IF ANY ADDITIONAL UTILITIES ARE ENCOUNTERED DURING CONSTRUCTION.

UTILITY OWNER CONTACT INFORMATION:
SNAPPING SHOALS EMC - JAMIE NASH, 770-385-2855
GEORGIA POWER COMPANY - KRIS STEPHENS, x2ksteph@southernco.com, 706-340-6457

AT&T - JASON DOBSON, jd1288@att.com, 770-757-9482
ED ROCKERS, er2531@att.com, 678-640-2202
COMCAST - CHRIS BATES, christopher_bates2@cable.comcast.com
SOUTHERN COMPANY GAS - MATTHEW VALE, mvale@southernco.com, 404-584-3038
RWR - TIM SMITH, tim.smith@rockdalecountyga.gov, 770-278-7434

CONTRACTOR SHALL CONTACT THE ROCKDALE COUNTY FORESTER (770-278-7100) BEFORE BEGINNING ANY CLEARING OPERATIONS. IDENTIFICATION OF SPECIMEN TREES, CLEARING LIMITS, AND DETERMINATION OF ASSOCIATED RECOMPENSE REQUIREMENTS WILL BE AT THE DISCRETION OF THE COUNTY FORESTER. UNLESS ALLOWED BY THE COUNTY FORESTER, CONTRACTOR SHALL NOT REMOVE ANY TREES OR WOODY VEGETATION BEYOND WHAT IS NECESSARY TO CONSTRUCT THE PROPOSED IMPROVEMENTS.

CONTRACTOR SHALL PERFORM ALL WORK IN ACCORDANCE WITH LOCAL, STATE, AND FEDERAL ORDINANCES AND REGULATIONS.

ALL WORK SHALL CONFORM TO GEORGIA DEPARTMENT OF TRANSPORTATION STANDARDS AND SPECIFICATIONS.

CONTRACTOR SHALL ENSURE SAFE AND UNRESTRICTED ACCESS TO PROPERTIES THROUGHOUT THE PROJECT, AND SHALL PROVIDE TEMPORARY DRIVEWAYS, PAVEMENT, ROAD PLATES, SIGNAGE, ETC. WHEN NECESSARY.

PRIOR TO CONSTRUCTION, THE CONTRACTOR SHALL SUBMIT A DETAILED CONSTRUCTION SCHEDULE FOR THE COUNTY PROJECT MANAGER'S APPROVAL, SHOWING THE SEQUENCE AND DURATION OF ALL ACTIVITIES. THE SCHEDULE MAY BE COMPRESSED OR EXPANDED AS NECESSARY, BUT NO DEVIATION FROM THE APPROVED SEQUENCE SHALL BE ALLOWED WITHOUT PRIOR WRITTEN APPROVAL FROM THE COUNTY PROJECT MANAGER.

Sheet Index:

- 1 Existing Conditions
- 2 Demolition & Work Area Plan
- 3 Site & Utility Plan
- 4 Grading & Drainage Plan
- 5 Storm Sewer Profiles
- 6 Road & Wall Profiles, Details
- 7 Erosion, Sedimentation, & Pollution Control (ES&PC) Plan - Initial Phase
- 8 Erosion, Sedimentation, & Pollution Control (ES&PC) Plan - Intermediate Phase
- 9 Erosion, Sedimentation, & Pollution Control (ES&PC) Plan - Final Phase

Georgia Department of Transportation (GDOT) Standards, Details, and Specifications are included by reference.

Manual for Erosion and Sediment Control in Georgia (Green Book), 2016 Edition, Standards, Details, and Specifications are included by reference.

**FOR BIDDING PURPOSES ONLY;
NOT FOR CONSTRUCTION;
SEE SIGNED HARDCOPY**

ISSUE DATE:
July 10, 2018

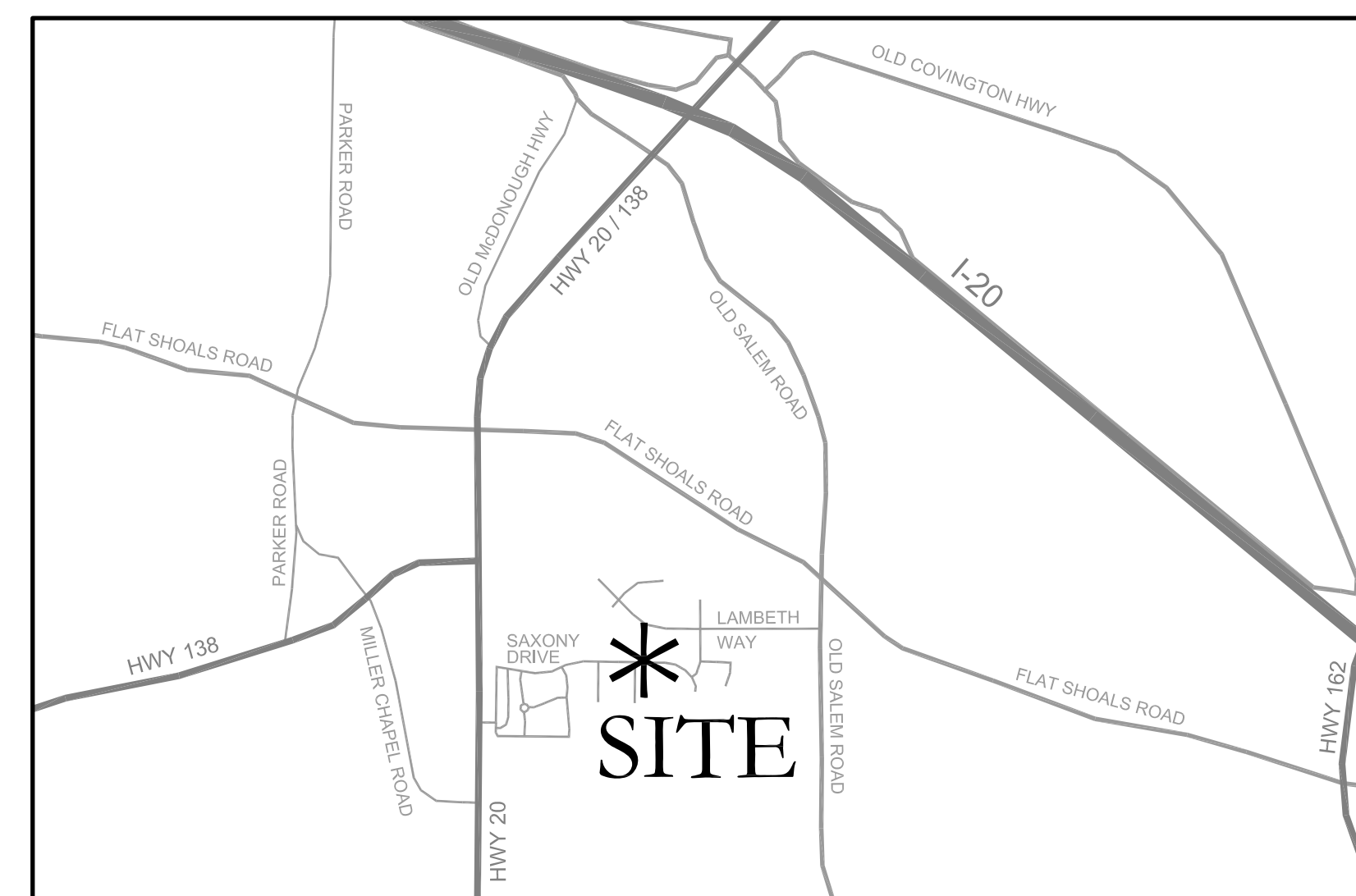

VICINITY MAP

SAXONY DRIVE CULVERT REPLACEMENT
ISSUE DATE: JULY 10, 2018



CALL BEFORE YOU DIG!

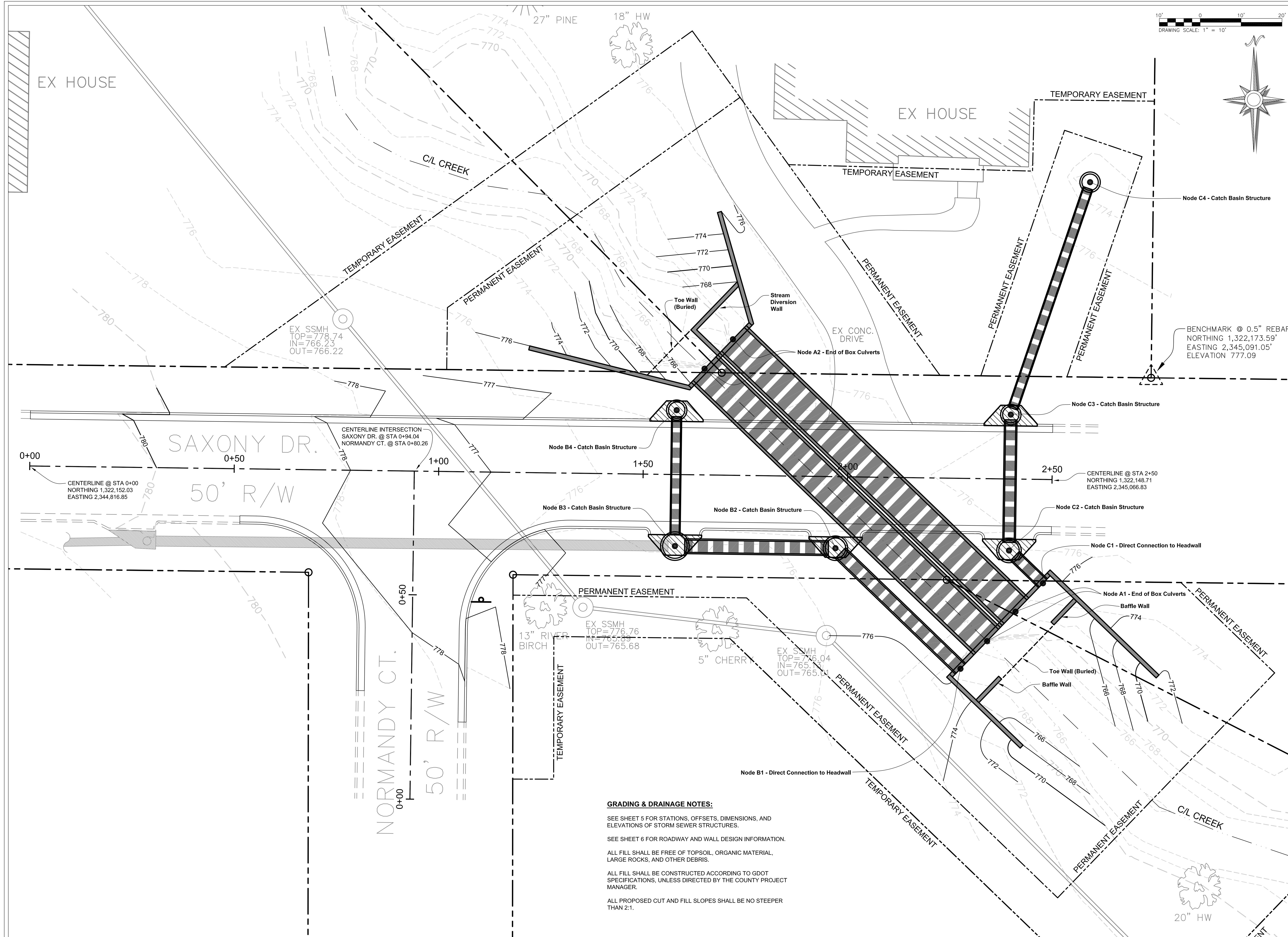

GRADING & DRAINAGE NOTES:

SEE SHEET 5 FOR STATIONS, OFFSETS, DIMENSIONS, AND ELEVATIONS OF STORM SEWER STRUCTURES.

SEE SHEET 6 FOR ROADWAY AND WALL DESIGN INFORMATION.

ALL FILL SHALL BE FREE OF TOPSOIL, ORGANIC MATERIAL, LARGE ROCKS, AND OTHER DEBRIS.

ALL FILL SHALL BE CONSTRUCTED ACCORDING TO GDOT SPECIFICATIONS, UNLESS DIRECTED BY THE COUNTY PROJECT MANAGER.

ALL PROPOSED CUT AND FILL SLOPES SHALL BE NO STEEPER THAN 2:1.

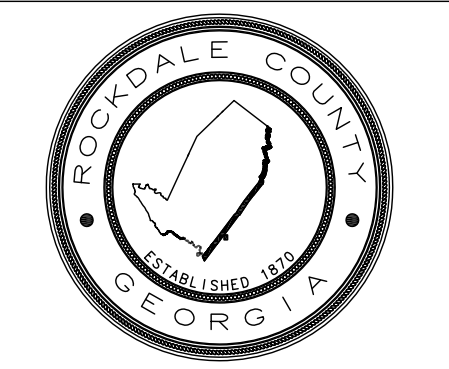
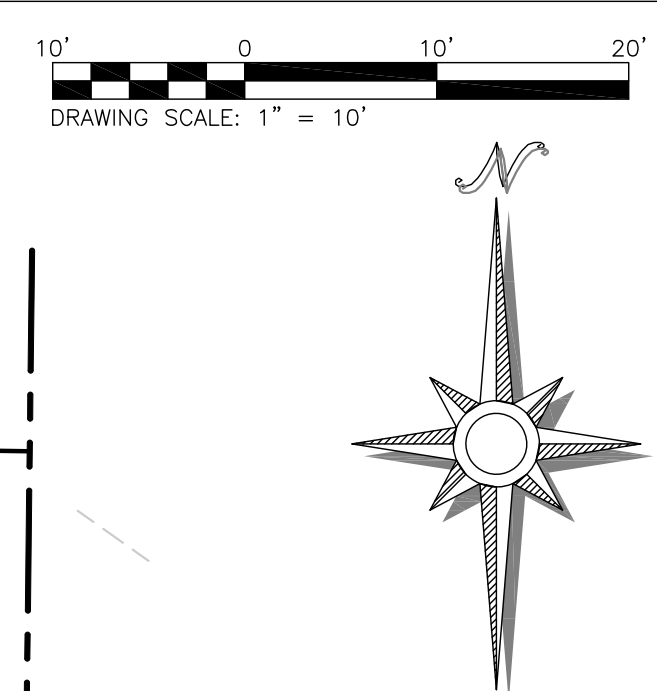

**ROCKDALE COUNTY
STORMWATER
MANAGEMENT**
958 MILSTEAD AVENUE
CONYERS, GEORGIA 30012
PHONE: (770) 278-7155



CALL BEFORE YOU DIG!

CONSTRUCTION PLANS for
SAXONY DRIVE CULVERT REPLACEMENT
 1309 Saxony Drive SE, Conyers, GA 30013 Land Lot 237, 10th District, Rockdale County
 Rockdale County Dept. of Stormwater Management
 958 Milstead Avenue NE, Conyers, GA 30012 Phone: 770-278-7155

PROJECT NUMBER
 SWC-2015-02

REVISIONS	
#	DATE
2	7/10/2018
1	1/31/2018
0	11/15/2017
#	DATE

CERTIFICATION
**FOR BIDDING
 PURPOSES ONLY;
 NOT FOR
 CONSTRUCTION;
 SEE SIGNED
 HARDCOPY**

ISSUE DATE
 7/10/2018

SCALE
 1" = 10'

SHEET NUMBER
 4 OF 9

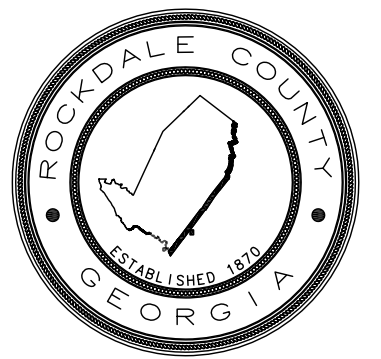

**ROCKDALE COUNTY
STORMWATER
MANAGEMENT**

958 MILSTEAD AVENUE
CONYERS, GEORGIA 30012
PHONE: (770) 278-7155



CALL BEFORE YOU DIG!

CONSTRUCTION PLANS for
SAXONY DRIVE CULVERT REPLACEMENT
1309 Saxony Drive SE, Conyers, GA 30013 Land Lot 237, 10th District, Rockdale County
Rockdale County Dept. of Stormwater Management
958 Milstead Avenue NE, Conyers, GA 30012 Phone: 770-278-7155

Storm Sewer Profiles

PROJECT NUMBER
SWC-2015-02

REVISIONS	
#	DATE
2	7/10/2018
1	1/31/2018
0	11/15/2017
DESCRIPTION	DATE
REVISED NOTES AND DETAILS	
REVISED NOTES AND DETAILS	
ORIGINAL SUBMITTAL	

CERTIFICATION
**FOR BIDDING
PURPOSES ONLY;
NOT FOR
CONSTRUCTION;
SEE SIGNED
HARDCOPY**

ISSUE DATE
7/10/2018

SCALE
VARIES

SHEET NUMBER

5 OF 9

NOTES:

1. BOX CULVERTS SHALL BE PRECAST REINFORCED CONCRETE, DESIGNED FOR LESS THAN 2.0 FEET OF COVER, AND SHALL MEET ASTM C-1433 (LATEST REVISION).
2. STORM SEWER PIPE SHALL BE CLASS III REINFORCED CONCRETE PIPE (RCP), AND INSTALLED ACCORDING TO GDOT STANDARDS AND SPECIFICATIONS.
3. STORM SEWER STRUCTURES SHALL BE EITHER REINFORCED CONCRETE OR BRICK, AND CONSTRUCTED ACCORDING TO GDOT STANDARDS AND SPECIFICATIONS.
4. CONTRACTOR SHALL PROVIDE TEMPORARY STREAM DIVERSION AND DEWATERING MEASURES THROUGHOUT CONSTRUCTION OF STORM SEWER AND WALL STRUCTURES. CONTRACTOR SHALL PROVIDE SHOP DRAWINGS AND SPECIFICATIONS OF SUCH MEASURES PRIOR TO INSTALLATION.

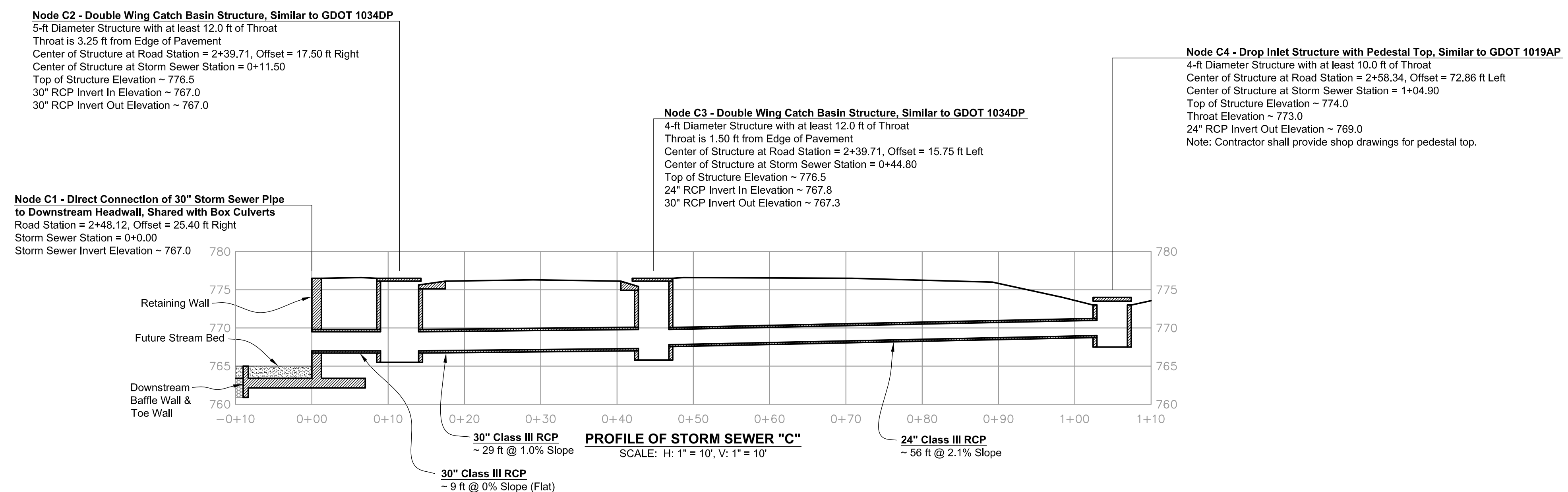
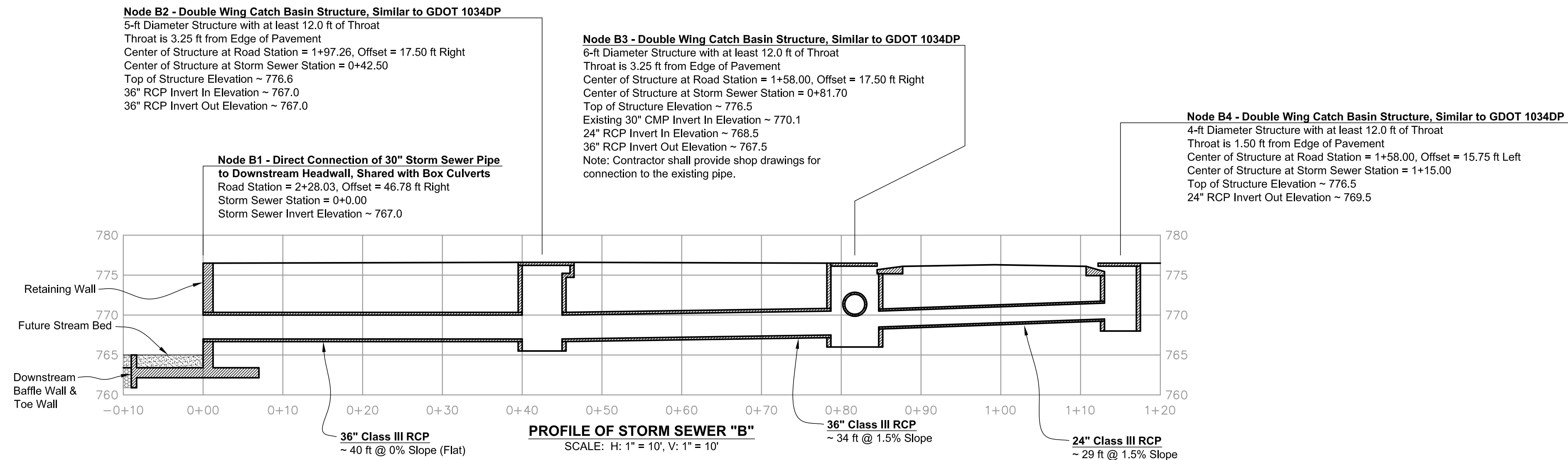
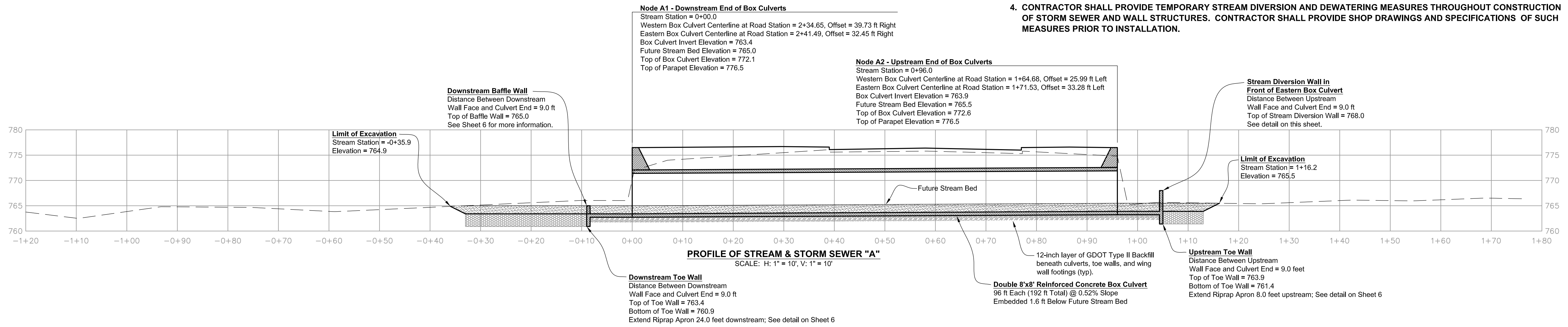

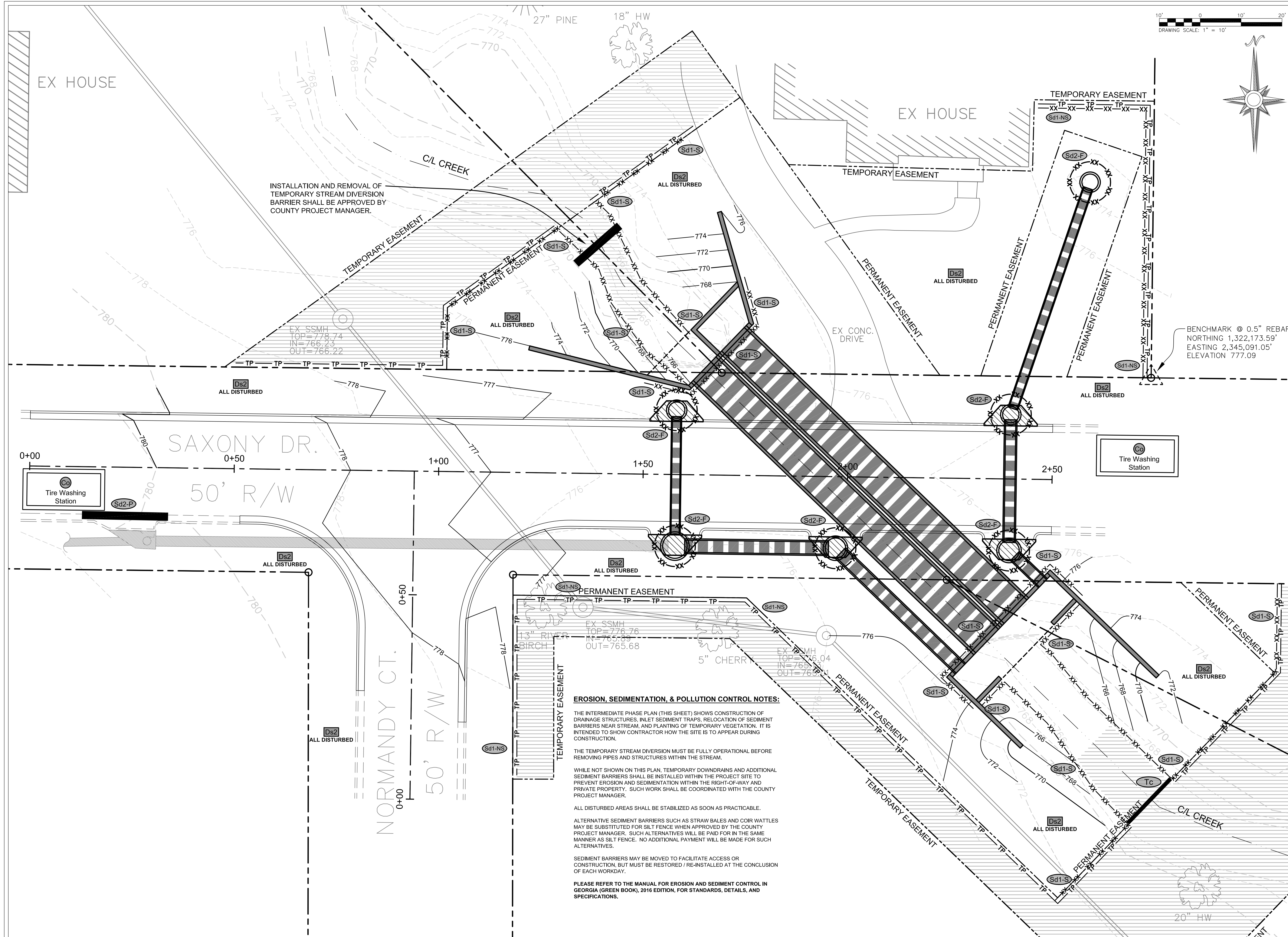

10' 0 10' 20'
DRAWING SCALE: 1" = 10'

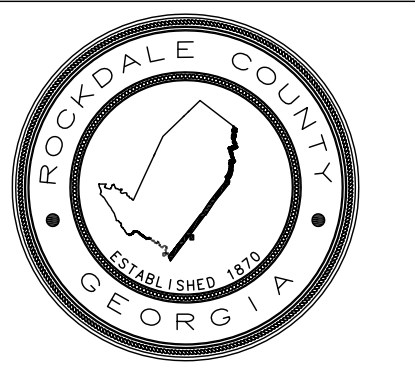
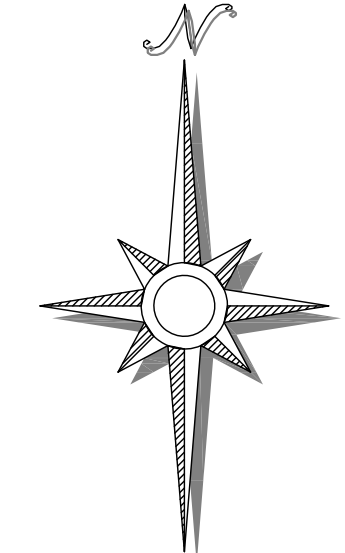

**ROCKDALE COUNTY
STORMWATER
MANAGEMENT**
958 MILSTEAD AVENUE
CONYERS, GEORGIA 30012
PHONE: (770) 278-7155



CALL BEFORE YOU DIG!

CONSTRUCTION PLANS for
SAXONY DRIVE CULVERT REPLACEMENT
1309 Saxony Drive SE, Conyers, GA 30013 Land Lot 237, 10th District, Rockdale County
Rockdale County Dept. of Stormwater Management
958 Milstead Avenue NE, Conyers, GA 30012 Phone: 770-278-7155

ES&PC Plan - Intermediate Phase

PROJECT NUMBER
SWC-2015-02

REVISIONS

#	DATE	DESCRIPTION
2	7/10/2018	REVISED NOTES AND DETAILS
1	1/31/2018	REVISED NOTES AND DETAILS
0	11/15/2017	ORIGINAL SUBMITTAL

CERTIFICATION
**FOR BIDDING PURPOSES ONLY;
NOT FOR CONSTRUCTION;
SEE SIGNED HARDCOPY**

ISSUE DATE
7/10/2018

SCALE
1" = 10'

SHEET NUMBER
8 OF 9

EROSION, SEDIMENTATION, & POLLUTION CONTROL NOTES:

THE INTERMEDIATE PHASE PLAN (THIS SHEET) SHOWS CONSTRUCTION OF DRAINAGE STRUCTURES, INLET SEDIMENT TRAPS, RELOCATION OF SEDIMENT BARRIERS NEAR STREAM, AND PLANTING OF TEMPORARY VEGETATION. IT IS INTENDED TO SHOW CONTRACTOR HOW THE SITE IS TO APPEAR DURING CONSTRUCTION.

THE TEMPORARY STREAM DIVERSION MUST BE FULLY OPERATIONAL BEFORE REMOVING PIPES AND STRUCTURES WITHIN THE STREAM.

WHILE NOT SHOWN ON THIS PLAN, TEMPORARY DOWNDRAINS AND ADDITIONAL SEDIMENT BARRIERS SHALL BE INSTALLED WITHIN THE PROJECT SITE TO PREVENT EROSION AND SEDIMENTATION WITHIN THE RIGHT-OF-WAY AND PRIVATE PROPERTY. SUCH WORK SHALL BE COORDINATED WITH THE COUNTY PROJECT MANAGER.

ALL DISTURBED AREAS SHALL BE STABILIZED AS SOON AS PRACTICABLE.

ALTERNATIVE SEDIMENT BARRIERS SUCH AS STRAW BALES AND COIR WATTLES MAY BE SUBSTITUTED FOR SILT FENCE WHEN APPROVED BY THE COUNTY PROJECT MANAGER. SUCH ALTERNATIVES WILL BE PAID FOR IN THE SAME MANNER AS SILT FENCE. NO ADDITIONAL PAYMENT WILL BE MADE FOR SUCH ALTERNATIVES.

SEDIMENT BARRIERS MAY BE MOVED TO FACILITATE ACCESS OR CONSTRUCTION, BUT MUST BE RESTORED / RE-INSTALLED AT THE CONCLUSION OF EACH WORKDAY.

PLEASE REFER TO THE MANUAL FOR EROSION AND SEDIMENT CONTROL IN GEORGIA (GREEN BOOK), 2016 EDITION, FOR STANDARDS, DETAILS, AND SPECIFICATIONS.

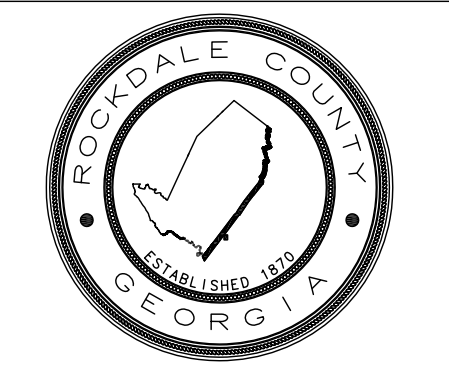
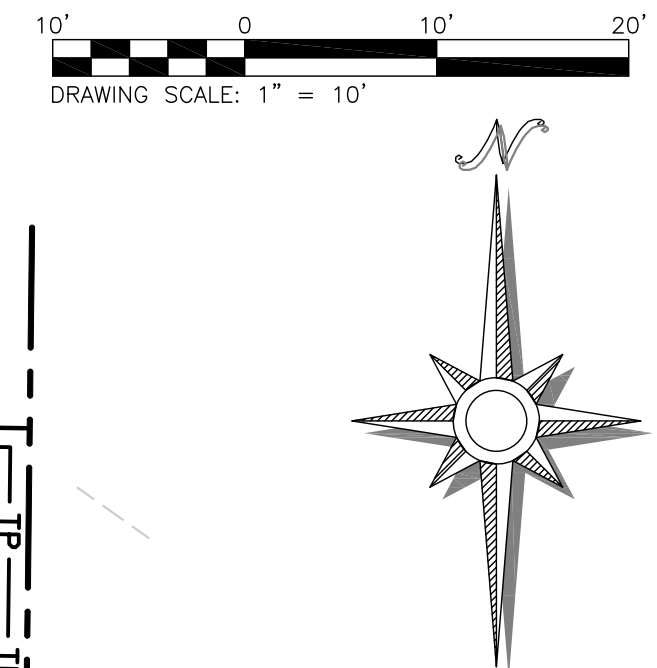
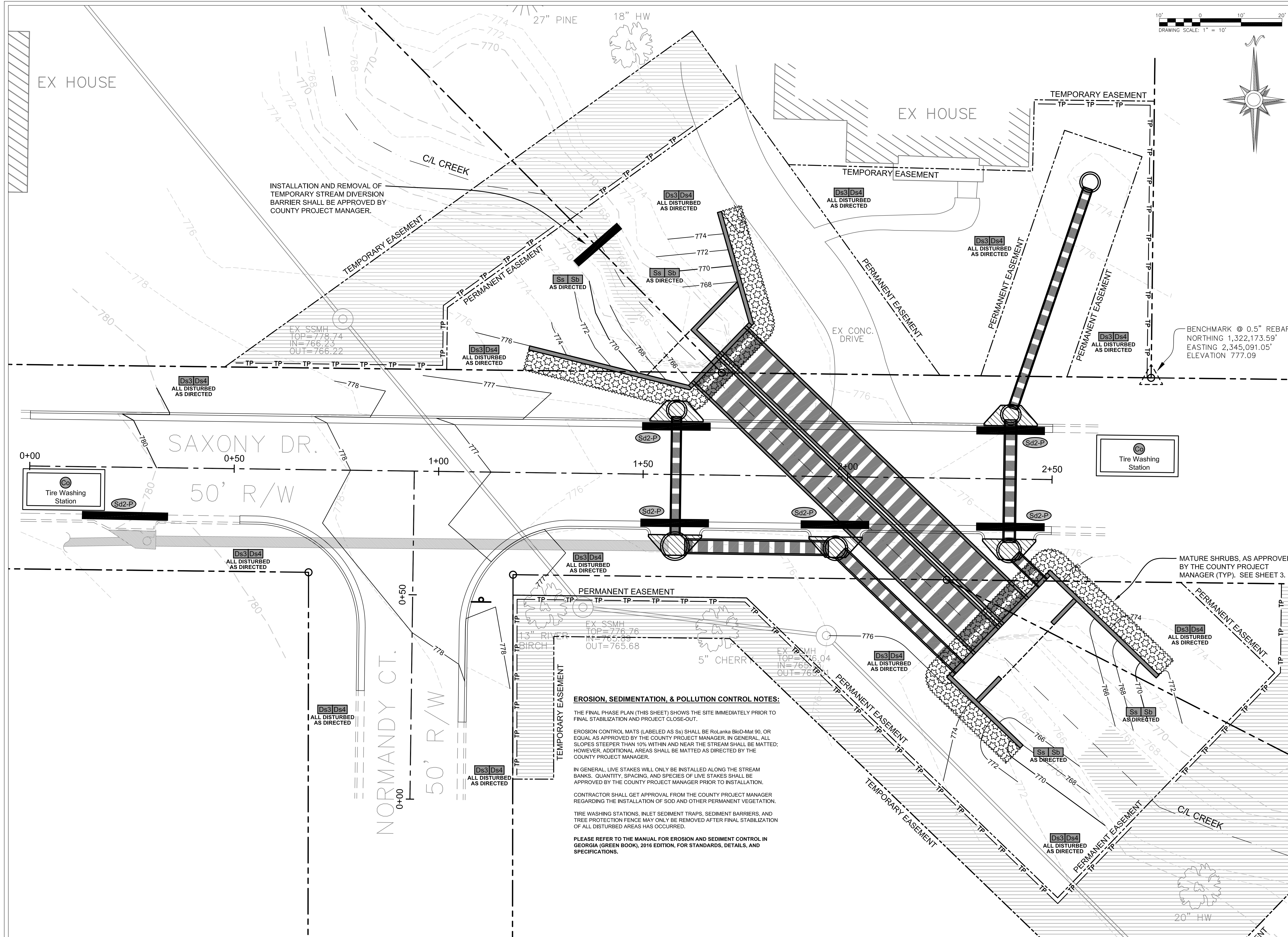

**ROCKDALE COUNTY
STORMWATER
MANAGEMENT**
958 MILSTEAD AVENUE
CONYERS, GEORGIA 30012
PHONE: (770) 278-7155



CALL BEFORE YOU DIG!

CONSTRUCTION PLANS for
SAXONY DRIVE CULVERT REPLACEMENT
1309 Saxony Drive SE, Conyers, GA 30013 Land Lot 237, 10th District, Rockdale County
Rockdale County Dept. of Stormwater Management
958 Milstead Avenue NE, Conyers, GA 30012 Phone: 770-278-7155

PROJECT NUMBER
SWC-2015-02

REVISIONS

#	DESCRIPTION	DATE
2	REVISED NOTES AND DETAILS	7/10/2018
1	REVISED NOTES AND DETAILS	1/31/2018
0	ORIGINAL SUBMITTAL	11/15/2017

CERTIFICATION
**FOR BIDDING
PURPOSES ONLY;
NOT FOR
CONSTRUCTION;
SEE SIGNED
HARDCOPY**

ISSUE DATE
7/10/2018

SCALE
1" = 10'

SHEET NUMBER
9 OF 9

EROSION, SEDIMENTATION, & POLLUTION CONTROL NOTES:

THE FINAL PHASE PLAN (THIS SHEET) SHOWS THE SITE IMMEDIATELY PRIOR TO FINAL STABILIZATION AND PROJECT CLOSE-OUT.

EROSION CONTROL MATS (LABELED AS Ss) SHALL BE RolAnka BioMat 90, OR EQUAL AS APPROVED BY THE COUNTY PROJECT MANAGER. IN GENERAL, ALL SLOPES STEEPER THAN 10% WITHIN AND NEAR THE STREAM SHALL BE MATTED; HOWEVER, ADDITIONAL AREAS SHALL BE MATTED AS DIRECTED BY THE COUNTY PROJECT MANAGER.

IN GENERAL LIVE STAKES WILL ONLY BE INSTALLED ALONG THE STREAM BANKS. QUANTITY, SPACING, AND SPECIES OF LIVE STAKES SHALL BE APPROVED BY THE COUNTY PROJECT MANAGER PRIOR TO INSTALLATION.

CONTRACTOR SHALL GET APPROVAL FROM THE COUNTY PROJECT MANAGER REGARDING THE INSTALLATION OF SOD AND OTHER PERMANENT VEGETATION.

TIRE WASHING STATIONS, INLET SEDIMENT TRAPS, SEDIMENT BARRIERS, AND TREE PROTECTION FENCE MAY ONLY BE REMOVED AFTER FINAL STABILIZATION OF ALL DISTURBED AREAS HAS OCCURRED.

PLEASE REFER TO THE MANUAL FOR EROSION AND SEDIMENT CONTROL IN GEORGIA (GREEN BOOK), 2016 EDITION, FOR STANDARDS, DETAILS, AND SPECIFICATIONS.