

Geocortex Essentials Parcel Report

Cherokee County, GA

TIN: 03N22 008

Report generated 10/18/2017 1:58:54 PM

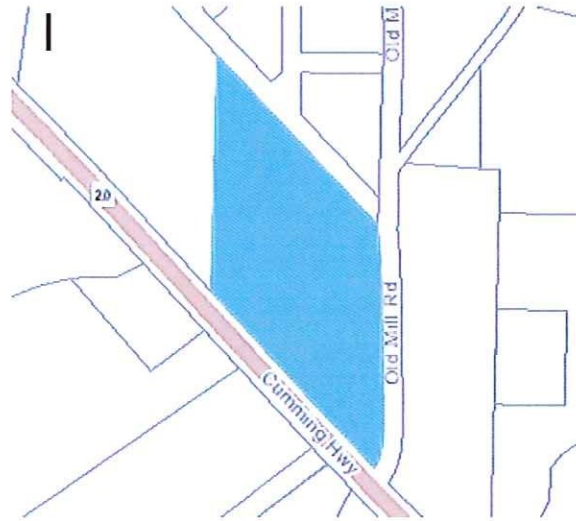
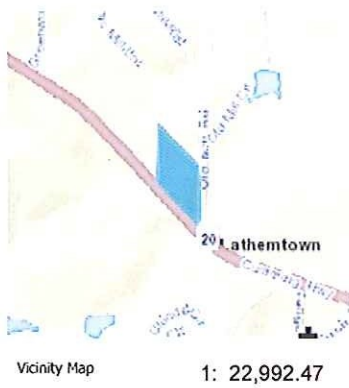

Tax Parcel Information

TIN: 03N22 008

PIN: 03-0840-0003

Owner: CHEROKEE COUNTY GOVERNMENT

Billing Address: 1130 BLUFFS PW CANTON, GA 30114

Acreage: 6.14

Exhibit "A"

All that tract or parcel of land lying and being in Land Lot 840 of the 3rd District, 2nd Section, Cherokee County, Georgia, containing 6.14 acres according to a boundary survey for Laverne Ledbetter dated August 7, 2002, prepared by Wikle Land Surveying, P.C., David E. Mitchell, G.R.L.S. 2665, said tract being more particularly described as according to said survey as follows:

Beginning at a point located at the intersection of the northeasterly right of way line of Georgia Highway No. 20 (100' R/W) with the westerly right of way line of Old Mill Road (50' R/W) and run thence along said right of way line of Georgia Highway No. 20, north 44 degrees 16 minutes 00 seconds west a distance of 192.51 feet to a point; continuing along said right of way line, run thence north 43 degrees 42 minutes 35 seconds west a distance of 291.43 feet to a point; continuing along said right of way line, run thence north 43 degrees 54 minutes 25 seconds west a distance of 130.66 feet to a point; leaving the aforesaid right of way line, run thence north 03 degrees 09 minutes 45 seconds east a distance of 577.39 feet to a point (said point also being located south 45 degrees 05 minutes 55 seconds east a distance of 1254.65 feet from an iron pin set at the common corner to Land Lots 816, 817, 840 and 841); run thence south 45 degrees 05 minutes 55 seconds east a distance of 594.61 feet to a point marked by an iron pin set located on the westerly right of way line of Old Mill Road; run thence along said right of way line of Old Mill Road, south 01 degree 18 minutes 25 seconds east a distance of 241.71 feet to a point; continuing along said right of way line, run thence south 04 degrees 40 minutes 25 seconds west a distance of 280.66 feet to a point; continuing along said right of way line, run thence south 06 degrees 47 minutes 50 seconds west a distance of 78.61 feet to a point located at the intersection of the aforesaid right of way line with the northeasterly right of way line of Georgia Highway No. 20, said point being the true place or point of beginning.