

CITY OF FOLEY

COUNTY ROAD 12

STORMWATER CHANNEL IMPROVEMENTS

MAYOR
JOHN E. KONIAR

COUNCIL
J. WAYNE TRAWICK
COUNCIL PRESIDENT
DISTRICT 1

VERA J. QUITES
DISTRICT 2

RALPH G. HELLMICH
COUNCIL VICE PRESIDENT
DISTRICT 3

C. RICK BLACKWELL
DISTRICT 4

CHARLIE J. EBERT III
DISTRICT 5

CITY ADMINISTRATOR
MICHAEL L. THOMPSON

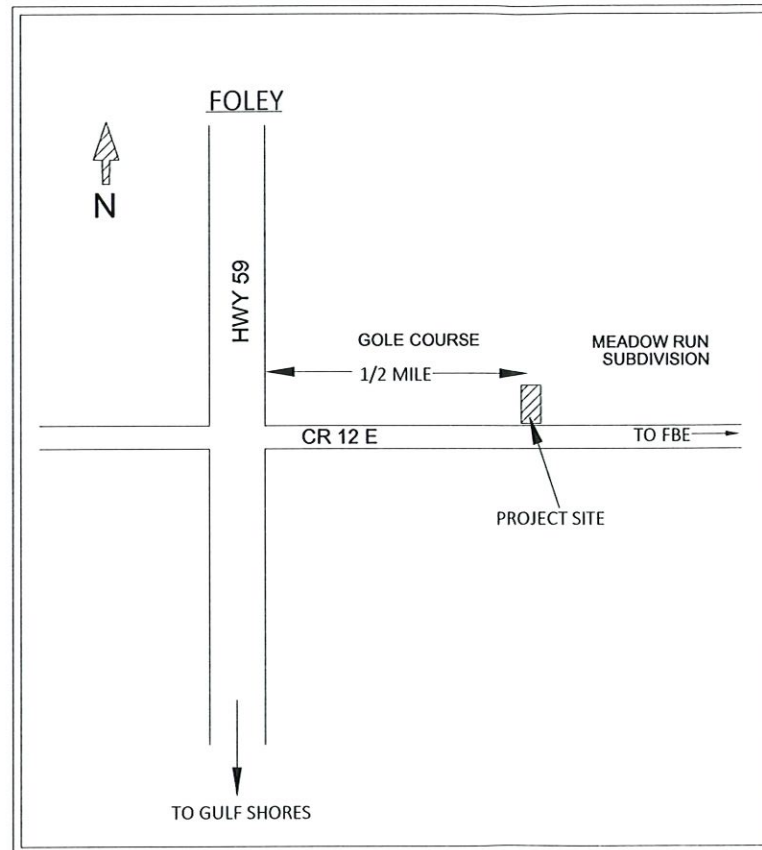

SHEET	DESCRIPTION	TITLE
DWG-01	PLAN	
DWG-02	SECTIONS	
DWG-03	SECTIONS AND DETAILS	

May 2020



 CITY ENGINEER, CITY OF FOLEY



GOLF COURSE

STA N 00+64

STORMWATER FLOW
DITCH
EXISTING SANDY BOTTOM DITCH
PLACE FILTER CLOTH AND CLASS II RIP RAP TO CHANNEL STORMWATER INTO CONCRETE DITCH

PROPERTY LINE

STA N 00+49

MEADOW RUN

STA N 00+42

STA N 00+39.50'

EXISTING WOOD FENCE
GRADE EL 46.00'
BM NAIL ON POST EL 47.87'

PROPERTY LINE

EXISTING WHITE FENCE

PROPERTY CORNER
STA W 00+00
PROPERTY CORNER

STA N 00+24

PROPERTY LINE
ROW

EXISTING BLOCK WALL OF MEADOW RUN S/D

PLACE FILTER CLOTH AND CLASS II RIP RAP TO TRANSITION FROM CONCRETE DITCH PROFILE TO EXISTING DITCH PROFILE

PROPERTY LINE
ROW

STA N 00+17.50

TOP EL 44.68'

TOP SLOPES

TOP EL 45.10'

TOP EL 44.63'

TOP EL 45.10'

TOP EL 44.63'

TOP EL 44.63'

TOP EL 44.63'

TOP EL 45.10'

TOP EL 44.63'

TOP EL 45.10'

TOP EL 44.63'

TOP EL 45.10'

TOP EL 45.10'

DITCH

THICKENED EDGE

STORMWATER FLOW

EXP JT

EXP JT

EXP JT

EXP JT

EXP JT

EXP JT

EXP JT

EXP JT

EXP JT

EXP JT

EXP JT

EXP JT

EXP JT

TOP EL 44.68'

TOP SLOPES

TOP EL 45.10'

TOP EL 45.10'

TOP EL 45.10'

TOP EL 45.10'

TOP EL 45.10'

10'-6"

SLOPE GRADE TO EDGE OF NEW CONCRETE DITCH

EOP EL 45.43'

EDGE OF PAVEMENT

EOP EL 45.47'

EOP EL 45.44'

STA N 00+00

NEW HEADWALL

EXISTING 40X60 CMAP

UG PIPE

STA N 00+14

TOP EL 45.10'

CITY OF FOLEY

CR 12 STORMWATER CHANNEL IMPROVEMENTS

PLAN VIEW

May 2020

SCALE: 1/4"=1'-0"

DWG -01

REV

TO HWY 59

STA W 00+75

CR 12

STA W 00+50

PLAN VIEW
SCALE: 1/4"=1'-0"

STA W 00+25

TO FBE

STA W 00+00

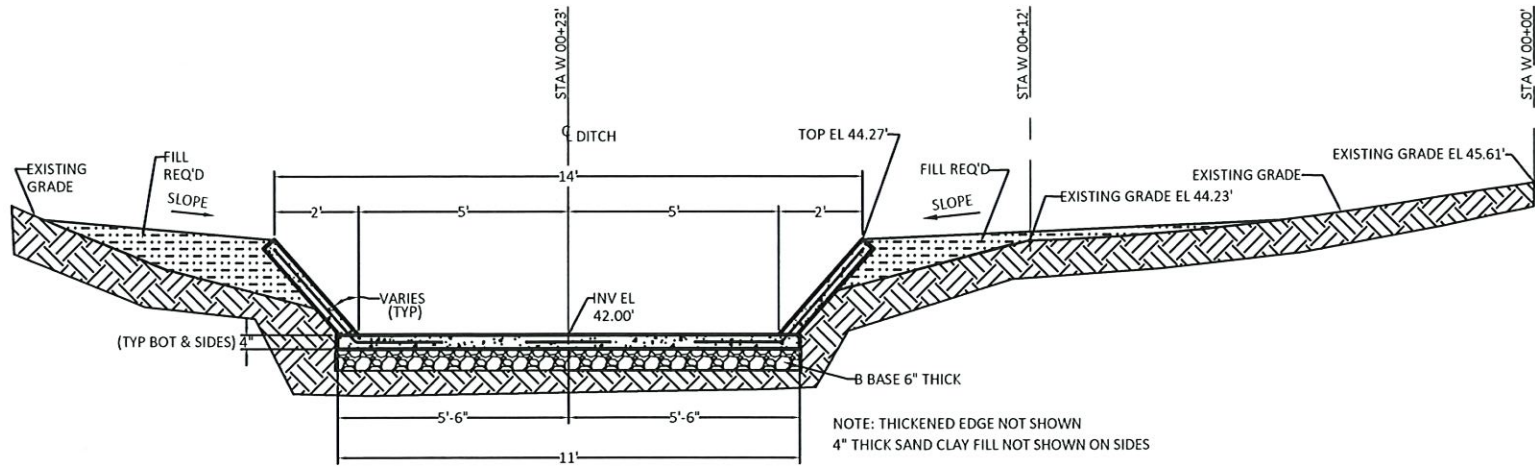

STA N 00+40
LOOKING NORTH
SCALE: 1/2" = 1'-0"

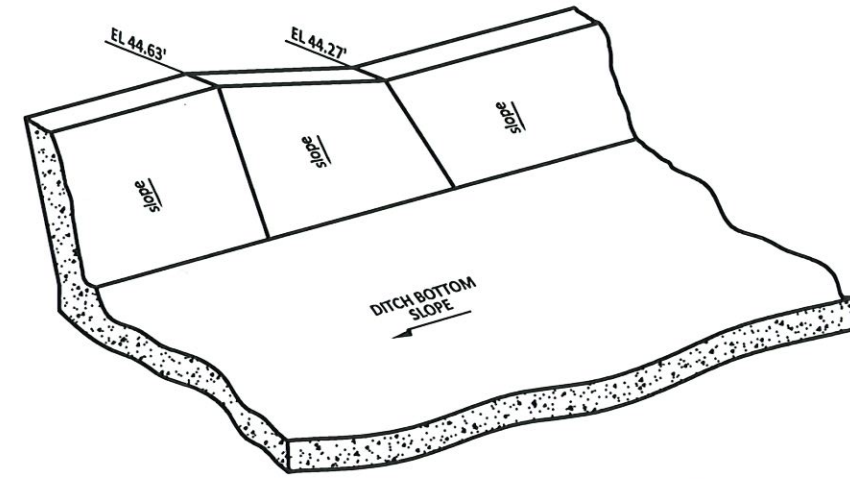

SECTION/VIEW "C-C"
LOOKING WEST
N T S

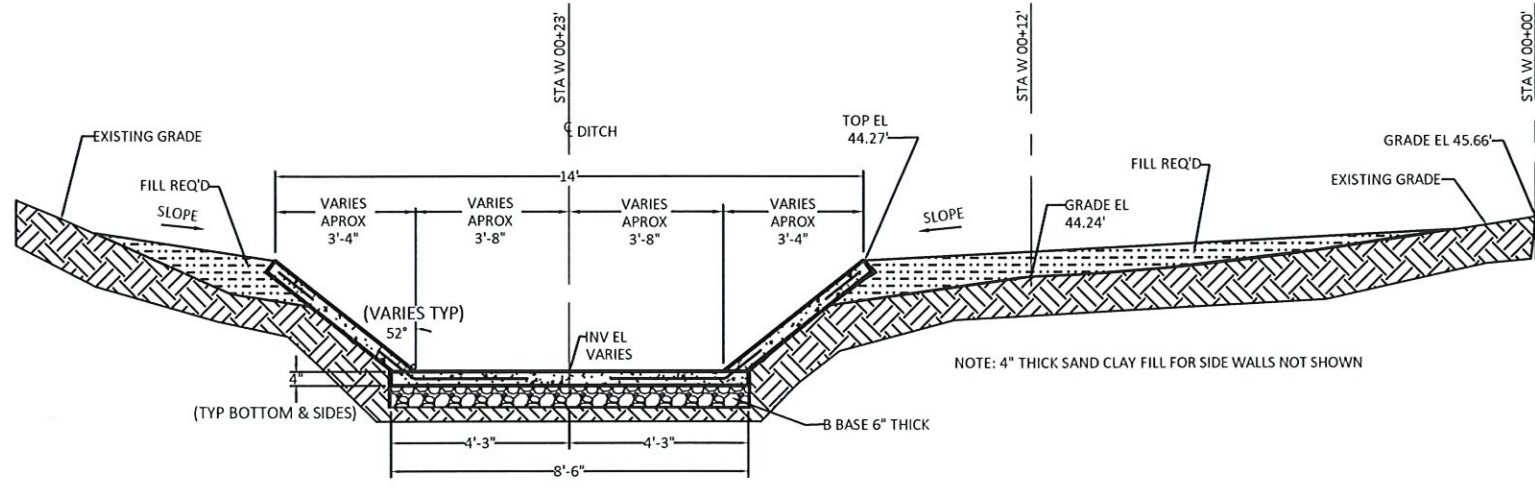

SECTION "A-A" AT STA N 00+15.50
LOOKING NORTH
SCALE: 1/2" = 1'-0"

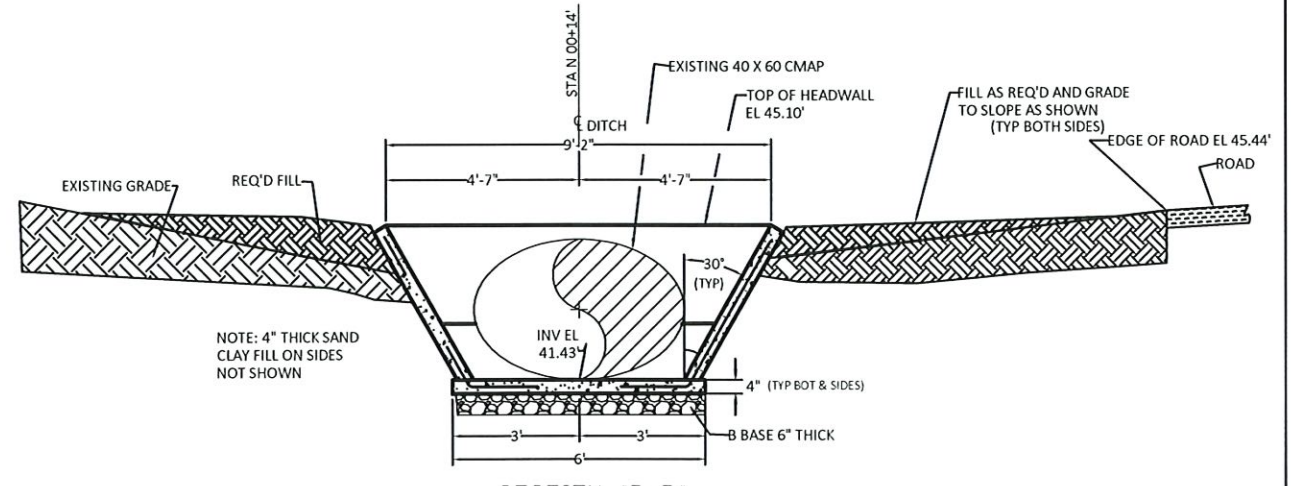

SECTION "D-D"
LOOKING EAST
SCALE: 1/2" = 1'-0"

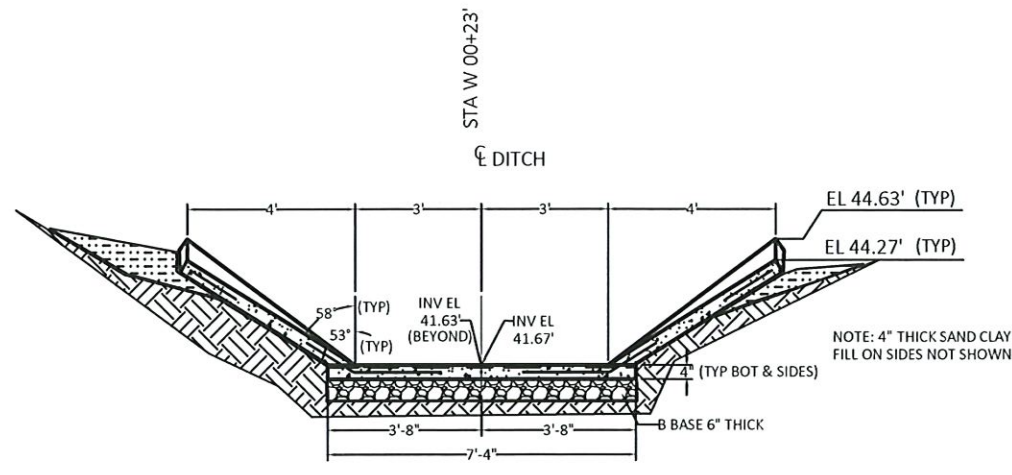

SECTION "B-B"
LOOKING NORTH
SCALE: 1/2" = 1'-0"

CITY OF FOLEY			
CR 12 STORMWATER CHANNEL IMPROVEMENTS			
SECTIONS			
May 2020	SCALE: NOTED	DWG -02	REV

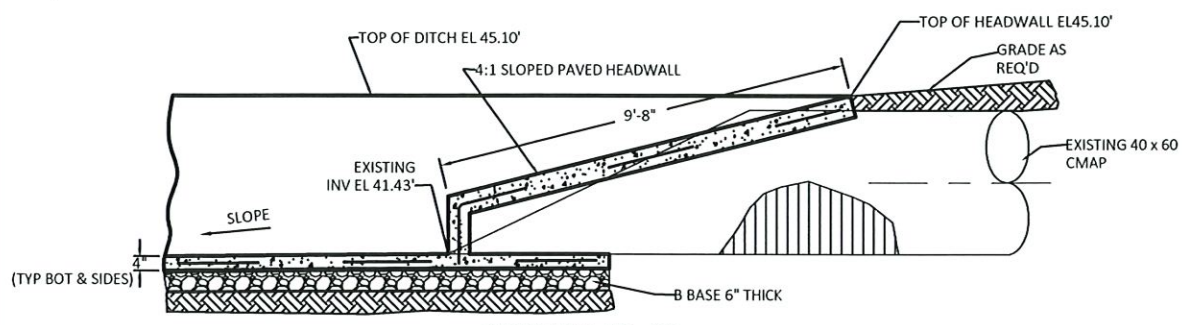

SECTION "E-E"
LOOKING NORTH
SCALE: 1/2" = 1'-0"

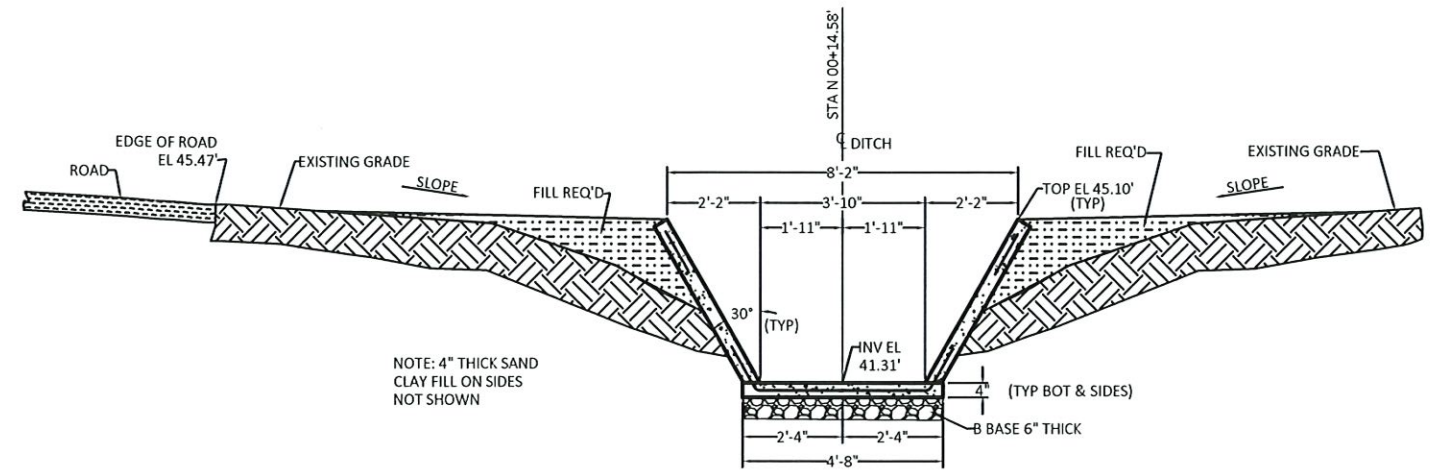

NOTE: 4" THICK SAND CLAY FILL ON SIDES NOT SHOWN

STA W 00+25
SCALE: 1/2" = 1'-0"
LOOKING WEST

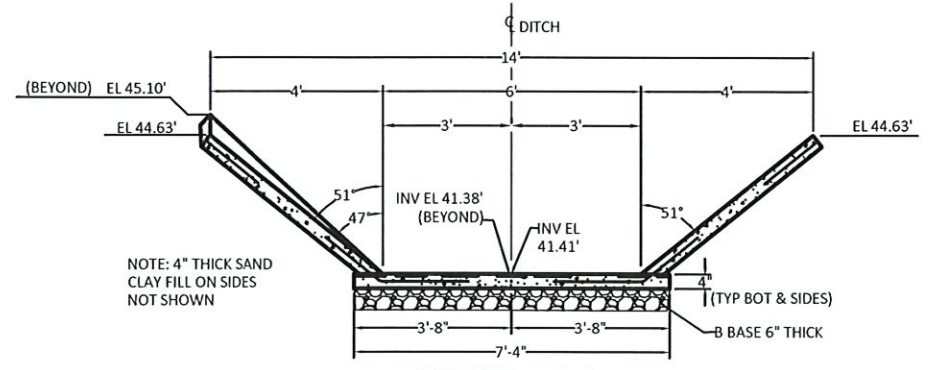

NOTE: 4" THICK SAND CLAY FILL ON SIDES NOT SHOWN

SECTION "F-F"
LOOKING WEST
SCALE: 1/2" = 1'-0"

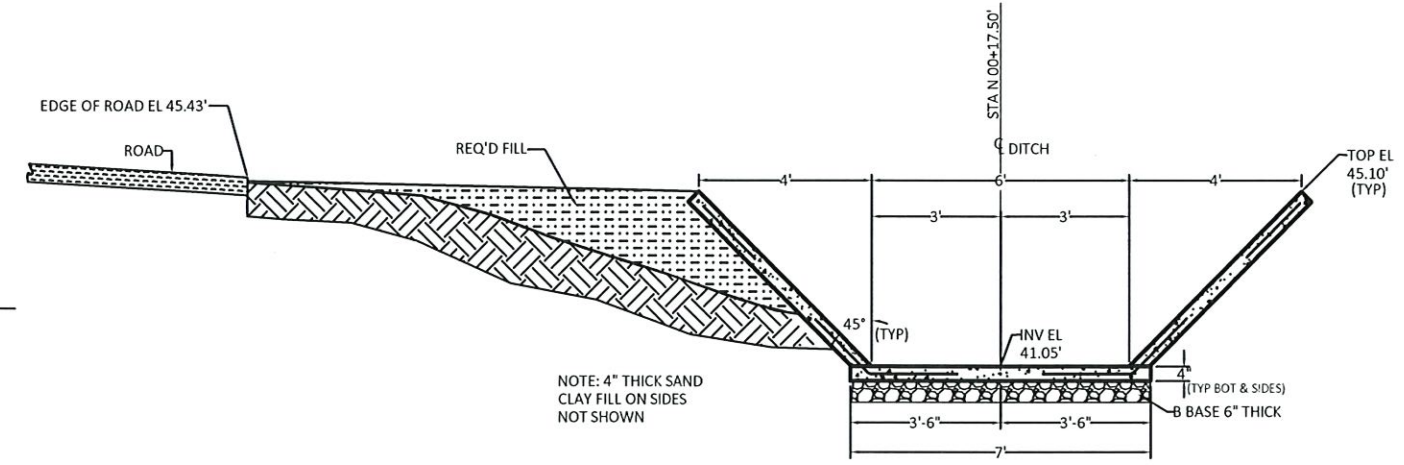

NOTE: 4" THICK SAND CLAY FILL ON SIDES NOT SHOWN

STA W 00+50
LOOKING WEST
SCALE: 1/2" = 1'-0"

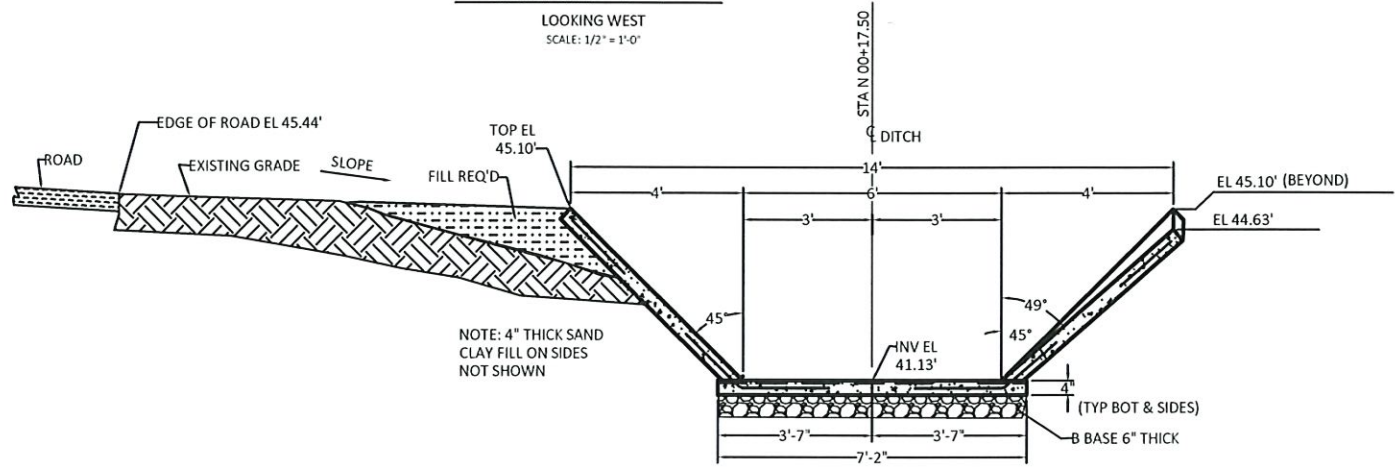

NOTE: 4" THICK SAND CLAY FILL ON SIDES NOT SHOWN

SECTION "G-G"
LOOKING NORTH
SCALE: 1/2" = 1'-0"

- GENERAL NOTES:
1. ALL EXPOSED EDGES TO RECEIVE 1/2" X 45 DEGREES CHAMFER.
 2. CONCRETE TO ACHIEVE 95% OF 3,000PSI IN 28 DAYS.
 3. WIRE MESH REINFORCING STEEL TO BE PLACED MID-SLAB AND SUPPORTED USING WIRE OR PLASTIC CHAIRS.
 4. DITCH BOTTOM AND SIDES TO RECEIVE BROOM FINISH.

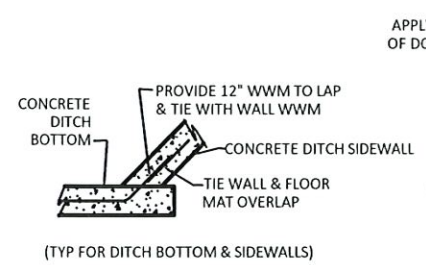

DETAIL -1
SCALE: 1" = 1'-0"

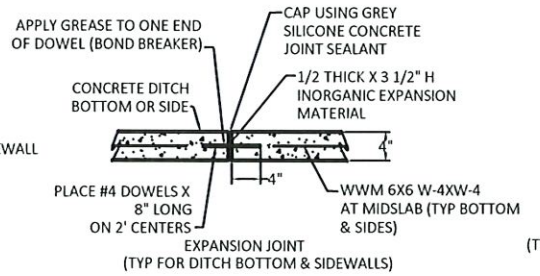

DETAIL -2
SCALE: 1" = 1'-0"

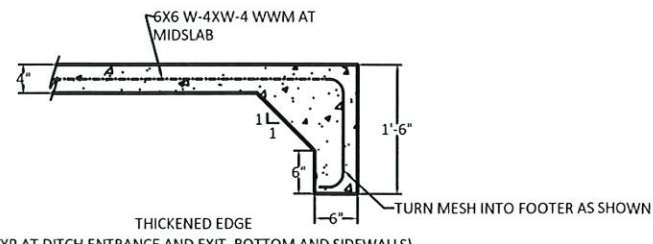

DETAIL -3
SCALE: 1" = 1'-0"

CITY OF FOLEY			
CR 12 STORMWATER CHANNEL IMPROVEMENTS			
SECTION & DETAILS			
May 2020	SCALE: NOTED	DWG -03	REV