

# NORTH MIDDLE SCHOOL BASKETBALL COURT

## PORTAGE PUBLIC SCHOOLS

Portage, Michigan

### DESIGN TEAM

#### ARCHITECT/ENGINEER

**TowerPinkster**  
Architecture · Engineering · Interiors

242 E. KALAMAZOO AVE, SUITE 100  
KALAMAZOO, MICHIGAN 49007  
PHONE: 269.343.6133  
FAX: 269.343.6633

### REFERENCED CODES

BUILDING: 2015 MICHIGAN BUILDING CODE AND 2012 NFPA 101 LIFE SAFETY CODE  
ELECTRICAL: 2017 NATIONAL ELECTRICAL CODE WITH MICHIGAN AMENDMENTS  
BARRIER-FREE: 2015 MICHIGAN BUILDING CODE AND 2009 ICC & C A117.1

### PROJECT AREA

TOTAL FINISHED PROJECT: 0.14 AC.

### DRAWING INDEX

GENERAL  
G 001 COVER SHEET

LANDSCAPE  
L 101 LANDSCAPE LAYOUT PLAN

### SITE ADDRESS

PORTAGE PUBLIC SCHOOLS  
1110 W MILHAM AVE  
PORTAGE, MICHIGAN 49204

ISSUED FOR DATE

PROJECT TITLE  
NORTH MIDDLE SCHOOL  
BASKETBALL COURT

OWNER  
PORTAGE PUBLIC  
SCHOOLS

Portage, Michigan

SHEET TITLE  
COVER SHEET

DATE  
JANUARY 31, 2024

SHEET NUMBER  
G 001  
23-188.00

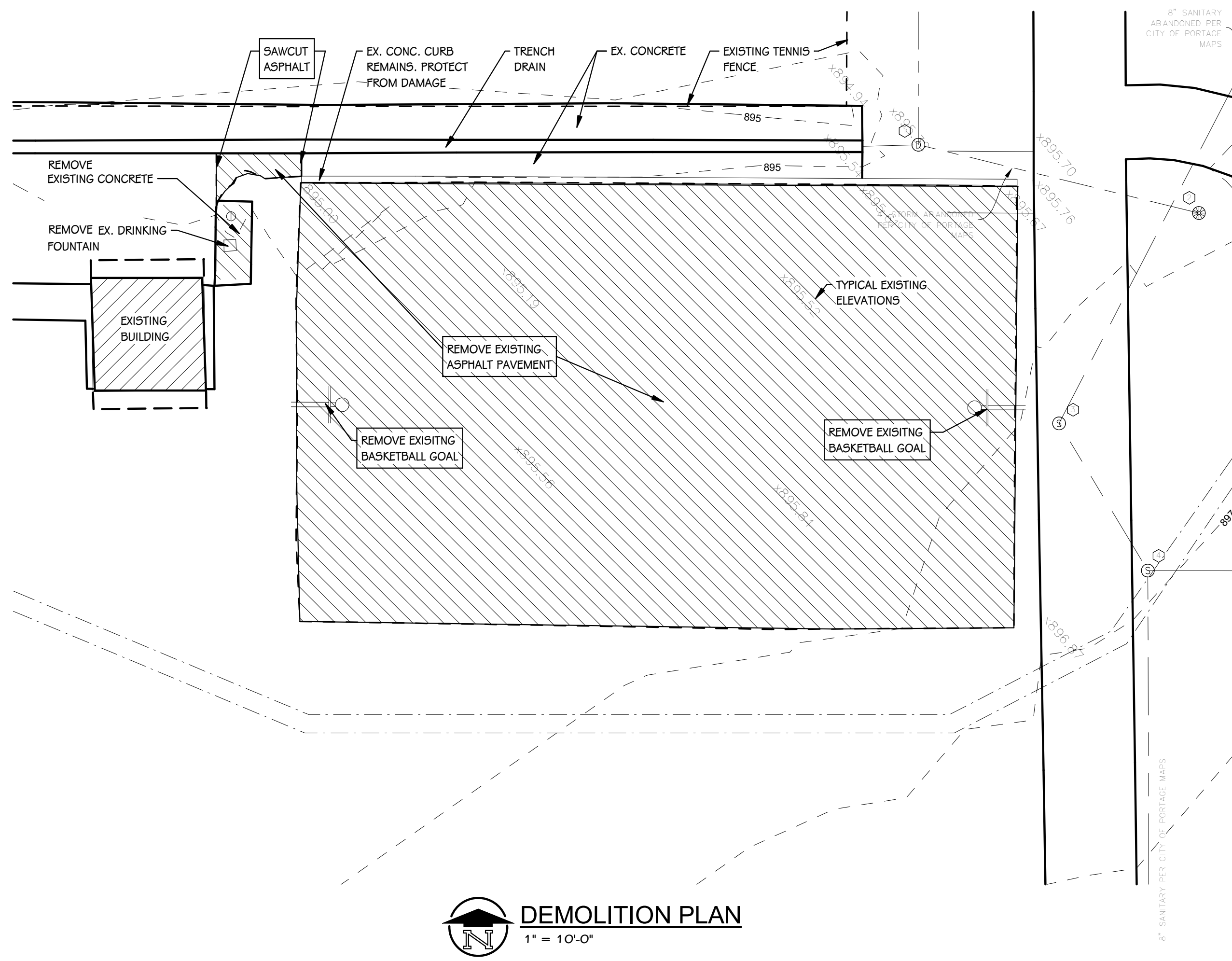

**DEMOLITION PLAN**  
1" = 10'-0"

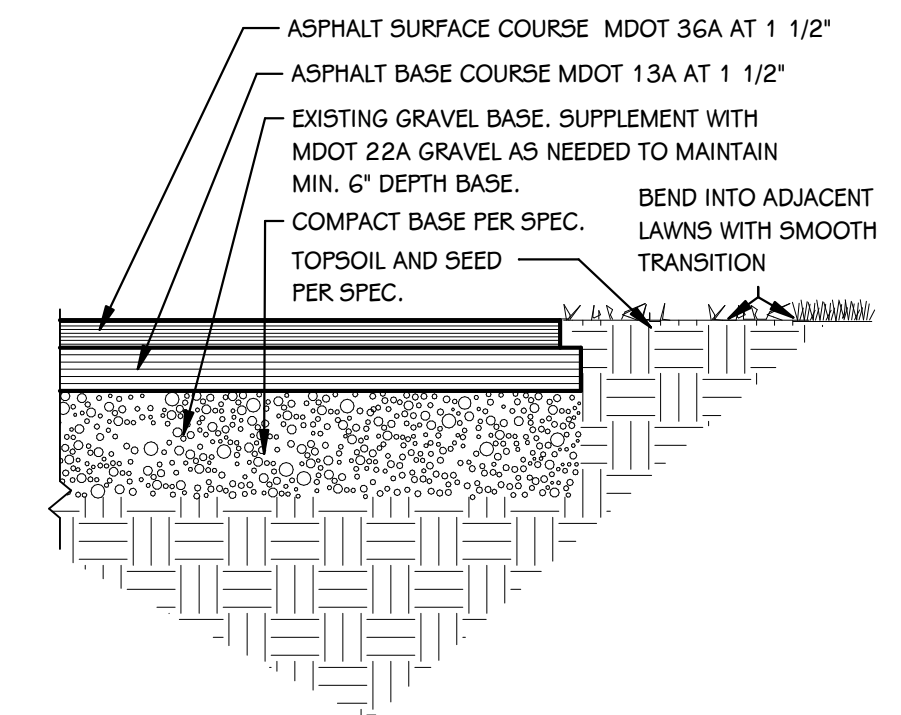

**ASPHALT PAVING DETAIL**  
3/16" = 1'-0"

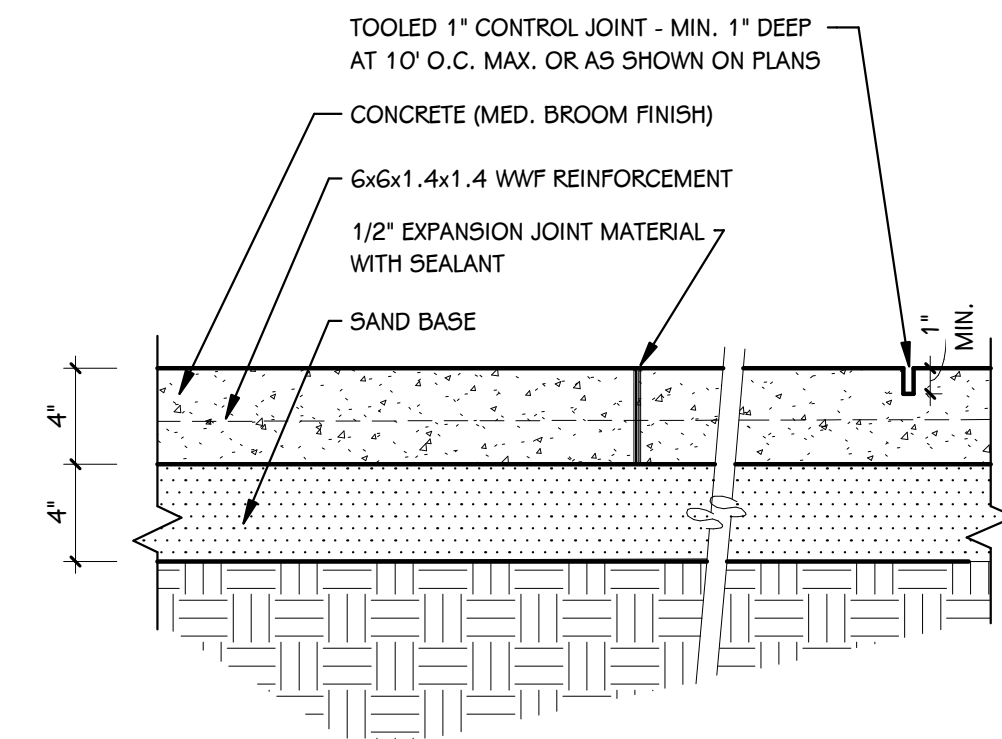

**CONCRETE PAVING DETAIL**  
1 1/2" = 1'-0"

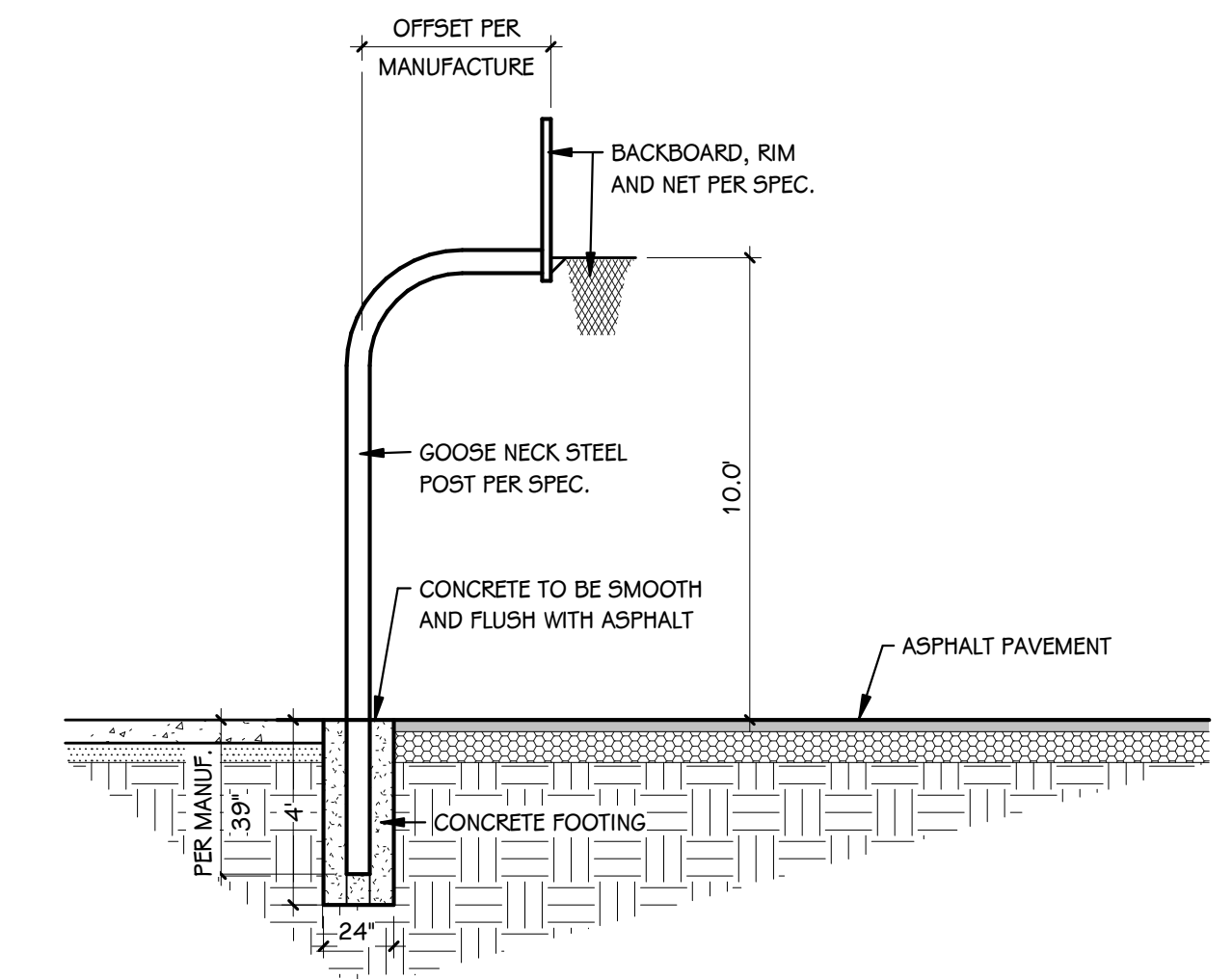

**BASKETBALL GOAL DETAIL**  
1/4" = 1'-0"

- NOTES - SITE PLAN**
1. CALL "MISS DIG" AND HAVE EXISTING UTILITY LOCATIONS MARKED PRIOR TO ANY EXCAVATIONS OR INSTALLATIONS ON SITE.
  2. EXISTING INFORMATION SHOWN HEREIN IS APPROXIMATE AND MUST BE FIELD VERIFIED PRIOR TO THE COMMENCEMENT OF ANY CONSTRUCTION ACTIVITY.
  3. ALL EXISTING INFORMATION SHOWN IS FROM THE SITE TOPOGRAPHIC SURVEY PRODUCED BY HURLEY STEWART ENG., KALAMAZOO, MICHIGAN. SEE SHEET T5 001 FOR THE COMPLETE TOPOGRAPHIC SURVEY, EXISTING CONDITIONS AND ADDITIONAL INFORMATION.
  4. PROTECT ALL EXISTING PAVEMENT, STRUCTURES, FENCING AND UTILITIES TO REMAIN. DO NOT SCAR EXISTING PAVEMENTS.
  5. SEED AND TOPSOIL ALL DISTURBED AREAS AS STATED IN THE SPECIFICATIONS. RAKE INTO ADJACENT LAWN AREAS WITH SMOOTH TRANSITION.

ISSUED FOR \_\_\_\_\_ DATE \_\_\_\_\_

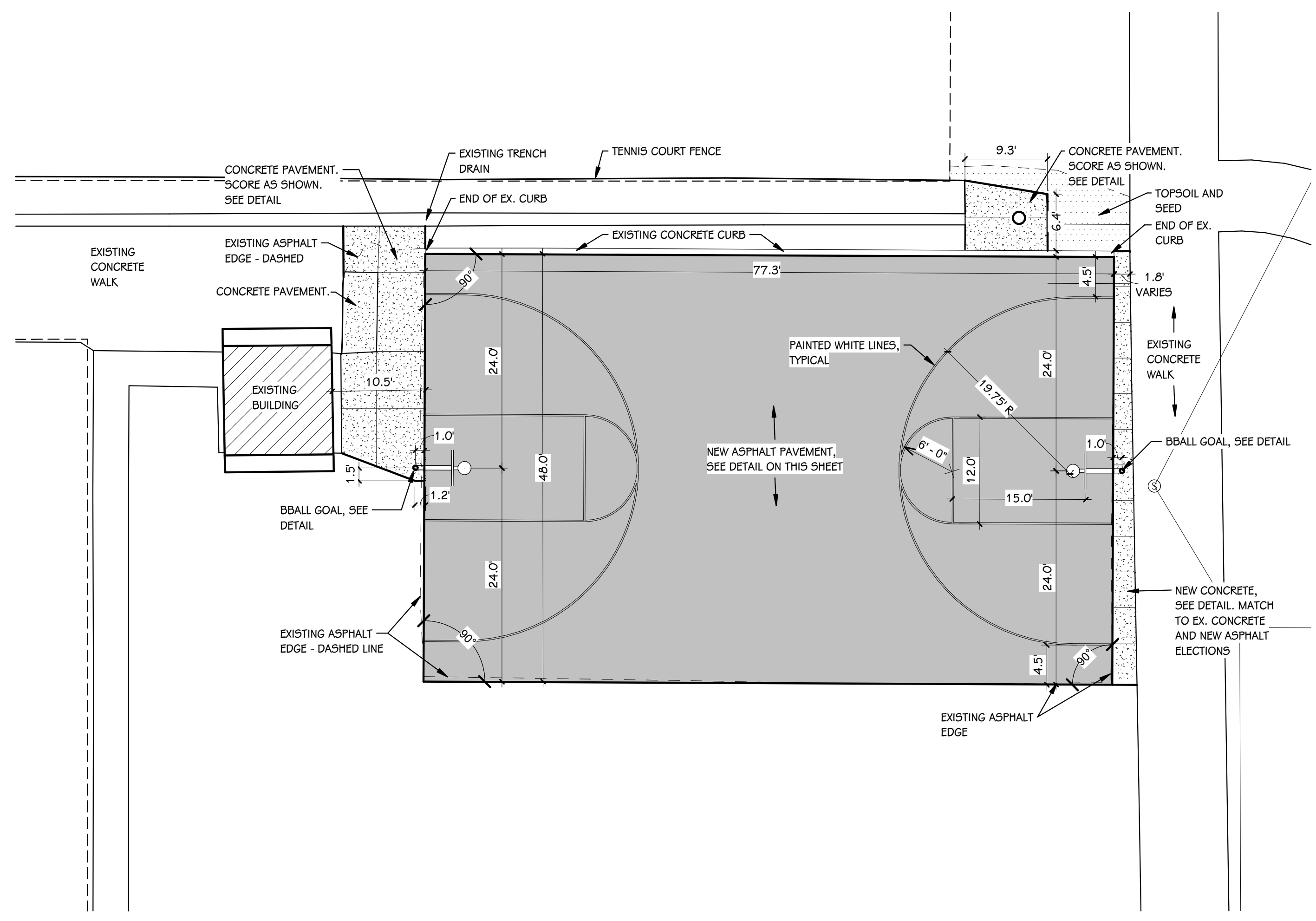

**LAYOUT PLAN**  
1" = 10'-0"

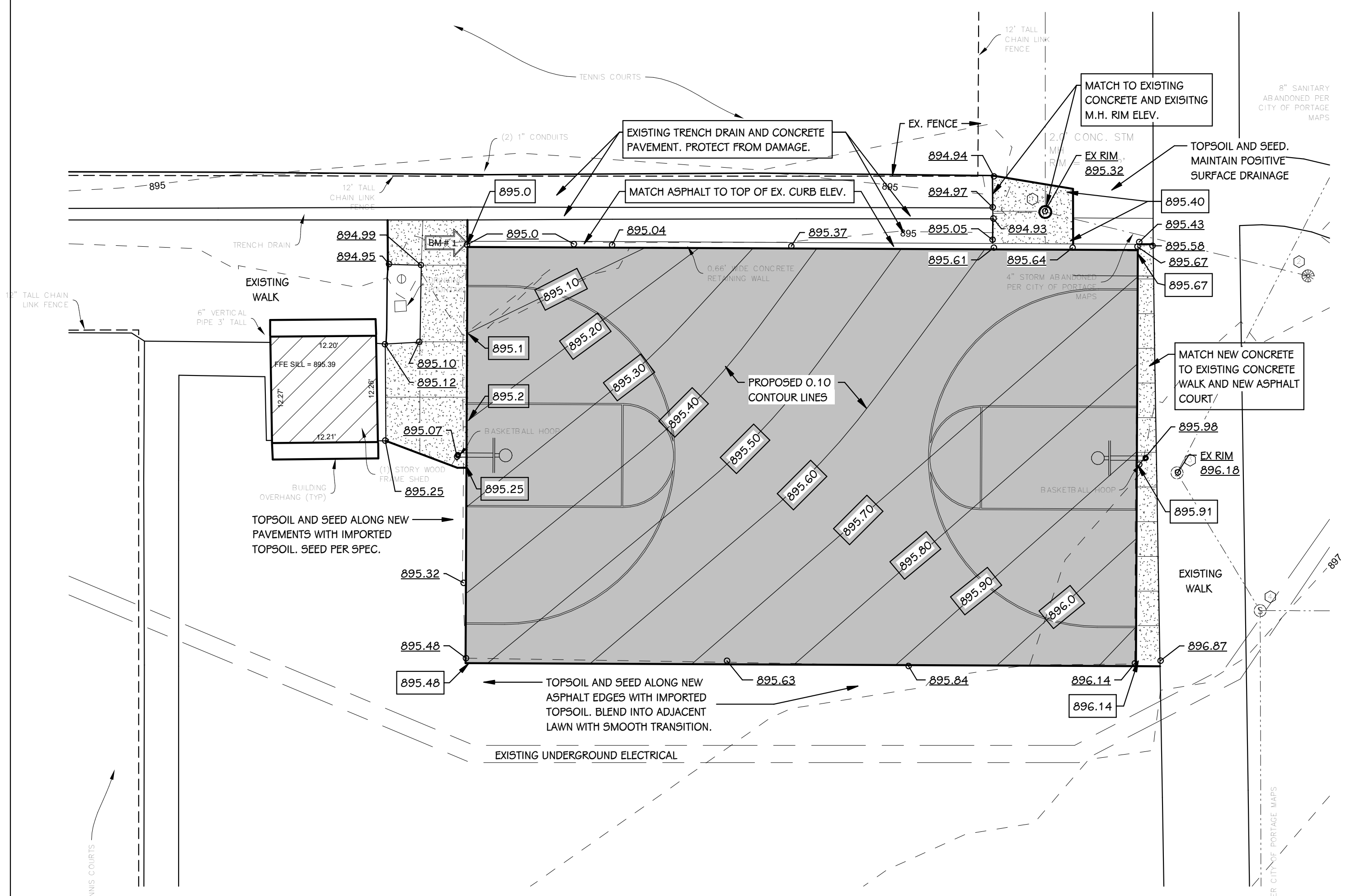

**GRADING PLAN**  
1" = 10'-0"

PROJECT TITLE  
NORTH MIDDLE SCHOOL  
BASKETBALL COURT

OWNER  
PORTAGE PUBLIC  
SCHOOLS

SHEET TITLE  
LANDSCAPE LAYOUT PLAN

Portage, Michigan

DATE  
JANUARY 31, 2024

SHEET NUMBER  
**L 101**  
23-188.00