

B2021 (2007)  
8,594 SF

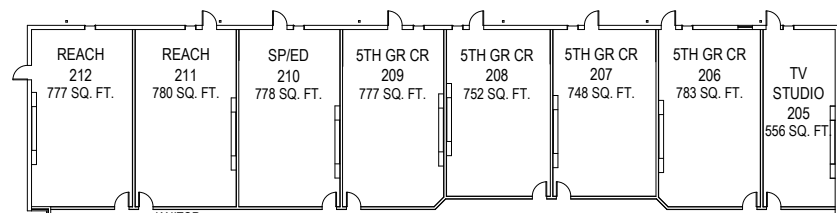

B2020 (1994)  
21,883 SF

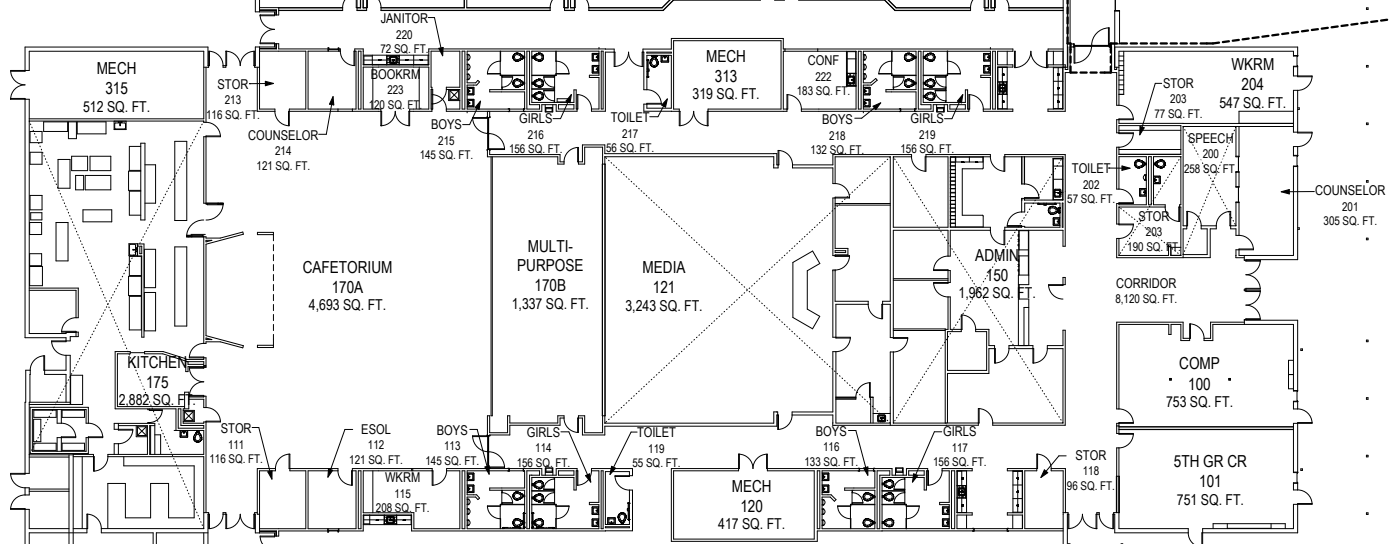

B2010 (1971)  
42,656 SF

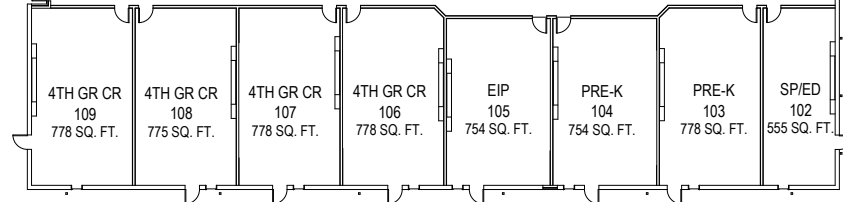

**BIBB COUNTY SCHOOL DISTRICT  
SPRINGDALE ELEMENTARY SCHOOL**

FACILITY NUMBER:	1105
INSTRUCTIONAL UNITS:	42
FTE:	650
SITE ACREAGE:	20
AREA:	
MAIN BUILDING:	73,113 SF
EXTERIOR COVERED @ 1/2":	3,391 SF
TOTAL:	76,504 SF

SCALE: 1" = 40'