

MLK PARK IMPROVEMENTS

IRRIGATION AND RESTROOM BUILDING

PREPARED FOR:
SPRINGFIELD, TENNESSEE



LOBE & ASSOCIATES, INC
1314 5th Avenue North, Suite 200
Nashville, Tennessee 37208
(615) 242-0040

220 West Cogan Street, Suite 100
Lawrenceville, Georgia 30046
(770) 338-0017

www.lobeassoc.com

THIS DRAWING AND THE DESIGN SHOWN IS THE PROPERTY OF THE ARCHITECT. REPRODUCTION, COPYING, OR USE OF THIS DRAWING WITHOUT THEIR WRITTEN CONSENT IS PROHIBITED AND ANY INFRINGEMENT IS SUBJECT TO LEGAL ACTION.

SHEET INDEX

C0.00	COVER SHEET
L2.00	IRRIGATION PLAN
L2.10	IRRIGATION NOTES/SCHEDULE
L2.11	IRRIGATION DETAILS

OWNER/DEVELOPER

CITY OF SRINGFIELD
401 NORTH MAIN STREET
SPRINGFIELD, TENNESSEE 37172
(615) 382-1655



DESIGNER

LOSE & ASSOCIATES, INC
LANDSCAPE ARCHITECTURE/ARCHITECTURE/CIVIL
ENGINEERING/PLANNING

1314 5TH AVENUE NORTH, SUITE 200
NASHVILLE, TENNESSEE 37208
PHONE: 615-242-0040
CONTACT: LEE DAVIDSON

UTILITIES

SPRINGFIELD WATER & WASTE WATER DEPARTMENT
924 CENTRAL AVENUE WEST
SPRINGFIELD, TENNESSEE 37172
(615) 384-1600

SPRINGFIELD ELECTRIC DEPARTMENT
1000 CENTRAL AVENUE
SPRINGFIELD, TENNESSEE 37172
(615) 384-6770

LOCATION MAP



MLK PARK IMPROVEMENTS
IRRIGATION AND RESTROOM BUILDING

PREPARED FOR:
CITY OF SPRINGFIELD PARKS DEPARTMENT

SPRINGFIELD
TENNESSEE

REVISIONS		
NO.	DATE	COMMENTS

SHEET TITLE

COVER SHEET

PROJECT NO. 15104	DATE 2/24/16
DRAWN BY LD	SCALE NOT TO SCALE
CHECKED BY LD	
SHEET NUMBER	

C0.00



0 West Crogan Street, Suite 100
Lawrenceville, Georgia 30046

(770) 338-0017
www.joseassoc.com

THIS DRAWING AND THE DESIGN SHOWN IS THE PROPERTY OF THE ARCHITECT. REPRODUCTION, COPYING, OR USE OF THIS DRAWING WITHOUT THEIR WRITTEN CONSENT IS PROHIBITED, AND ANY INFRINGEMENT IS SUBJECT TO LEGAL ACTION.



MARTIN LUTHER KING PARK
CITY OF SPRINGFIELD

PARKS DEPARTMENT

SPRINGFIELD

[illegible]

SHEET TITLE

IRRIGATION PLAN

PROJECT NO. 15104	DATE 10/13/15
DRAWN BY JWS	SCALE 1"=30'-0"
CHECKED BY CLC	
SHEET NUMBER	

L2.00

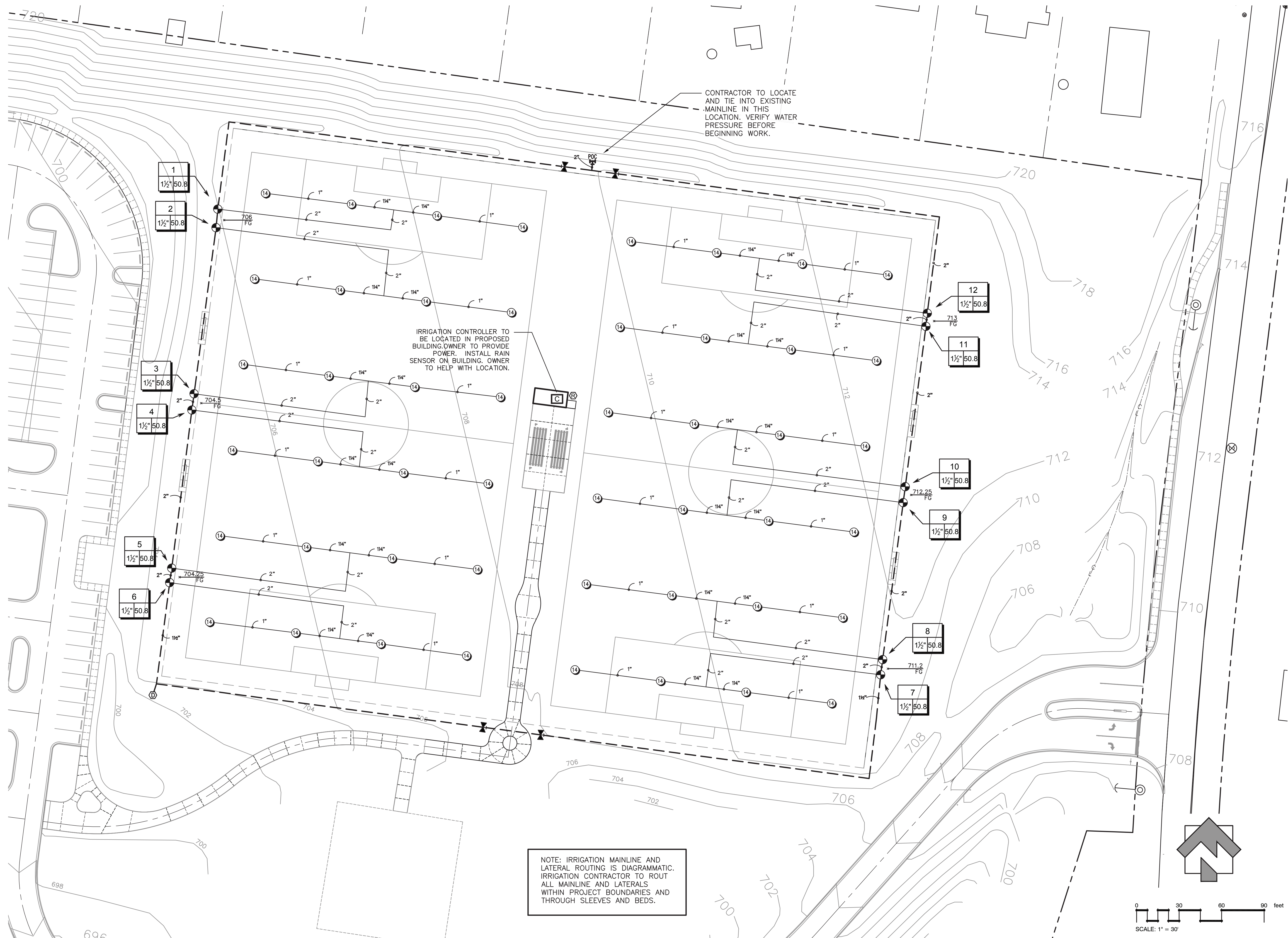

NUMBER	RAIN	BIRD	PEB	TURF	ROTOR	PRECIP	SUN	MON	TUE	WED	THU	FRI	SAT	IN./WEEK	MIN./WEEK	GAL./WEEK	GAL./DAY
1						0.33 in/h		77 min		77 min		77 min		1.25	229	11,633	3,878
2						0.33 in/h		77 min		77 min		77 min		1.25	229	11,633	3,878
3						0.34 in/h		73 min		73 min		73 min		1.25	218	11,074	3,691
4						0.35 in/h		73 min		73 min		73 min		1.25	218	11,074	3,691
5						0.33 in/h		77 min		77 min		77 min		1.25	230	11,684	3,895
6						0.33 in/h		77 min		77 min		77 min		1.25	230	11,684	3,895
7						0.33 in/h		76 min		76 min		76 min		1.25	228	11,582	3,861
8						0.33 in/h		77 min		77 min		77 min		1.25	230	11,684	3,895
9						0.35 in/h		73 min		73 min		73 min		1.25	217	11,024	3,675
10						0.35 in/h		73 min		73 min		73 min		1.25	217	11,024	3,675
11						0.33 in/h		77 min		77 min		77 min		1.25	229	11,633	3,878
12						0.33 in/h		76 min		76 min		76 min		1.25	228	11,582	3,861
						TOTALS:		906		906		906			2,703	137,312	45,771

NUMBER	MODEL	SIZE	TYPE	WIRE	PSI	PSI @ PQC	GPM	PRECIP
1	RAIN BIRD PEB	1-1/2"	TURF ROTOR	483.7	58.06	65.26	50.80	0.33 in/h
2	RAIN BIRD PEB	1-1/2"	TURF ROTOR	496.8	58.36	65.65	50.80	0.33 in/h
3	RAIN BIRD PEB	1-1/2"	TURF ROTOR	615.1	58.33	65.57	50.80	0.34 in/h
4	RAIN BIRD PEB	1-1/2"	TURF ROTOR	626.7	58.27	65.55	50.80	0.35 in/h
5	RAIN BIRD PEB	1-1/2"	TURF ROTOR	739.2	58.30	65.73	50.80	0.33 in/h
6	RAIN BIRD PEB	1-1/2"	TURF ROTOR	749.6	58.24	65.68	50.80	0.33 in/h
7	RAIN BIRD PEB	1-1/2"	TURF ROTOR	756.0	58.22	65.96	50.80	0.33 in/h
8	RAIN BIRD PEB	1-1/2"	TURF ROTOR	745.2	58.24	68.83	50.80	0.33 in/h
9	RAIN BIRD PEB	1-1/2"	TURF ROTOR	633.8	58.30	67.90	50.80	0.35 in/h
10	RAIN BIRD PEB	1-1/2"	TURF ROTOR	622.1	58.29	67.74	50.80	0.35 in/h
11	RAIN BIRD PEB	1-1/2"	TURF ROTOR	508.0	58.30	66.82	50.80	0.33 in/h
12	RAIN BIRD PEB	1-1/2"	TURF ROTOR	498.6	58.18	66.61	50.80	0.33 in/h
	Common Wire			1,828				



7 IRRIGATION SLEEVING DETAIL
N.T.S.



L2.11