

ENGINEER IS NOT RESPONSIBLE FOR ON-SITE OR OFF-SITE DAMAGES TO EXISTING STRUCTURES DUE TO CONSTRUCTION ACTIVITIES.

WIND LOAD INFO:  
 $V_{asd} = 124$  mph  
 $V_{ult} = 160$  mph (3 sec. GUST)  
 RISK CATEGORY I  
 Exposure D

# DUNE WALKOVER CONSTRUCTION

ATLANTIC OCEAN FRONTAGE  
 800 OCEAN DRIVE (JB-2)  
 TOWN OF JUNO BEACH  
 PALM BEACH COUNTY, FLORIDA

LOADS:  
 THE DUNE WALKOVER HAS BEEN DESIGNED FOR A VERTICAL LIVE LOAD OF 100 PSF, DEAD LOADS ASSOCIATED WITH THE STRUCTURE ITSELF, AND WIND LOADS PER CODE. THE STRUCTURE HAS NOT BEEN DESIGNED FOR SCOUR, OR HYDRODYNAMIC LOADS (INCLUDING BUT NOT LIMITED TO WAVE LOADS, CURRENT LOADS, ETC.).

ENGINEER MAKES NO WARRANTY OR CERTIFICATION REGARDING EXISTING STRUCTURES ONSITE.

CLIENT:  
**TOWN OF JUNO BEACH**

OCTOBER 2020

## INDEX TO DRAWINGS

SHEET NUMBER	TITLE
1	VICINITY MAP & TITLE SHEET
2	DEMOLITION PLAN
3	SITE PLAN
4	PILE LAYOUT
5	FRAMING PLAN
6	SOUTH ELEVATION
7	DETAILS

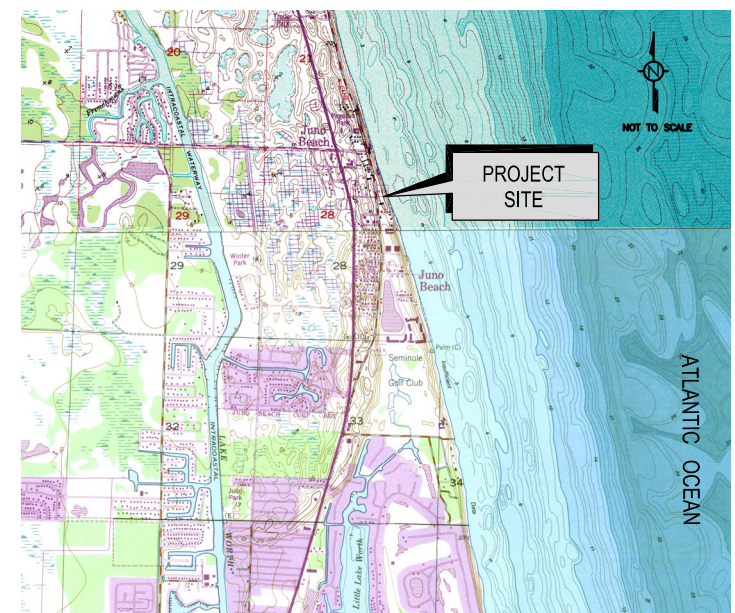
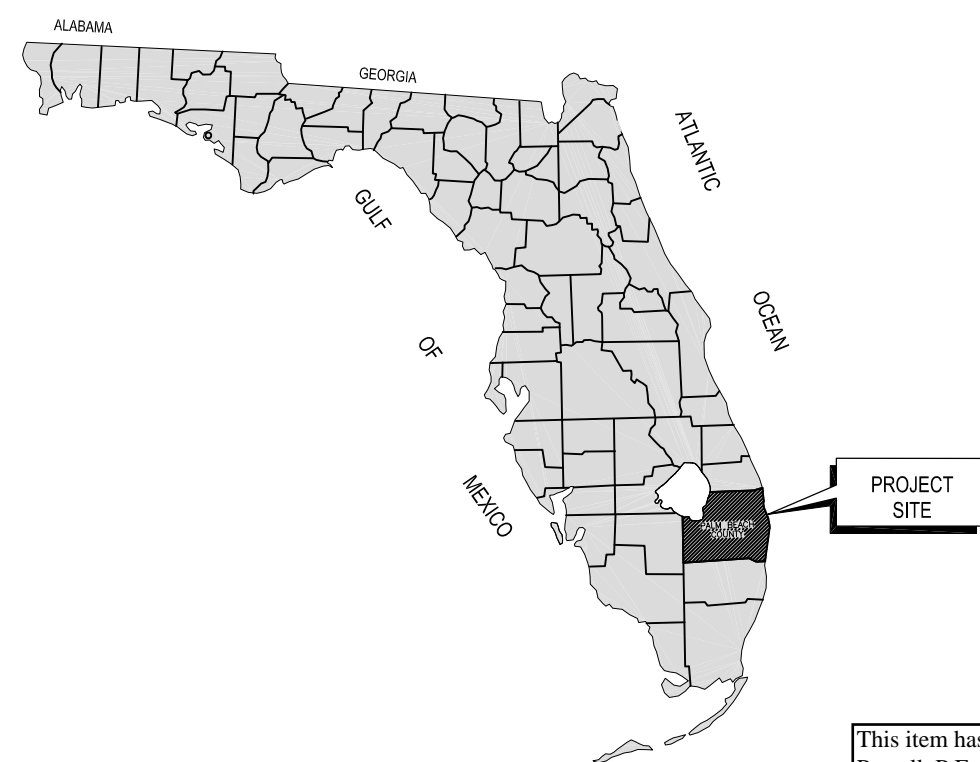

This item has been electronically signed and sealed by Mark A. Powell, P.E. on November 6, 2020 using a Digital Signature. Printed copies of this document are not considered signed and sealed and the signature must be verified on any electronic copies.

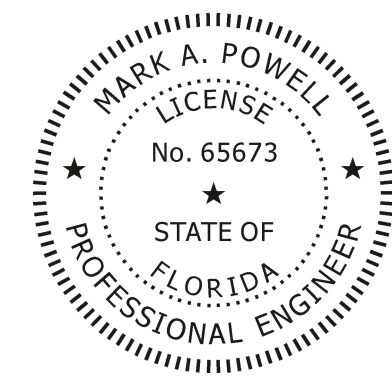

## PRELIMINARY VICINITY MAP & TITLE SHEET

 <b>ISIMINGER &amp; STUBBS ENGINEERING, INC.</b> <small>COASTAL • ENVIRONMENTAL • MARINE</small> <small>REGISTRY NUMBER: 8114</small> <small>P.O. BOX 14702 - NORTH PALM BEACH, FL. 33408 - 561-881-0003</small>							
<b>DUNE WALKOVER CONSTRUCTION</b> <b>ATLANTIC OCEAN FRONTAGE</b> <b>800 OCEAN DRIVE (JB-2)</b> <b>TOWN OF JUNO BEACH, PALM BEACH COUNTY, FL</b> <b>CLIENT: TOWN OF JUNO BEACH</b>							
DATE	10/20	DRAWN	PJK	CHKD	KDB	APPRVD	MAP
DWG NO.	20161A1					SHEET	
COMPUTER FILE NO.	20161A					OF 7	
							<b>1</b>

### APPLICABLE PROVISION(S):

THE DUNE WALKOVER HAS BEEN DESIGNED IN ACCORDANCE WITH THE APPLICABLE SECTIONS OF THE 2017 FLORIDA BUILDING CODE.

### NOTE:

THESE PLANS MUST BE USED IN CONJUNCTION WITH THE ATTACHED TECHNICAL SPECIFICATIONS.

FOR BID PURPOSES ONLY. NOT FOR CONSTRUCTION.

NOTE: EXISTING HARDWARE SHALL NOT BE REUSED FOR THIS PROJECT.

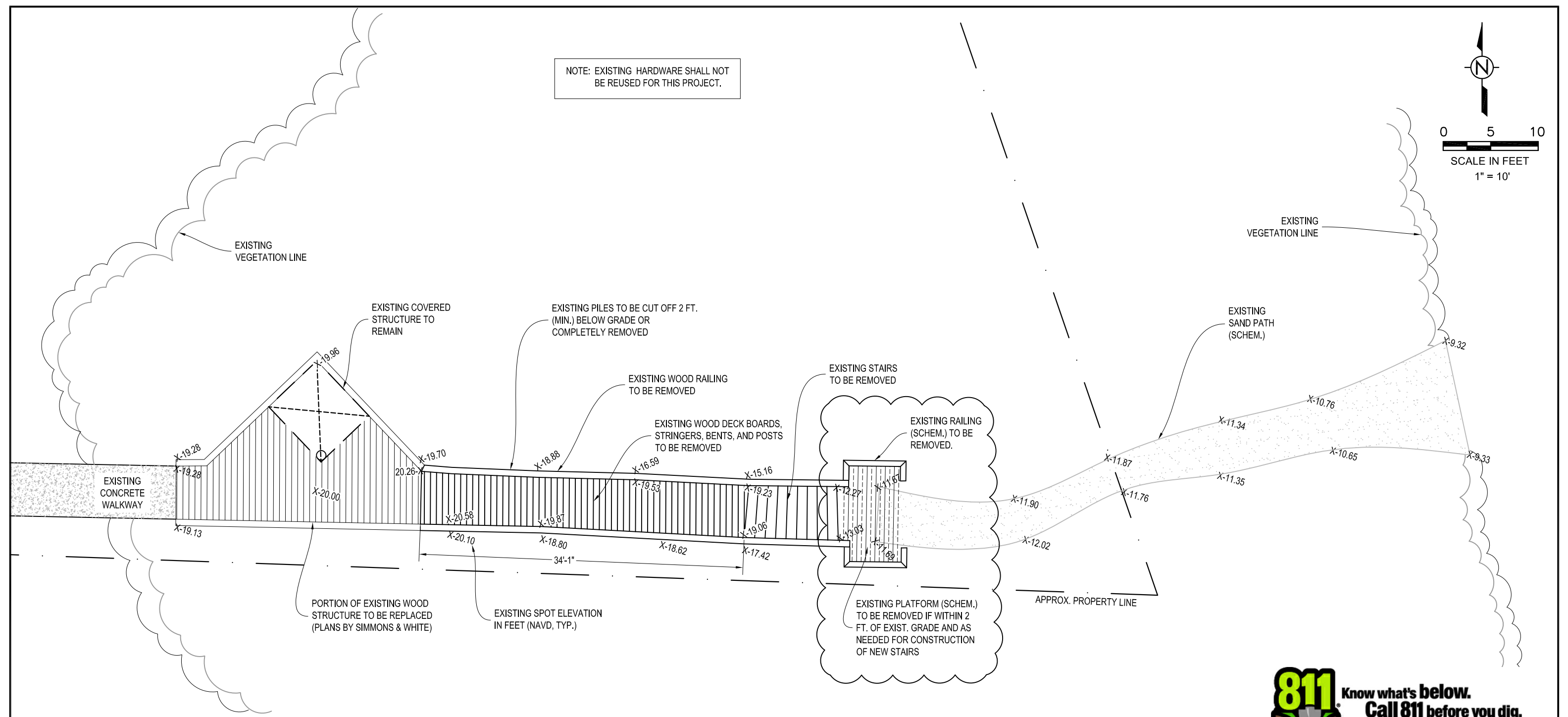
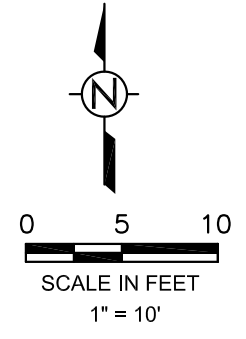

- NOTES:
- DATUM IS NAVD.
  - EXISTING CONDITIONS ARE APPROXIMATE BASED ON SURVEY BY MILLER LAND SURVEYING (DATED 8/28/20) AND ON-SITE OBSERVATIONS.
  - CONTRACTOR SHALL TAKE ALL STEPS NECESSARY TO PROTECT ALL EXISTING STRUCTURES ON-SITE AND ON NEIGHBORING PROPERTIES FROM DAMAGE. CONTRACTOR SHALL BE RESPONSIBLE FOR ALL REPAIRS TO EXISTING STRUCTURES AND VEGETATION SHOULD ANY DAMAGE OCCUR.

This item has been electronically signed and sealed by Mark A. Powell, P.E. on November 6, 2020 using a Digital Signature. Printed copies of this document are not considered signed and sealed and the signature must be verified on any electronic copies.

**PRELIMINARY**

FOR BID PURPOSES ONLY. NOT FOR CONSTRUCTION.

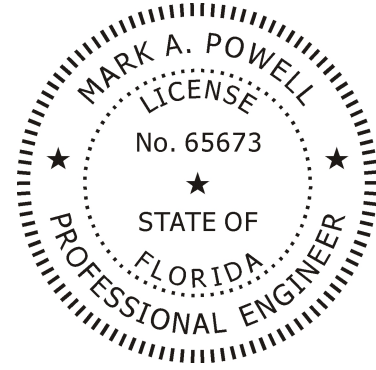

DEMOLITION PLAN							
<b>ISIMINGER &amp; STUBBS ENGINEERING, INC.</b>							
<small>COASTAL • ENVIRONMENTAL • MARINE REGISTRY NUMBER: 8114 P.O. BOX 14702 - NORTH PALM BEACH, FL. 33408 - 561-881-0003</small>							
<b>DUNE WALKOVER CONSTRUCTION ATLANTIC OCEAN FRONTAGE 800 OCEAN DRIVE (JB-2) TOWN OF JUNO BEACH, PALM BEACH COUNTY, FL CLIENT: TOWN OF JUNO BEACH</b>							
DATE	10/20	DRAWN	PJK	CHKD	KDB	APPRVD	MAP
DWG NO.	20161A2			SHEET		2	
COMPUTER FILE NO.	20161Ar1			OF		7	

REV	1	11/20	MODIFY DEMO OUTLINE AND DESCRIPTION
-----	---	-------	-------------------------------------

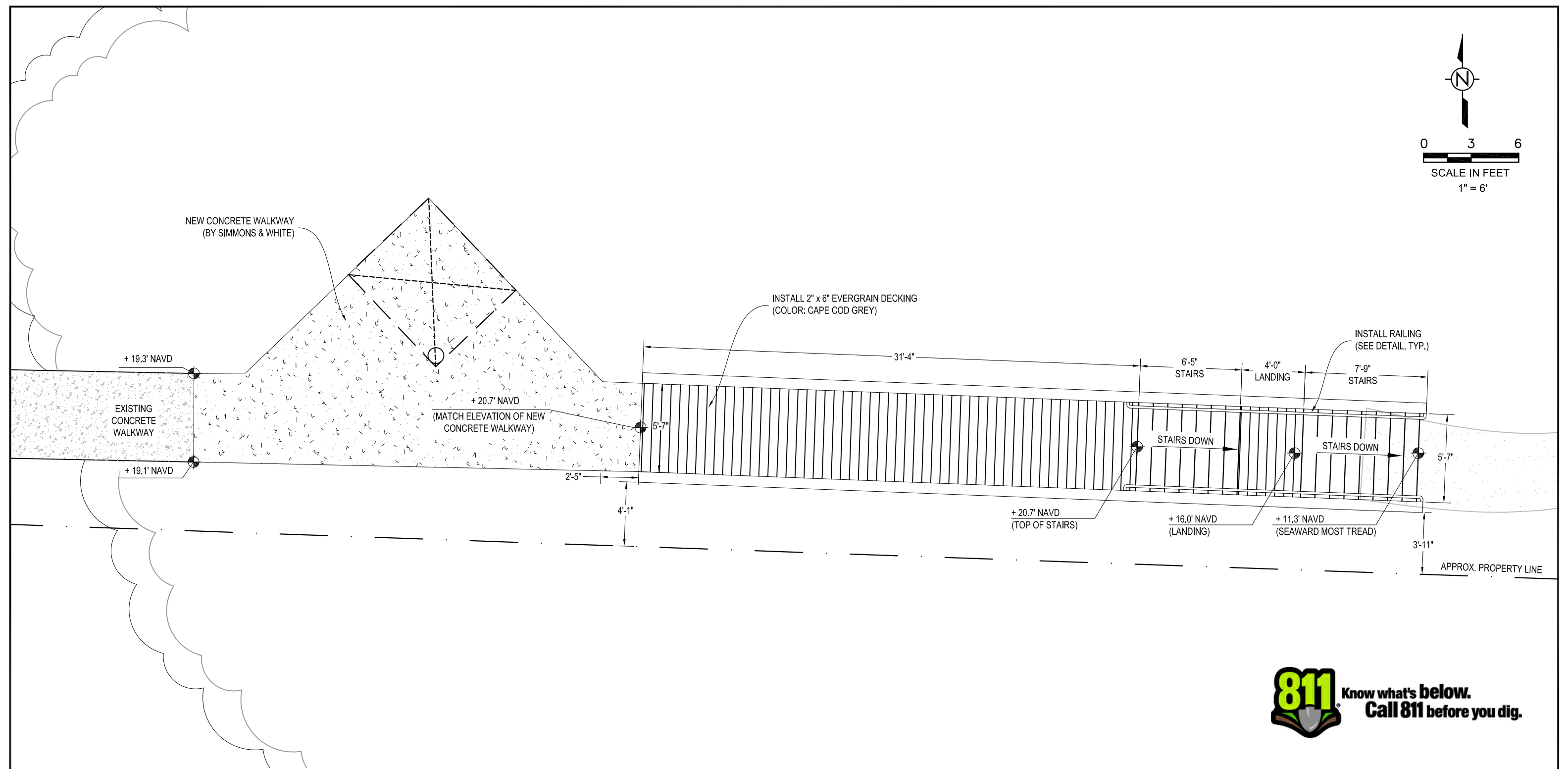
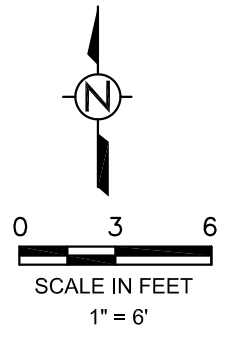

- NOTES:
1. DATUM IS NAVD.
  2. EXISTING CONDITIONS ARE APPROXIMATE BASED ON SURVEY BY MILLER LAND SURVEYING (DATED 8/28/20) AND ON-SITE OBSERVATIONS.
  3. CONTRACTOR SHALL TAKE ALL STEPS NECESSARY TO PROTECT ALL EXISTING STRUCTURES ON-SITE AND ON NEIGHBORING PROPERTIES FROM DAMAGE. CONTRACTOR SHALL BE RESPONSIBLE FOR ALL REPAIRS TO EXISTING STRUCTURES AND VEGETATION SHOULD ANY DAMAGE OCCUR.
  4. SOME TRIM ELEMENTS NOT SHOWN. CONTRACTOR TO CONFIRM DETAILING OF TRIM ELEMENTS PRIOR TO COMMENCEMENT OF CONSTRUCTION.

This item has been electronically signed and sealed by Mark A. Powell, P.E. on November 6, 2020 using a Digital Signature. Printed copies of this document are not considered signed and sealed and the signature must be verified on any electronic copies.

**PRELIMINARY**  
FOR BID PURPOSES ONLY. NOT FOR CONSTRUCTION.

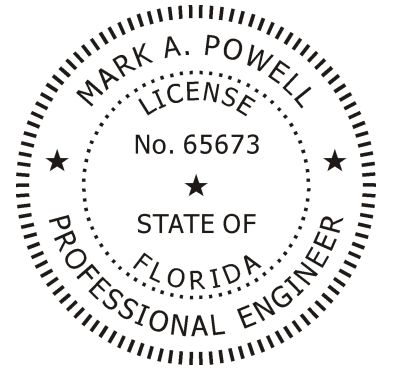

<b>SITE PLAN</b>							
<b>ISIMINGER &amp; STUBBS ENGINEERING, INC.</b>							
<small>COASTAL • ENVIRONMENTAL • MARINE REGISTRY NUMBER: 8114 P.O. BOX 14702 - NORTH PALM BEACH, FL. 33408 - 561-881-0003</small>							
<b>DUNE WALKOVER CONSTRUCTION</b>							
<b>ATLANTIC OCEAN FRONTAGE</b>							
<b>800 OCEAN DRIVE (JB-2)</b>							
<b>TOWN OF JUNO BEACH, PALM BEACH COUNTY, FL</b>							
<b>CLIENT: TOWN OF JUNO BEACH</b>							
DATE	10/20	DRAWN	PJK	CHKD	KDB	APPRVD	MAP
DWG NO.	20161A3			SHEET		3	
COMPUTER FILE NO.	20161A			OF		7	

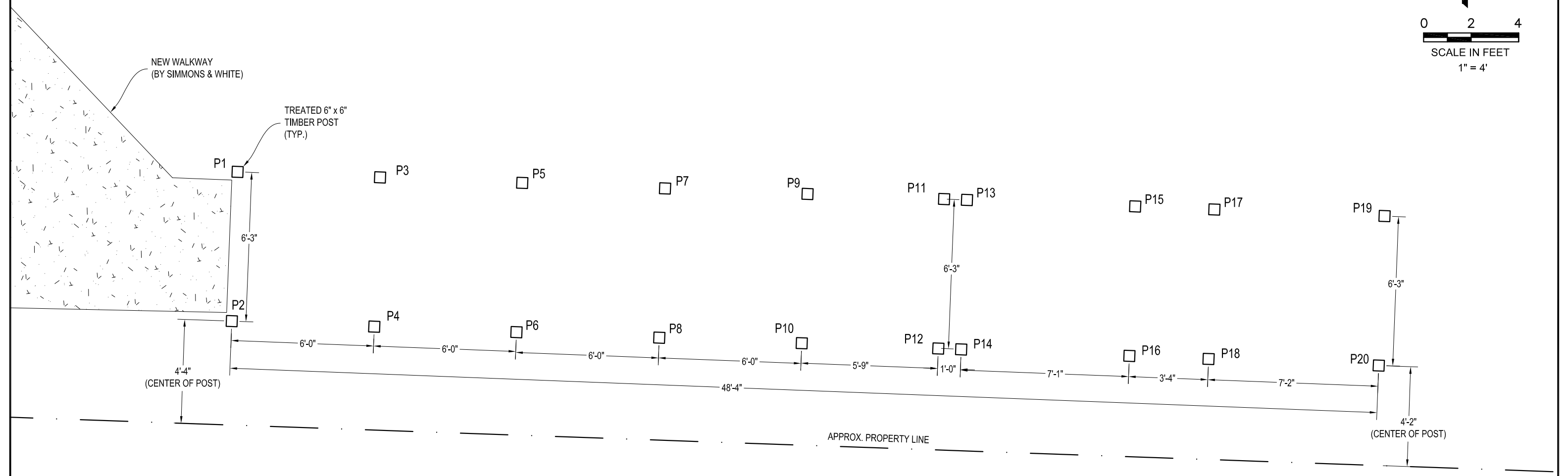
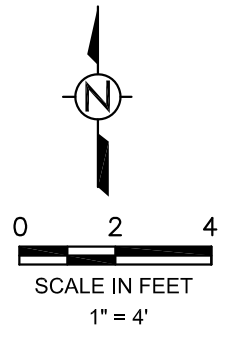

**NOTES:**

1. DATUM IS NAVD.
2. EXISTING CONDITIONS ARE APPROXIMATE BASED ON SURVEY BY MILLER LAND SURVEYING (DATED 8/28/20) AND ON-SITE OBSERVATIONS.
3. CONTRACTOR SHALL TAKE ALL STEPS NECESSARY TO PROTECT ALL EXISTING STRUCTURES ON-SITE AND ON NEIGHBORING PROPERTIES FROM DAMAGE. CONTRACTOR SHALL BE RESPONSIBLE FOR ALL REPAIRS TO EXISTING STRUCTURES AND VEGETATION SHOULD ANY DAMAGE OCCUR.
4. SOME TRIM ELEMENTS NOT SHOWN. CONTRACTOR TO CONFIRM DETAILING OF TRIM ELEMENTS PRIOR TO COMMENCEMENT OF CONSTRUCTION.

This item has been electronically signed and sealed by Mark A. Powell, P.E. on November 6, 2020 using a Digital Signature. Printed copies of this document are not considered signed and sealed and the signature must be verified on any electronic copies.

**PRELIMINARY**

FOR BID PURPOSES ONLY. NOT FOR CONSTRUCTION.

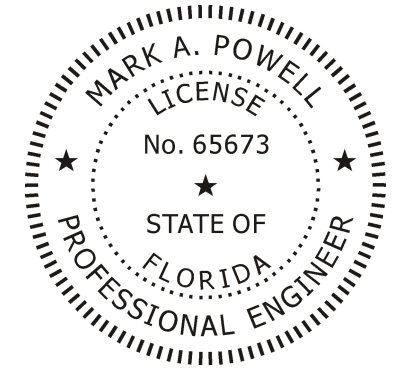

<b>ISIMINGER &amp; STUBBS ENGINEERING, INC.</b>							
<small>COASTAL • ENVIRONMENTAL • MARINE REGISTRY NUMBER: 8114 P.O. BOX 14702 - NORTH PALM BEACH, FL. 33408 - 561-881-0003</small>							
<b>DUNE WALKOVER CONSTRUCTION ATLANTIC OCEAN FRONTAGE 800 OCEAN DRIVE (JB-2) TOWN OF JUNO BEACH, PALM BEACH COUNTY, FL CLIENT: TOWN OF JUNO BEACH</b>							
DATE	10/20	DRAWN	PJK	CHKD	KDB	APPRVD	MAP
DWG NO.	20161A4					SHEET	
COMPUTER FILE NO.	20161A					OF 7	
							<b>4</b>

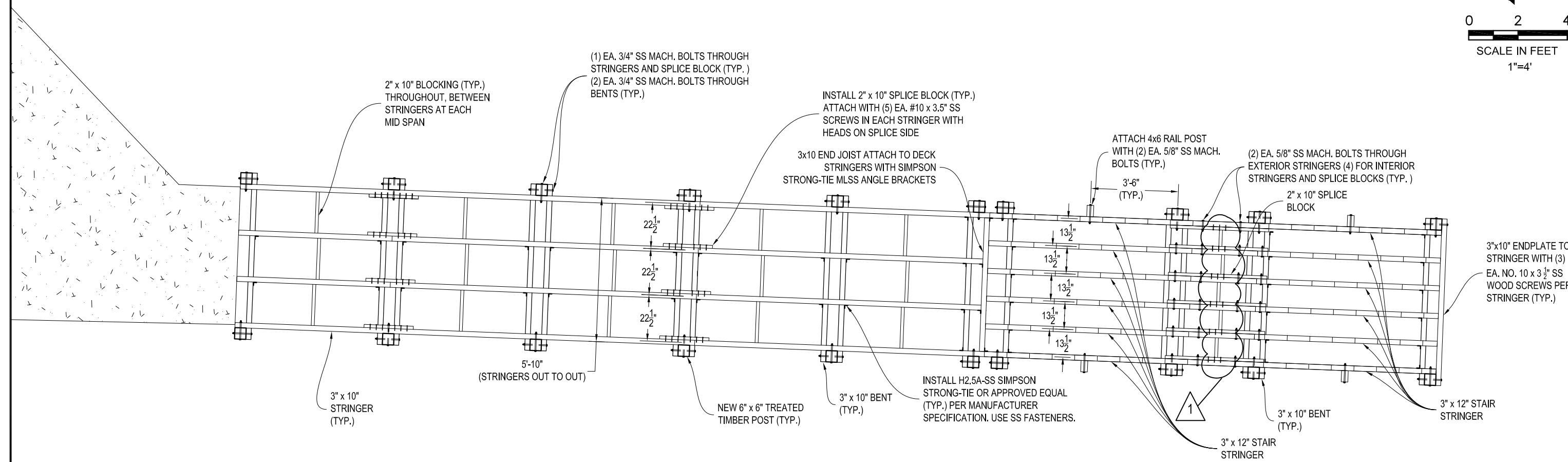
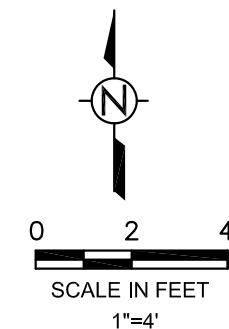

**PRODUCT NOTES:**

**WOOD:**

ALL STRUCTURAL MEMBERS SHALL BE PRESSURE TREATED ("GROUND CONTACT", AWPA CATEGORY UC4B MINIMUM EQUIVALENT) NO. 1 SOUTHERN YELLOW PINE OR BETTER.

**HARDWARE:**

ALL BOLTS, WASHERS, NUTS, SCREWS, NAILS, AND OTHER HARDWARE ITEMS SHALL BE 316 STAINLESS. THREADED ROD MAY BE USED IN PLACE OF HEX HEAD BOLTS FOR BOLTS LONGER THAN 7".

**DECKING:**

DECKING SHALL CONSIST OF 2" x 6" EVERGRAIN® DECKING (COLOR: CAPE COD GREY). END-TO-END JOINTS ARE NOT ALLOWED. DECKING SHALL BE INSTALLED WITH (2) EA. #10 X 3 1/2" DECK SCREWS PER STRINGER CROSSING. GAP BOARDS 1/8" SIDE TO SIDE AND BETWEEN THE BOARDS AND OTHER SURFACES. PRE-DRILLING/COUNTERSINKING IS REQUIRED SUCH THAT THE TOP OF SCREWS ARE FLUSH WITH OR NO LOWER THAN 1/32" BELOW THE TOP OF DECKING. ALL OTHER MANUFACTURER INSTALLATION REQUIREMENTS (INCLUDING BOARD EDGE SPACING) SHALL BE FOLLOWED.

**NOTES:**

1. DATUM IS NAVD.
2. EXISTING CONDITIONS ARE APPROXIMATE BASED ON SURVEY BY MILLER LAND SURVEYING (DATED 8/28/20) AND ON-SITE OBSERVATIONS.
3. SOME TRIM ELEMENTS NOT SHOWN. CONTRACTOR TO CONFIRM DETAILING OF TRIM ELEMENTS PRIOR TO COMMENCEMENT OF CONSTRUCTION.

This item has been electronically signed and sealed by Mark A. Powell, P.E. on November 6, 2020 using a Digital Signature. Printed copies of this document are not considered signed and sealed and the signature must be verified on any electronic copies.

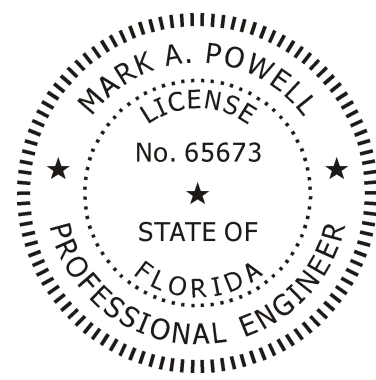

**PRELIMINARY**

FOR BID PURPOSES ONLY. NOT FOR CONSTRUCTION.



**FRAMING PLAN**

**ISIMINGER & STUBBS ENGINEERING, INC.**  
COASTAL • ENVIRONMENTAL • MARINE  
 REGISTRY NUMBER: 8114  
 P.O. BOX 14702 - NORTH PALM BEACH, FL. 33408 - 561-881-0003

**DUNE WALKOVER CONSTRUCTION**  
**ATLANTIC OCEAN FRONTAGE**  
 800 OCEAN DRIVE (JB-2)  
 TOWN OF JUNO BEACH, PALM BEACH COUNTY, FL  
 CLIENT: TOWN OF JUNO BEACH

DATE	10/20	DRAWN	PJK	CHKD	KDB	APPRVD	MAP
DWG NO.	20161A5			SHEET		5	
COMPUTER FILE NO.	20161A			OF		7	

REV	1	11/20	ADD BLOCKING TO LANDING
-----	---	-------	-------------------------

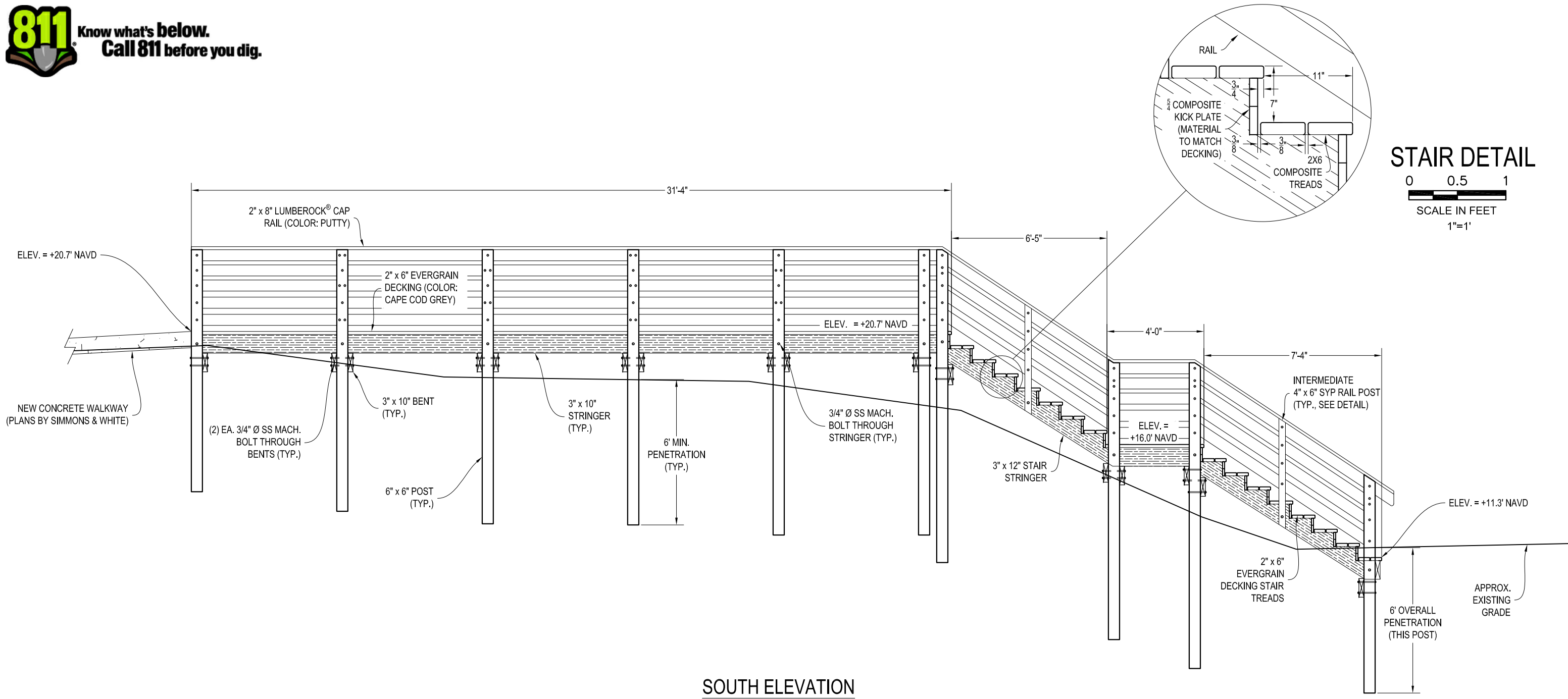

**SOUTH ELEVATION**

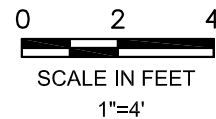

**NOTES:**

- DATUM IS NAVD.
- EXISTING CONDITIONS ARE APPROXIMATE BASED ON SURVEY BY MILLER LAND SURVEYING (DATED 8/28/20) AND ON-SITE OBSERVATIONS.
- ALL STRUCTURAL MEMBERS SHALL BE PRESSURE TREATED ("GROUND CONTACT", AWPA CATEGORY UC4B MINIMUM EQUIVALENT) NO. 1 SOUTHERN YELLOW PINE OR BETTER.
- ALL BOLTS, WASHERS, NUTS, SCREWS, NAILS, AND OTHER HARDWARE ITEMS SHALL BE 316 STAINLESS STEEL UNLESS SPECIFIED OTHERWISE. ALL BOLTS SHALL HAVE POLISHED FINISH. THREADED ROAD MAY BE SUBSTITUTED FOR BOLTS LONGER THAN 7".
- SOME TRIM ELEMENTS NOT SHOWN. CONTRACTOR TO CONFIRM DETAILING OF TRIM ELEMENTS PRIOR TO COMMENCEMENT OF CONSTRUCTION.

This item has been electronically signed and sealed by Mark A. Powell, P.E. on November 6, 2020 using a Digital Signature. Printed copies of this document are not considered signed and sealed and the signature must be verified on any electronic copies.

**PRELIMINARY**

FOR BID PURPOSES ONLY. NOT FOR CONSTRUCTION.

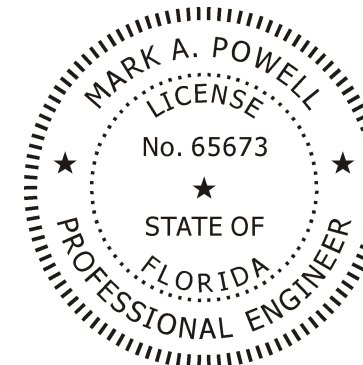

**SOUTH ELEVATION**

 ISIMINGER & STUBBS ENGINEERING, INC. COASTAL • ENVIRONMENTAL • MARINE REGISTRY NUMBER: 8114 P.O. BOX 14702 - NORTH PALM BEACH, FL. 33408 - 561-881-0003							
DUNE WALKOVER CONSTRUCTION ATLANTIC OCEAN FRONTAGE 800 OCEAN DRIVE (JB-2) TOWN OF JUNO BEACH, PALM BEACH COUNTY, FL CLIENT: TOWN OF JUNO BEACH							
DATE	10/20	DRAWN	PJK	CHKD	KDB	APPRVD	MAP
DWG NO.	20161A6				SHEET		<b>6</b>
COMPUTER FILE NO.	20161A				OF 7		

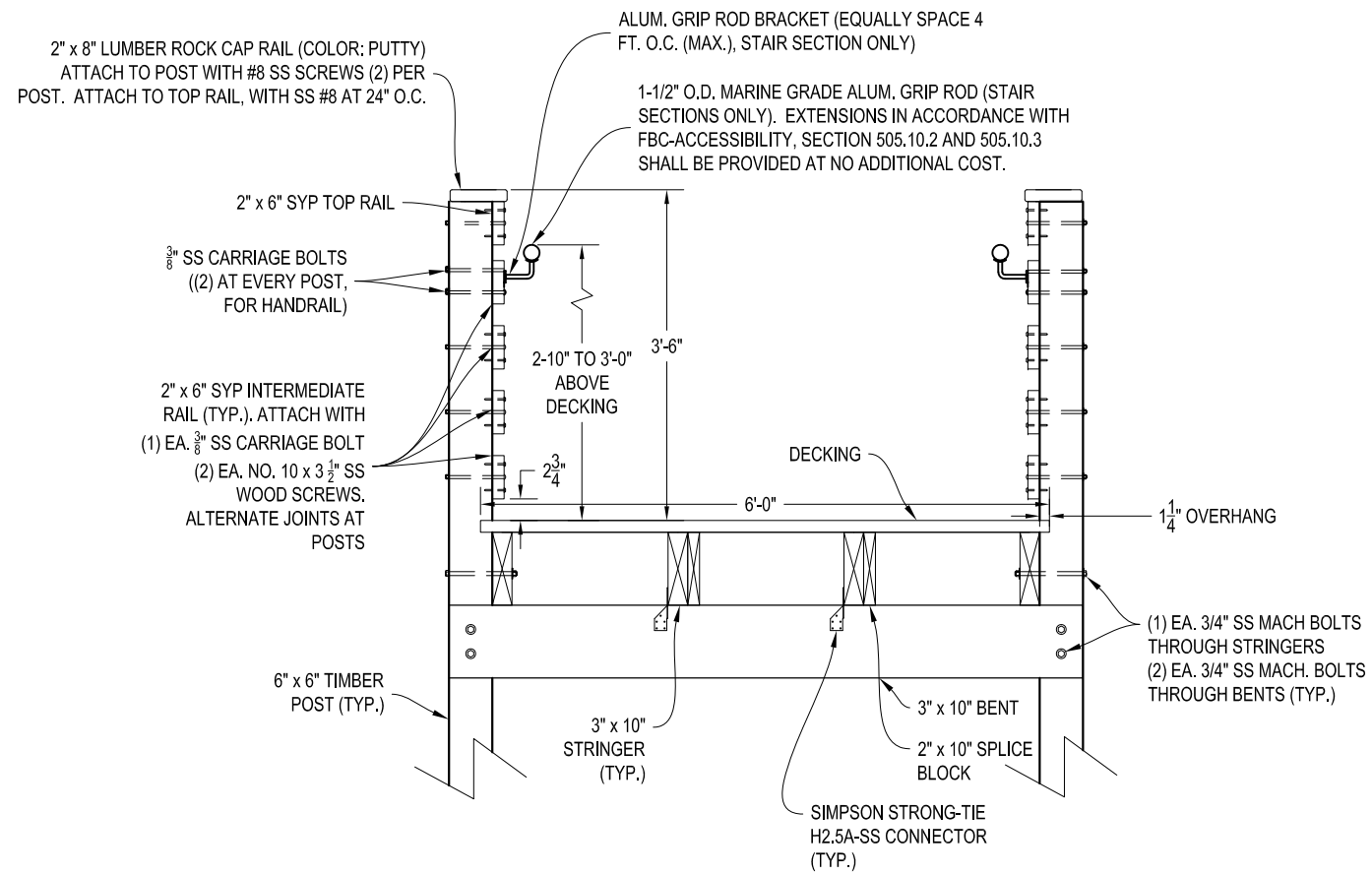

**RAILING DETAIL AT POST**

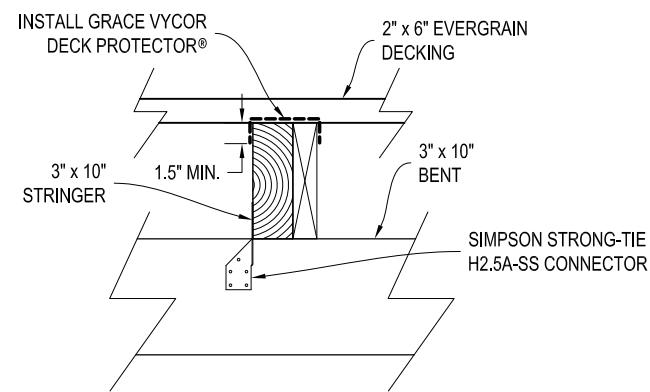
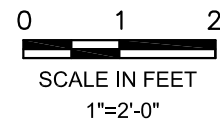

**GRACE VYCOR DETAIL**

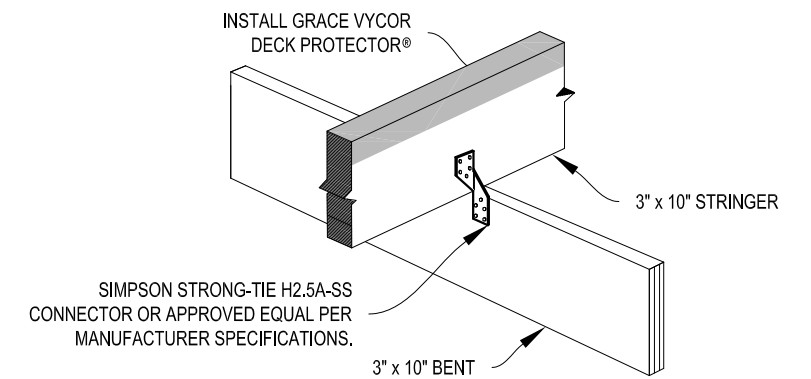
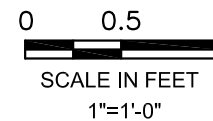

**STRINGER/BENT DETAIL**

NOT TO SCALE

**NOTES:**

1. DATUM IS NAVD.
2. ALL STRUCTURAL MEMBERS SHALL BE PRESSURE TREATED ("GROUND CONTACT", AWPA CATEGORY UC4B MINIMUM EQUIVALENT) NO. 1 SOUTHERN YELLOW PINE OR BETTER.
3. ALL BOLTS, WASHERS, NUTS, SCREWS, NAILS, AND OTHER HARDWARE ITEMS SHALL BE 316 STAINLESS STEEL UNLESS SPECIFIED OTHERWISE. ALL BOLTS SHALL HAVE POLISHED FINISH. THREADED ROAD MAY BE SUBSTITUTED FOR BOLTS LONGER THAN 7". ALUMINUM HANDRAILS SHALL BE ALLOY 6061. CONTRACTOR TO PROVIDE CONNECTION DETAILS TO ENGINEER PRIOR TO ORDERING AND INSTALLING.
4. SOME TRIM ELEMENTS NOT SHOWN. CONTRACTOR TO CONFIRM DETAILING OF TRIM ELEMENTS PRIOR TO COMMENCEMENT OF CONSTRUCTION.

NOTE: \* GRIP ROD SHALL BE A CONSISTENT HEIGHT ABOVE STAIR NOSINGS .

This item has been electronically signed and sealed by Mark A. Powell, P.E. on November 6, 2020 using a Digital Signature. Printed copies of this document are not considered signed and sealed and the signature must be verified on any electronic copies.

**PRELIMINARY**

FOR BID PURPOSES ONLY. NOT FOR CONSTRUCTION.

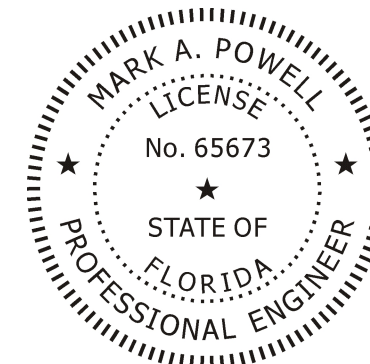

**DETAILS**

<b>ISIMINGER &amp; STUBBS ENGINEERING, INC.</b>							
<small>COASTAL • ENVIRONMENTAL • MARINE REGISTRY NUMBER : 8114 P.O. BOX 14702 - NORTH PALM BEACH, FL. 33408 - 561-881-0003</small>							
<b>DUNE WALKOVER CONSTRUCTION ATLANTIC OCEAN FRONTAGE 800 OCEAN DRIVE (JB-2) TOWN OF JUNO BEACH, PALM BEACH COUNTY, FL CLIENT: TOWN OF JUNO BEACH</b>							
DATE	10/20	DRAWN	PJK	CHKD	KDB	APPRVD	MAP
DWG NO.	20161A7					SHEET	
COMPUTER FILE NO.	20161A					OF 7	