

ENGINEER IS NOT RESPONSIBLE FOR ON-SITE OR OFF-SITE DAMAGES TO EXISTING STRUCTURES DUE TO CONSTRUCTION ACTIVITIES.

WIND LOAD INFO:  
 $V_{asd} = 124$  mph  
 $V_{ult} = 160$  mph (3 sec. GUST)  
 RISK CATEGORY I  
 Exposure D

# DUNE WALKOVER CONSTRUCTION

ATLANTIC OCEAN FRONTAGE  
 530 OCEAN DRIVE (JB-4)  
 TOWN OF JUNO BEACH  
 PALM BEACH COUNTY, FLORIDA  
 CLIENT:  
**TOWN OF JUNO BEACH**

LOADS:  
 THE DUNE WALKOVER SUPER STRUCTURE (INCLUDING BENTS, STRINGERS, AND DECKING) AND NEW PILES HAVE BEEN DESIGNED FOR A VERTICAL LIVE LOAD OF 100 PSF, DEAD LOADS ASSOCIATED WITH THE STRUCTURE ITSELF, AND WIND LOADS PER CODE. THE STRUCTURE HAS NOT BEEN DESIGNED FOR SCOUR, OR HYDRODYNAMIC LOADS (INCLUDING BUT NOT LIMITED TO WAVE LOADS, CURRENT LOADS, ETC.).

ENGINEER MAKES NO WARRANTY OR CERTIFICATION REGARDING EXISTING STRUCTURES (INCLUDING EXISTING PILES) ONSITE.

NOVEMBER 2020

## INDEX TO DRAWINGS

SHEET NUMBER	TITLE
1	VICINITY MAP & TITLE SHEET
2	DEMOLITION PLAN
3	SITE PLAN
4	FRAMING PLAN
5	SOUTH ELEVATION
6	DETAILS
7	PLATFORM SECTION
8	BENCH DETAIL

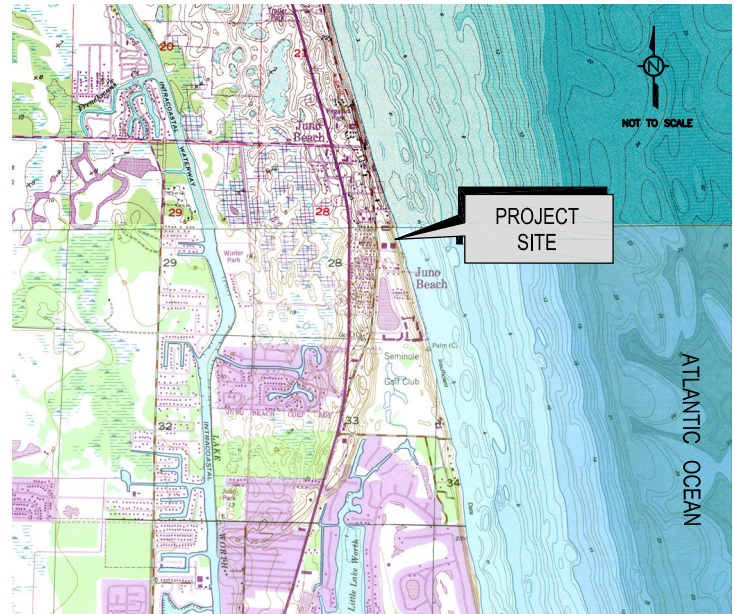
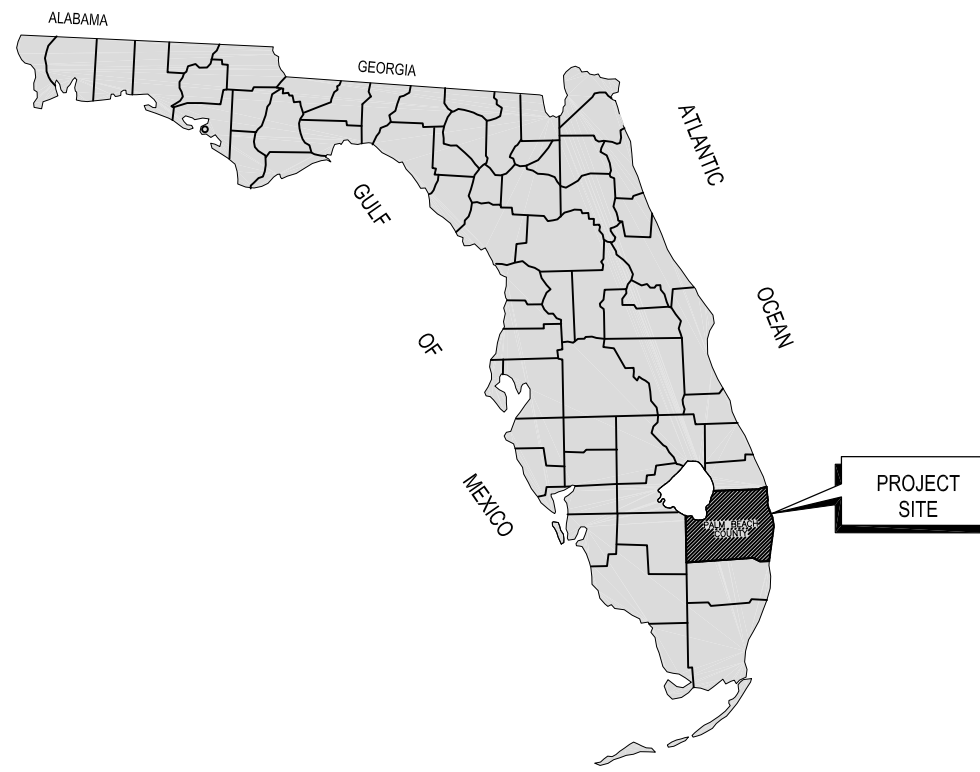

This item has been electronically signed and sealed by Mark A. Powell P.E. on November 3, 2020 using a Digital Signature.  
 Printed copies of this document are not considered signed and sealed and the signature must be verified on any electronic copies.

PRELIMINARY

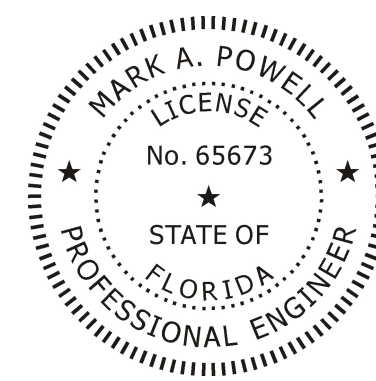

APPLICABLE PROVISION(S):

THE DUNE WALKOVER HAS BEEN DESIGNED IN ACCORDANCE WITH THE APPLICABLE SECTIONS OF THE 2017 FLORIDA BUILDING CODE.

NOTE:  
 THESE PLANS MUST BE USED IN CONJUNCTION WITH THE ATTACHED TECHNICAL SPECIFICATIONS.

FOR BID PURPOSES ONLY. NOT FOR CONSTRUCTION.

## VICINITY MAP & TITLE SHEET

<p>ISIMINGER &amp; STUBBS                  ENGINEERING, INC.                  COASTAL • ENVIRONMENTAL • MARINE                  REGISTRY NUMBER: 8114                  P.O. BOX 14702 - NORTH PALM BEACH, FL. 33408 - 561-881-0003</p>							
<p>DUNE WALKOVER CONSTRUCTION                  ATLANTIC OCEAN FRONTAGE                  530 OCEAN DRIVE (JB-4)                  TOWN OF JUNO BEACH, PALM BEACH COUNTY, FL                  CLIENT: TOWN OF JUNO BEACH</p>							
DATE	10/20	DRAWN	PJK	CHKD	KDB	APPRVD	MAP
DWG NO.	20160B1					SHEET	
COMPUTER FILE NO.	20160B					OF 8	
							<b>1</b>

NOTE: EXISTING HARDWARE SHALL NOT BE REUSED FOR THIS PROJECT.

NOTE: ENGINEER SHALL INSPECT ALL EXISTING PILING TO REMAIN (AFTER DEMOLITION WORK) FOR APPROVAL TO REUSE IN THE PROJECT. ANY PILES DEEMED UNACCEPTABLE BY ENGINEER SHALL BE REPLACED AT TOWN'S EXPENSE. CONTRACTOR TO PROVIDE A PRICE PER PILE WITH INITIAL BID PACKAGE.

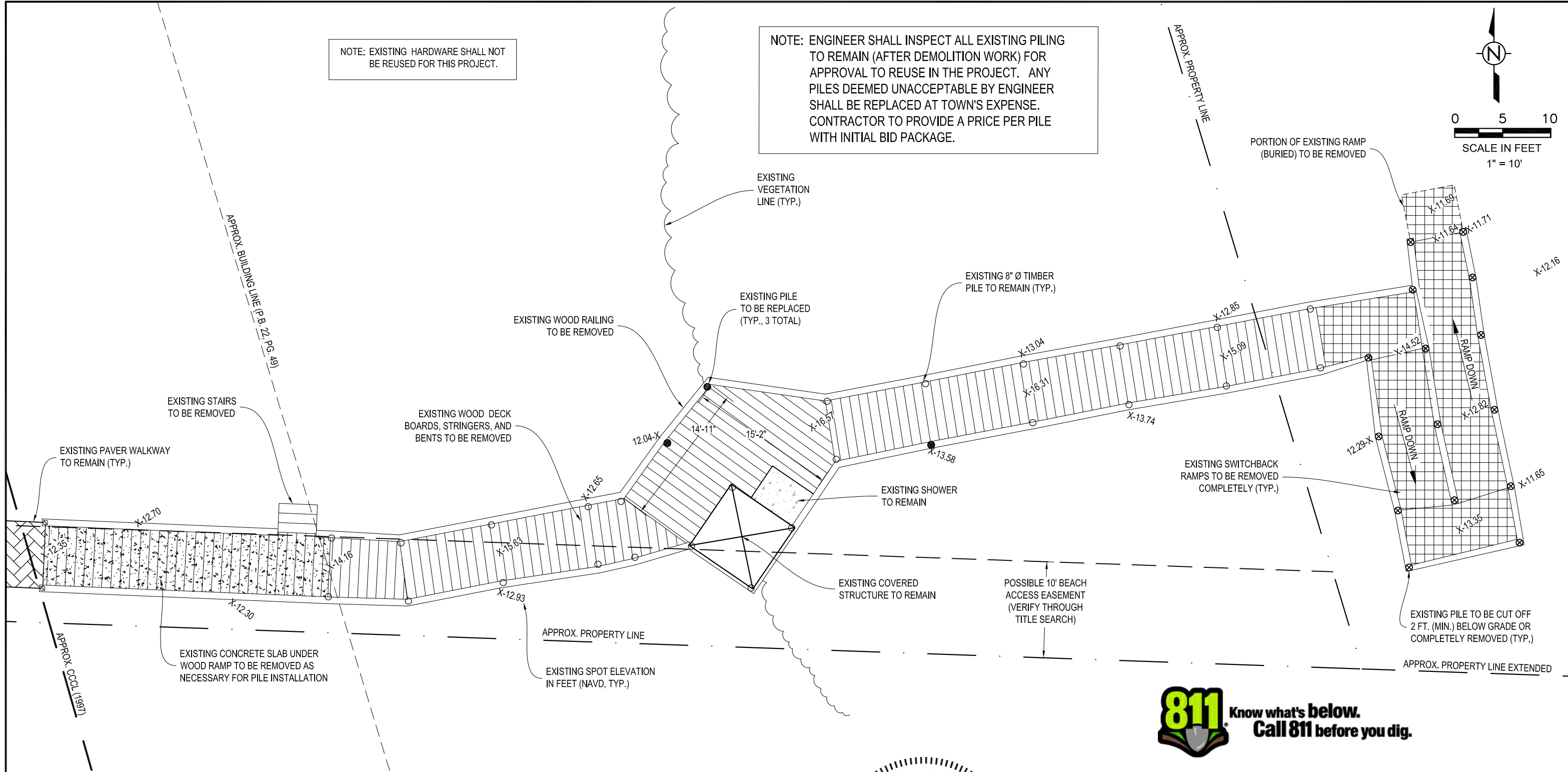
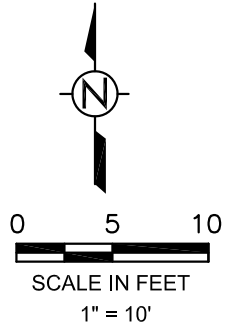

**NOTES:**

1. DATUM IS NAVD.
2. EXISTING CONDITIONS ARE APPROXIMATE BASED ON SURVEY BY MILLER LAND SURVEYING (DATED 8/28/20, REV. 10/30/20) AND ON-SITE OBSERVATIONS.
3. CONTRACTOR SHALL TAKE ALL STEPS NECESSARY TO PROTECT ALL EXISTING STRUCTURES ON-SITE AND ON NEIGHBORING PROPERTIES FROM DAMAGE. CONTRACTOR SHALL BE RESPONSIBLE FOR ALL REPAIRS TO EXISTING STRUCTURES AND VEGETATION SHOULD ANY DAMAGE OCCUR.

This item has been electronically signed and sealed by Mark A. Powell P.E. on November 3, 2020 using a Digital Signature. Printed copies of this document are not considered signed and sealed and the signature must be verified on any electronic copies.

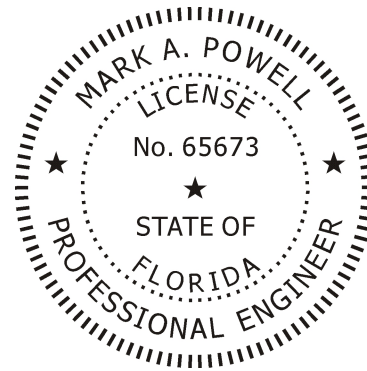

FOR BID PURPOSES ONLY. NOT FOR CONSTRUCTION.



**Know what's below.  
Call 811 before you dig.**

**DEMOLITION PLAN**

 ISIMINGER & STUBBS ENGINEERING, INC. COASTAL • ENVIRONMENTAL • MARINE REGISTRY NUMBER: 8114 P.O. BOX 14702 - NORTH PALM BEACH, FL. 33408 - 561-881-0003							
DUNE WALKOVER CONSTRUCTION ATLANTIC OCEAN FRONTAGE 530 OCEAN DRIVE (JB-4) TOWN OF JUNO BEACH, PALM BEACH COUNTY, FL CLIENT: TOWN OF JUNO BEACH							
DATE	10/20	DRAWN	PJK	CHKD	KDB	APPRVD	MAP
DWG NO.	20160B2			SHEET		2	
COMPUTER FILE NO.	20160B			OF		8	

PRELIMINARY

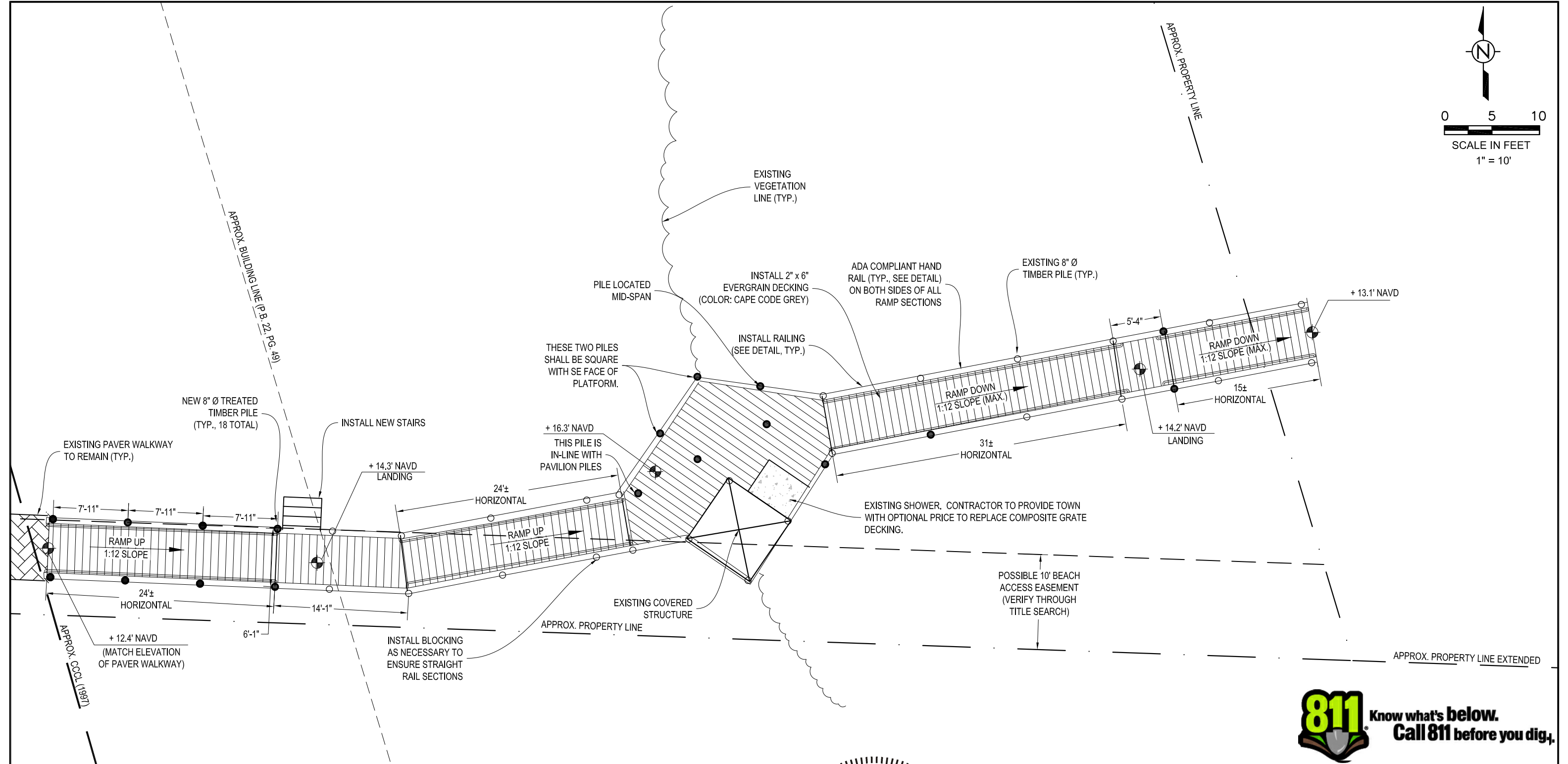
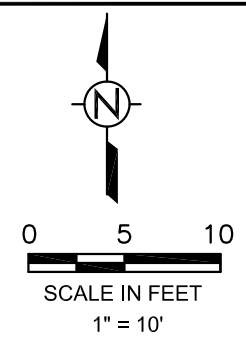

- NOTES:
1. DATUM IS NAVD.
  2. EXISTING CONDITIONS ARE APPROXIMATE BASED ON SURVEY BY MILLER LAND SURVEYING (DATED 8/28/20, REV. 10/30/20) AND ON-SITE OBSERVATIONS.
  3. CONTRACTOR SHALL TAKE ALL STEPS NECESSARY TO PROTECT ALL EXISTING STRUCTURES ON-SITE AND ON NEIGHBORING PROPERTIES FROM DAMAGE. CONTRACTOR SHALL BE RESPONSIBLE FOR ALL REPAIRS TO EXISTING STRUCTURES AND VEGETATION SHOULD ANY DAMAGE OCCUR.
  4. SOME TRIM ELEMENTS NOT SHOWN. CONTRACTOR TO CONFIRM DETAILING OF TRIM ELEMENTS PRIOR TO COMMENCEMENT OF CONSTRUCTION.

This item has been electronically signed and sealed by Mark A. Powell P.E. on November 3, 2020 using a Digital Signature. Printed copies of this document are not considered signed and sealed and the signature must be verified on any electronic copies.

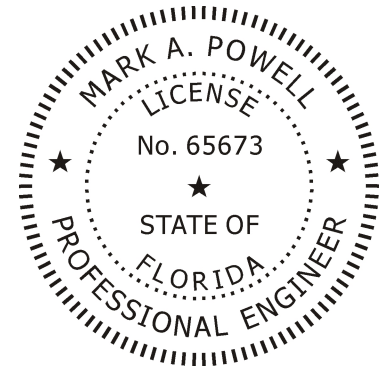

FOR BID PURPOSES ONLY. NOT FOR CONSTRUCTION.

PRELIMINARY



<b>SITE PLAN</b>							
<b>ISIMINGER &amp; STUBBS ENGINEERING, INC.</b>							
<small>COASTAL • ENVIRONMENTAL • MARINE REGISTRY NUMBER: 8114 P.O. BOX 14702 - NORTH PALM BEACH, FL. 33408 - 561-881-0003</small>							
<b>DUNE WALKOVER CONSTRUCTION ATLANTIC OCEAN FRONTAGE 530 OCEAN DRIVE (JB-4) TOWN OF JUNO BEACH, PALM BEACH COUNTY, FL CLIENT: TOWN OF JUNO BEACH</b>							
DATE	10/20	DRAWN	PJK	CHKD	KDB	APPRVD	MAP
DWG NO.	20160B3					SHEET	<b>3</b>
COMPUTER FILE NO.	20160B					OF	

**PRODUCT NOTES:**

**WOOD:**

ALL STRUCTURAL MEMBERS SHALL BE PRESSURE TREATED ("GROUND CONTACT", AWPA CATEGORY UC4B MINIMUM EQUIVALENT) NO. 1 SOUTHERN YELLOW PINE OR BETTER.

**HARDWARE:**

ALL BOLTS, WASHERS, NUTS, SCREWS, NAILS, AND OTHER HARDWARE ITEMS SHALL BE 316 STAINLESS. THREADED ROD MAY BE USED IN PLACE OF HEX HEAD BOLTS FOR BOLTS LONGER THAN 7".

**DECKING:**

DECKING SHALL CONSIST OF 2" x 6" EVERGRAIN® DECKING (COLOR: CAPE COD GREY). END-TO-END JOINTS ARE NOT ALLOWED. DECKING SHALL BE INSTALLED WITH (2) EA. #10 X 3 1/2" DECK SCREWS PER STRINGER CROSSING. GAP BOARDS 1/8" SIDE TO SIDE AND BETWEEN THE BOARDS AND OTHER SURFACES. PRE-DRILLING/COUNTERSINKING IS REQUIRED SUCH THAT THE TOP OF SCREWS ARE FLUSH WITH OR NO LOWER THAN 1/32" BELOW THE TOP OF DECKING. ALL OTHER MANUFACTURER INSTALLATION REQUIREMENTS (INCLUDING BOARD EDGE SPACING) SHALL BE FOLLOWED.

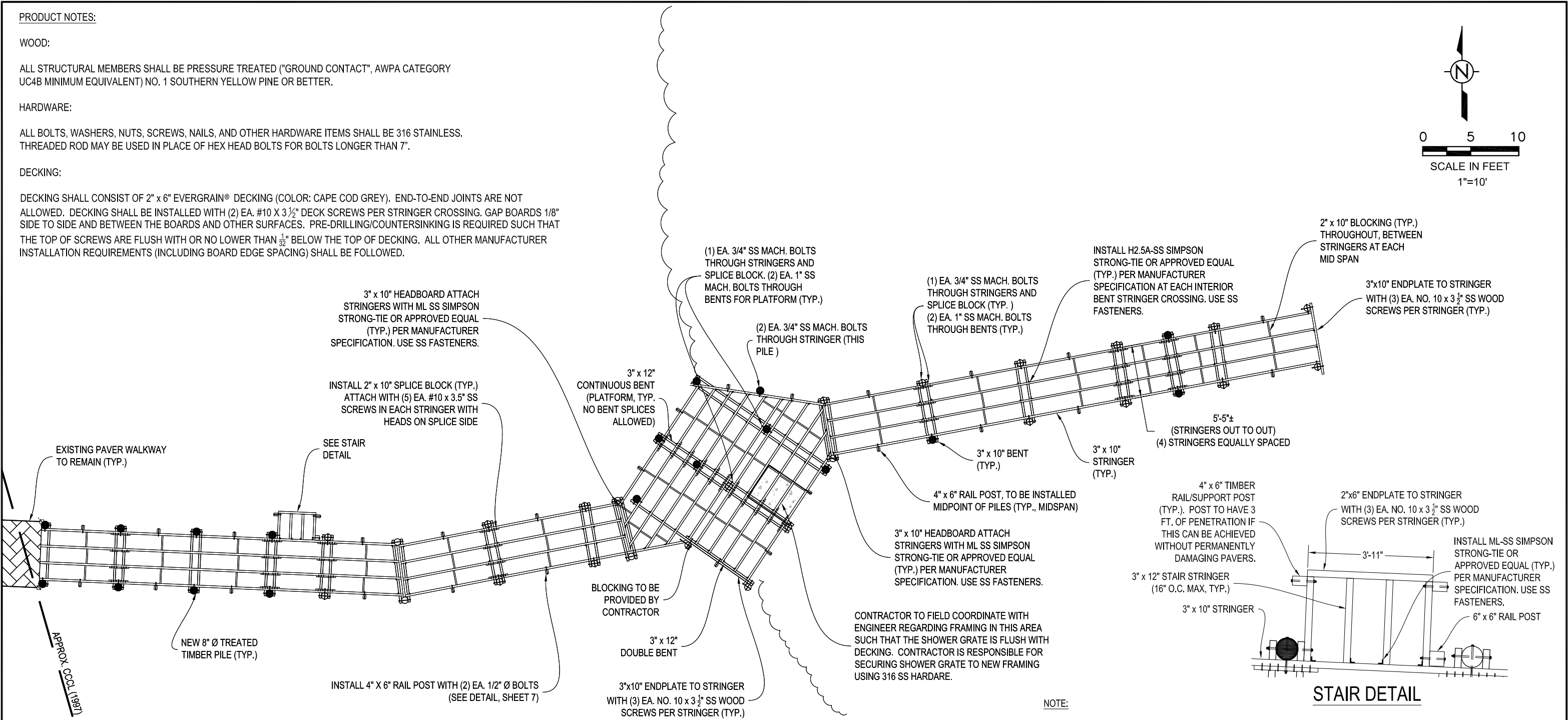
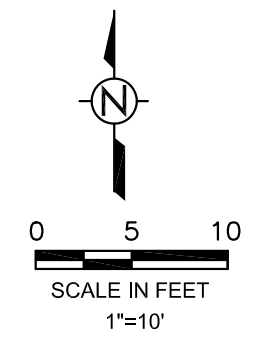

**NOTE:**

CONTRACTOR TO PROVIDE STAIR RAILING SHOP DRAWING FOR ENGINEER'S APPROVAL. RAILING SHALL USE THE SAME MATERIALS AS WALKOVER STRUCTURE.

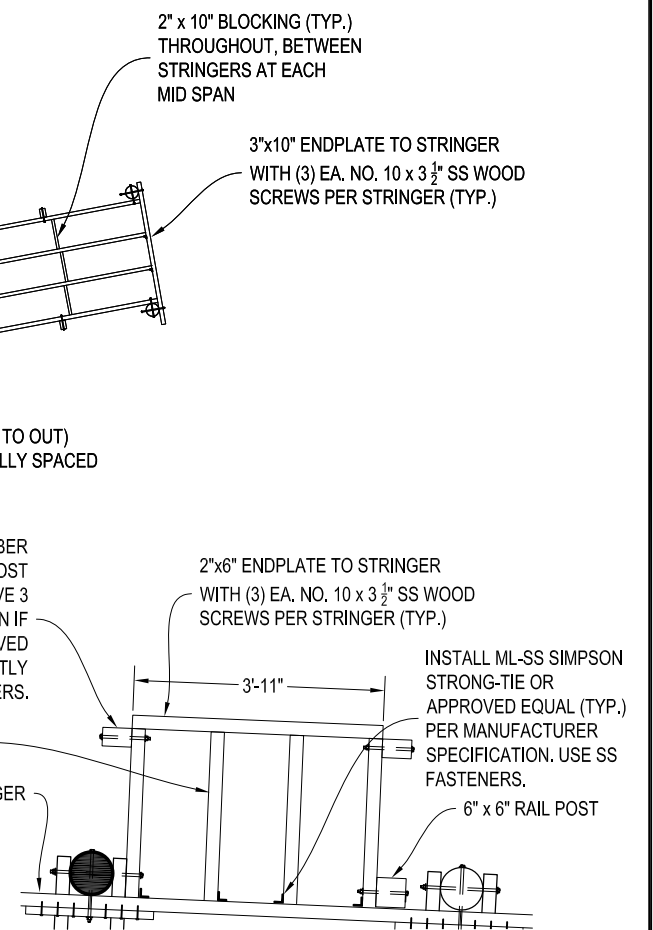

**STAIR DETAIL**

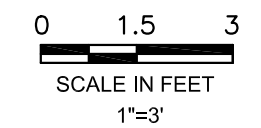

**NOTES:**

- DATUM IS NAVD.
- EXISTING CONDITIONS ARE APPROXIMATE BASED ON SURVEY BY MILLER LAND SURVEYING (DATED 8/28/20, REV. 10/30/20) AND ON-SITE OBSERVATIONS.
- SOME TRIM ELEMENTS NOT SHOWN. CONTRACTOR TO CONFIRM DETAILING OF TRIM ELEMENTS PRIOR TO COMMENCEMENT OF CONSTRUCTION.

This item has been electronically signed and sealed by Mark A. Powell P.E. on November 3, 2020 using a Digital Signature. Printed copies of this document are not considered signed and sealed and the signature must be verified on any electronic copies.

FOR BID PURPOSES ONLY. NOT FOR CONSTRUCTION.

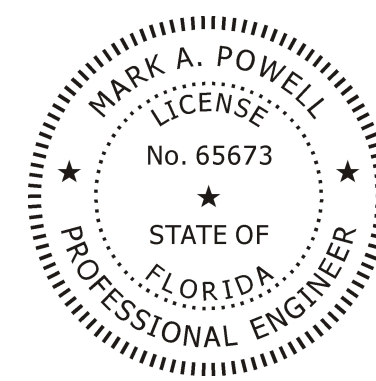

**FRAMING PLAN**

**ISIMINGER & STUBBS ENGINEERING, INC.**  
 COASTAL • ENVIRONMENTAL • MARINE  
 REGISTRY NUMBER: 8114  
 P.O. BOX 14702 - NORTH PALM BEACH, FL. 33408 - 561-881-0003

**DUNE WALKOVER CONSTRUCTION**  
 ATLANTIC OCEAN FRONTAGE  
 530 OCEAN DRIVE (JB-4)  
 TOWN OF JUNO BEACH, PALM BEACH COUNTY, FL  
 CLIENT: TOWN OF JUNO BEACH

DATE	10/20	DRAWN	PJK	CHKD	KDB	APPRVD	MAP
DWG NO.	20160B4				SHEET		4
COMPUTER FILE NO.	20160B				OF 8		

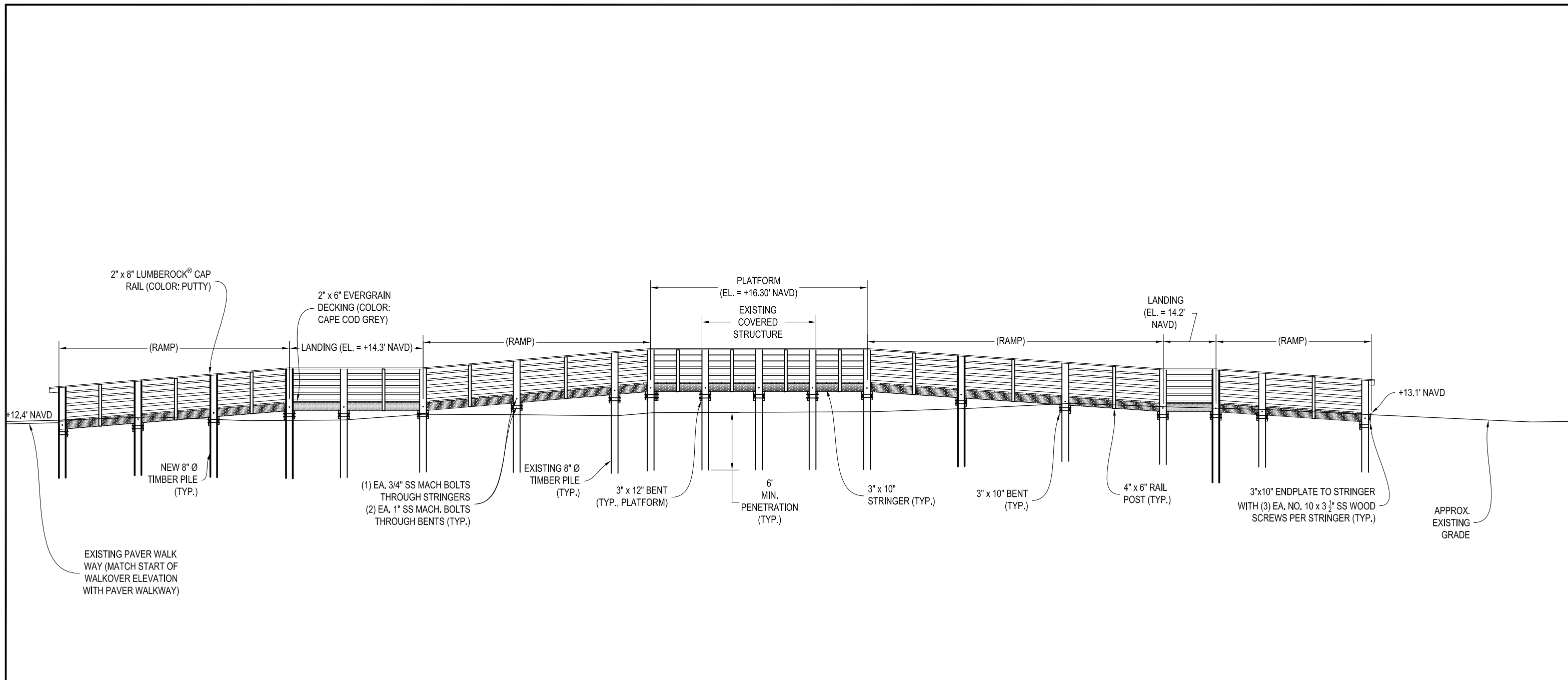

**SOUTH ELEVATION**

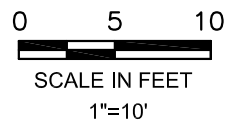

**NOTES:**

1. DATUM IS NAVD.
2. EXISTING CONDITIONS ARE APPROXIMATE BASED ON SURVEY BY MILLER LAND SURVEYING (REV. 10/24/19) AND ON-SITE OBSERVATIONS.
3. ALL STRUCTURAL MEMBERS SHALL BE PRESSURE TREATED ("GROUND CONTACT", AWPA CATEGORY UC4B MINIMUM EQUIVALENT) NO. 1 SOUTHERN YELLOW PINE OR BETTER.
4. ALL BOLTS, WASHERS, NUTS, SCREWS, NAILS, AND OTHER HARDWARE ITEMS SHALL BE 316 STAINLESS STEEL UNLESS SPECIFIED OTHERWISE. ALL BOLTS SHALL HAVE POLISHED FINISH. THREADED ROAD MAY BE SUBSTITUTED FOR BOLTS LONGER THAN 7".
5. SOME TRIM ELEMENTS NOT SHOWN. CONTRACTOR TO CONFIRM DETAILING OF TRIM ELEMENTS PRIOR TO COMMENCEMENT OF CONSTRUCTION.

This item has been electronically signed and sealed by Mark A. Powell P.E. on November 3, 2020 using a Digital Signature. Printed copies of this document are not considered signed and sealed and the signature must be verified on any electronic copies.

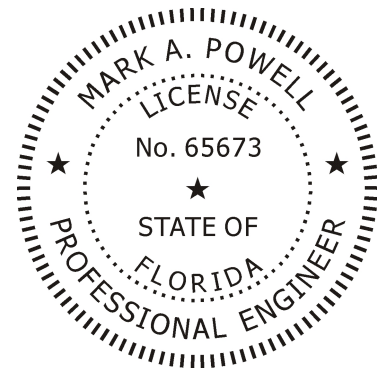

**PRELIMINARY**

**SOUTH ELEVATION**

<p><b>ISIMINGER &amp; STUBBS ENGINEERING, INC.</b>  <small>COASTAL • ENVIRONMENTAL • MARINE          REGISTRY NUMBER: 8114          P.O. BOX 14702 - NORTH PALM BEACH, FL. 33408 - 561-881-0003</small></p>							
<p><b>DUNE WALKOVER CONSTRUCTION</b>  <b>ATLANTIC OCEAN FRONTAGE</b>  <b>530 OCEAN DRIVE (JB-4)</b>  <b>TOWN OF JUNO BEACH, PALM BEACH COUNTY, FL</b>  <b>CLIENT: TOWN OF JUNO BEACH</b></p>							
DATE	10/20	DRAWN	PJK	CHKD	KDB	APPRVD	MAP
DWG NO.	20160B5					SHEET	<b>5</b>
COMPUTER FILE NO.	20160B					OF	8

**FOR BID PURPOSES ONLY. NOT FOR CONSTRUCTION.**

2" x 8" LUMBEROCK CAP RAIL (COLOR: PUTTY). ATTACH TO PILE WITH (3) #10 SS SCREWS. ATTACH TO TOP RAIL, WITH SS #8 SCREW 24" O.C.

ALUM. GRIP ROD BRACKET (EQUALLY SPACE 4 FT. O.C. (MAX.), STAIR SECTION ONLY)

1-1/2" O.D. MARINE GRADE ALUM. GRIP ROD (RAMP SECTIONS ONLY). EXTENSIONS IN ACCORDANCE WITH FBC-ACCESSIBILITY, SECTION 505.10.2 AND 505.10.3 SHALL BE PROVIDED AT NO ADDITIONAL COST.

CHAMFER EXISTING TIMBER PILE (TYP.)

2" x 6" TOP RAIL  
3/8" SS CARRIAGE BOLTS ((2) AT EVERY POST, THIS 2X6 MEMBER)

2" x 6" INTERMEDIATE RAIL (TYP.), ATTACH WITH (1) EA. 3/8" SS CARRIAGE BOLT AND (2) EA. NO. 10 x 3 1/2" SS WOOD SCREWS

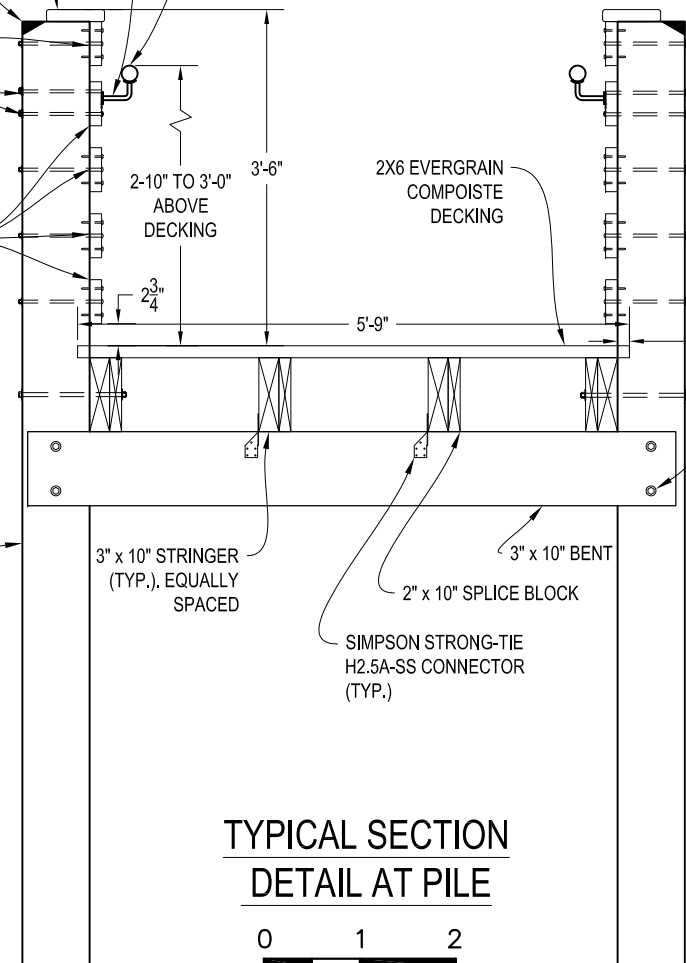

**TYPICAL SECTION  
DETAIL AT PILE**

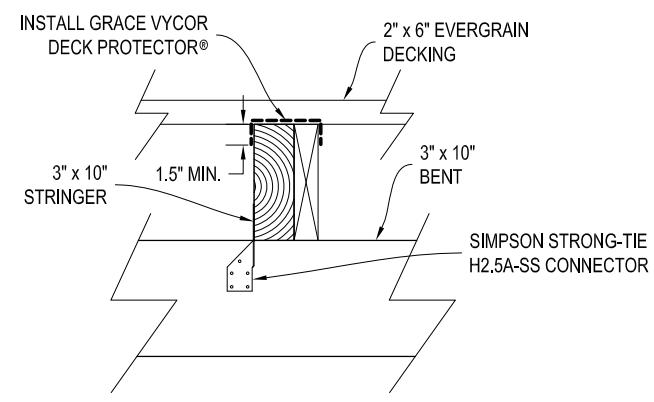
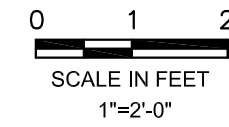

**GRACE VYCOR DETAIL**

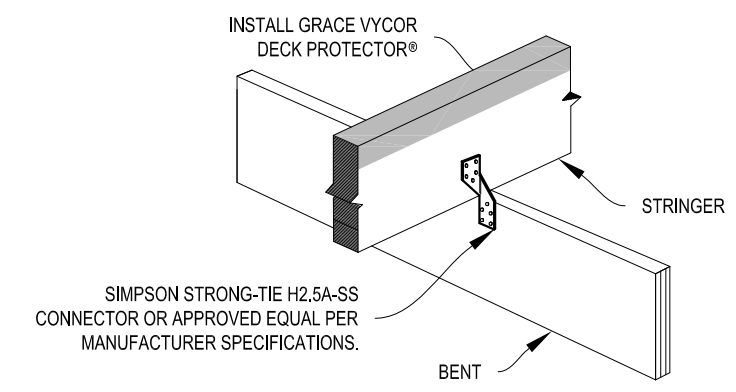
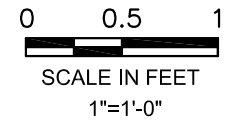

**STRINGER/BENT DETAIL**

NOT TO SCALE

2" x 8" LUMBEROCK CAP RAIL (COLOR: PUTTY). ATTACH TO POST/PILE WITH (2) #10 SS SCREWS (2) PER POST. ATTACH TO TOP RAIL, WITH SS #8 SCREW 24" O.C.

ALUM. GRIP ROD BRACKET (EQUALLY SPACE 4 FT. O.C. (MAX.), RAMP SECTIONS ONLY)

1-1/2" O.D. MARINE GRADE ALUM. GRIP ROD (RAMP SECTIONS ONLY). EXTENSIONS IN ACCORDANCE WITH FBC-ACCESSIBILITY, SECTION 505.10.2 AND 505.10.3 SHALL BE PROVIDED AT NO ADDITIONAL COST.

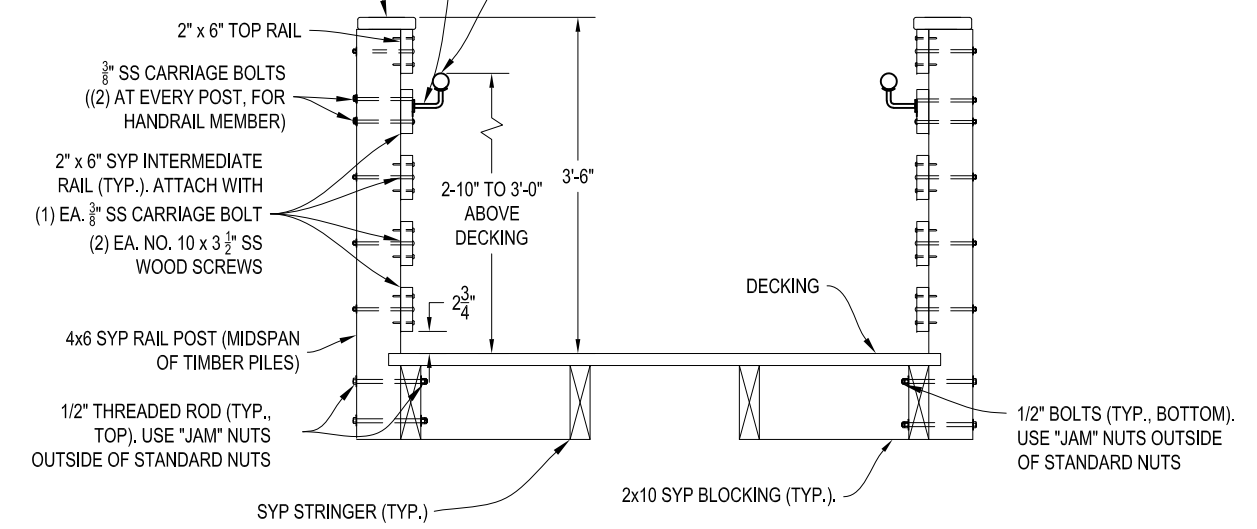

**TYPICAL SECTION DETAIL AT  
INTERMEDIATE RAIL POST**

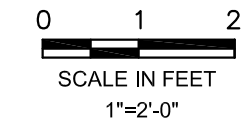

**NOTES:**

- DATUM IS NAVD.
- ALL STRUCTURAL MEMBERS SHALL BE PRESSURE TREATED ("GROUND CONTACT", AWPA CATEGORY UC4B MINIMUM EQUIVALENT) NO. 1 SOUTHERN YELLOW PINE OR BETTER.
- ALL BOLTS, WASHERS, NUTS, SCREWS, NAILS, AND OTHER HARDWARE ITEMS SHALL BE 316 STAINLESS STEEL UNLESS SPECIFIED OTHERWISE. ALL BOLTS SHALL HAVE POLISHED FINISH. THREADED ROAD MAY BE SUBSTITUTED FOR BOLTS LONGER THAN 7". ALUMINUM HANDRAILS SHALL BE ALLOY 6061. CONTRACTOR TO PROVIDE CONNECTION DETAILS TO ENGINEER PRIOR TO ORDERING AND INSTALLING.
- SOME TRIM ELEMENTS NOT SHOWN. CONTRACTOR TO CONFIRM DETAILING OF TRIM ELEMENTS PRIOR TO COMMENCEMENT OF CONSTRUCTION.

This item has been electronically signed and sealed by Mark A. Powell P.E. on November 3, 2020 using a Digital Signature. Printed copies of this document are not considered signed and sealed and the signature must be verified on any electronic copies.

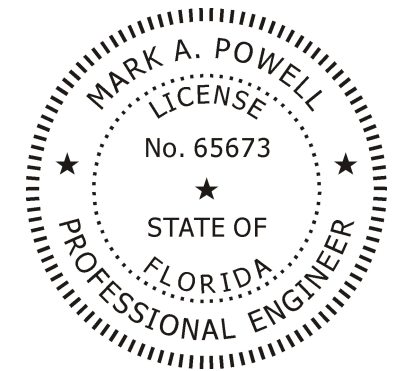

**PRELIMINARY**

FOR BID PURPOSES ONLY. NOT FOR CONSTRUCTION.

**DETAILS**

 ISIMINGER & STUBBS ENGINEERING, INC. COASTAL • ENVIRONMENTAL • MARINE REGISTRY NUMBER: 8114 P.O. BOX 14702 - NORTH PALM BEACH, FL. 33408 - 561-881-0003							
DUNE WALKOVER CONSTRUCTION ATLANTIC OCEAN FRONTAGE 530 OCEAN DRIVE (JB-4) TOWN OF JUNO BEACH, PALM BEACH COUNTY, FL CLIENT: TOWN OF JUNO BEACH							
DATE	10/20	DRAWN	PJK	CHKD	KDB	APPRVD	MAP
DWG NO.	20160B6			SHEET		OF 8	
COMPUTER FILE NO.	20160B					<b>6</b>	

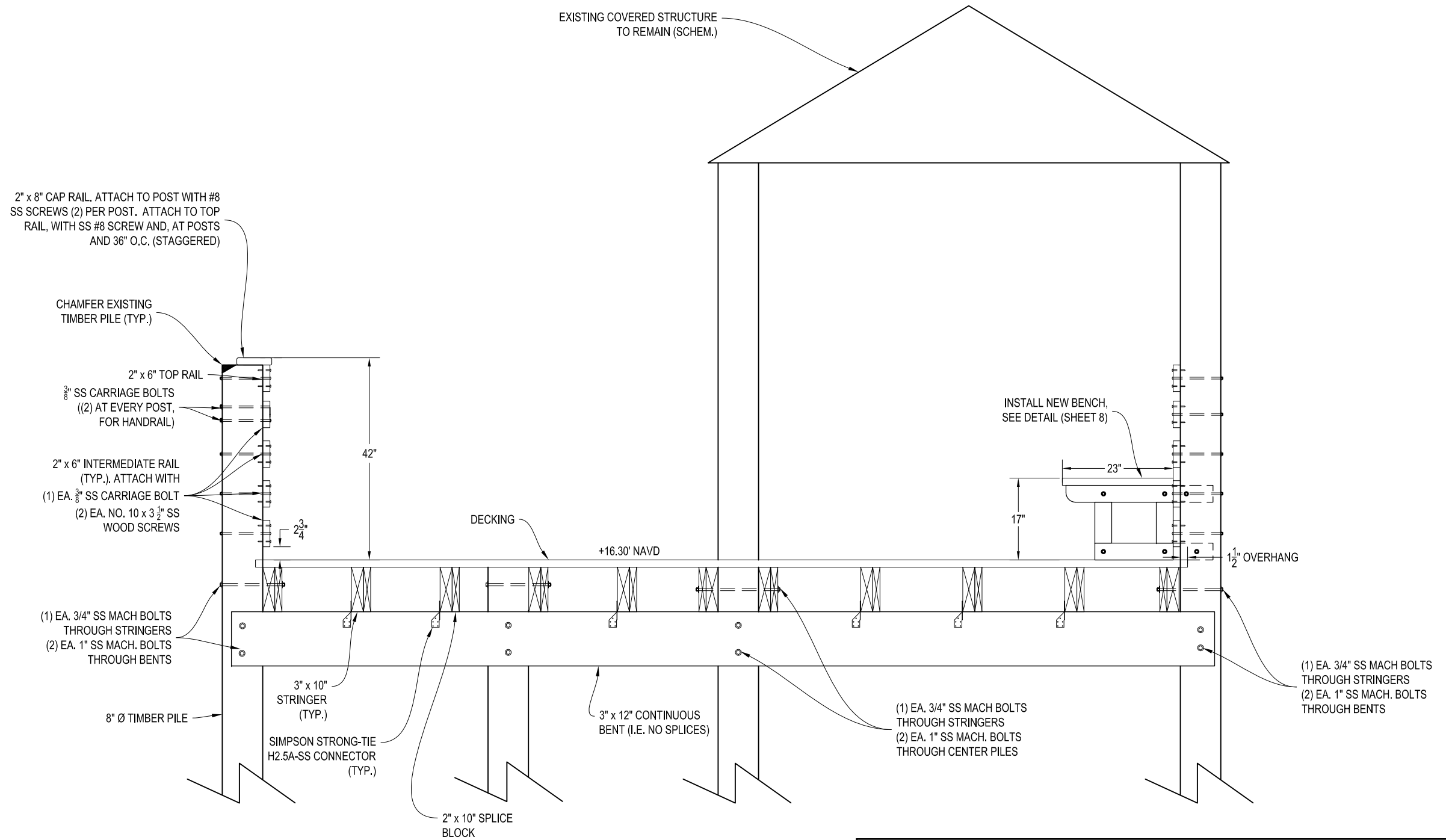

This item has been electronically signed and sealed by Mark A. Powell P.E. on November 3, 2020 using a Digital Signature. Printed copies of this document are not considered signed and sealed and the signature must be verified on any electronic copies.

**NOTES:**

1. DATUM IS NAVD.
2. ALL STRUCTURAL MEMBERS SHALL BE PRESSURE TREATED ("GROUND CONTACT", AWPA CATEGORY UC4B MINIMUM EQUIVALENT) NO. 1 SOUTHERN YELLOW PINE OR BETTER.
3. ALL BOLTS, WASHERS, NUTS, SCREWS, NAILS, AND OTHER HARDWARE ITEMS SHALL BE 316 STAINLESS STEEL UNLESS SPECIFIED OTHERWISE. ALL BOLTS SHALL HAVE POLISHED FINISH. THREADED ROAD MAY BE SUBSTITUTED FOR BOLTS LONGER THAN 7". ALUMINUM HANDRAILS SHALL BE ALLOY 6061. CONTRACTOR TO PROVIDE CONNECTION DETAILS TO ENGINEER PRIOR TO ORDERING AND INSTALLING.
4. SOME TRIM ELEMENTS NOT SHOWN. CONTRACTOR TO CONFIRM DETAILING OF TRIM ELEMENTS PRIOR TO COMMENCEMENT OF CONSTRUCTION.

**PLATFORM SECTION**

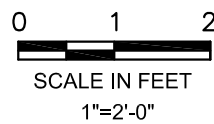

FOR BID PURPOSES ONLY. NOT FOR CONSTRUCTION.

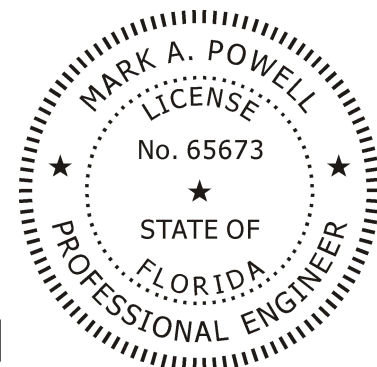

**PRELIMINARY**

**PLATFORM SECTION**

 <b>ISIMINGER &amp; STUBBS ENGINEERING, INC.</b> COASTAL • ENVIRONMENTAL • MARINE <small>REGISTRY NUMBER : 8114          P.O. BOX 14702 - NORTH PALM BEACH, FL. 33408 - 561-881-0003</small>							
<b>DUNE WALKOVER CONSTRUCTION</b> <b>ATLANTIC OCEAN FRONTAGE</b> <b>530 OCEAN DRIVE (JB-4)</b> <b>TOWN OF JUNO BEACH, PALM BEACH COUNTY, FL</b> <b>CLIENT: TOWN OF JUNO BEACH</b>							
DATE	10/20	DRAWN	PJK	CHKD	KDB	APPRVD	MAP
DWG NO.	20160B7					SHEET	
COMPUTER FILE NO.	20160B					OF 8	

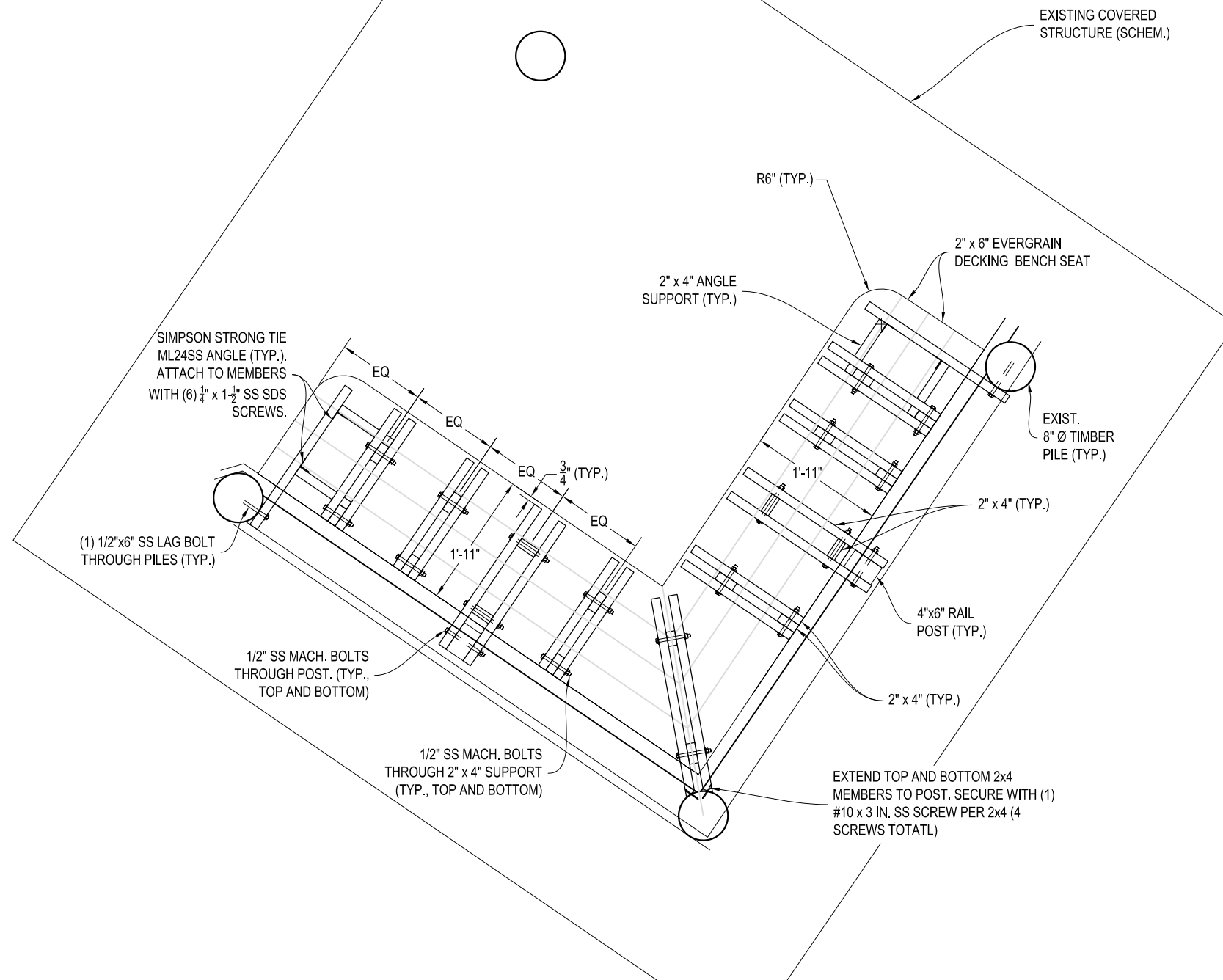

**NOTES:**

1. DATUM IS NAVD.
2. ALL STRUCTURAL MEMBERS SHALL BE PRESSURE TREATED ("GROUND CONTACT", AWPA CATEGORY UC4B MINIMUM EQUIVALENT) NO. 1 SOUTHERN YELLOW PINE OR BETTER.
3. ALL BOLTS, WASHERS, NUTS, SCREWS, NAILS, AND OTHER HARDWARE ITEMS SHALL BE 316 STAINLESS STEEL UNLESS SPECIFIED OTHERWISE. ALL BOLTS SHALL HAVE POLISHED FINISH. THREADED ROAD MAY BE SUBSTITUTED FOR BOLTS LONGER THAN 7". ALUMINUM HANDRAILS SHALL BE ALLOY 6061. CONTRACTOR TO PROVIDE CONNECTION DETAILS TO ENGINEER PRIOR TO ORDERING AND INSTALLING.
4. SOME TRIM ELEMENTS NOT SHOWN. CONTRACTOR TO CONFIRM DETAILING OF TRIM ELEMENTS PRIOR TO COMMENCEMENT OF CONSTRUCTION.

**BENCH DETAIL**

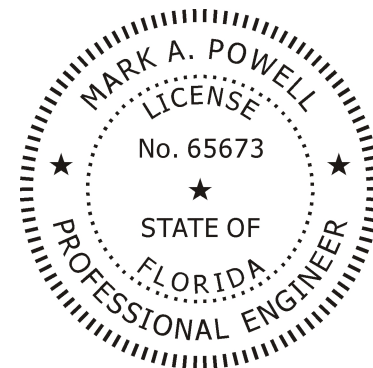
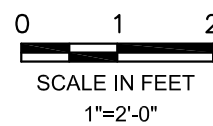

**PRELIMINARY**

FOR BID PURPOSES ONLY. NOT FOR CONSTRUCTION.

This item has been electronically signed and sealed by Mark A. Powell P.E. on November 3, 2020 using a Digital Signature. Printed copies of this document are not considered signed and sealed and the signature must be verified on any electronic copies.

**BENCH DETAIL**

		<b>ISIMINGER &amp; STUBBS ENGINEERING, INC.</b> <small>COASTAL • ENVIRONMENTAL • MARINE          REGISTRY NUMBER: 8114          P.O. BOX 14702 - NORTH PALM BEACH, FL 33408 - 561-881-0003</small>					
<b>DUNE WALKOVER CONSTRUCTION          ATLANTIC OCEAN FRONTAGE          530 OCEAN DRIVE (JB-4)          TOWN OF JUNO BEACH, PALM BEACH COUNTY, FL          CLIENT: TOWN OF JUNO BEACH</b>							
DATE	10/20	DRAWN	PJK	CHKD	KDB	APPRVD	MAP
DWG NO.	20160B8		SHEET		8		
COMPUTER FILE NO.	20160B		OF		8		