

**TOWN OF JUNO BEACH**  
**November 13, 2020, 3:00pm**

**REQUEST FOR PROPOSAL - Renovate Two Dune Walkovers located at 530 & 800  
Ocean Drive**

**SUBJECT: Question and Answers Report**

**1: QUESTION:**

Is there a place to access the beach with equipment?

If so, are we permitted to track equipment down the beach to the jobsites?

**1: ANSWER:**

There are two locations that you could access the beach with equipment- Mercury Road which is south of both job sites and Loggerhead park which is north of both sites. Depending on the beach re-nourishment project that the county is conducting (due to begin the end of November) you could possibly access the job sites with equipment/materials via beach access if necessary.

**2: QUESTION:**

Please clarify the size and quantity of the Simpson MLSS Angle Brackets shown here:

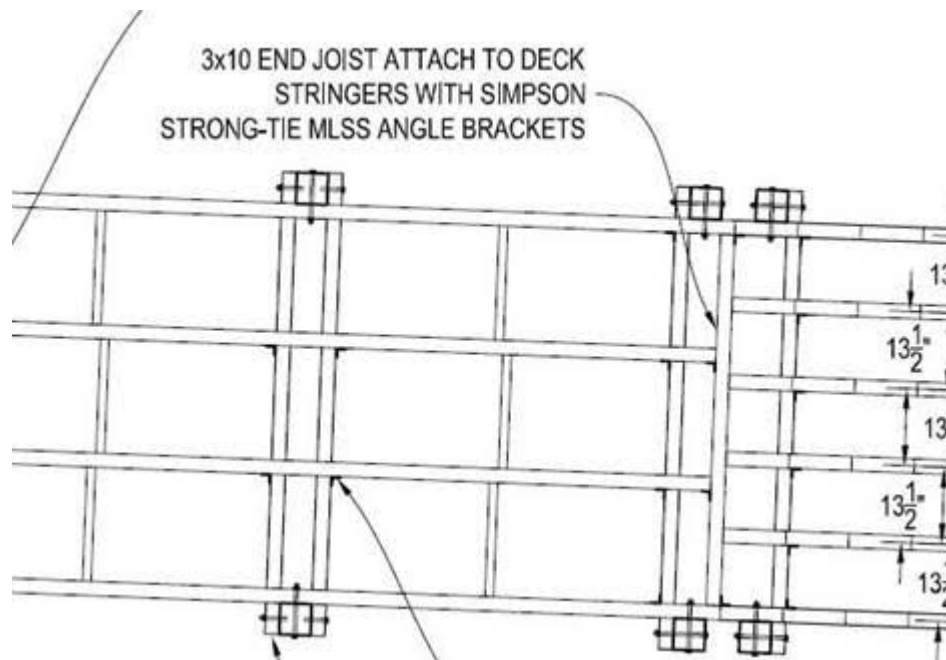

**2: ANSWER:**

**From:** Mark A. Powell [mailto:[mpowell@coastal-engineers.com](mailto:mpowell@coastal-engineers.com)]

Four (4) total ML26 SS angle brackets connecting the end joist to the four (4) stringers of the flat access deck.