

1 OVERALL SITE PLAN
1" = 60'-0"



SHEET GENERAL NOTES

1. PROTECT ADJACENT STRUCTURES, EQUIPMENT, VEHICLES ETC. FROM OVERSPRAY

LEGEND

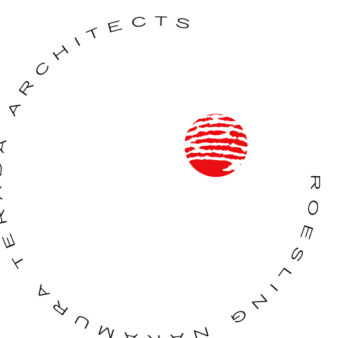

Roesling Nakamura
Terada Architects

285 N Ventura Ave #102
Ventura, CA 93001
P805.626.5330
F805.626.5350
www.RNTarchitects.com

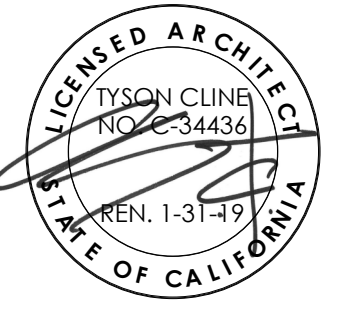

OJAI
UNIFIED
SCHOOL
DISTRICT

NORDHOFF
HIGH SCHOOL
ROOFING
PROJECT

1401 MARICOPA HWY,
OJAI, CA 93023

100% CDs

No.	Description	Date
2	BID ADDEND. 1	11/26/2019

Sheet Name

SITE PLAN

17761.11
Date 01/10/2019
Drawn by CLD
Checked by CY
Sheet Number

AS-100