



# St. Johns River

## Water Management District

Ann B. Shortelle, Ph.D., Executive Director

---

4049 Reid Street • P.O. Box 1429 • Palatka, FL 32178-1429 • (386) 329-4500  
On the Internet at [www.sjrwmd.com](http://www.sjrwmd.com).

DATE: December 26, 2018  
TO: Prospective Respondents  
FROM: Pamela Paulk, Sr. Procurement Specialist  
SUBJECT: Addendum #2 to Invitation for Bid # 33945, Lake Apopka Levee Improvements

As a result of inquiries, and the Pre-bid Meeting the following clarifications/changes are provided for your information. Please make all appropriate changes to your bid documents.

### MODIFICATIONS:

1. A revised sheet C2 is attached that indicates the location of cross-sections 1 and 2.
2. Note 11 on sheet C10 shall be deleted on the drawings issued for construction, and replaced with the following:

11. GEOTEXTILE FABRIC SHALL BE MIRAFI FILTERWAEVE WOVEN NO. FW 404 (OR APPROVED EQUAL) AND SHALL COMPLY WITH THE REQUIREMENTS SECTION 514 OF THE FDOT STANDARD SPECIFICATIONS FOR ROAD AND BRIDGE CONSTRUCTION (LATEST EDITION). ADDITIONALLY, THE GEOTEXTILE FABRIC MATERIAL SHALL CONFORM TO THE REQUIREMENTS FOR TYPE D-2 OF THE FDOT SPECIFICATIONS SECTION 985.

The annotation on Detail 1 will be removed from the drawings issued for construction, to avoid a conflict with Note 11.

3. The District revised the fill quantities to incorporate the 5% allowance mentioned in the Additional Information #1 below and have attached a revised Statement of Work (SOW) and a Revised Cost Schedule to reflect those quantities.
4. Section 1(c) of the Draft Agreement titled **Completion Date** shall be deleted and replaced with the following:
  - (c) The Substantially Completion Date of this Agreement is August 2, 2019 and the Final Completion Date is August 16, 2019, unless extended by mutual written agreement of the parties. The Work shall be completed for use no later than said date.

### QUESTIONS AND ANSWERS

- Q1: Should the Bid Guaranty/Bond be original or a pdf file?  
A1: The Bid Bond shall be the original hard copy that shall be included with the Respondent's jump, pin, etc. drive; both within the sealed envelope.
- Q.2. Will trucking tickets be necessary?  
A.2. Truck tickets are required for riprap delivery and to receive payment for placement.
- Q.3. Are CADD files available for the plans?  
A.3. CADD files are on our FTP website at the following link which do include the revised Sheet C2:  
<ftp://ftp.sjrwmd.com/IFB%20%2333945%20Lake%20Apopka%20Lake%20Levee%20Improvements/>

- Q.4. Will a copy of the Pre-bid meeting sign-in sheet be available?  
A.4. Yes, it is on the FTP website link denoted in A.3. above.
- Q.5. Are the Contractor's required to provide the material?  
A.5. All materials are to be supplied, delivered and placed by the contractor.
- Q.6. May crush-crete be used in place of limerock?  
A.6. Limerock or crush-crete may be used for line items 6 and 7 on Cost Schedule.

**ADDITIONAL INFORMATION:**

1. If the contractor prefers to construct turnouts and back-up to place fill material, the contractor may re-survey the existing levee prior to fill placement at 1,000 foot intervals. For example, the contractor provides survey for the first 1,000 feet for where fill is to be placed, fill is placed to the elevations shown on the cross sections and signed off on by the District. Upon acceptance and prior to further fill placement, the contractor may re-survey the next 1,000 feet and if the survey shows that the levee has settled, the District will accept the new survey as the baseline. No further allowance shall be made once the final grade of the fill placement has been signed off on. If the contractor opts to place the fill material without backing-up (loaded trucks will drive over newly placed fill), the District will allow up to a 5% overage for the areas where loaded trucks drive over placed material. The 5% allowance will be based on the total fill placed in that area. No further allowance shall be made once the final grade of the fill placement has been signed off on. Should the contractor opt to drive over the finish limerock (approximate station 107+00 to station 137+00), the District will allow a 10% overage for limerock placed in this area.
2. Lake Apopka Trail will be closed by the District for through traffic M-F during the construction work.
3. The District will permit empty trucks to drive over the finished limerock surface from approximate station 107+00 to 137+00 +/- . However, the contractor shall be responsible for maintaining the limerock elevation shown on the Contract Drawings.
4. The Pre-Bid Meeting was digitally audio taped and was uploaded the District's FTP site as it and onto Demandstar.com as well. The audio file may be obtained on FTP website referenced above in A.3. and it is titled IFB 33945 Pre-Bid Meeting Audio. The .wma file may be listened to using the Microsoft Media Audio program. Although, it may take a few minutes to down load, should you not be able to open it please contact Pam Paulk for further instructions to access this file.
5. Site map is attached, and includes the laydown areas, access roads, etc.

**NOTE:** The Bid Due Date remains 2:00 p.m., Thursday, January 10, 2019.

Please acknowledge receipt of this Addendum on the BID FORM provided in the bid package.

If you have any questions, please e-mail me at [ppaulk@sjrwmd.com](mailto:ppaulk@sjrwmd.com).

Attachments:

REVISED COST SCHEDULE

REVISED Statement of Work

REVISED Sheet C2 of the Drawings

Site map including the laydown areas, access roads, etc.

Respondent's Name: \_\_\_\_\_

IFB 33945

**REVISED COST SCHEDULE**

Include this form in the response

Bid to be opened at 2:00 p.m., January 10, 2019

To: ST. JOHNS RIVER WATER MANAGEMENT DISTRICT

In accordance with the advertisement requesting bids for the Lake Apopka Lake Levee Improvements, subject to the terms and conditions of the Agreement, the undersigned proposes to perform the Work for the price contained in the following schedule (fill in all blanks). If said bid exceeds the estimated amount previously provided, the District expressly reserves the right to increase, decrease, or delete any class, item, or part of the Work, as may be determined by the District.

Respondents are reminded to refer to "PREPARATION AND ORGANIZATION OF BID DOCUMENTS" for information to be included with the bid package.

The bid will be awarded to the lowest responsive and responsible Respondent for the Total Bid Cost. **RESPONDENTS MUST PROVIDE COSTS FOR ALL LISTED ITEMS.**

<b>REVISED COST SCHEDULE - LAKE APOPKA NORTH SHORE LEVEE IMPROVEMENTS</b>					
<b>ITEM NO.</b>	<b>DESCRIPTION</b>	<b>ESTIMATED QUANTITY</b>	<b>UNIT</b>	<b>COST PER UNIT</b>	<b>TOTAL PRICE (NUMBER)</b>
1	Mobilization	1	LS		
2	Strip Existing Vegetation	1	LS		
3	Place Fill Material (Station 0+00 to 64+00)	7,700	CY		
4	Place Fill Material (Station 66+00 to 117+20 +/-)	6,300	CY		
5	Place Fill Material (Station 129+00 +/- to 232+00 +/-)	7,700	CY		
6	Place 4-inches Limerock Material (station 0+00 to 232+00 +/-)	32,000	SY		
7	Place 8-inches Limerock Material (station 232+00 to 251+50 +/-)	2,300	SY		
8	Place Rip Rap Material	3,900	TN		
9	Vegetative Cover	1	LS		
10	Demobilization	1	LS		
11	Supplemental Work Allowance	1	LS	\$50,000	\$50,000
<b>TOTAL PRICE (Items 1-11)</b>					

**For Total Bid Cost (Price) for Items 1-11 in Words:** \_\_\_\_\_

Cost schedule continued on the next page.

**ATTACHMENT A  
REVISED STATEMENT OF WORK  
LAKE APOPKA NORTH SHORE LEVEE IMPROVEMENTS**

**I. INTRODUCTION/BACKGROUND**

During Hurricane Irma, high water and wave action along the North Shore of Lake Apopka caused the Lake levee to fail/breach. This breach in the levee system allowed water from Lake Apopka to free flow across large portions of the North Shore inundating much of the area and overtopping most internal roadways and levees. Even though this breach has been repaired, it highlighted the need to reconstruct the remaining portions of the Lake levee to minimize this from occurring in the future. This levee not only serves as a separator levee between the Lake and the North Shore but is part of the Apopka Loop Trail from Lake County to Orange County. It is the District's intention to reconstruct the levee from Magnolia Park to Laughlin Road and provide for the continued use by the public (see attached construction drawing cover page).

**II. OBJECTIVE**

The objective of this work is to reconstruct portions of the North Shore levee from Magnolia Park to Laughlin Road to elevation 70-feet NAVD88.

**III. SCOPE OF WORK**

The scope of work generally includes raising the height of the levee with general fill material, placing a 4-inch limerock surface atop the levee and placing riprap or other structural material along the south face of the levee to protect against wave action. All work shall be completed per the attached construction drawings. Work on the levee may occur Monday through Friday. The Wildlife Drive will be open to the public Saturday and Sunday.

**IV. TASK IDENTIFICATION**

Contractor's Responsibilities:

1. Conduct a preconstruction meeting with District operations and land resources staff 48-hours in advance of mobilizing to site. Provide construction sequence plan to District in writing for approval prior to preconstruction meeting.
2. Mobilize all equipment, labor and materials necessary to complete the work.
3. Conduct a pre-construction survey to verify fill quantities estimated by the District. Discuss any discrepancies found by the contractor with District staff.
4. Provide all safety and traffic control necessary for completing the project. This includes barricades and signage indicating that the Loop Trail is closed to through traffic and securing lay-down areas. It should be noted that no Contractor's vehicles are allowed through Magnolia Park.
5. Purchase all materials to complete the work. Material storage areas may be located at Laughlin/Roach intersection, Unit 2 pump station and at Wildlife Drive/Conrad intersection.
6. Construct turn-arounds as necessary to place fill, limerock and riprap. It has been the District's experience that the less truck traffic on the levee, the less material is required to bring the levee to grade.
7. Strip existing vegetation and place at the base of the fill limits along the northern slope.
8. Place and compact fill material as shown on the Contract Drawings including roadway transitions and turn-out at station 18+00 +/- . Maintain a minimum top width of 12-feet (11-feet where riprap is placed). The contractor may place fill in one-lift up to 15-inches in depth. The only areas where more than one lift may be required is between station 45+00 to 60+00 and 70+00 to 96+00. As stated in the Measurement and Payment section, the District is paying for the fill material in-place and compacted.

9. Place and compact 4-inches of limerock to construct new drivable surface – minimum width is 10-feet. Payment shall also include capping roadway transition and turn-out at station 18+00 +/-.
10. Place geotextile and riprap on south slope (lake side) as shown on the drawings to stabilize embankment. Where present regrade existing riprap at toe of slope to create bench for placement of new riprap.
11. Minimize loss of material outside the 12-foot roadway width. The cost associated with excess use of material shall be borne by the Contractor.
12. Regrade grubbing material along northern slope to promote future grass growth.
13. Stabilize with seed and mulch all disturbed areas not receiving limerock or riprap.
14. Any damage to the Wildlife Drive and Conrad Road caused by trucks shall be repaired at no cost to the District. The Contractor shall take before pictures of the entire roadway to ensure that the roadway is not further damaged by truck use. Sharp turning and braking quickly is to be avoided. In addition, the Contractor shall remove any driver that is not complying with safe driving operations.
15. Work when it is raining or the roadway is wet shall be avoided, the District's project manager shall be the sole decision maker as to work commencing or continuing.
16. Demobilize from site. The Contractor shall take care to protect all existing structures, roads, utilities and other improvements from damage. Additionally, the Work will be considered complete only after all rubbish and unused material connected with the Work has been removed and the premises left in a condition satisfactory to the District. All property disturbed or damaged during prosecution of the Work shall be restored to its former condition or better at no additional expense to the District. The contractor shall submit as-builts drawings of all work complete.
17. Complete as-builts drawings of all work completed. As built drawings shall include at a minimum: top of levee elevation, limits of fill and limits of rip rap placement. The as-builts shall be completed as each cross-section provided in the Contract Drawings as well as each roadway transition and the turn-out at station 18+00 +/-.
18. Maintain and submit weekly reports to the District Project Manager.

#### District's Responsibilities:

1. Provide baseline construction staking at each cross-section. Contractor to maintain construction staking.
2. Provide benchmark elevations at beginning and end of project limits.
3. Provide onsite inspection of project.
4. Review weekly reports and approve request for payments.
5. Approve the compaction requirements of the fill placement.
6. Approve limits of transitions and turn-outs for limerock payment
7. Direct the placement of all riprap material
8. Have the sole decision on when trucks can be utilized on the Wildlife Drive due to wet conditions.
9. Notify the contractor when roadways/ haul roads need to be regraded and/or maintained
10. Notify the Contractor of any driver that is not complying with safe operations of the trucks.
11. Provide access to site.

#### PAY ITEMS

1. Mobilization - Lump Sum  
Mobilize personnel and equipment to the site. Establish on-site material staging areas. Contractor shall assume the responsibility of protecting all survey stakes, benchmarks, monuments, etc. Replacement cost for all of these damaged or disturbed items shall be borne by Contractor. Provide all safety and traffic control necessary for access to the site and work within the project limits. Construction and removal of turn-arounds to place materials, maintenance of haul roads (specifically the Wildlife Drive and Conrad Road) and lay-down areas (Laughlin Road/Roach Road, Unit 2 Pump Station and Wildlife Drive/Conrad Road) and all other aspects not consider in other pay items shall be considered under this line item

2. Grub existing vegetation – Lump Sum  
Remove all vegetation to a depth of 2-4 inches under all areas to receive fill, limerock or riprap. Grubbing material shall be placed on the northern slope (land side) at the base of the fill material limits.
3. Place fill material (Station 0+00 to 64+00) – Cubic Yard  
Place and compact all fill material to the limits as shown on the Contract drawings. The District has estimated 7,700 cy of in-place-compacted material will be required to complete the work in this area as shown on the cross-sections provided in the Contract Drawings. This includes fill material to transition Laughlin Road to the Loop Trail station 0+00 +/-), widen the turn-out (station 18+00 +/-) and transition the Wildlife Drive to the Loop Trail (station 63+00 +/-). The contractor shall conduct a pre-construction survey to verify quantity.
4. Place fill material (Station 66+00 to 105+00 +/-) – Cubic Yard  
Place and compact all fill material to the limits as shown on the Contract drawings. The District has estimated 6,300 cy of in-place-compacted material will be required to complete the work in this area as shown on the cross-sections provided in the Contract Drawings. This includes fill material to transition the Wildlife Drive to the Loop Trail (station 66+00 +/-). The contractor shall conduct a pre-construction survey to verify quantity.
5. Place fill material (Station 129+00 +/- to 232+00 +/-) Cubic Yard  
Place and compact all fill material to the limits as shown on the Contract drawings. The District has estimated 7,700 cy of in-place-compacted material will be required to complete the work in this area as shown on the cross-sections provided in the Contract Drawings. This includes fill material to transition Conrad Road to the Loop Trail station 168+00 +/-). The contractor shall conduct a pre-construction survey to verify quantity.
6. Place 4-inches limerock material (station 0+00 to 232+00 +/-) – Square Yard  
Place and compact all limerock material to a uniform depth of 4-inches as shown on the Contract Drawings. The pay item shall only consider a 10-foot wide roadway for payment. In addition, limerock capping of transitions and the turn-out at station 18+00 +/- shall also be paid under this line item; the limits of which shall be field verified by District staff.
7. Place 8-inches limerock material (station 232+00 to 251+50 +/-) – Square Yard  
Place and compact all limerock material to a uniform depth of 8-inches as shown on the Contract Drawings. The pay item shall only consider a 11.5-foot wide roadway for payment, however top width will be maintained at 10-feet.
8. Place riprap material – Square Yard  
Place all riprap as shown on the Contract Drawings. Placement shall include all materials associated with the installation including geotextile. Included in this pay item is the regrading of existing riprap at toe of slope. Additional locations may be requested by District staff during construction, these areas will be discussed with the contractor in the sequence of construction and shall be paid at the unit cost provided
9. Vegetative Cover – Lump Sum  
Seed and mulch all disturbed areas not receiving limerock or riprap. This line item shall include grading the grubbing material that was removed prior to fill placement over the north slope prior to seed and mulch being placed.
10. Demobilization – Lump Sum  
Demobilize, clean site, remove all erosion control measures and submittal of as-built drawings. Contractor shall protect all existing structures, roads utilities and other improvements from damage whether or not shown on the drawings. Contractor shall assume all responsibility for repairs to the utilities and other site improvements damaged during construction. Additionally, the Work will be considered complete only after all rubbish and unused material due to or connected with the Work has been removed and the premises left in a condition satisfactory to the District. All property disturbed or damaged during prosecution of the Work shall be restored to its former condition or better at no additional expense to the District. Final payment will be withheld until such cleanup is completed and approved by the District.
11. Supplemental Work Allowance  
If necessary, this item will be used for increases in the Contract Price within the amount set forth on the Cost Schedule, due to District approved changes in the unit price quantities, unforeseen site conditions, or minor changes to the work.

**V. TIME FRAMES AND DELIVERABLES**

Contractor shall begin work within 15 days of the Effective Date. The Effective Date is the date upon which the last party to this Agreement has dated and executed the same. Contract shall be completed no later than August 16, 2019 after which time liquidated damages shall be assessed as specified in the Agreement.

**VI. BUDGET AND INVOICE REQUIREMENTS**

The District will pay Contractor the lump sum amount for each lump sum item and the unit cost for each unit cost item submitted on its Cost Schedule. The quantities may vary for those items requiring a “per unit cost” and the total quantities of each of these items will be determined during construction. The District reserves the right to increase, decrease, or delete any class, item, or part of the Work at the stated unit prices in determining the value of a change order.

**Project Manager**

David Watt  
Supervising Engineer  
Phone: 386-329-4355  
Cell: 386-937-0536  
Email: [dwatt@sjrwmd.com](mailto:dwatt@sjrwmd.com)

**Project Inspector**

Rayford (Flint) McCain  
Engineering Construction Inspector  
Phone: 321-473-1332  
Cell: 321-212-9329  
Email: [rmccain@sjrwmd.com](mailto:rmccain@sjrwmd.com)

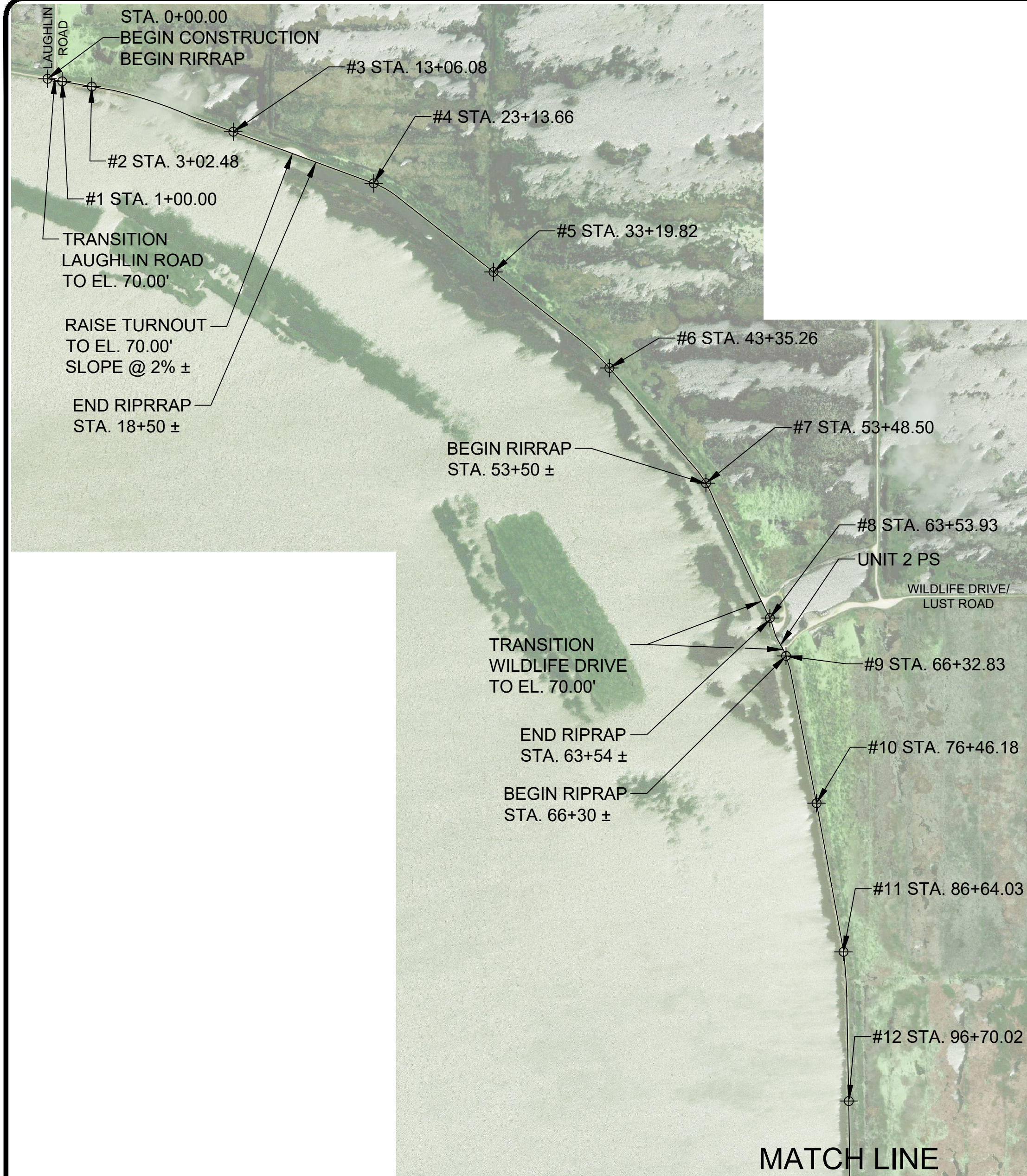

MATCH LINE

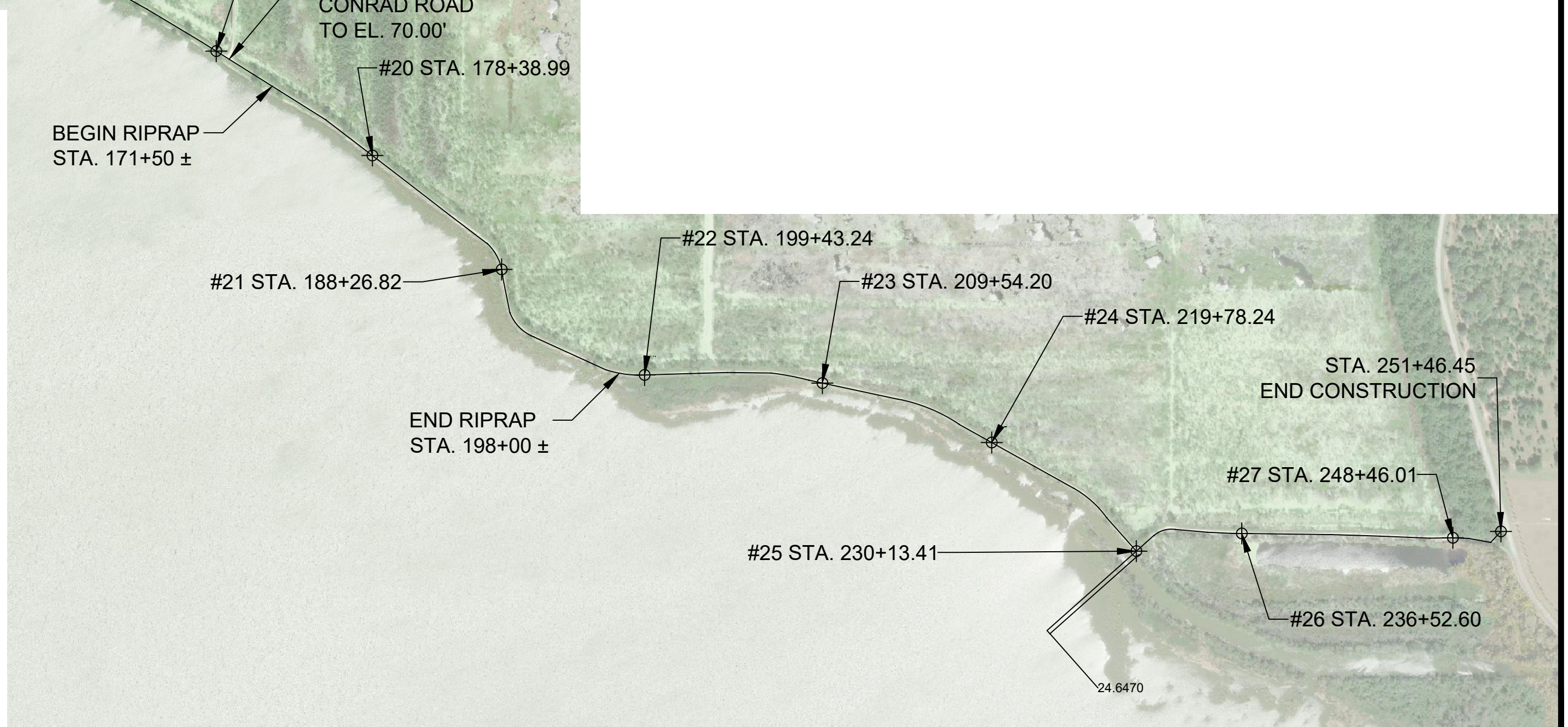
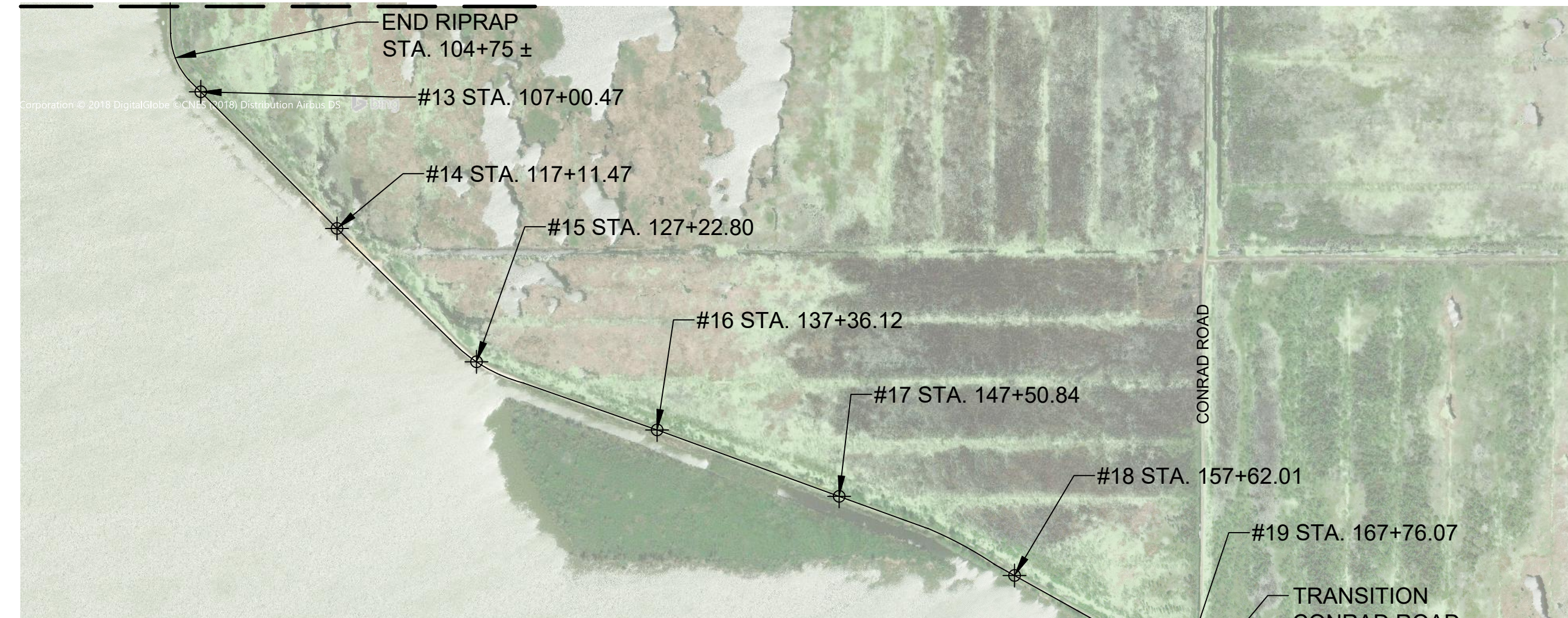

NOTES:  
 1. ALL ELEVATIONS SHOWN HEREON ARE REFERENCE TO NAVD(88)  
 2. ALL COORDINATES SHOWN HEREON ARE REFERENCE TO HPGN AND, PROJECTED TO FLORIDA EAST.  
 3. THIS SKETCH MAY HAVE BEEN SHRUNKEN OR ENLARGED FROM ITS ORIGINAL AND MAY NOT BE TO SCALE.

**FOR BID PURPOSES  
 ONLY NOT FOR  
 CONSTRUCTION**

L:\Projects\CADD\APOPKA LAKE LEVEE IMPROVEMENTS\CONSTRUCTION\C2\LALLOSPN.dwg

NO.	REVISION	BY	DATE	APPROVED	DATE

UPPER OCKLAWAHA RIVER BASIN  
 LAKE APOPKA LAKE LEVEE IMPROVEMENTS  
 ORANGE COUNTY, FLORIDA

ST. JOHNS RIVER  
 WATER MANAGEMENT DISTRICT  
 P.O. BOX 1429 PALATKA, FLORIDA

DRAWN: N.J.G. DATE: DECEMBER 14, 2018 REVIEWER: D.R.W.  
 SCALE: 1" = 600' DESIGNER: E.C.B. SECTION CHIEF: W.R.C.

OVERALL SITE PLAN

CERTIFICATION:  
 P.E. NUMBER: \_\_\_\_\_  
 DATE: DECEMBER 14, 2018

FILE NAME:  
 CZLALLOSPN.dwg  
 PROJECT NO.: \_\_\_\_\_  
 SHEET:  
 C2



