

Addendum 1

City of Canton, Ohio
Purchasing Department
218 Cleveland Ave. SW, 4th floor
Canton, Ohio 44702

STA-13th Street NW Request for Qualifications

Item/Project

Engineering

Responsible Department

April 4, 2020 at 4:00 PM local time

Qualifications Due On or Before

Qualifications Submitted By:

Company Name

Street Address

City

State

Zip

Contact Person

Phone No.

Email Address

1. Conceptual plans and drawings are provided for informational purposes.

End of Addendum

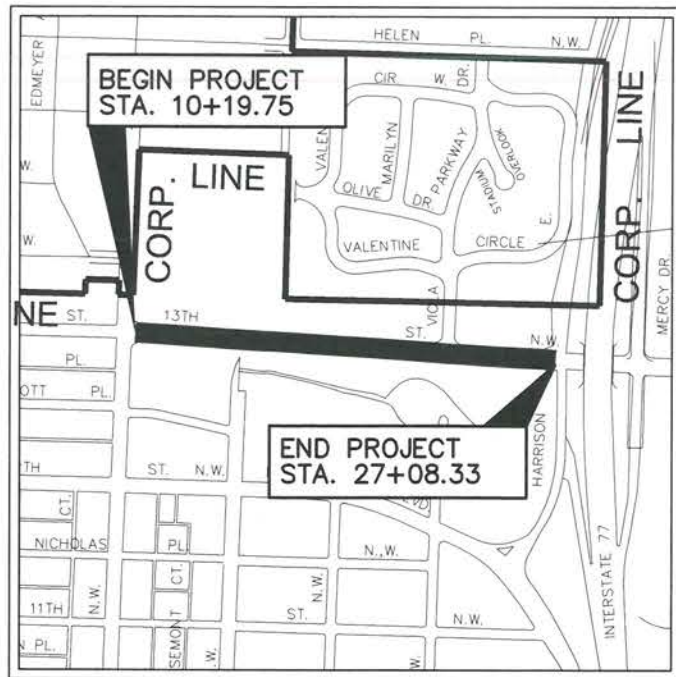

LOCATION MAP
NTS



PORTION TO BE IMPROVED

DESIGN DESIGNATION

CURRENT A.D.T. (2019) = 15,800
 DESIGN YEAR A.D.T. (2039) = 15,800
 DESIGN SPEED = 35 MPH
 LEGAL SPEED = 35 MPH
 FUNCTIONAL CLASSIFICATION = PRINCIPAL ARTERIAL

UNDERGROUND UTILITIES
 TWO WORKING DAYS
BEFORE YOU DIG
 CALL 1-800-362-2764 (TOLL FREE)
 OHIO UTILITIES PROTECTION SERVICE
 NON-MEMBERS
 MUST BE CALLED DIRECTLY

PLAN PREPARED BY:

OFFICE OF THE CITY ENGINEER
 CANTON, OHIO
 DANIEL J. MOEGLIN, P.E., CITY ENGINEER
 2436 30th STREET N.E. 44705 (330)489-3381

<p>ENGINEERS SEAL:</p> <p>SIGNED: </p> <p>DATE: 02-25-2020</p> <p>SHEETS: 1-8, 10-16</p>	<p>ENGINEERS SEAL:</p> <p>SIGNED: </p> <p>DATE: 02-18-2020</p> <p>SHEETS: 9, 12</p>
--	---

CITY OF CANTON

13TH STREET NW RECONSTRUCTION

G.P. 1248 PID 104873

CANTON, OHIO

INDEX OF SHEETS:

TITLE SHEET	1
SCHEMATIC	2
TYPICAL SECTIONS	3
GENERAL NOTES	4-6
MAINTENANCE OF TRAFFIC	7
GENERAL SUMMARY	8
STORM WATER POLLUTION PREVENTION PLAN	9
PLAN SHEETS	10-13
SIGNING AND PAVEMENT MARKINGS	14
STREETSCAPE/CONDUIT PLAN	15-16
SANITARY SEWER FORCE MAIN PLAN	17
SANITARY GRAVITY SEWER PLAN	18
CANTON STANDARD CONST. DWGS.	APPENDIX

STANDARD CONSTRUCTION DRAWINGS				SUPPLEMENTAL SPECIFICATIONS
ODOT	ODOT	CANTON		ODOT
BP-3.1 10/18/19	MT-95.31 7/19/19	STD. DWG. 1		832 10/19/18
	MT-95.32 4/19/19	STD. DWG. 10 APP		907 10/18/19
HL-30.22 1/17/14	MT-95.41 7/21/17	STD. DWG. 11		
	MT-95.50 7/21/17	STD. DWG. 12		
TC-41.20 10/18/13	MT-99.20 4/19/19	STD. DWG. 13		
TC-71.10 1/19/18	MT-101.90 7/21/17	STD. DWG. 18		CANTON
	MT-105.10 7/19/13	STD. DWG. 19		SS-01
		STD. DWG. 20		SS-02-00
		STD. DWG. 27		SS-03-00
		STD. DWG. 29		SS-04-01
		STD. DWG. 30		
		STD. DWG. 40		
		STD. DWG. 41		
		STD. DWG. 42		
		STD. DWG. 43		
		STD. DWG. 62		SPECIAL PROVISIONS
		STD. DWG. 63		
		STD. DWG. 64		
		STD. DWG. 65		

PROJECT DESCRIPTION

THE PROJECT SHALL CONSIST OF REMOVAL OF EXISTING CONCRETE ROADWAY AND CONSTRUCTION OF A NEW ASPHALT ROADWAY. ROADWAY WORK INCLUDES NEW CURBS, CATCH BASIN RECONSTRUCTIONS, CASTING ADJUSTMENTS, NEW SIDEWALK AND STREETSCAPING (DECORATIVE STREET LIGHTS, TREE GRATES, BRICK BOXES) ON THE SOUTH SIDE OF THE ROAD. THE PROJECT ALSO INCLUDES SANITARY SEWER WORK WHICH CONSISTS OF A NEW 8" DIAMETER GRAVITY SEWER AND REPLACEMENT 10" DIAMETER FORCE MAIN.

PROJECT EARTH DISTURBED AREA: 2.66 ACRES
 ESTIMATED CONTRACTOR EARTH DISTURBED AREA: 0.25 ACRES
 NOTICE OF INTENT EARTH DISTURBED AREA: 4.90 ACRES

2019 SPECIFICATIONS

THE STANDARD SPECIFICATIONS OF THE STATE OF OHIO, DEPARTMENT OF TRANSPORTATION AND THE CITY OF CANTON, INCLUDING CHANGES AND SUPPLEMENTAL SPECIFICATIONS LISTED IN THE PROPOSAL SHALL GOVERN THIS IMPROVEMENT.

CITY OF CANTON, OHIO
 MAYOR
 THOMAS M. BERNABEI

DIRECTOR OF PUBLIC SERVICE
 JOHN HIGHMAN

DIRECTOR OF PUBLIC SAFETY
 ANDREA PERRY

WARD COUNCIL MEMBER
 GREG HAWK, WARD 1

CITY CIVIL ENGINEER
 DANIEL J. MOEGLIN, P.E.

APPROVED
 DATE 2/25/20 CITY ENGINEER, CITY OF CANTON

OFFICE OF THE CITY ENGINEER
 CANTON, OHIO
 DANIEL J. MOEGLIN, P.E., CITY ENGINEER
 2436 30th STREET N.E. 44705 (330)489-3381

13TH STREET NW RECONSTRUCTION

PID NO. 104873

GENERAL PROJECT NO. 1248

RAILROAD INVOLVEMENT NONE

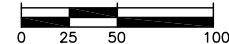
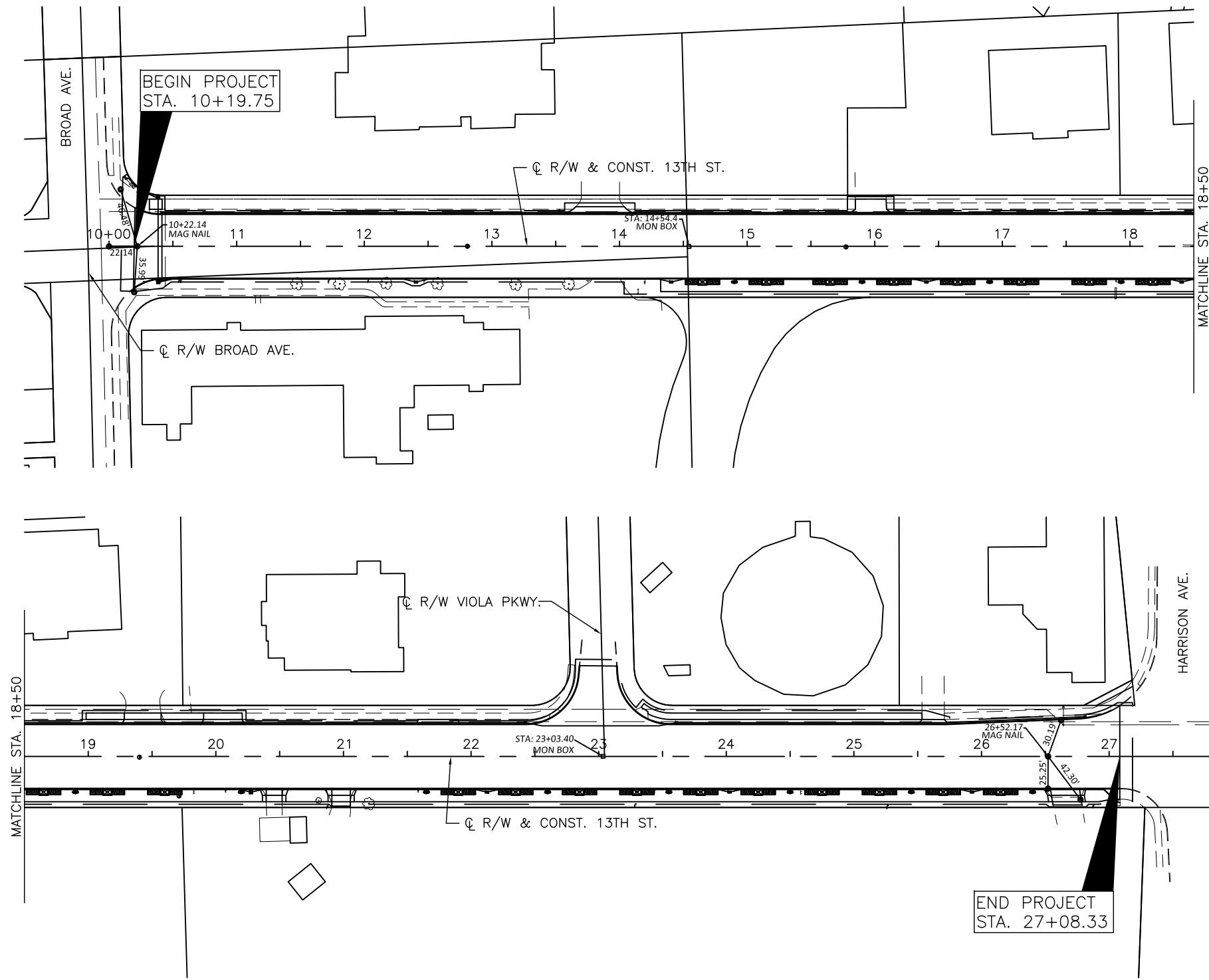

- NOTES:**
1. THE BEARING OF THE CENTERLINE OF 13TH ST. COINCIDES WITH THE EXISTING CENTER PAVEMENT JOINT.
 2. STATIONING IS TIED TO PK NAILS LOCATED ALONG THE CENTER JOINT.

CONTROL POINTS

ID	NORTHING	EASTING	ELEV.	DESCRIPTION
BM1	419114.304	2272994.365	1103.09	BM - CHISLED X ON THE SOUTH BONET BOLT ON A FH LOCATED ON THE NW CORNER OF 13 ST & VIOLA PKWY
BM2	418978.685	2273416.565	1104.08	BM - NE CORNER OF A CONC. PAD FOR A TRANSFORMER LOCATED ON THE SW CORNER OF 13TH ST & HARRISON AVE
BM3	419031.651	2272717.192	1095.53	BM - BENCH TIE APPROX. 1' UP THE NORTH SIDE OF A PP ID#AEP 795A3-268 LOCATED ON THE SOUTH SIDE OF 13TH ST. 285 FT WEST OF VIOLA PKWY.
CP1	419361.657	2273038.306	1111.04	CNPT -5/8IN X 30IN IRON REBAR W/ RED GPD CAP
CP2	419010.300	2273000.592	1098.30	CNPT -5/8IN X 30IN IRON REBAR W/ RED GPD CAP
CP3	419096.215	2272681.909	1095.06	CNPT -5/8IN X 30IN IRON REBAR W/ RED GPD CAP
CP4	419039.358	2273525.636	1105.24	CNPT -8IN MAGS
CP5	419010.344	2272724.712	1092.52	CNPT -8IN MAGS

OFFICE OF THE CITY ENGINEER
 CANTON, OHIO
 DANIEL J. MOEGLIN, P.E., CITY ENGINEER
 2436 30th STREET N.E. 44705 (330)488-3381

SCHEMATIC PLAN
13TH STREET NW RECONSTRUCTION

REVISIONS	DATE	BY

DATE: 3/22/19	DRAWN BY: NJL
H. SCALE:	APPROVED BY:
V. SCALE:	FIELD BOOK:
SHEET 2 OF 18	FILE NAME: 13th St Schematic

TYPICAL SECTION
 13TH ST. NW RECONSTRUCTION

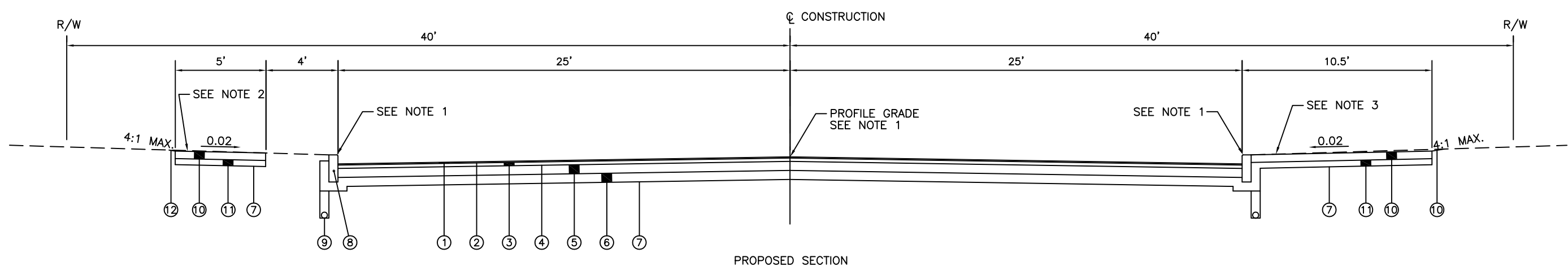
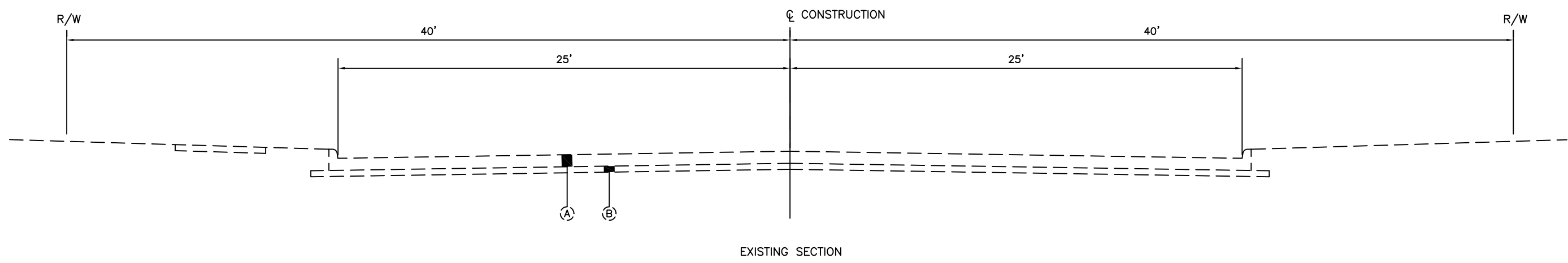

LEGEND

- ① 424 - 3/4" FINE GRADED POLYMER ASPHALT CONCRETE, TYPE A
 - ② 407 - TACK COAT
 - ③ 441 - 2 1/4" ASPHALT CONCRETE INTERMEDIATE COURSE, TYPE 1, (448)
 - ④ 407 - TACK COAT FOR INTERMEDIATE COURSE
 - ⑤ 301 - 6" ASPHALT CONCRETE BASE, PG 64-22
 - ⑥ 304 - 6" AGGREGATE BASE
 - ⑦ 204 - SUBGRADE COMPACTION
 - ⑧ 609 - CURB, MISC.: CANTON CITY STANDARD
 - ⑨ 605 - 4" BASE PIPE UNDERDRAINS WITH FABRIC
 - ⑩ 608 - 5" CONCRETE WALK
 - ⑪ 304 - 4" AGGREGATE BASE
 - ⑫ 659 - SEEDING AND MULCHING
-
- (A) EXISTING 8" REINFORCED CONCRETE PAVEMENT
 - (B) EXISTING 4" AGGREGATE BASE

- NOTES:
1. PROPOSED ELEVATIONS SHALL MATCH EXISTING. THE CONTRACTOR SHALL DETERMINE EXISTING ELEVATIONS VIA SURVEY PRIOR TO REMOVAL.
 2. REPLACE EXISTING WALK WHERE SHOWN IN PLANS. INSTALL NEW WALK BETWEEN STA. 23+33 AND STA. 25+53.
 3. REFER TO STREETSCAPE PLAN AND CANTON CITY STANDARD DRAWINGS 40-43 FOR TREE GRATE AND BRICK BOX DETAILS.

DATE	REVISIONS	DESCRIPTION	BY
3/13/19			
H. SCALE: N/A			
V. SCALE: N/A			
SHEET 3 OF 18			

DRAWN BY: NUL
 APPROVED BY:
 FIELD BOOK:
 FILE NAME: 13th St Typ Sect

I. PRECONSTRUCTION INCIDENTALS

PROJECT SPECIFICATIONS/REQUIREMENTS:

ALL WORK REQUIRED TO COMPLETE THIS IMPROVEMENT SHALL BE PERFORMED IN ACCORDANCE WITH SPECIFICATIONS/REQUIREMENTS OF THE CITY OF CANTON AND THE LATEST EDITION OF THE STATE OF OHIO DEPARTMENT OF TRANSPORTATION CONSTRUCTION AND MATERIAL SPECIFICATIONS, EXCEPT AS HEREIN AMENDED. IN THE CASE OF A CONFLICT BETWEEN THE CITY OF CANTON AND THE OHIO DEPARTMENT OF TRANSPORTATION SPECIFICATIONS/REQUIREMENTS, THE CITY OF CANTON REQUIREMENTS WILL TAKE PRECEDENCE, UNLESS OTHERWISE DIRECTED BY THE CITY ENGINEER.

THE DEVELOPER/CONTRACTOR SHALL COMPLY WITH THE CITY OF CANTON SUPPLEMENTAL SPECIFICATION 01-00 PROJECT DOCUMENTATION AND SUBMITTAL REQUIREMENTS.

ADMINISTRATIVE REQUIREMENTS:

THE CONTRACTOR SHALL BE RESPONSIBLE FOR FULLY COMPLYING WITH ALL THE ADMINISTRATIVE DUTIES HEREIN CONTAINED.

THE CONTRACTOR SHALL DESIGNATE TO THE CITY AN EMPLOYEE RESPONSIBLE FOR CORRESPONDENCE, NOTIFICATIONS, AND SUBMITTALS PERTINENT TO THE PROJECT.

PRECONSTRUCTION MEETING:

A PRECONSTRUCTION MEETING WITH THE CONTRACTOR, REPRESENTATIVES OF ALL UTILITY COMPANIES, THE CITY OF CANTON ENGINEERING DEPARTMENT AND THE CITY OF CANTON WATER DEPARTMENT IS REQUIRED FOR THIS PROJECT PRIOR TO THE START OF ANY CONSTRUCTION ACTIVITY.

THE CITY ENGINEER WILL CONTACT THE CONTRACTOR TO ARRANGE A MEETING DATE. THE CITY ENGINEER WILL CONTACT THE ABOVE AGENCIES TO CONFIRM THE MEETING DATE.

IF THE PROPOSED PROJECT LAND-DISTURBANCE AREA IS ONE (1) OR MORE ACRES, A SEPARATE PRE-CONSTRUCTION MEETING IS ALSO REQUIRED. THIS MEETING SHALL OCCUR ON-SITE BETWEEN THE CONTRACTOR AND THE STARK SOIL & WATER CONSERVATION DISTRICT (SWCD). THE CONTRACTOR IS RESPONSIBLE FOR ARRANGING THIS MEETING. NO LAND-DISTURBANCE ACTIVITIES SHALL START UNTIL SAID MEETING HAS OCCURRED AND APPROVAL HAS BEEN GRANTED BY STARK SWCD.

PROJECT SAFETY:

THE CONTRACTOR SHALL MAINTAIN A SAFE WORKING ENVIRONMENT AT THE PROJECT SITE AT ALL TIMES. THE CONTRACTOR SHALL PROPERLY SUPPORT AND/OR MAINTAIN ALL EXCAVATIONS PER APPLICABLE SAFETY REQUIREMENTS AND COMPLY WITH ALL O.S.H.A. REGULATIONS. APPROPRIATE BARRICADES, WARNING LIGHTS, SIGNS, FENCING, ETC. SHALL BE ERECTED AROUND THE CONSTRUCTION AREA DURING ALL NON-WORKING HOURS TO ALERT PERSONS OF THE POTENTIAL DANGER ASSOCIATED WITH THE AREA UNDER CONSTRUCTION AS WELL AS TO PREVENT ACCESS BY UNAUTHORIZED PERSONNEL TO THE CONSTRUCTION SITE/AREA. THE CONTRACTOR IS RESPONSIBLE FOR ENSURING THE SAFETY OF THE GENERAL PUBLIC AS WELL AS ALL CONSTRUCTION PERSONNEL. PUBLIC STREETS SHALL BE KEPT CLEAN AND FREE OF DEBRIS (MUD, STONE, ETC.) AT ALL TIMES. THE CONTRACTOR SHALL ALERT ALL LOCAL EMERGENCY AGENCIES (FIRE, POLICE, AMBULANCE, ETC.) OF THE NATURE OF THE PROPOSED PROJECT PRIOR TO BEGINNING AND CONSTRUCTION ACTIVITY. ACCESS FOR EMERGENCY VEHICLES SHALL BE MAINTAINED AT ALL TIMES.

UNDERGROUND UTILITIES:

THE LOCATIONS OF EXISTING UNDERGROUND UTILITIES SHOWN ON THE PLANS WERE OBTAINED BY FIELD OBSERVATIONS, FROM EXISTING RECORDS, AND/OR FROM THE OWNERS OF THE RESPECTIVE UTILITIES. THE INFORMATION AS SHOWN IS BELIEVED TO BE CORRECT; HOWEVER, THE COMPLETENESS AND ACCURACY OF THIS INFORMATION CANNOT BE GUARANTEED. THE CONTRACTOR SHALL BE RESPONSIBLE TO CONTACT ALL THE VARIOUS UTILITY COMPANIES (PUBLIC AND PRIVATE) TO VERIFY THE EXISTENCE, LIMITS AND/OR LOCATION OF ANY UTILITIES WHICH MAY BE ALONG THE ROUTE OR WITHIN THE VICINITY OF THIS IMPROVEMENT.

UTILITY NOTIFICATION:

AT LEAST TWO WORKING DAYS PRIOR TO COMMENCING OPERATIONS ON THIS PROJECT, THE CONTRACTOR SHALL NOTIFY THE CITY ENGINEER, THE REGISTERED UTILITY PROTECTION AGENCY/SERVICE, AND THE OWNERS OF ANY OTHER UTILITIES (PUBLIC AND/OR PRIVATE) THAT MAY HAVE UTILITY LINES OR FACILITIES WITHIN THE VICINITY OF THIS PROJECT BUT WHO ARE NOT MEMBERS OF THE REGISTERED UTILITY PROTECTION SERVICE. THE OWNERS OF ANY UNDERGROUND UTILITY FACILITY SHALL, WITHIN 48 HOURS AFTER NOTICE IS RECEIVED, EXCLUDING SATURDAYS, SUNDAYS AND OTHER LEGAL HOLIDAYS; STAKE, MARK OR OTHERWISE DESIGNATE THE EXISTENCE AND/OR LOCATION OF THE UNDERGROUND UTILITY FACILITIES IN THE CONSTRUCTION AREA IN SUCH A MANNER AS TO INDICATE THEIR COURSE TOGETHER WITH THE APPROXIMATE DEPTH AT WHICH THEY WERE INSTALLED. THE MARKING AND/OR LOCATING SHALL BE COORDINATED TO STAY APPROXIMATELY TWO WORKING DAYS AHEAD OF THE PLANNED CONSTRUCTION.

OHIO UTILITIES PROTECTION SERVICE: 1-800-362-2764 (CONTACT NON-MEMBERS DIRECTLY).

THE PRIMARY UTILITIES WITHIN THE CITY OF CANTON AREA:

NATURAL GAS DIST./TRANS.
DOMINION EAST OHIO GAS
320 SPRINGSIDE DR.
AKRON, OHIO 44333
330-664-2541
ATTN: KEVIN BIRT
RELOCATION@DOM.COM
EMERGENCY NO.
1-800-521-4400

TELEPHONE
AT&T
50 WEST BOWERY STREET
AKRON, OHIO 44308
ATTN: STEVE HYLTON
330-384-3055
EMERGENCY NO. - 24 HRS
1-800-572-4545 OPTION#4

COMMUNICATIONS CABLE
CHARTER (SPECTRUM)
5520 WHIPPLE AVE N.W.
NORTH CANTON, OHIO 44720
330-633-9203
ext. 216-555-4261
ATTN: MIKE MEYER
216-618-2528(CELL)

ELECTRIC
AMERICAN ELECTRIC POWER
301 CLEVELAND AVE. S.W.
P.O. BOX 24400
CANTON, OHIO 44701-4400
330-438-7739
ATTN: MICHAEL ALLMAN
330-312-6981 (CELL)
ATTN: KEITH SCHALMO
330-438-7720
EMERGENCY NO.
1-800-672-2017

SANITARY AND STORM SEWER
CITY ENGINEER'S OFFICE
2436-30TH ST. N.E.
CANTON, OHIO 44705
ATTN: DAN MOEGLIN
330-489-3381

WATER
CANTON WATER DEPT.
2664 HARRISBURG RD. N.E.
CANTON, OHIO 44708
ATTN: BRENT BURRIER OR
LEWI MILLER
330-489-3310

TRAFFIC INTERCONNECT
CITY ENGINEER'S OFFICE
2436-30TH ST. N.E.
CANTON, OHIO 44705
ATTN: NICK LOUKAS
330-489-3381

THE CITY ENGINEER'S OFFICE IS TO BE CONTACTED DIRECTLY FOR SANITARY AND STORM SEWER AND TRAFFIC INTERCONNECT FACILITIES LOCATION: 330-489-3381.
[UTILITY CONTACTS LAST UPDATED 1/11/2018]

EXPLORATORY BORINGS:

EXPLORATORY SOIL BORING INFORMATION IS NOT THE RESPONSIBILITY OF THE CITY OF CANTON. IT IS THE CONTRACTOR RESPONSIBILITY TO REVIEW ANY AND ALL INFORMATION AVAILABLE. IF DEVELOPER/CONTRACTOR REQUESTS TO DRILL AND OR EXCAVATE WITHIN THE CITY'S R/W, THE CONTRACTOR SHALL NOTIFY THE CITY ENGINEER AT LEAST 3 WORKING DAYS PRIOR TO THIS WORK. THE CONTRACTOR SHALL BE RESPONSIBLE FOR ALL UTILITY NOTIFICATION, AS SPECIFIED, ALL TRAFFIC CONTROL, PREMIUM BACKFILL, AND COMPACTION AND RESTORATION, AS NECESSARY.

CONTINGENCY QUANTITIES:

WHEN SPECIFIED ON PLANS OR SPECIFICATIONS, CONTINGENCY QUANTITIES ARE TO BE PERFORMED ONLY UNDER DIRECTION OF THE CITY ENGINEER. THE CONTRACTOR SHALL NOT ORDER ANY CONTINGENCY MATERIAL OR PERFORM ANY WORK UNTIL DIRECTED BY THE ENGINEER. THE ACTUAL WORK LOCATION AND QUANTITIES FOR SUCH ITEMS SHALL BE DOCUMENTED BY THE CONTRACTOR AND THE ENGINEER.

PROJECT SCHEDULE AND COMPLETION:

THE WORK EMBRACED IN THIS CONTRACT SHALL BE COMPLETE 180 CALENDAR DAYS AFTER THE NOTICE PROCEED (NTP). IF WEATHER CONDITIONS DO NOT ALLOW FOR THE PLACEMENT OF THE 424 ASPHALT SURFACE COURSE, THE ASPHALT SURFACE COURSE AND FINAL CASTING ADJUSTMENTS MAY BE PERFORMED AFTER THE WINTER SHUTDOWN, BY MAY 31, 2021. (SEE MAINTENANCE OF TRAFFIC NOTES)

WORK SHALL BE SUSPENDED AUGUST 2-9, 2020 AND SEPTEMBER 16-19, 2020. DURING SUSPENSION PERIODS, THE ROADWAY AND SIDEWALKS MUST BE FULLY OPEN TO TRAFFIC AND CLEAR OF DEBRIS/CONSTRUCTION MATERIALS AND EQUIPMENT. ALL DISTURBED HARD SURFACES WHICH HAVE NOT BEEN PERMANENTLY RESTORED, SHALL BE TEMPORARILY RESTORED WITH ASPHALT OR CONCRETE.

II. CONSTRUCTION INCIDENTALS

PLAN DISCREPANCIES:

ANY DISCREPANCIES FROM THE PLAN INFORMATION SHALL BE BROUGHT TO THE ATTENTION OF THE ENGINEER SO THAT THE APPROPRIATE ADJUSTMENTS IN ALIGNMENT AND/OR GRADE MAY BE MADE PRIOR TO THE START OF CONSTRUCTION OR THE CONTINUATION OF THE SAME.

FAILURE BY THE CONTRACTOR TO VERIFY AND/OR DETERMINE EXISTING INFORMATION AS INDICATED WILL RESULT IN THE CONTRACTOR BEING RESPONSIBLE FOR ANY CHANGES NECESSARY TO COMPLETE THE WORK SPECIFIED WITHOUT ADDITIONAL COMPENSATION.

VERIFICATION OF UNDERGROUND UTILITIES:

THE CONTRACTOR SHALL BE RESPONSIBLE TO VERIFY THE EXISTENCE AS WELL AS THE ACTUAL LOCATION, ALIGNMENT, AND ELEVATIONS OF ALL EXISTING UTILITIES/FACILITIES WITHIN AND/OR ADJACENT TO THE GENERAL LIMITS OF THESE IMPROVEMENTS INCLUDING WATERLINES, SANITARY AND STORM SEWERS, GAS LINES, COMMUNICATION LINES/BANKS, ELECTRIC LINES, ETC. THIS MAY REQUIRE EXPLORATORY EXCAVATIONS TO BE PERFORMED BY THE CONTRACTOR FOR WHICH HE WILL NOT BE REIMBURSED. THE CONTRACTOR SHALL NOT ASSUME THAT EXISTING UTILITIES/CONDUITS WERE INSTALLED AT TYPICAL/STANDARD DEPTHS OR AT UNIFORM SLOPES/GRADES/DEPTHS BETWEEN ACCESS POINTS (CATCH BASINS, MANHOLES, JUNCTION CHAMBERS, ETC.)

WHERE PLANS PROVIDE FOR A PROPOSED CONDUIT TO BE CONNECTED TO, OR CROSS OVER OR UNDER AN EXISTING SEWER OR UNDERGROUND UTILITY, THE CONTRACTOR SHALL LOCATE THE EXISTING PIPES OR UTILITIES BOTH AS TO LINE AND GRADE BEFORE STARTING TO INSTALL THE PROPOSED CONDUIT.

PROTECTION OF UTILITIES:

THE CONTRACTOR SHALL TAKE ALL PRECAUTIONS NECESSARY TO PROTECT AND SUPPORT EXISTING UTILITIES ENCOUNTERED DURING THE CONSTRUCTION OF THE PROPOSED IMPROVEMENTS AS APPROVED BY THE OWNERS OF THE UTILITY AND THE CITY ENGINEER.

THE CONTRACTOR SHALL BE RESPONSIBLE TO CLOSELY COORDINATE THEIR WORK WITH ALL UTILITY COMPANIES; ANY POTENTIAL DELAYS WILL NOT BE THE RESPONSIBILITY OF THE CITY.

THE CONTRACTOR SHOULD EXPECT AT A MINIMUM ONE SANITARY SEWER LATERAL, ONE ROOF DRAIN, ONE WATER SERVICE, AND ONE GAS SERVICE FOR EACH LOT. ANY OF THE ABOVE UTILITIES DAMAGED DUE TO THE CONTRACTOR'S WORK SHALL BE RESTORED TO THE UTILITY OWNER'S SATISFACTION AT THE CONTRACTOR'S EXPENSE, UNLESS OTHERWISE NOTED IN THE PLANS OR SPECIFICATIONS.

MAINTENANCE OF UTILITY SERVICES:

THE CONTRACTOR SHALL BE RESPONSIBLE TO MAINTAIN UTILITY SERVICES AT ALL TIMES.

WATER SERVICE MAY BE INTERRUPTED FOR LIMITED PERIODS (4 HOURS MAXIMUM) DURING CONNECTION BETWEEN EXISTING WATER LINES AND RELOCATED/NEW WATER MAINS WHICH CANNOT BE COMPLETED OTHERWISE. NO SHUT DOWN SHALL OCCUR WITHOUT WRITTEN PERMISSION OF THE CITY OF CANTON WATER DEPARTMENT. PROPERTY OWNERS AFFECTED BY APPROVED INTERRUPTED SERVICE SHALL BE NOTIFIED 48 HOURS IN ADVANCE BY THE CONTRACTOR.

STORM SEWER AND SANITARY SEWER SERVICES SHALL BE MAINTAINED WITHOUT INTERRUPTION, UNLESS APPROVED BY THE CITY ENGINEER.

IN THE EVENT THAT CONSTRUCTION DISRUPTS THE FLOW OF A SANITARY SEWER, THE CONTRACTOR SHALL IMMEDIATELY RECTIFY THE DISRUPTED SEWER BY EITHER TEMPORARILY FLUMING WITH MATERIALS ACCEPTABLE TO THE ENGINEER OR BYPASSING WITH PUMPS. COST OF MAINTAINING AND REPAIR OF SANITARY SEWERS DISTURBED BY CONSTRUCTION SHALL BE AT THE CONTRACTOR'S EXPENSE, UNLESS OTHERWISE NOTED IN THE PLANS OR SPECIFICATIONS.

CONSTRUCTION NOISE:

CONSTRUCTION NOISE ASSOCIATED WITH ANY IMPROVEMENT PROJECT SHALL BE LIMITED TO LEVELS COMMENSURABLE WITH ADJOINING LAND AND THEIR ASSOCIATED USAGE AS DETERMINED BY THE CITY ENGINEER. IN ORDER TO MINIMIZE ANY ADVERSE CONSTRUCTION NOISE IMPACTS, ANY POWER-OPERATED CONSTRUCTION-TYPE DEVICES SHALL NOT BE OPERATED BETWEEN THE HOURS OF 7:00 P.M. AND 7:00 A.M. UNLESS AUTHORIZED BY THE CITY ENGINEER.

OPEN TRENCH CONSTRUCTION:

THE CONTRACTOR SHALL BE RESPONSIBLE FOR ALL EXCAVATION/TRENCHING PRACTICES FOR THE PROPOSED IMPROVEMENT, OR AS FURTHER SHOWN ON THE PLANS AND SPECIFICATIONS.

THE CONTRACTOR SHALL FOLLOW ALL APPLICABLE LOCAL AND STATE SAFETY REGULATIONS, INCLUDING CODE OF FEDERAL REGULATIONS, PART 1926 (SAFETY AND HEALTH REGULATIONS FOR CONSTRUCTION), SUBPART P (EXCAVATIONS), FOR ALL APPLICABLE REQUIREMENTS AND RESPONSIBILITIES.

PRIOR TO COMMENCING CONSTRUCTION, THE CONTRACTOR SHALL NOTIFY THE CITY ENGINEER OF THE PROJECT'S ASSIGNED "COMPETENT PERSON" IN OSHA EXCAVATION STANDARDS.

TRENCH CLOSING AND TEMPORARY TOPPING:

THE CONTRACTOR SHALL BE RESPONSIBLE TO DETERMINE THE NECESSARY LEVELS OF PROTECTION AND SAFEGUARDING OF ALL OPEN TRENCHES, WHEN WORK IS EITHER COMPLETED AT THE END OF THE DAY OR SUSPENDED FOR ANY OTHER REASON.

FOR TRENCH SURFACE REQUIREMENTS, REFER TO NOTE 4 ON CITY STANDARD DRAWING NO. 19.

DUST CONTROL:

THE CONTRACTOR SHALL FURNISH AND APPLY WATER AND CALCIUM CHLORIDE FOR DUST CONTROL AS DIRECTED BY THE ENGINEER. SUFFICIENT QUANTITIES OF CALCIUM CHLORIDE SHALL BE STORED ON THE JOB SITE AT ALL TIMES TO BE USED FOR DUST CONTROL.

PRESERVATION AND RESTORATION OF DISTURBED FEATURES:

EXISTING DRIVES, BERMS, LAWNS, PAVEMENTS, CURBS, SIDEWALKS, SIGNS, MAILBOXES, FENCES, RETAINING WALLS, LANDSCAPING ITEMS, OR OTHER APPURTENANCES DISTURBED DURING CONSTRUCTION BUT NOT SPECIFICALLY DESIGNATED FOR REMOVAL/REPLACEMENT SHALL BE RESTORED BY THE CONTRACTOR AT HIS EXPENSE TO A CONDITION EQUAL TO OR BETTER THAN THAT WHICH EXISTED PRIOR TO DISTURBANCE AND TO THE COMPLETE SATISFACTION OF THE CITY ENGINEER.

RESTORATION OF EXISTING ROADWAYS SHALL BE IN ACCORDANCE WITH THE REQUIREMENTS OF THE CITY, TOWNSHIP, COUNTY, AND/OR OTHER AGENCIES HAVING AUTHORITY. COST FOR THE RESTORATION OF THESE ITEMS SHALL BE THE RESPONSIBILITY OF THE CONTRACTOR, UNLESS OTHERWISE SPECIFIED IN THE PLANS OR SPECIFICATIONS. NO PUBLIC ROADWAY SHALL BE DISTURBED WITHOUT PRIOR WRITTEN APPROVAL FROM THE GOVERNING AGENCY AND ACQUISITION OF NECESSARY PERMITS.

DATE: 3/20/19		DRAWN BY: NUL		REVISIONS		BY	
H. SCALE: N/A		APPROVED BY:		DATE			
V. SCALE: N/A		FIELD BOOK:		DESCRIPTION			
SHEET 4 OF 18		FILE NAME: 13th St Gen Notes 1					
OFFICE OF THE CITY ENGINEER CANTON, OHIO				GENERAL NOTES 13TH STREET NW RECONSTRUCTION			
				DANIEL J. MOEGLIN, P.E., CITY ENGINEER 2436 30th STREET N.E. 44705 (330)489-3381			

II. CONSTRUCTION INCIDENTALS (CONT.)

SALVAGED CASTINGS:

WHEN DIRECTED BY THE CITY ENGINEER, ALL METAL CASTINGS SHALL BE CAREFULLY REMOVED AND STORED ON SITE OR DELIVERED TO A LOCATION DESIGNATED BY THE CITY ENGINEER.

PLUG EXISTING CONDUIT:

THIS ITEM SHALL CONSIST OF THE CONSTRUCTION OF BULKHEADS IN AN EXISTING CONDUIT TO BE ABANDONED.

BULKHEADS SHALL CONSIST OF BRICK AND/OR CONCRETE MASONRY WITH A MINIMUM THICKNESS OF 12 INCHES.

PAYMENT FOR PLUGGING OF EXISTING CONDUIT FOR ABANDONMENT SHALL BE INCLUDED IN THE UNIT BID OF THE VARIOUS ITEMS OF THE PROJECT.

CONSTRUCTION LAYOUT:

THE CONTRACTOR SHALL BE RESPONSIBLE FOR ALL CONSTRUCTION LAYOUT UTILIZING PERTINENT PLAN DATA. THE CITY ENGINEER WILL NOT BE RESPONSIBLE FOR STAKING HORIZONTAL OR VERTICAL CONTROL. CONSTRUCTION LAYOUT SHALL BE IN ACCORDANCE WITH ODOT 623 CONSTRUCTION LAYOUT STAKES AND SURVEYING.

IN ADDITION TO THE REQUIREMENTS OF 623 CONSTRUCTION LAYOUT STAKES AND SURVEYING, THE CONTRACTOR SHALL PERFORM A PRE-CONSTRUCTION SURVEY TO ESTABLISH THE EXISTING ROADWAY AND CURB ELEVATIONS (SEE TYPICAL SECTION NOTES). THE PRE-CONSTRUCTION SURVEY DATA COLLECTED SHALL BE SUFFICIENT FOR THE CONTRACTOR TO LAYOUT THE PROPOSED CURB AND PAVEMENT WITHIN 0.02'± TOLERANCE OF THE EXISTING CURB AND PAVEMENT. THE CONTRACTOR MUST USE BEST JUDGEMENT AND/OR SEEK ENGINEER'S CONCURRENCE TO NOT PERPETUATE OBVIOUS SETTLEMENTS OR HEAVES FROM THE EXISTING PAVEMENT.

COST FOR THE PRELIMINARY SURVEY SHALL BE INCLUDED IN 623 CONSTRUCTION LAYOUT STAKES AND SURVEYING.

AT THE CITY ENGINEER'S REQUEST, THE CONTRACTOR SHALL MAKE AVAILABLE ALL SURVEY FIELD NOTES FOR REVIEW.

EXISTING MONUMENTATION:

THE CONTRACTOR SHALL PRESERVE ALL CORNERSTONES, IRON PINS, CONCRETE MONUMENTS AND/OR ANY TYPE OF LAND MONUMENT. THE CONTRACTOR SHALL HAVE ALL MONUMENTS IN THE PROXIMITY OF THE WORK REFERENCED. THE CONTRACTOR SHALL REPLACE/RESET ANY DISTURBED OR DAMAGED MONUMENTS AND SHALL FURNISH A CERTIFICATION BY A REGISTERED SURVEYOR THAT THE MONUMENTS HAVE BEEN RESTORED.

ELEVATION DATUM:

ALL ELEVATIONS ARE TO BE DETERMINED BY CONTRACTOR LAYOUT.

DEWATERING OPERATIONS:

WHEN DEEMED NECESSARY, THE CONTRACTOR MAY INSTALL DEWATERING EQUIPMENT PRIOR TO THE COMMENCEMENT OF CONSTRUCTION.

THE PROPOSED LOCATION OF WELL POINTS, HEADER PIPE, ELECTRICAL DISTRIBUTION, GENERATORS AND DISCHARGE PIPES, ETC. SHALL BE THE RESPONSIBILITY OF THE CONTRACTOR.

THE CONTRACTOR SHALL BE RESPONSIBLE FOR ALL PERMITS FOR THE INSTALLATION AND SUBSEQUENT REMOVAL OF DEWATERING EQUIPMENT AS WELL AS PROPER WATER DISCHARGE PROCEDURES AS MAY BE REQUIRED PER STATE AND LOCAL GOVERNING AGENCIES.

INSTALLATION OF ALL ELECTRICAL EQUIPMENT, INCLUDING GROUNDING AND PROTECTION SHALL BE THE RESPONSIBILITY OF THE CONTRACTOR.

CONTRACTOR SHALL PROVIDE ALL COMBUSTIBLE ENGINE DRIVEN GENERATORS WITH "HOSPITAL GRADE" MUFFLERS. MUFFLERS SHALL BE RATED, AT A MAXIMUM OF 67 dB AT 23 FEET AWAY RUNNING FULL LOAD.

INSPECTION:

FOLLOWING THE PRE-CONSTRUCTION MEETING(S) AND ESTABLISHMENT OF AN APPROVED SCHEDULE, THE CONTRACTOR SHALL GIVE A MINIMUM 48 HOUR NOTICE BEFORE STARTING ANY WORK ON THIS PROJECT AND SHALL KEEP THE CITY INFORMED OF HIS/HER CONSTRUCTION SCHEDULE. ALL WORK REQUIRED FOR THIS IMPROVEMENT SHALL BE SUBJECT TO INSPECTION BY THE CITY OF CANTON OR THEIR DESIGNATED REPRESENTATIVE. NO WORK SHALL BE PERFORMED WITHOUT AN AUTHORIZED INSPECTOR PRESENT, UNLESS OTHERWISE APPROVED.

III. EARTHWORK / SITE WORK

EASEMENTS AND RIGHT-OF-WAY:

THE CONTRACTOR SHALL STAY WITHIN THE DESIGNATED PROPERTIES, EASEMENTS, AND/OR RIGHT-OF-WAY PROVIDED FOR THE PROJECT AT ALL TIMES. NO MATERIAL SHALL BE STORED NOR ANY WORK PERFORMED ON PRIVATE PROPERTY UNLESS OTHERWISE APPROVED. DISTURBANCE OF EXISTING FEATURES AND/OR IMPROVEMENTS SHALL BE KEPT TO AN ABSOLUTE MINIMUM AND AS APPROVED BY THE CITY ENGINEER/PROPERTY OWNER.

SUITABILITY OF SITE:

THE CITY OF CANTON SHALL NOT BE RESPONSIBLE FOR THE TYPE AND/OR SUITABILITY OF THE MATERIAL UNDERLYING THE PROJECT SITE. THE CONTRACTOR MUST APPRAISE THEMSELVES OF ANY EXISTING SITE CONDITIONS WHICH MAY AFFECT THEIR BID OR THE PERFORMANCE OF THE REQUIRED WORK. THE CONTRACTOR SHALL PERFORM ANY INVESTIGATIONS AND/OR TESTING NECESSARY TO ADEQUATELY DETERMINE/ESTIMATE TO THEIR SATISFACTION ALL SITE CONDITIONS WHICH COULD AFFECT THE PERFORMANCE OF THE PROPOSED IMPROVEMENTS. THIS COULD INCLUDE, BUT NOT BE LIMITED TO, UNSUITABLE AND/OR UNSTABLE SOIL/SUBSURFACE CONDITIONS, ROCK, WATER (PERCHED OR FREE), SPRINGS, ETC.

REFER TO CITY STANDARD DRAWING NO. 19 FOR ADDITIONAL DETAILS.

REMOVAL/REPLACEMENT OF UNSUITABLE MATERIAL:

THE DEVELOPER/CONTRACTOR SHALL UNDERCUT AND REPLACE UNSUITABLE MATERIAL ENCOUNTERED DURING INSTALLATION OF THE PROPOSED UTILITIES AND ROADWAY IN ACCORDANCE WITH CITY STANDARD DRAWING NO. 19.

IV. ROADWAY / DRIVE APPROACHES / WALK / CURB

PAVEMENT STANDARDS:

PAVEMENTS ARE TO BE CONSTRUCTED IN ACCORDANCE WITH APPLICABLE CITY STANDARD DRAWINGS AND SPECIFICATIONS (LISTED BELOW) AND ODOT SPECIFICATIONS, UNLESS SPECIFIED OTHERWISE ON THE PLANS.

CITY STANDARD DRAWING NO.:

- DRIVEWAYS, CURBS, AND PAVEMENT
- 27 "DRIVE APPROACH WITH LAWNSTRIP BETWEEN SIDEWALK & CURB"
- 28 "DRIVE APPROACH WITH SIDEWALK AGAINST CURB"
- 29 "COMBINED CURB & WALK"
- 30 "CONCRETE CURB AND COMBINED CURB & GUTTER"
- 31 "BRICK PAVEMENT REPAIR & REPLACEMENT OVER TRENCHES/ALONG CURB"
- 32 "TYPICAL SECTION - LOCAL STREET"
- 33 "WHEELCHAIR RAMP"
- 34 "PAVEMENT TRANSITION, BRICK-ASPHALT", CITY STREETScape
- 40 "TYPICAL STREETScape CORRIDOR"
- 41 "ROADWAY BRICK & CROSSWALK PAVEMENT DETAILS"
- 42 "STREETScape CONCRETE WALK PAVEMENT DETAILS"
- 44 "CONCRETE WALK OVER VAULT CONSTRUCTION DETAILS"
- 45 "BRICK WALK OVER VAULT CONSTRUCTION DETAILS"

CITY SPECIFICATIONS:

"CITY OF CANTON SPECIFICATIONS FOR THE CONSTRUCTION, REPAIR, AND REPLACEMENT OF SIDEWALKS, CURBS, AND DRIVEWAYS"

RESTRICTED WORK SCHEDULE:

NO CONCRETE FINISH WORK OR PERMANENT ASPHALT SHALL BE PLACED FROM NOVEMBER 15TH TO APRIL 15TH UNLESS WRITTEN APPROVAL IS GRANTED BY THE CITY ENGINEER.

ASPHALT/CONCRETE:

IT SHALL BE THE RESPONSIBILITY OF THE CONTRACTOR TO NOTIFY THE ENGINEER 48 HOURS IN ADVANCE OF BEGINNING WORK WHICH REQUIRES COMPACTION TESTING AND/OR PRE-POUR INSPECTION PRIOR TO PLACEMENT OF ASPHALT OR CONCRETE. WORK SHALL NOT PROCEED UNTIL TESTING AND/OR INSPECTION HAS BEEN COMPLETED AND APPROVED BY THE CITY ENGINEER.

ITEM 608, 5" CONCRETE WALK, AS PER PLAN

ALL PROVISIONS OF ODOT CMS 608 SHALL APPLY WITH THE ADDITION THAT THE WALK SHALL BE CONSTRUCTED IN ACCORDANCE WITH CITY OF CANTON STANDARD DRAWINGS NOS. 40 AND 42. THIS WORK SHALL INCLUDE THICKER CONCRETE BETWEEN THE WALK AND THE BACK OF THE BRICK PAVERS.

ITEM 609 - CURB TYPE 6, AS PER PLAN

ALL PROVISIONS OF ODOT CMS 609 SHALL APPLY WITH THE ADDITION THAT THE CURB SHALL BE CONSTRUCTED IN ACCORDANCE WITH CITY OF CANTON STANDARD DRAWINGS NO. 29 AND NO. 40.

V. SANITARY SEWERS / STORM SEWERS

SEWER STANDARDS:

ALL SANITARY/STORM SEWER CONDUITS AND APPURTENANCES SHALL BE CONSTRUCTED ACCORDING TO APPLICABLE CITY STANDARD DRAWINGS AND SPECIFICATIONS (LISTED BELOW) AND ODOT SPECIFICATIONS EFFECTIVE AT THE TIME OF CONSTRUCTION, UNLESS SPECIFIED OTHERWISE ON THE PLANS. ROOF DRAINS, FOUNDATION DRAINS, AND OTHER CLEAN WATER CONNECTIONS TO THE DISPOSAL SYSTEM ARE PROHIBITED.

CITY STANDARD DRAWING NO.:

- CATCH BASINS
- 1 "CURB INLET CATCH BASIN"
- 2 "CURB INLET WATER QUALITY CATCH BASIN"
- 3 "HILLSIDE CURB INLET CATCH BASIN"
- 4 "SQUARE-TOP CATCH BASIN"
- 5 "SQUARE-TOP WATER QUALITY CATCH BASIN"
- MANHOLES
- 10 "PRECAST STORM OR SANITARY MANHOLE"
- 11 "OUTSIDE DROP CONNECTION FOR SANITARY MANHOLE"
- 12 "MANHOLE COVER"
- 13 "MANHOLE ADJUSTMENTS"

- CONDUITS AND TRENCHES
- 18 "HOUSE CONNECTION STACK"
- 19 "UTILITY TRENCH REQUIREMENTS"
- 20 "SANITARY SEWERS AND LATERALS"
- 21 "CONCRETE ENCASEMENT DETAIL"
- 22 "DOWNSPOUT OUTLET (NON-CURBED STREET)"
- 23 "DOWNSPOUT OUTLET (CURBED STREET)"
- 24 "GROUNDWATER DRAIN LINE CONNECTION"

- DRIVEWAYS, CURBS, AND PAVEMENT
- 32 "TYPICAL SECTION - LOCAL STREET"

ITEM 611 - MANHOLE ADJUSTED TO GRADE, AS PER PLAN:

MANHOLE ADJUSTMENTS SHALL BE PERFORMED BY ONE OF THE FOLLOWING METHODS:

METHOD A - AFTER THE SURFACE COURSE ASPHALT IS PLACED. ADJUSTMENTS SHALL BE MADE AS PER CITY OF CANTON STANDARD DRAWING #13. THIS ITEM SHALL INCLUDE ALL MATERIALS REQUIRED AS PER THE STANDARD DRAWING.

METHOD B - PRIOR TO THE PLACEMENT OF THE INTERMEDIATE ASPHALT COURSE. CONCRETE SHALL NOT BE USED TO BACKFILL AROUND THE CASTING IN ORDER TO PREVENT REFLECTIVE CRACKING.

THIS ITEM SHALL INCLUDE THE REPLACEMENT OF THE EXISTING CASTING. SEWER CASTINGS SHALL COMPLY WITH CITY OF CANTON STANDARD DRAWING #12. PAYMENT FOR THE CASTING WILL BE INCLUDED WITH THIS ITEM.

ITEM 611 - CATCH BASIN RECONSTRUCTED TO GRADE, AS PER PLAN:

IN ADDITION TO THE REQUIREMENTS IN 611 OF THE CMS, THIS ITEM SHALL INCLUDE THE REPLACEMENT OF THE EXISTING CASTING. THE NEW CASTING SHALL COMPLY WITH CITY OF CANTON STANDARD DRAWING #1. PAYMENT FOR THE CASTING WILL BE INCLUDED WITH THIS ITEM.

FORCE MAIN:

ITEM 611 - CONDUIT, MISC.: 10" FORCE MAIN, CONCRETE LINED DUCTILE IRON PIPE, AWWA C151

THIS ITEM SHALL CONSIST OF CONSTRUCTING AND TESTING A 10" FORCE MAIN, CONCRETE LINED DUCTILE IRON PIPE, AWWA C151, AT THE LOCATIONS, GRADES, AND ELEVATIONS SPECIFIED IN THE PLANS IN ACCORDANCE WITH CITY OF CANTON SPECIFICATIONS, STANDARDS, DETAILS, AND NOTES. THE 10" FORCE MAIN SHALL BE TESTED IN ACCORDANCE WITH AWWA C600.

PAYMENT FOR THE ABOVE WORK SHALL BE MADE AT THE CONTRACT UNIT PRICE BID PER FOOT.

ITEM 611 - CONDUIT, MISC.: (BY SIZE) DEZURIK ECCENTRIC PLUG VALVE W/ H.D. VALVE BOX

THIS ITEM SHALL CONSIST OF PROVIDING AND INSTALLING A DUZURIK ECCENTRIC PLUG VALVE W/ H.D. VALVE BOX AT THE LOCATIONS AND ELEVATIONS SHOWN ON THE PLANS.

PAYMENT FOR THE ABOVE WORK SHALL BE MADE AT THE CONTRACT UNIT PRICE BID FOR EACH.

ITEM 611 - CONDUIT, MISC.: 6" DEZURIK ECCENTRIC THREADED PLUG VALVE W/ H.D. VALVE BOX

THIS ITEM SHALL CONSIST OF PROVIDING AND INSTALLING A 6" DUZURIK ECCENTRIC PLUG VALVE W/ H.D. VALVE BOX AT THE LOCATIONS AND ELEVATIONS SHOWN ON THE PLANS. ALL LABOR, MATERIAL, EQUIPMENT, AND INCIDENTAL ITEMS NECESSARY TO REMOVE AND RE-INSTALL THE TOP OF THE MANHOLE SHALL BE INCIDENTAL TO THIS ITEM.

PAYMENT FOR THE ABOVE WORK SHALL BE MADE AT THE CONTRACT UNIT PRICE BID FOR EACH

ITEM SPECIAL - CONNECTION TO EXISTING LIFT STATION FORCE MAIN DISCHARGE

THIS ITEM SHALL CONSIST OF CONNECTING THE PROPOSED FORCE MAIN TO THE DISCHARGE PIPING OF THE EXISTING LIFT STATION PER THE CONSTRUCTION NOTES AND DETAILS PROVIDED ON THE SANITARY SEWER PLAN SHEETS. THE LUMP SUM CONTRACT PRICE SHALL INCLUDE ALL LABOR, MATERIAL, EQUIPMENT, AND INCIDENTAL ITEMS NECESSARY TO CONSTRUCT THE CONNECTION.

PAYMENT FOR THE ABOVE WORK SHALL BE MADE AT THE CONTRACT LUMP SUM PRICE BID.

ITEM SPECIAL - CONNECTION TO THE EXISTING 10" SANITARY FORCE MAIN

THIS ITEM SHALL CONSIST OF CONNECTING THE PROPOSED FORCE MAIN TO THE EXISTING FORCE MAIN PER THE CONSTRUCTION NOTES AND DETAILS PROVIDED ON THE SANITARY SEWER PLAN SHEETS. THE LUMP SUM CONTRACT PRICE SHALL INCLUDE ALL LABOR, MATERIAL, EQUIPMENT, AND INCIDENTAL ITEMS NECESSARY TO CONSTRUCT THE CONNECTION.

PAYMENT FOR THE ABOVE WORK SHALL BE MADE AT THE CONTRACT LUMP SUM PRICE BID.

ITEM SPECIAL - BYPASS PUMPING

THIS ITEM SHALL CONSIST OF BYPASS PUMPING OF THE EXISTING LIFT STATION DISCHARGE PER THE CONSTRUCTION NOTES AND DETAILS PROVIDED ON THE SANITARY SEWER PLAN SHEETS. THE LUMP SUM CONTRACT PRICE SHALL INCLUDE ALL LABOR, MATERIAL, EQUIPMENT, AND INCIDENTAL ITEMS NECESSARY TO PERFORM BYPASS PUMPING.

PAYMENT FOR THE ABOVE WORK SHALL BE MADE AT THE CONTRACT LUMP SUM PRICE BID

ITEM SPECIAL - ABANDON EXISTING 10" SANITARY FORCE MAIN

THIS ITEM SHALL CONSIST OF ABANDONING THE EXISTING 10" SANITARY FORCE MAIN PER THE CONSTRUCTION NOTES AND DETAILS PROVIDED ON THE SANITARY SEWER PLAN SHEETS. THE LUMP SUM CONTRACT PRICE SHALL INCLUDE ALL LABOR, MATERIAL, EQUIPMENT, AND INCIDENTAL ITEMS NECESSARY TO ABANDON THE EXISTING 10" SANITARY FORCE MAIN.

PAYMENT FOR THE ABOVE WORK SHALL BE MADE AT THE CONTRACT LUMP SUM PRICE BID

DATE: 3/20/19		DRAWN BY: NUL		REVISIONS	BY	DATE	OFFICE OF THE CITY ENGINEER	
		APPROVED BY:					CANTON, OHIO	
H. SCALE: N/A		FIELD BOOK:		GENERAL NOTES		13TH STREET NW RECONSTRUCTION		
V. SCALE: N/A		FILE NAME: 13th St Gen Notes 2		DANIEL J. MOEGLIN, P.E., CITY ENGINEER		2436 30th STREET N.E. 44705 (330)488-3381		
SHEET 5 OF 18								

V. SANITARY SEWERS / STORM SEWERS (CONT.)

GRAVITY SEWER:

ITEM 611 – MANHOLE, MISC.: CITY OF CANTON SCD NO.10 PRECAST SANITARY MANHOLE

THIS ITEM SHALL CONSIST OF CONSTRUCTING AND TESTING SANITARY MANHOLES AT THE LOCATIONS AND ELEVATIONS SPECIFIED IN THE PLANS IN ACCORDANCE WITH CITY OF CANTON SPECIFICATIONS, STANDARDS, DETAILS, AND NOTES. SANITARY MANHOLES SHALL BE TESTED IN ACCORDANCE WITH ASTM C1244 PER CITY OF CANTON SUPPLEMENTAL SPECIFICATION 04-01 – STANDARD TEST METHOD FOR CONCRETE SEWER MANHOLES BY THE NEGATIVE AIR PRESSURE TEST.

PAYMENT FOR THE ABOVE WORK SHALL BE MADE AT THE CONTRACT UNIT PRICE BID FOR EACH

ITEM 611 – CONDUIT, MISC.: 8" CONDUIT, TYPE B, PVC SDR-35

THIS ITEM SHALL CONSIST OF CONSTRUCTING AND TESTING AN 8" CONDUIT, TYPE B, PVC SDR-35, AT THE LOCATIONS, GRADES, AND ELEVATIONS SPECIFIED IN THE PLANS IN ACCORDANCE WITH CITY OF CANTON SPECIFICATIONS, STANDARDS, DETAILS, AND NOTES. THE 8" CONDUIT SHALL BE TESTED IN ACCORDANCE WITH CITY OF CANTON SUPPLEMENTAL SPECIFICATION 02-00 – TESTING FOR EXCESSIVE DEFLECTION FOR NON-PRESSURE THERMOPLASTIC SEWER PIPE (LASER PROFILING PER ODOT 611.12.B MAY BE PROVIDED AS AN ALTERNATIVE). THE 8" CONDUIT SHALL ALSO BE TESTED IN ACCORDANCE WITH CITY OF CANTON SUPPLEMENTAL SPECIFICATION 03-00 – TESTING PRACTICES FOR LOW-PRESSURE AIR TESTING OF INSTALLED, NON-PRESSURE, THERMOPLASTIC SEWER PIPE.

PAYMENT FOR THE ABOVE WORK SHALL BE MADE AT THE CONTRACT UNIT PRICE BID PER FOOT.

ITEM 611 – CONDUIT, MISC.: SEWER TELEVISION INSPECTION AND DOCUMENTATION, 8" DIA.

GRAVITY SANITARY SEWERS CONSTRUCTED WITH THIS PROJECT SHALL BE TELEVIEWED BY THE CONTRACTOR IN ACCORDANCE WITH ODOT ITEM 611.12, SECTION B. ANY OTHER APPLICABLE CITY OF CANTON STANDARDS, DETAILS, AND NOTES SHALL ALSO APPLY.

PAYMENT FOR THE ABOVE WORK SHALL BE MADE AT THE CONTRACT UNIT PRICE BID PER FOOT

ITEM SPECIAL – CORE EXISTING LIFT STATION WET WELL

THIS ITEM SHALL CONSIST OF CORING INTO THE EXISTING LIFT STATION WET WELL. THE CONNECTION SHALL BE MADE PER THE CONSTRUCTION NOTES AND DETAILS PROVIDED ON THE SANITARY SEWER PLAN SHEETS. THE LUMP SUM CONTRACT PRICE SHALL INCLUDE ALL LABOR, MATERIAL, EQUIPMENT, AND INCIDENTAL ITEMS NECESSARY TO CONSTRUCT THE CONNECTION.

PAYMENT FOR THE ABOVE WORK SHALL BE MADE AT THE CONTRACT LUMP SUM PRICE BID.

VI. STORM WATER POLLUTION PREVENTION:

FOR PROJECTS ONE (1) ACRE OR MORE OF TOTAL LAND-DISTURBANCE:

THE CONTRACTOR SHALL APPLY FOR AND OBTAIN AN OHIO EPA NPDES PERMIT FOR STORM WATER DISCHARGES ASSOCIATED WITH CONSTRUCTION ACTIVITY. SAID PERMIT REQUIRES THE PREPARATION AND IMPLEMENTATION OF A STORM WATER POLLUTION PREVENTION PLAN (SWP3) TO ADDRESS CONSTRUCTION SITE STORM WATER RUNOFF AS WELL AS POST-CONSTRUCTION STORM WATER MANAGEMENT. THE SWP3 MUST BE REVIEWED AND APPROVED BY THE STARK COUNTY SOIL & WATER CONSERVATION DISTRICT (SWCD).

THE CONTRACTOR AND HIS REPRESENTATIVES SHALL COMPLY WITH ALL APPLICABLE REQUIREMENTS OF THE PERMIT AS WELL AS THE SWP3. ALL ACTIVITIES AND PRACTICES SHALL ALSO COMPLY WITH THE CURRENT EDITIONS OF THE CITY OF CANTON STORM WATER MANAGEMENT MANUAL AND THE OHIO DEPARTMENT OF NATURAL RESOURCES' RAINWATER AND LAND DEVELOPMENT MANUAL, AS APPLICABLE. SUCH PROJECTS ARE ALSO SUBJECT TO INSPECTION BY THE CITY OF CANTON AND/OR ITS AUTHORIZED REPRESENTATIVES (I.E. STARK SWCD) TO ENSURE COMPLIANCE WITH PERMIT AND SWP3 REQUIREMENTS AND LOCAL STORM WATER QUALITY REGULATIONS.

A PRE-CONSTRUCTION MEETING INITIATED BY THE CONTRACTOR IS REQUIRED ON-SITE WITH THE STARK SWCD PRIOR TO ANY LAND-DISTURBING ACTIVITIES. THE CONTRACTOR SHALL ABIDE BY ALL ORDERS ISSUED BY THE CITY AND/OR STARK SWCD PURSUANT TO INSPECTION OF THE PROJECT SITE.

IT IS THE CONTRACTOR'S RESPONSIBILITY TO SUBMIT CO-PERMITTEE APPLICATION TO OHIO EPA PRIOR TO BEGINNING WORK ON THE PROJECT. AS APPLICABLE, THE CONTRACTOR SHALL OBTAIN A COPY OF THE SWP3 AND FAMILIARIZE HIMSELF WITH IT, IMPLEMENTING ALL ITEMS AND ABIDING BY ALL PERMIT REQUIREMENTS AND REGULATIONS.

POST CONSTRUCTION STORM WATER TREATMENT

THIS PLAN UTILIZES STRUCTURAL BEST MANAGEMENT PRACTICES (BMP'S) FOR POST CONSTRUCTION STORM WATER TREATMENT.

MANUFACTURED WATER QUALITY STRUCTURE

THIS PLAN UTILIZES MANUFACTURED WATER QUALITY STRUCTURES FOR WATER QUALITY TREATMENT. AREAS HAVE BEEN SHOWN IN THE PLANS FOR PLACEMENT OF AN OFF-LINE SYSTEM. PAYMENT FOR THESE DEVICES SHALL BE MADE AT THE CONTRACT UNIT PRICE FOR ITEM 895, MANUFACTURED WATER QUALITY STRUCTURE, TYPE 4.

VII. TRAFFIC:

EXISTING STREET NAME AND TRAFFIC CONTROL SIGNS:

WHERE WORK REQUIRES THE MOVEMENT OF EXISTING SIGNS (STOP SIGNS, SPEED LIMIT SIGNS, NO PARKING SIGNS, ETC.). THE CONTRACTOR IS REQUIRED TO MAINTAIN THE FUNCTION OF ALL TRAFFIC CONTROL SIGNS. ALL SIGNS REMOVED BY THE CONTRACTOR SHALL BE STORED ON SITE AND REINSTALLED BY THE CONTRACTOR.

NEW STREET NAME & TRAFFIC CONTROL SIGNS:

ALL STREET NAME AND TRAFFIC CONTROL SIGNS SHALL COME COMPLETE AND BE MADE IN ACCORDANCE WITH THE CITY OF CANTON SIGN AND PAINT DEPARTMENT SPECIFICATIONS. GENERALLY, ALL SIGNS SHALL HAVE HI-INTENSITY SHEETING AND BE MADE WITH .080 50/52 ALUMINUM. STREET NAME SIGNS SHALL BE MADE WITH WHITE UPPER AND LOWER CASE LETTERING ON GREEN BACKGROUND USING 9" BLANKS, BE DOUBLED SIDED W/RADIUS CORNERS AND HAVE 6" NAME AND 3" SUFFIXES. ALL SIGN RELATED HARDWARE IS TO BE INCLUDED, SUCH AS 6" HEAVY DUTY U-CHANNEL CAPS AND STREET NAME CROSSES.

VIII. STREETScape / LIGHTING / CONDUIT SYSTEM

ITEM SPECIAL, BRICK WALKWAY PAVERS

BRICK PAVERS SHALL BE CONSTRUCTED IN ACCORDANCE WITH CITY OF CANTON STANDARD DRAWING NO. 40.

PAYMENT OF ITEM SPECIAL, BRICK PAVERS SHALL BE MADE AT THE CONTRACT UNIT PRICE PER SQUARE FOOT OF BRICK WALKWAY PAVERS AND SHALL INCLUDE ALL LABOR, MATERIALS, AND EQUIPMENT TO COMPLETE THE BRICK PAVERS, SETTING SAND, SEALANT, AND JOINT SAND IN ACCORDANCE WITH CITY STANDARDS.

ITEM SPECIAL, TREE FRAME AND GRATE

SPECIFICATIONS OF THE TREE FRAMES, GRATES, AND CONSTRUCTION OF THE CONCRETE COLLARS SHALL BE IN ACCORDANCE WITH CITY OF CANTON STANDARD DRAWING NO. 43. CONCRETE SHALL BE PER ODOT 499, CLASS C WITH LIMESTONE AGGREGATE.

PAYMENT OF ITEM SPECIAL, TREE FRAME AND GRATE SHALL BE MADE AT THE CONTRACT UNIT PRICE FOR EACH AND SHALL INCLUDE ALL LABOR, MATERIALS, EQUIPMENT, AND INCIDENTALS TO COMPLETE THE CONCRETE COLLAR, TREE FRAMES, GRATES, AND EXCAVATION OF THE TREE PIT.

ITEM 608, WALKWAY MISC.: CONCRETE BASE

ALL PROVISIONS OF ODOT CMS 608 SHALL APPLY WITH THE ADDITION THAT THE WALK SHALL BE CONSTRUCTED IN ACCORDANCE WITH CITY OF CANTON STANDARD DRAWING NO. 40. THIS ITEM INCLUDES THE 3 INCH CONCRETE BASE CONSTRUCTED UNDER THE BRICK WALKWAY PAVERS AND THE 6 INCH WIDE CONCRETE HEADER BETWEEN THE ROADWAY CURB AND BRICK PAVERS.

PAYMENT OF ITEM 608, WALKWAY MISC.: CONCRETE BASE SHALL BE MADE AT THE CONTRACT UNIT PRICE PER SQUARE FOOT AND SHALL INCLUDE ALL LABOR, MATERIALS, EQUIPMENT, AND INCIDENTALS TO CONSTRUCT THE CONCRETE BASE AND HEADER.

ITEM 625 – CONDUIT, 725.05, 2", AS PER PLAN

ALL CONDUITS AND FITTINGS SHALL BE TYPE EB, SCHEDULE 40 PVC. ALL CONDUITS SHALL HAVE PULL WIRE. ALL CONDUITS ENTERING A PULL BOX, POLE, ETC. SHALL NOT EXTEND MORE THAN 1" BEYOND ENTERING THE PULL BOX, POLE, ETC.

ITEM 625 – PULL BOX, MISC.: 725.06, (BY SIZE)

PULL BOXES SHALL BE MANUFACTURED BY CARSON BROOKS, QUAZITE, SYNERTech, OR APPROVED EQUAL. ALL PULL BOXES SHALL INCLUDE A POLYMER CONCRETE RING AND COVER TYPE, OR EQUAL, AND SHALL BE MARKED "TRAFFIC" OR "LIGHTING" AS APPLICABLE. THE PULL BOX SHALL BE FIBERGLASS REINFORCED POLYESTER, OR EQUAL, WITH INSERTS AND SHALL BE 18" IN DEPTH. EACH PULL BOX SHALL INCLUDE TWO (2) STAINLESS STEEL HEX BOLTS. EACH PULL BOX AND COVER SHALL HAVE A MINIMUM LOAD RATING OF 20,000 POUNDS CAPACITY IN ACCORDANCE WITH THE WESTERN UNDERGROUND COMMITTEE GUIDE 3.6. UNDERDRAINS SHALL NOT BE INSTALLED IN PULL BOXES.

CONDUITS ENTERING TRAFFIC/INTERCONNECT PULL BOXES SHALL NOT HAVE VERTICAL SWEEPS.

ITEM 625 – LIGHT POLE FOUNDATION, AS PER PLAN

LIGHT POLE FOUNDATIONS SHALL BE CONSTRUCTED AS PER CITY OF CANTON STANDARD DRAWINGS.

GROUNDING AND BONDING

THE REQUIREMENTS OF THE CONSTRUCTION AND MATERIAL SPECIFICATIONS (CMS) AND THE TC SERIES OF STANDARD CONSTRUCTION DRAWINGS ARE MODIFIED AS FOLLOWS:

1. ALL METALLIC PARTS CONTAINING ELECTRICAL CONDUCTORS SHALL BE PERMANENTLY JOINED TO FORM AN EFFECTIVE GROUND FAULT CURRENT PATH BACK TO THE GROUNDED CONDUCTOR IN THE POWER SERVICE DISCONNECT SWITCH.
 - A. PROVIDE AN EQUIPMENT GROUNDING CONDUCTOR IN METALLIC CONDUITS (725.04) IN ADDITION TO THE CONDUCTORS SPECIFIED AND BOND THE CONDUIT TO THIS GROUNDING CONDUCTOR.
 - B. WHEN AN EQUIPMENT GROUNDING CONDUCTOR IS REQUIRED IN PLASTIC CONDUIT (725.05), THE INSTALLATION SHALL INCLUDE A SEPARATE EQUIPMENT GROUNDINGS CONDUCTOR IN ADDITION TO THE CONDUCTORS SPECIFIED.
 - C. METALLIC CONDUIT CARRYING THE LOOP WIRES FROM IN THE PAVEMENT TO THE PULL BOX SPLICE LOCATION WILL ONLY BE BONDED AT THE PULL BOX END, AND WILL NOT CONTAIN AN EQUIPMENT GROUNDING CONDUCTOR.
 - D. IF MULTIPLE CONDUIT RUNS BEGIN AND END AT THE SAME POINTS, ONLY ONE EQUIPMENT GROUNDING CONDUCTOR IS REQUIRED.
 - E. IF AN EQUIPMENT GROUNDING CONDUCTOR IS NEEDED IN CONDUIT BETWEEN SIGNALIZED INTERSECTIONS FOR UNDERGROUND INTERCONNECT CABLE, THE GROUNDING SYSTEM FOR EACH SIGNALIZED INTERSECTION WILL BE SEPARATED ABOUT MIDWAY BETWEEN THE INTERSECTIONS.
 - F. THE MESSENGER WIRE AT SIGNALIZED INTERSECTIONS WILL BE USED AS THE CONDUCTIVE PATH FROM CORNER TO CORNER IF CONDUIT IS NOT PROVIDED UNDER THE ROADWAY. WHEN CONDUIT CONNECTS THE CORNERS OF AN INTERSECTION, AN EQUIPMENT GROUNDING CONDUCTOR SHALL BE USED IN THE CONDUIT.
2. CONDUITS
 - A. THE 725.04 CONDUIT SHALL HAVE GROUNDING BUSHINGS INSTALLED AT ALL TERMINATION POINTS. THE BUSHING MATERIAL SHALL BE COMPATIBLE WITH GALVANIZED STEEL CONDUIT AND THE GROUNDING LUG MATERIAL SHALL BE COMPATIBLE FOR USE WITH COPPER WIRE. THREADED OR COMPRESSION TYPE BUSHINGS MAY BE USED.
 - B. THE 725.05 CONDUIT SHALL HAVE THE INSIDE AND OUTSIDE DIAMETERS OF THE CONDUIT DEBURRED AT ALL TERMINATION POINTS.
 - C. BOTH ENDS OF METALLIC CONDUITS SHALL BE BONDED TO THE EQUIPMENT GROUNDING CONDUCTOR.
 - D. METALLIC CONDUIT MAY BE BONDED TO METALLIC BOXES THROUGH THE USE OF CONDUIT FITTINGS UL APPROVED FOR THIS TYPE OF CONNECTION, WITH THE BOX BONDED TO THE EQUIPMENT GROUNDING CONDUCTOR.

3. WIRE FOR GROUNDINGS AND BONDING
 - A. USE INSULATED, STRANDED COPPER WIRE FOR THE EQUIPMENT GROUNDING CONDUCTOR. BONDING JUMPERS IN BOXES AND ENCLOSURES MAY BE BARE OR INSULATED COPPER WIRE. WIRE SIZE SHALL BE AS FOLLOWS:
 - I. USE #4 AWG BETWEEN THE POWER SERVICE AND SUPPORTS, POLES, PEDESTALS, CONTROLLER, OR FLASHER CABINETS.
 - II. THE INSULATION SHALL BE GREEN OR GREEN WITH YELLOW STRIPE(S). FOR #4 AWG OR LARGER, INSULATION MAY ALSO BE BLACK WITH GREEN TAPE/LABELS INSTALLED AT ALL ACCESS POINTS.

4. GROUND ROD
 - A. A 3/4 INCH SCHEDULE 40 PVC CONDUIT WILL BE USED IN FOUNDATIONS AND CONCRETE WALLS FOR THE GROUNDING CONDUCTOR (GROUND WIRE) RACEWAY TO THE GROUND ROD. SHOULD METALLIC CONDUIT BE USED, BOTH ENDS OF THE CONDUIT SHALL BE BONDED TO THE GROUNDING CONDUCTOR.
 - B. THE TYPICAL GROUNDING CONDUCTOR (GROUND WIRE) SHALL BE #4 AWG INSULATED, STRANDED COPPER.

5. POWER SERVICE AND MAIN PEDESTAL
 - A. AT THE POWER SERVICE LOCATION, THE GROUNDING CONDUCTOR (GROUND WIRE) FROM THE MAIN PEDESTAL NEUTRAL (AC-) BAR TO THE GROUND ROD SHALL BE A CONTINUOUS, UNSPLICED CONDUCTOR. IF SPLICED, IT SHALL BE AN EXOTHERMIC WELD BUTT SPLICE.
 - B. THE SERVICE NEUTRAL (AC-) SHALL ONLY BE CONNECTED TO GROUND AT THE PRIMARY POWER SERVICE DISCONNECT.
 - I. NEMA CONTROLLER CABINETS: IF A POWER SERVICE DISCONNECT IS LOCATED BEFORE THE CONTROLLER CABINET, THE NEUTRAL (AC-) AND THE GROUNDING BARS IN THE CONTROLLER CABINET SHALL NOT BE CONNECTED TOGETHER AS SHOWN IN NEMA TS-2, FIGURE 5-4.
 - II. IF SECONDARY DISCONNECT SWITCHES ARE CONNECTED AFTER THE PRIMARY DISCONNECT SWITCH, THE NEUTRAL (AC-) SHALL ONLY BE GROUNDED AT THE PRIMARY SWITCH. EQUIPMENT GROUNDING CONDUCTORS SHALL BE BROUGHT TO THE PRIMARY SWITCH, BUT SHALL BE GROUNDED AT BOTH SECONDARY AND PRIMARY SWITCHES.

6. PAYMENT – ALL MATERIALS AND WORK REQUIRED TO COMPLETE THE EFFECTIVE GROUND FAULT CURRENT PATH SYSTEM ARE INCIDENTAL TO THE CONDUCTORS INSTALLED BY CONTRACT.

IX. POST CONSTRUCTION INCIDENTALS

AS-BUILT DRAWINGS:

AS-BUILT REPRODUCIBLE MYLARS SHALL BE PROVIDED TO THE CITY OF CANTON BY THE DESIGN ENGINEER AT THE COMPLETION OF THE PROJECT. AS-BUILT INFORMATION CONSISTS OF POST-CONSTRUCTION FIELD SURVEY DATA OF THE LOCATION, FLOWLINE ELEVATIONS, AND TOP-OF-GRATE/RIM ELEVATIONS FOR ALL STORM AND SANITARY STRUCTURES CONSTRUCTED AND/OR IMPACTED BY THE PROJECT.

FOR PRIVATE PROJECTS, THE CONSTRUCTION BOND WILL NOT BE RELEASED UNTIL THE AS-BUILT DRAWINGS HAVE BEEN ACCEPTED.

PROPOSED MONUMENTATION:

THE CONTRACTOR'S SURVEYOR SHALL NOTIFY THE CITY ENGINEER IN WRITING UPON THE COMPLETION OF MONUMENTS BEING SET AS PER PLAN OR RECORD PLAT.

RELEASE OF RETAINER/BONDS:

PRIOR TO THE RELEASE OF RETAINER/CONSTRUCTION BOND BY THE CITY OF CANTON, THE CONTRACTOR SHALL HAVE COMPLETED THE ENGINEER'S PROJECT PUNCHLIST AND SUBMIT FINAL WAIVER OF LIEN, IN ACCORDANCE WITH CITY SS 01-00.

DATE: 3/20/19		DRAWN BY: NUL		REVISIONS		GENERAL NOTES		OFFICE OF THE CITY ENGINEER	
H. SCALE: N/A		APPROVED BY:		DATE		13TH STREET NW RECONSTRUCTION		CANTON, OHIO	
V. SCALE: N/A		FIELD BOOK:		DESCRIPTION		13TH STREET NW RECONSTRUCTION		DANIEL J. MOEGLIN, P.E., CITY ENGINEER	
SHEET 6 OF 18		FILE NAME: 13th St Gen Notes 3						2436 30th STREET N.E. 44705 (330)488-3381	

MAINTAINING TRAFFIC:

THE CONTRACTOR SHALL MAINTAIN TRAFFIC ADJACENT TO AND THROUGH THE PROJECT AS DESCRIBED BELOW AND IN ACCORDANCE WITH THE REQUIREMENTS OF THE OHIO DEPARTMENT OF TRANSPORTATION MANUAL OF CONSTRUCTION AND MATERIALS SPECIFICATIONS ITEM 614 MAINTAINING TRAFFIC. THE CONTRACTOR SHALL FURNISH, MAINTAIN, AND REMOVE ALL SIGNS, FLAGS, FLAGMEN, WATCHMEN, BARRICADES, SIGN SUPPORTS, CONES, BARRELS, AND INCIDENTALS IN CONFORMANCE WITH THE MOST RECENT REVISIONS OF THE CURRENT EDITION OF THE OHIO MANUAL OF UNIFORM TRAFFIC CONTROL DEVICES FOR STREETS AND HIGHWAYS AND THE FOLLOWING:

1. THE CONTRACTOR MUST MAINTAIN TWO-WAY TRAFFIC ON 13TH ST. AT ALL TIMES. DURING WORKING HOURS, IF ONE LANE IN EACH DIRECTION CAN NOT BE MAINTAINED, FLAGGERS MAY BE USED. DURING NON-WORKING HOURS, A MINIMUM OF ONE TEN FOOT LANE IN EACH DIRECTION SHALL BE MAINTAINED ON 13TH ST. ON THE EXISTING PAVEMENT OR COMPLETED PAVEMENT AT ALL TIMES.
2. CONES SHALL NOT BE ACCEPTABLE TRAFFIC CONTROL DEVICES FOR LANE RESTRICTIONS OR LANE REDUCTIONS THAT ARE IN OPERATION ONE-HALF HOUR AFTER SUNSET OR ONE-HALF HOUR BEFORE SUNRISE. ALL NIGHTTIME LANE RESTRICTIONS SHALL REQUIRE DRUMS AT A MINIMUM SPACING OF FIFTY (50) FEET.
3. THE CONTRACTOR SHALL FURNISH, ERECT, MAINTAIN, AND SUBSEQUENTLY REMOVE ALL FLAGS, BARRICADES, SIGNS, AND SIGN SUPPORTS AND FURNISH AND MAINTAIN ALL FLAGGERS, WATCHERS AND INCIDENTALS RELATED THERETO.
4. ONLY DURING OFF-PEAK PERIODS (I.E. ANY PERIOD OTHER THAN 6-8AM AND 3-6PM) SHALL THE CONTRACTOR INSTALL AND SUBSEQUENTLY RESET ALL TRAFFIC CONTROL NECESSARY FOR THE WORK ZONE FOR EACH CONSTRUCTION PHASE.
5. IN ADDITION TO THE REQUIREMENTS OF 614 WORK ZONE PAVEMENT MARKINGS (<614.11>), AT THE END OF EACH DAY OF WORK, THE CONTRACTOR SHALL REPLACE (WITH WORK ZONE MARKINGS) ALL LANE, CENTER, STOP OR CHANNELIZING LANES THAT WERE REMOVED OR COVERED DURING THE PAVEMENT REMOVAL OR PAVEMENT PLACING OPERATIONS. QUANTITIES FOR SUCH PLACEMENT ARE CARRIED AS PART OF THE ITEMS LISTED UNDER 614 WORK ZONE PAVEMENT MARKINGS.
8. A QUANTITY OF 200 CU. YD. OF 614 ASPHALT CONCRETE FOR MAINTAINING TRAFFIC SHALL BE PROVIDED FOR USE IN MAINTAINING PAVEMENT, SHOULDERS, AND OTHER LOCATIONS PRIOR TO RESURFACING, AS DIRECTED BY THE ENGINEER.
9. PRIOR TO OPENING TO TRAFFIC EACH LANE SHALL BE IN A SAFE, PASSABLE CONDITION. ALL TRANSVERSE JOINTS SHALL EXTEND ACROSS THE FULL LANE WIDTH AND EACH LANE SHALL BE FREE FROM UNEVEN LONGITUDINAL JOINTS. THE CONTRACTOR SHALL PROVIDE ASPHALT WEDGES FOR TRANSVERSE JOINTS WHEREVER THERE ARE PAVEMENT ELEVATION DIFFERENCES.
10. ACCESS SHALL BE MAINTAINED AT ALL TIMES FOR EMERGENCY AND FIRE DEPARTMENT VEHICLES.
11. THE CONTRACTOR SHALL MAINTAIN ACCESS TO LOCAL RESIDENCES AND BUSINESSES DURING CONSTRUCTION. IN THE EVENT A DRIVE ACCESS NEEDS TO BE CLOSED, THE CONTRACTOR SHALL GIVE NOTICE OF CLOSURE AND DURATION TO THE PROPERTY OWNER 24 HOURS IN ADVANCE. CONTRACTOR SHALL ARRANGE FOR ALTERNATE PARKING AND REASONABLE ACCESS FOR THOSE PROPERTY OWNERS AFFECTED BY DRIVE CLOSURES.

TEMPORARY TRAFFIC CONTROL PLAN:

THE CONTRACTOR SHALL DEVELOP A TEMPORARY TRAFFIC CONTROL PLAN FOR THE PROJECT. THE PLAN MUST TAKE INTO ACCOUNT THE PREVIOUS STIPULATIONS. THE PLAN MUST BE APPROVED BY THE ENGINEER PRIOR TO IMPLEMENTATION.

SPECIAL CARE MUST BE TAKEN AT THE EASTERN TRANSITION (HARRISON AVE.).

PAYMENT FOR ALL ITEMS NOT OTHERWISE ACCOUNTED FOR IN THE PLANS SHALL BE INCLUDED IN THE LUMP SUM PRICE BID FOR ITEM 614 MAINTAINING TRAFFIC.

WINTER SHUTDOWN PERIOD:

IF FINAL PAVING IS NOT PERFORMED PRIOR TO THE WINTER SHUTDOWN PERIOD, THE CONTRACTOR SHALL WEDGE/RAMP AROUND ALL CASTINGS TO ALLOW FOR SNOW PLOWING.

PAYMENT SHALL BE INCLUDED IN THE LUMP SUM PRICE BID FOR ITEM 614 MAINTAINING TRAFFIC.

TRAFFIC CONTROL INSPECTOR:

THE CONTRACTOR SHALL DESIGNATE AN INDIVIDUAL OTHER THAN THE SUPERINTENDENT AND SUBJECT TO THE APPROVAL OF THE ENGINEER, TO CONTINUOUSLY INSPECT ALL TRAFFIC CONTROL DEVICES WHENEVER CONSTRUCTION WORK IS BEING PERFORMED WITHIN THE WORK LIMITS OF THE PROJECT. THE DESIGNATED INDIVIDUAL SHALL ALSO INSPECT ALL TRAFFIC DEVICES AT THE BEGINNING AND AT THE END OF EACH WORK DAY. THE DESIGNATED INDIVIDUAL OR QUALIFIED REPRESENTATIVE SHALL ALSO BE AVAILABLE ON AN AROUND THE CLOCK BASIS TO REPAIR AND/OR REPLACE DAMAGED OR MISSING TRAFFIC CONTROL DEVICES. THESE INDIVIDUALS SHALL BE EQUIPPED WITH CELLULAR PHONES AND THEIR NAMES AND PHONE NUMBERS SHALL BE GIVEN TO THE PROJECT ENGINEER AT THE PRE-CONSTRUCTION MEETING. THE DESIGNATED INDIVIDUAL MAY HAVE OTHER CONSTRUCTION RELATED DUTIES AS LONG AS IMMEDIATE ATTENTION IS GIVEN TO TRAFFIC CONTROL. PAYMENT FOR THE SERVICES OF THE TRAFFIC CONTROL INSPECTOR SHALL BE INCLUDED IN THE LUMP SUM PRICE BID FOR ITEM 614 MAINTAINING TRAFFIC.

TRAFFIC SIGNALS:

THE TEMPORARY TRAFFIC CONTROL PLAN WILL LIKELY REQUIRE MODIFICATIONS TO THE TRAFFIC SIGNAL OPERATIONS AT THE EASTERN AND WESTERN TERMINI. THE CONTRACTOR SHALL COORDINATE WITH CITY OF CANTON TRAFFIC ENGINEERING AND TRAFFIC SIGNAL AND LIGHTING DIVISIONS TO FACILITATE THE CHANGES. CITY PERSONNEL WILL MAKE NECESSARY CHANGES TO THE DETECTION ZONES, SIGNAL PHASINGS, AND SIGNAL TIMINGS AS NECESSARY.

ITEM 614 - LAW ENFORCEMENT OFFICER WITH PATROL CAR FOR ASSISTANCE:

IN ADDITION TO THE REQUIREMENTS OF CMS 614 AND THE OMTCD, A UNIFORMED LAW ENFORCEMENT OFFICER (LEO) WITH AN OFFICIAL PATROL CAR (CAR WITH TOP-MOUNTED EMERGENCY FLASHING LIGHTS AND COMPLETE MARKINGS OF THE APPROPRIATE LAW ENFORCEMENT AGENCY) SHALL BE PROVIDED FOR CONTROLLING TRAFFIC AS DIRECTED BY THE ENGINEER FOR THE FOLLOWING TASKS:

1. FOR LANE CLOSURES: DURING INITIAL SET-UP PERIODS, TEAR DOWN PERIODS, SUBSTANTIAL SHIFTS OF A CLOSURE POINT OR WHEN NEW LANE CLOSURE ARRANGEMENTS ARE INITIATED.

LAW ENFORCEMENT OFFICERS SHOULD NOT BE USED WHERE THE OMTCD INTENDS THAT FLAGGERS BE USED. THE LEO'S ARE CONSIDERED TO BE EMPLOYED BY THE CONTRACTOR AND THE CONTRACTOR SHALL BE RESPONSIBLE FOR THEIR ACTIONS. ALTHOUGH THEY ARE EMPLOYED BY THE CONTRACTOR, THE PROJECT ENGINEER SHALL HAVE CONTROL OVER THEIR PLACEMENT. THE OFFICAL PATROL CAR SHALL BE A PUBLIC SAFETY VEHICLE AS REQUIRED BY THE OHIO REVISED CODE.

THE CONTRACTOR SHALL MAKE ARRANGEMENTS FOR THESE SERVICES WITH:

CITY OF CANTON POLICE DEPARTMENT
221 THIRD STREET S.W.
CANTON, OHIO 44702
330-489-3111

LAW ENFORCEMENT OFFICERS WITH PATROL CAR REQUIRED BY THE TRAFFIC MAINTENANCE TASKS ABOVE SHALL BE PAID FOR ON A UNIT PRICE (HOURLY) BASIS UNDER ITEM 614. LAW ENFORCEMENT OFFICER WITH PATROL CAR. THE FOLLOWING ESTIMATED QUANTITY HAS BEEN CARRIED TO THE GENERAL SUMMARY:

ITEM 614, LAW ENFORCEMENT OFFICER WITH PATROL CAR 80 HOURS

THE HOURS PAID SHALL INCLUDE MINIMUM SHOW-UP TIME REQUIRED BY THE LAW ENFORCEMENT AGENCY INVOLVED.

IF THE CONTRACTOR WISHES TO UTILIZE LEO'S FOR FLAGGING AND TRAFFIC CONTROL OTHER THAN FOR THAT REQUIRED IN THESE PLANS, HE MAY DO SO AT HIS OWN EXPENSE. PAYMENT FOR THE EXCESS ABOVE THE CONTRACT REQUIREMENTS WILL BE INCLUDED UNDER ITEM 614 MAINTAINING TRAFFIC.

CONTRACTOR'S EQUIPMENT - OPERATION AND STORAGE:

A QUALIFIED FLAGGER SHALL BE EMPLOYED WHERE THE CONTRACTOR'S EQUIPMENT MUST MERGE WITH THE TRAFFIC STREAM. THE CONTRACTOR'S EQUIPMENT SHALL BE EQUIPPED WITH AT LEAST ONE AMBER FLASHING LIGHT. PAVERS, ROLLERS AND OTHER EQUIPMENT MAY NOT BE PARKED ON CLEVELAND AVENUE, BUT MAY BE PARKED ON SIDE STREETS, WITH THE ENGINEER'S APPROVAL, WHEN PAVING OPERATIONS ARE SCHEDULED TO CONTINUE WITHIN THE NEXT WORKDAY. OTHERWISE THE EQUIPMENT SHALL BE STORED AT A STORAGE AREA OUTSIDE THE R/W, THE LOCATION OF WHICH SHALL HAVE PRIOR APPROVAL OF THE ENGINEER. WHEN PARKING ALONG A SIDE STREET, ADEQUATE BARRICADES AND LIGHTS SHALL BE PLACED ON THE PAVEMENT SIDE OF THE EQUIPMENT TO IDENTIFY THE LIMITS OF THE EQUIPMENT. ALL OTHER EQUIPMENT, INCLUDING PRIVATE VEHICLES, SHALL BE STORAGE AT THE APPROVED CONTRACTOR'S STORAGE AREA. NO EQUIPMENT SHALL BE PARKED ON PRIVATE PROPERTY UNLESS PRIOR APPROVAL OF THE OWNER AND THE PROJECT ENGINEER HAS BEEN GRANTED.

DATE: 3/26/19		DRAWN BY: NUL		REVISIONS		OFFICE OF THE CITY ENGINEER CANTON, OHIO	
H. SCALE: N/A		APPROVED BY:		DESCRIPTION		MAINTENANCE OF TRAFFIC	
V. SCALE: N/A		FIELD BOOK:		DATE		13TH STREET NW RECONSTRUCTION	
SHEET 7 OF 18		FILE NAME: 13th St. MOT		BY		DANIEL J. MOEGLIN, P.E., CITY ENGINEER 2436 30th STREET N.E. 44705 (330)489-3381	

NOTES:

1. THE BEARING OF THE CENTERLINE OF 13TH ST. COINCIDES WITH THE EXISTING CENTER PAVEMENT JOINT.
2. STATIONING IS TIED TO PK NAILS LOCATED ALONG THE CENTER JOINT.

PK NAILS TO BE SET PRIOR TO STAGE 3 PLANS. LOCATIONS AND TIE-IN WILL BE SHOWN ON SCHEMATIC.

PROJECT DESCRIPTION:
IMPROVEMENTS WILL INCLUDE PAVEMENT REPLACEMENT, STREETSCAPING, LIGHTING, AND SIDEWALK REPLACEMENT.

USGS QUADRANT: NORTH CANTON QUADRANGLE
NORTH CANTON, OHIO

LONGITUDE: W 81°24'06" *
LATITUDE: N 40°48'42" *
* LONGITUDE AND LATITUDE TO APPROXIMATE CENTER OF PROJECT.

LEGEND:

- ■ ■ NEW CATCH BASIN
- ⊙ NEW MANHOLE
- ▣ ⊙ EXISTING CATCH BASIN

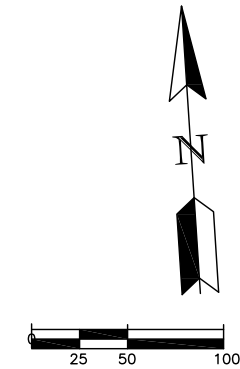
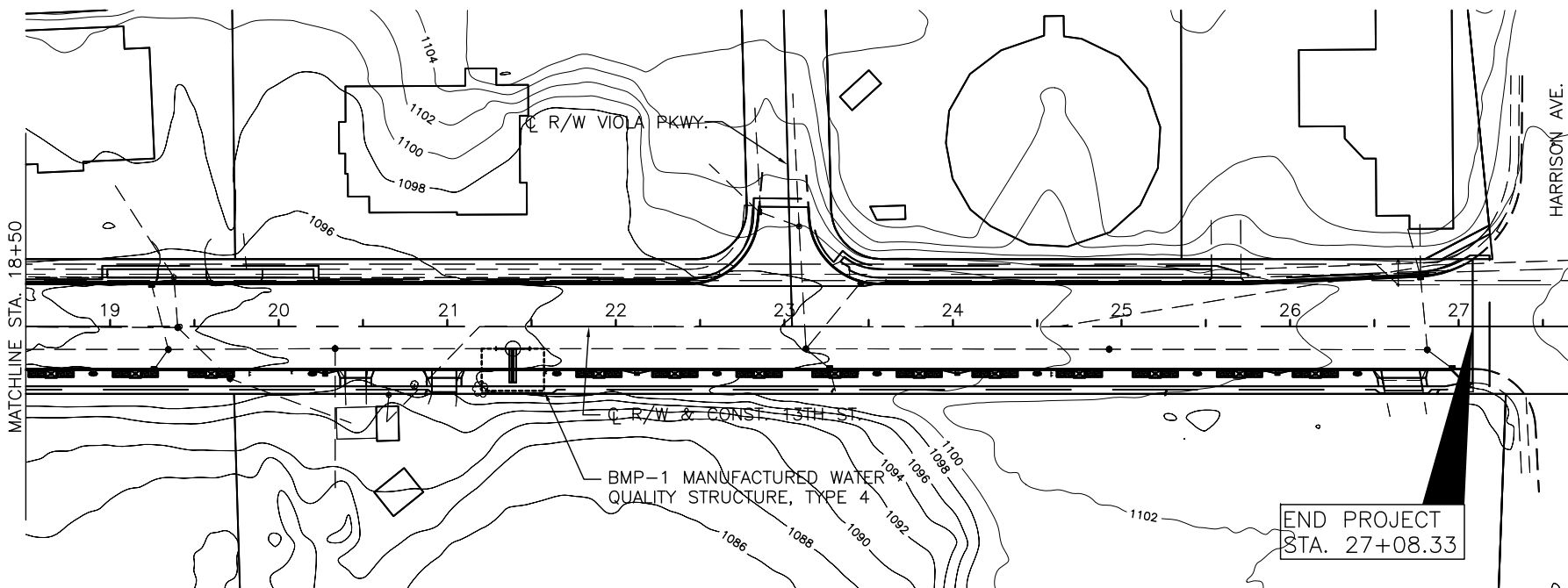
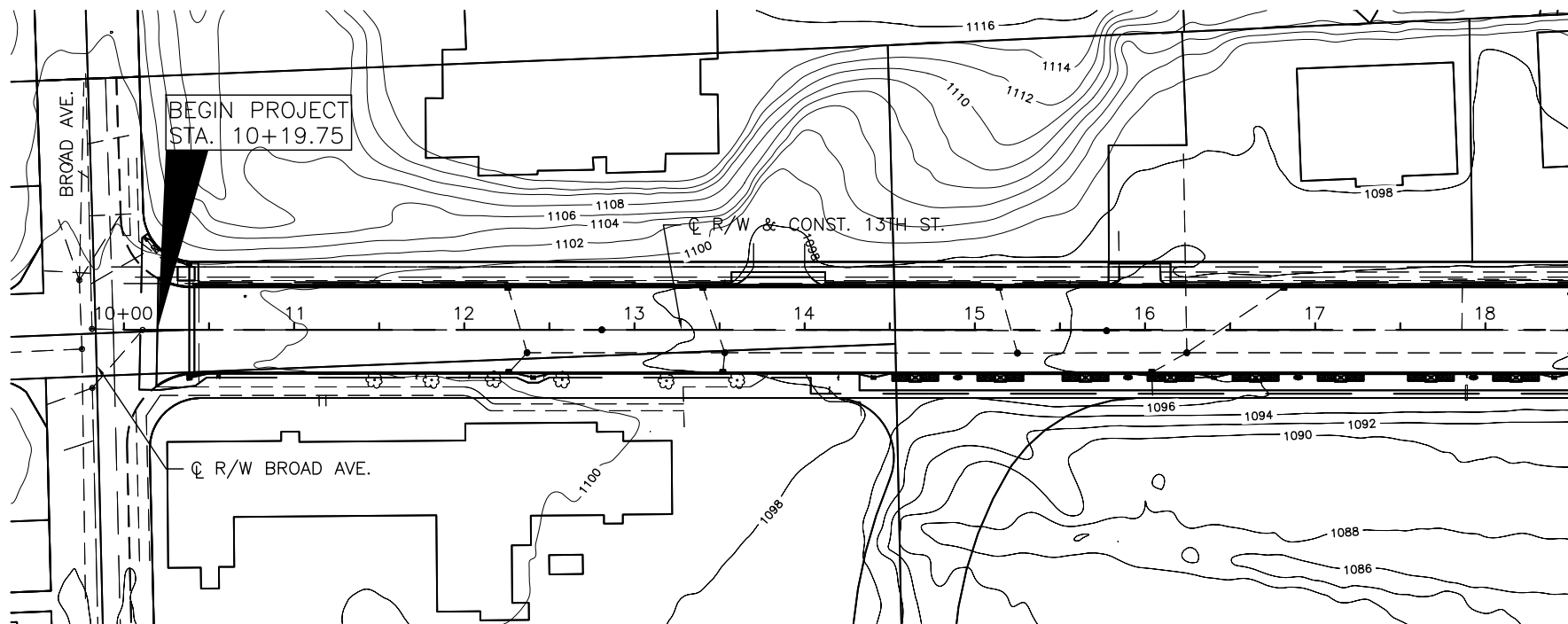

OFFICE OF THE CITY ENGINEER
CANTON, OHIO
DANIEL J. MOEGLIN, P.E., CITY ENGINEER
2436 30th STREET N.E. 44705 (330)488-3381

PROJECT SITE PLAN
13TH STREET NW RECONSTRUCTION

REVISIONS	DATE	BY

DRAWN BY: NUL	APPROVED BY:	FIELD BOOK:	FILE NAME: 13th St Project Site Plan
DATE: 7/30/20	H. SCALE:	V. SCALE:	SHEET 9 OF 18

ESTIMATED QUANTITIES			
ITEM	QUANTITY	UNIT	DESCRIPTION
832	LUMP		STORM WATER POLLUTION PREVENTION PLAN
832	18,500	EACH	EROSION CONTROL
QUANTITIES CARRIED TO THE GENERAL SUMMARY			

PERMANENT STORM WATER BMP					EDA TREATMENT CREDIT (ACRES)
BMP TYPE	STATION	OFFSET	LATITUDE	LONGITUDE	
BMP 1 - MANUFACTURED WATER QUALITY STRUCTURE, TYPE 4	21+38.98	13.17' RT.	40.811601°	-81.400460°	0.79
TREATMENT REQUIRED*					0.53

* CALCULATED PER L&D VOL. 2, SEC. 1115.7

PROJECT DATA	
TOTAL AREA (RIGHT OF WAY)	3.20 ACRES
PROJECT EARTH DISTURBED AREA	2.66 ACRES
ESTIMATED CONTRACTOR EARTH DISTURBED AREA	0.25 ACRES
NOTICE OF INTENT EARTH DISTURBED AREA	4.90 ACRES
IMPERVIOUS (PAVED) AREA FOR PRE-CONSTRUCTION SITE	2.23 ACRES
IMPERVIOUS (PAVED) AREA FOR POST-CONSTRUCTION SITE	2.52 ACRES
RUNOFF COEFFICIENT FOR PRE-CONSTRUCTION SITE	0.5-0.9
RUNOFF COEFFICIENT FOR POST-CONSTRUCTION SITE	0.68
IMMEDIATE RECEIVING WATERS	WESTBROOK PARK POND
SUBSEQUENT RECEIVING WATER	WEST BRANCH NIMISHILLEN CREEK
POST-CONSTRUCTION BMP: A MANUFACTURED WATER QUALITY STRUCTURE IS PROVIDED TO MEET NPDES POST-CONSTRUCTION REQUIREMENTS.	

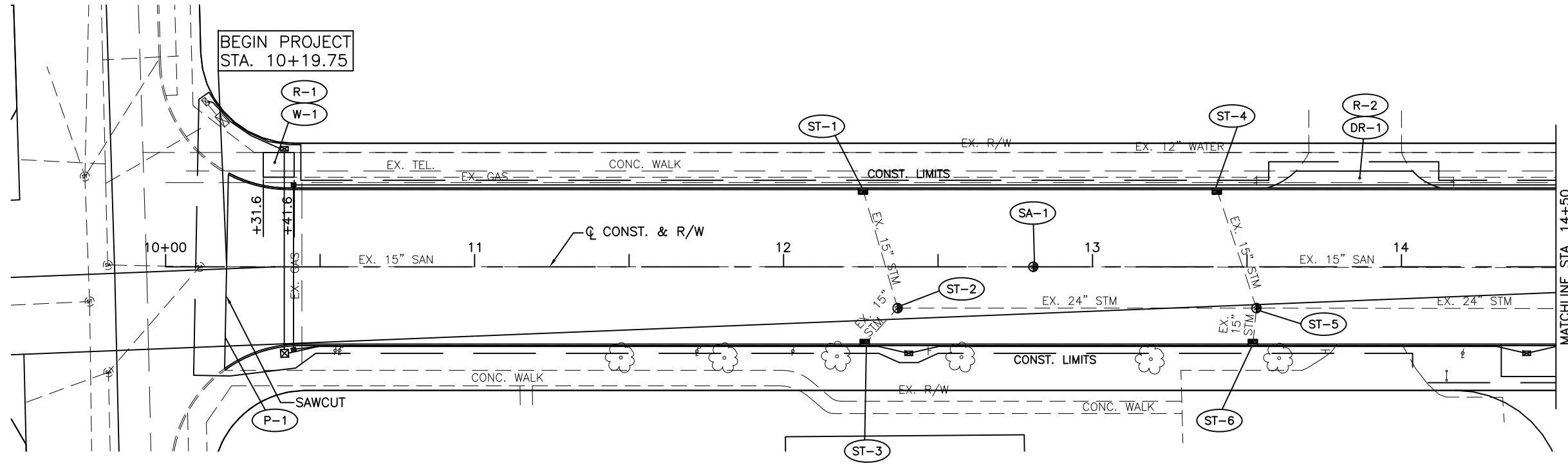

NOTE:
SOUTH WALK AND STREETSCAPE ITEMS ARE
QUANTIFIED IN STREETSCAPE PLANS

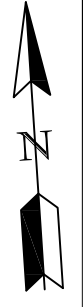
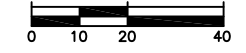

				204	301	304	407	407	441	424	202	202	605	609	638	
	DISTANCE (D)	AVERAGE WIDTH (W)	SURFACE AREA (A) A=DxW	SUBGRADE COMPACTION A 9	ASPH. CONC. BASE (6") 6*A 12*27	AGGREGATE BASE (6") 6*A 12*27	TACK COAT (0.10 GAL/SY) 0.10*A 9	TACK COAT FOR INTERM. COURSE (0.10 GAL/SY) 0.10*A 9	ASPH. CONC. INTERM. COURSE (2 1/4") 2.25*A 12*27	FINE GRADED POLYMER A.C., TYPE A (1/2") 0.75*A 12*27	PAVEMENT REMOVED	CURB REMOVED	4" BASE PIPE UNDERDRAINS WITH FABRIC	CURB TYPE 6, AS PER PLAN	SEEDING AND MULCHING	
	FT	FT	SQ FT	SQ YD	CU YD	CU YD	GAL	GAL	CU YD	CU YD	SQ YD	FT	FT	FT	SQ YD	
10+19.75	TO 10+43.59	23.84	56.4	1345	149	25	25	15	15	9	3	149	48	48	48	11
10+43.59	TO 14+50	406.41	50	20321	2258	376	376	226	226	141	47	2258	813	813	813	361
TOTALS CARRIED TO GENERAL SUMMARY				2407	401	401	241	241	150	50	2407	861	861	861	372	

REFERENCE	202	202	203	252	304	608	452		611	611
	PAVEMENT REMOVED	WALK REMOVED	EXCAVATION	FULL DEPTH PAVEMENT SAWING	AGGREGATE BASE	5" CONCRETE WALK, AS PER PLAN	7" NON-REINFORCED CONCRETE PAVEMENT, QC1		CATCH BASIN RECONSTRUCTED TO GRADE, AS PER PLAN	MANHOLE ADJUSTED TO GRADE, AS PER PLAN
	SQ YD	SQ FT	CU YD	FT	CU YD	SQ FT	SQ YD		EACH	EACH
R-1		80								
R-2	29									
DR-1			3		3		29			
W-1			1		1	80				
P-1				63						
SA-1										1
ST-1									1	
ST-2									1	1
ST-3									1	
ST-4									1	
ST-5									1	1
ST-6									1	
TOTALS CARRIED TO GENERAL SUMMARY	339	339	4	63	4	80	29		4	3

OFFICE OF THE CITY ENGINEER
CANTON, OHIO
DANIEL J. MOEGLIN, P.E., CITY ENGINEER
2436 30th STREET N.E. 44705 (330)488-3381

PLAN
13TH STREET NW RECONSTRUCTION

DATE: 3/22/19	REVISIONS	DESCRIPTION	DATE	BY
H. SCALE:				
V. SCALE:				
SHEET 10 OF 16				

DRAWN BY: NUL
APPROVED BY:
FIELD BOOK:
FILE NAME: 13th St Plan 1

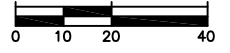
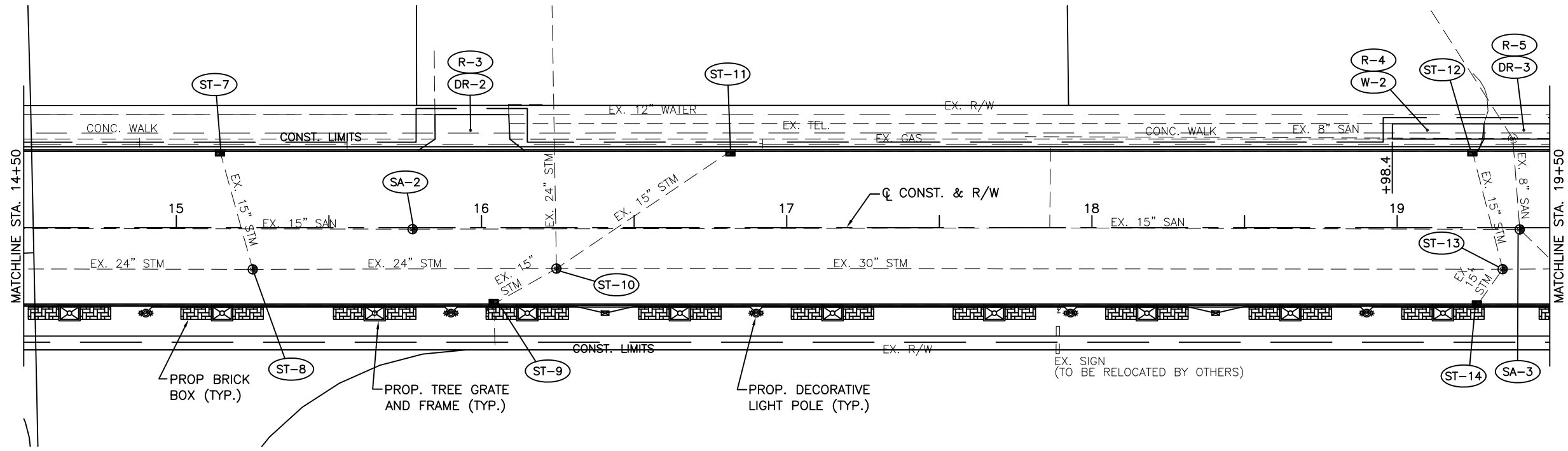

NOTE:
SOUTH WALK AND STREETScape ITEMS ARE
QUANTIFIED IN STREETScape PLANS

				204	301	304	407	407	441	424	202	202	605	609	638	
	DISTANCE (D)	AVERAGE WIDTH (W)	SURFACE AREA (A) A=DxW	SUBGRADE COMPACTION A 9	ASPH. CONC. BASE (6") 6*A 12*27	AGGREGATE BASE (6") 6*A 12*27	TACK COAT (0.10 GAL/SY) 0.10*A 9	TACK COAT FOR INTERM. COURSE (0.10 GAL/SY) 0.10*A 9	ASPH. CONC. INTERM. COURSE (2 1/4") 2.25*A 12*27	FINE GRADED POLYMER A.C., TYPE A (1/2") 0.75*A 12*27	PAVEMENT REMOVED	CURB REMOVED	4" BASE PIPE UNDERDRAINS WITH FABRIC	CURB TYPE 6, AS PER PLAN	SEEDING AND MULCHING	
	FT	FT	SQ FT	SQ YD	CU YD	CU YD	GAL	GAL	CU YD	CU YD	SQ YD	FT	FT	FT	SQ YD	
14+50	TO	19+50	500	50	25000	2778	463	463	278	278	174	58	2778	1000	1000	111
TOTALS CARRIED TO GENERAL SUMMARY					2778	463	463	278	278	174	58	2778	1000	1000	1000	111

REFERENCE	202	202	203	252	304	608	452		611	611
	PAVEMENT REMOVED	WALK REMOVED	EXCAVATION	FULL DEPTH PAVEMENT SAWING	AGGREGATE BASE	5" CONCRETE WALK, AS PER PLAN	7" NON-REINFORCED CONCRETE PAVEMENT, QC1		CATCH BASIN RECONSTRUCTED TO GRADE, AS PER PLAN	MANHOLE ADJUSTED TO GRADE, AS PER PLAN
	SQ YD	SQ FT	CU YD	FT	CU YD	SQ FT	SQ YD		EACH	EACH
R-3	33									
R-4		150								
R-5	29									
DR-2			4		4		33			
DR-3			3		3		28			
W-2			2		2	150				
SA-2										1
SA-3										1
ST-7									1	
ST-8									1	
ST-9									1	
ST-10										1
ST-11									1	
ST-12									1	
ST-13										1
ST-14									1	
TOTALS CARRIED TO GENERAL SUMMARY	62	150	9	0	9	150	61		6	4



OFFICE OF THE CITY ENGINEER
CANTON, OHIO
DANIEL J. MOEGLIN, P.E., CITY ENGINEER
2436 30th STREET N.E. 44705 (330)488-3381

PLAN
13TH STREET NW RECONSTRUCTION

DATE: 3/22/19	REVISIONS	DESCRIPTION	DATE	BY
H. SCALE:				
V. SCALE:				
SHEET 11 OF 16				

DRAWN BY: NJL
APPROVED BY:
FIELD BOOK:
FILE NAME: 13th St Plan 2

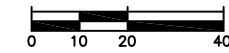
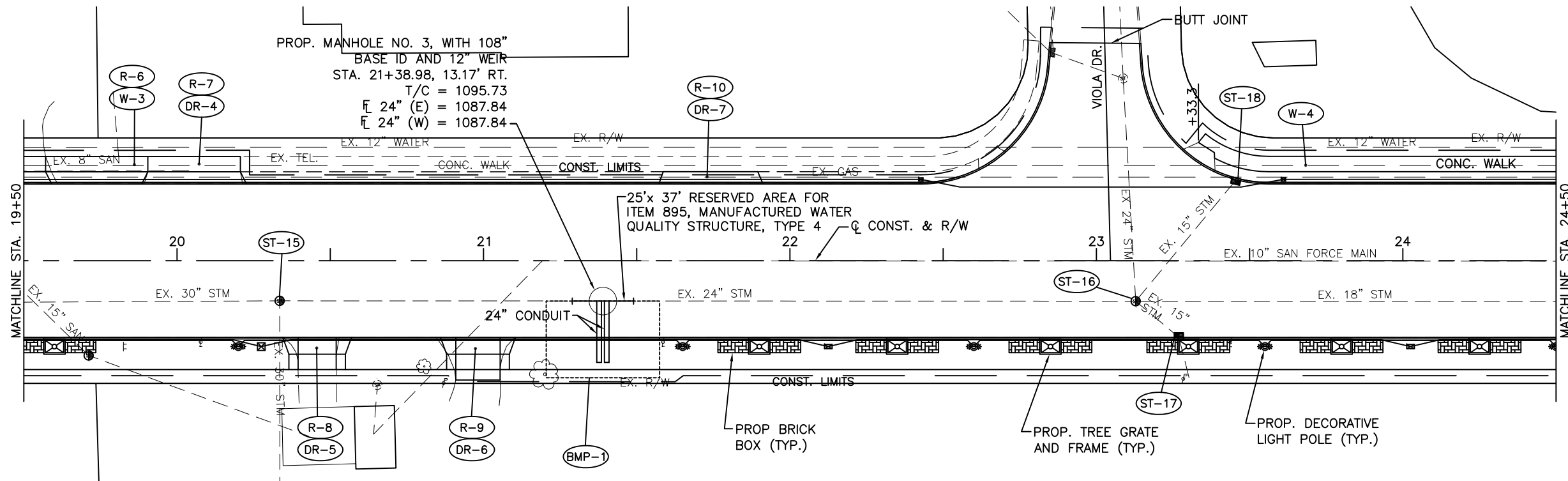

NOTE:
SOUTH WALK AND STREETSCAPE ITEMS ARE
QUANTIFIED IN STREETSCAPE PLANS

	DISTANCE (D)	AVERAGE WIDTH (W)	SURFACE AREA (A) A=DxW	SUBGRADE COMPACTION A 9	ASPH. CONC. BASE (6") 6*A 12*27	AGGREGATE BASE (6") 6*A 12*27	TACK COAT (0.10 GAL/SY) 0.10*A 9	TACK COAT FOR INTERM. COURSE (0.10 GAL/SY) 0.10*A 9	ASPH. CONC. INTERM. COURSE (2 1/4") 2.25*A 12*27	FINE GRADED POLYMER A.C., TYPE A (1/2") 0.75*A 12*27	PAVEMENT REMOVED	CURB REMOVED	4" BASE PIPE UNDERDRAINS WITH FABRIC	CURB TYPE 6, AS PER PLAN	SEEDING AND MULCHING
	FT	FT	SQ FT	SQ YD	CU YD	CU YD	GAL	GAL	CU YD	CU YD	SQ YD	FT	FT	FT	SQ YD
19+50 TO 24+50	500	50	25000	2778	463	463	278	278	174	58	2778	886	886	886	86
VIOLA DR.			2118	235	39	39	24	24	15	5	235	140	140	140	31
TOTALS CARRIED TO GENERAL SUMMARY				3013	502	502	302	302	189	63	3013	1026	1026	1026	117

REFERENCE	611	611	895
24" CONDUIT, TYPE B			
MANHOLE, NO. 3 W/108" BASE I.D. & 12" WEIR			
MANUFACTURED WATER QUALITY STRUCTURE, TYPE 4			
BMP-1	50	1	1
TOTALS CARRIED TO GENERAL SUMMARY	50	1	1

REFERENCE	202	202	203	252	304	608	452		611	611
	PAVEMENT REMOVED	WALK REMOVED	EXCAVATION	FULL DEPTH PAVEMENT SAWING	AGGREGATE BASE	5" CONCRETE WALK, AS PER PLAN	7" NON-REINFORCED CONCRETE PAVEMENT, QC1		CATCH BASIN RECONSTRUCTED TO GRADE, AS PER PLAN	MANHOLE ADJUSTED TO GRADE, AS PER PLAN
	SQ YD	SQ FT	CU YD	FT	CU YD	SQ FT	SQ YD		EACH	EACH
R-6		167								
R-7	29									
R-8	15									
R-9	27									
R-10	13									
DR-4			3		3		29			
DR-5			2		2		22			
DR-6			3		3		29			
DR-7			1		1		13			
W-3		2			2	167				
W-4		16			7	580				
ST-15										1
ST-16									1	1
ST-17									1	
ST-18									1	
TOTALS CARRIED TO GENERAL SUMMARY	84	167	27	0	18	747	93		2	2

OFFICE OF THE CITY ENGINEER
CANTON, OHIO
DANIEL J. MOEGLIN, P.E., CITY ENGINEER
2436 30th STREET N.E. 44705 (330)488-3381

PLAN
13TH STREET NW RECONSTRUCTION

DATE: 3/22/19	REVISIONS	DESCRIPTION	DATE	BY
H. SCALE:				
V. SCALE:				
SHEET 12 OF 16				

DRAWN BY: NUL
APPROVED BY:
FIELD BOOK:
FILE NAME: 13th St Plan 3

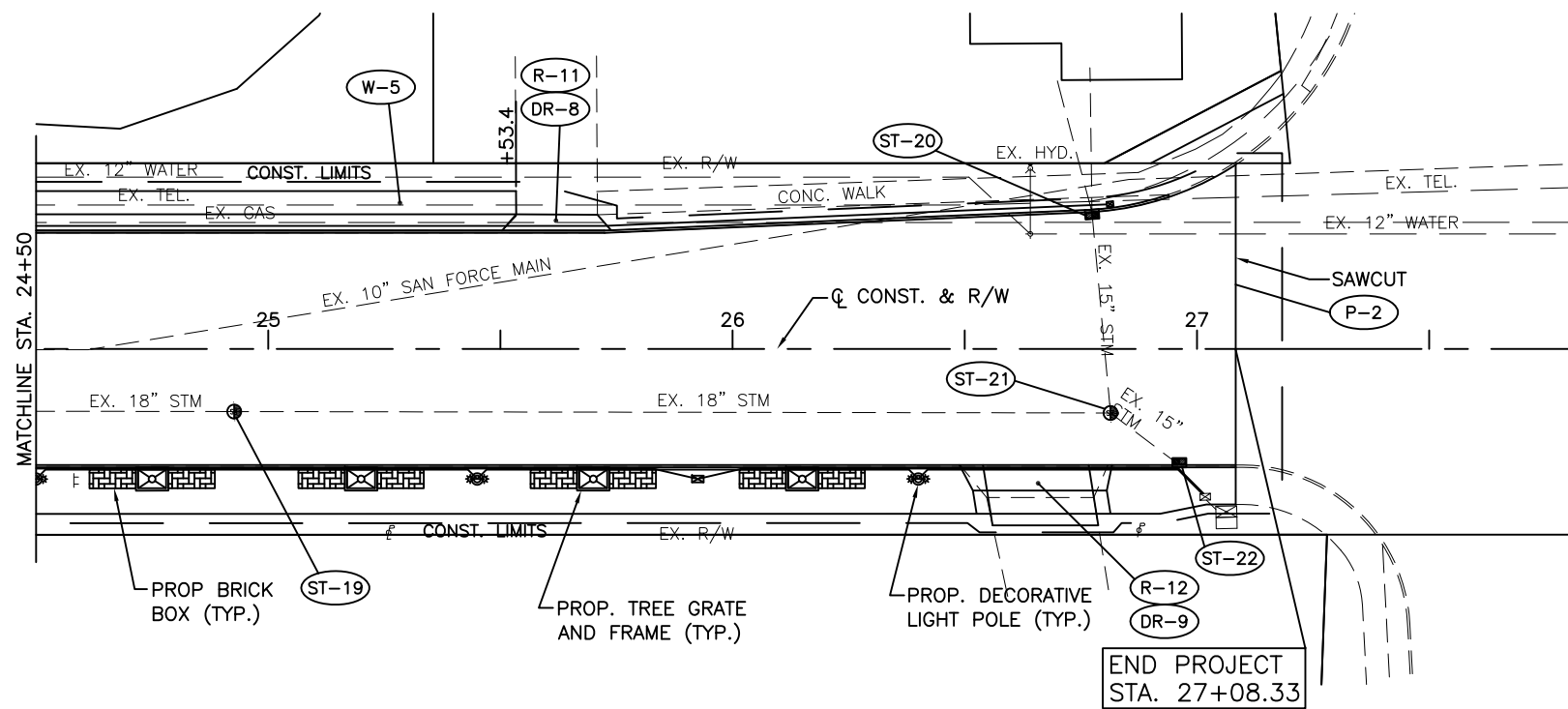

NOTE:
SOUTH WALK AND STREETSCAPE ITEMS ARE
QUANTIFIED IN STREETSCAPE PLANS



				204	301	304	407	407	441	424	202	202	605	609	638	
		DISTANCE (D)	AVERAGE WIDTH (W)	SURFACE AREA (A) A=DxW	SUBGRADE COMPACTION A 9	ASPH. CONC. BASE (6") 6xA 12*27	AGGREGATE BASE (6") 6xA 12*27	TACK COAT (0.10 GAL/SY) 0.10xA 9	TACK COAT FOR INTERM. COURSE (0.10 GAL/SY) 0.10xA 9	ASPH. CONC. INTERM. COURSE (2 1/4") 2.25xA 12*27	FINE GRADED POLYMER A.C., TYPE A (1/2") 0.75xA 12*27	PAVEMENT REMOVED	CURB REMOVED	4" BASE PIPE UNDERDRAINS WITH FABRIC	CURB TYPE 6, AS PER PLAN	SEEDING AND MULCHING
		FT	FT	SQ FT	SQ YD	CU YD	CU YD	GAL	GAL	CU YD	CU YD	SQ YD	FT	FT	FT	SQ YD
24+50	TO 25+72.43	122.43	50	6122	680	113	113	68	68	43	14	680	245	245	245	27
25+72.43	TO 26+76.28	103.85	52.5	5452	606	101	101	61	61	38	13	606	208	208	208	23
26+76.28	TO 27+08.33	32.05	59.8	1917	213	36	36	21	21	13	4	213	66	66	66	7
TOTALS CARRIED TO GENERAL SUMMARY					1499	250	250	150	150	94	31	1499	519	519	519	57

REFERENCE	202	202	203	252	304	608	452		611	611
	PAVEMENT REMOVED	WALK REMOVED	EXCAVATION	FULL DEPTH PAVEMENT SAWING	AGGREGATE BASE	5" CONCRETE WALK, AS PER PLAN	7" NON-REINFORCED CONCRETE PAVEMENT, QC1		CATCH BASIN RECONSTRUCTED TO GRADE, AS PER PLAN	MANHOLE ADJUSTED TO GRADE, AS PER PLAN
	SQ YD	SQ FT	CU YD	FT	CU YD	SQ FT	SQ YD		EACH	EACH
R-11	8									
R-12	35									
DR-8			1		1		8			
DR-9			4		4		39			
W-5			6		6	517				
P-2				65						
ST-19									1	1
ST-20									1	1
ST-21										
ST-22										
TOTALS CARRIED TO GENERAL SUMMARY	43	0	11	65	11	517	47		2	2

OFFICE OF THE CITY ENGINEER
CANTON, OHIO
DANIEL J. MOEGLIN, P.E., CITY ENGINEER
2436 30th STREET N.E. 44705 (330)488-3381

PLAN
13TH STREET NW RECONSTRUCTION

DATE	BY	REVISIONS	DESCRIPTION
DATE: 3/22/19	BY: NUL		
H. SCALE:	APPROVED BY:		
V. SCALE:	FIELD BOOK:		
SHEET 13 OF 16	FILE NAME: 13th St Plan 4		

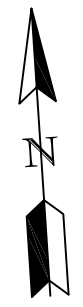
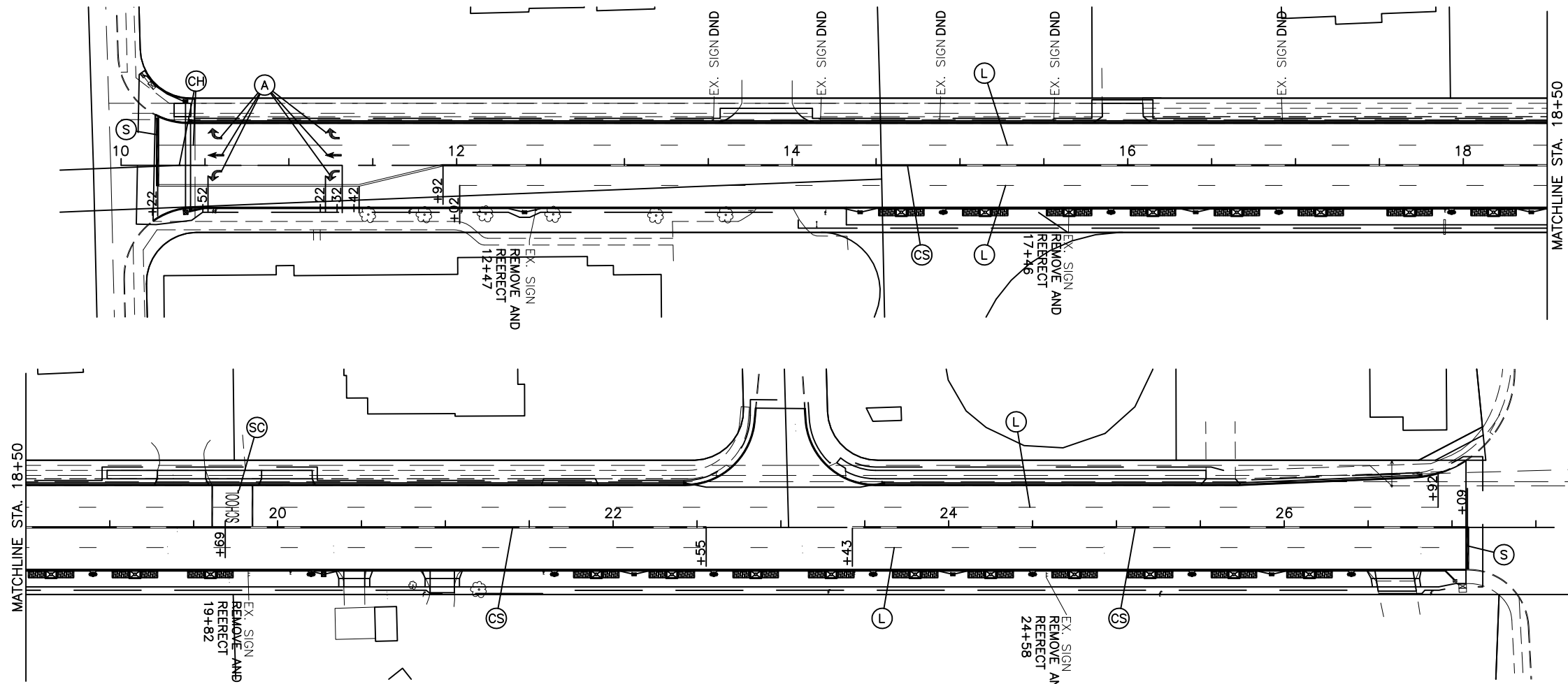

PAVEMENT MARKING LEGEND

- (CS) CENTER LINE, DOUBLE, SOLID
- (L) LANE LINE
- (CH) CHANNELIZING LINE
- (S) STOP LINE
- (CW) CROSSWALK LINE
- (TW) TRANSVERSE LINE, (WHITE), 12' C/C
- (RR) RAILROAD SYMBOL MARKING
- (SC) SCHOOL SYMBOL MARKING, 72 INCH
- (A) LANE ARROW

CENTER LINE			
FROM	TO	TOTAL MILES	COMMENTS
10+22	27+09	0.32	
TOTAL CARRIED TO GENERAL SUMMARY		0.32	
LANE LINE			
FROM	TO	TOTAL MILES	COMMENTS
10+22	27+09	0.32	WESTBOUND
12+02	27+09	0.29	EASTBOUND
TOTAL CARRIED TO GENERAL SUMMARY		0.61	

LOCATION	CHANNEL LINE FT	STOP LINE FT	TRANSVERSE DIAGONAL LINES		CROSS WALK LINES FT	LANE ARROWS				SYMBOL MARKINGS		COMMENTS	
			WHITE FT	YELLOW FT		LEFT EACH	THRU EACH	RIGHT EACH	COMBIN. EACH	RXR EACH	SCHOOL 72" EACH		
10+22		41											
10+22 TO 11+32	220												
10+52						1	1	1					
11+22						1	1	1					
19+69											1		
27+09		25											
TOTALS CARRIED TO GENERAL SUMMARY	220	66	0	0	0	2	2	2	0	0	1		

SIGN SUBSUMMARY	
LOCATION	EACH
	630
REMOVAL OF GROUND MOUNTED SIGN AND REERECTION	
12+47	1
17+46	1
19+82	1
24+58	1
TOTALS CARRIED TO GENERAL SUMMARY	4

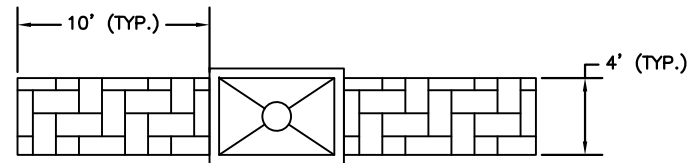
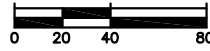
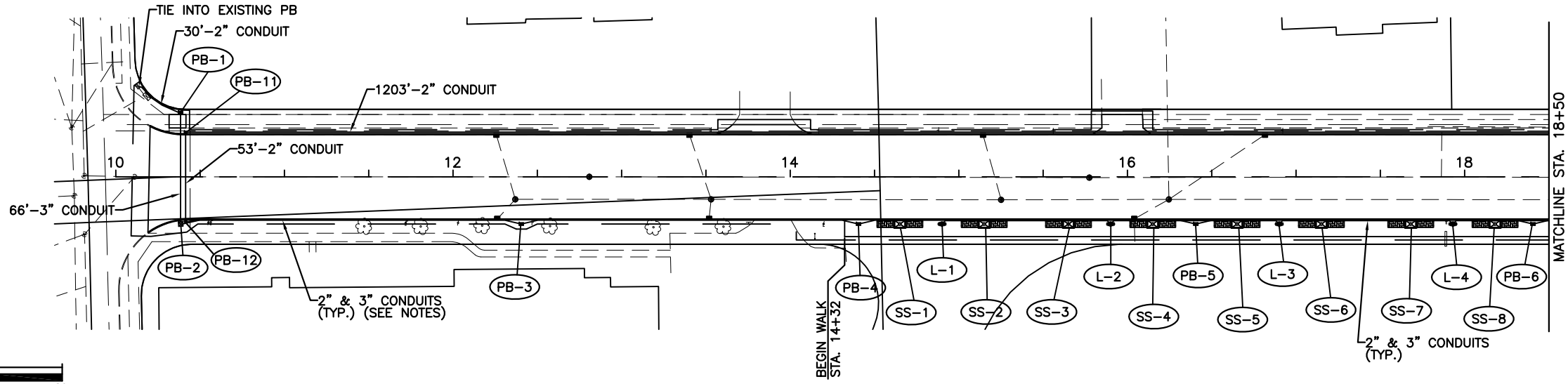

BRICK BOX AND TREE GRATE DETAIL

NOTE: SEE CITY OF CANTON STANDARD DRAWINGS 40-43 FOR ADDITIONAL DETAILS

NOTES:

1. LONGITUDINAL CONDUITS SHALL BE PLACED DIRECTLY BEHIND THE CURB AND HAVE 12" MINIMUM OF COVER.
2. 2" LIGHTING CONDUIT ON NORTH SIDE OF 13TH ST. SHALL BE CONTINUOUS BETWEEN PULL BOXES AND IS FOR FUTURE USE.
3. 2" LIGHTING CONDUIT ON SOUTH SIDE OF 13TH ST. SHALL RUN BETWEEN LIGHT POLE FOUNDATIONS WITH THE EXCEPTION OF THE CONDUIT WEST OF L-1. THIS CONDUIT SHALL BE CONTINUOUS BETWEEN L-1 AND PB-12 FOR FUTURE USE.
4. 3" INTERCONNECT CONDUIT SHALL RUN BETWEEN PULL BOXES. ALL SWEEPS SHALL BE GRADUAL (157.5' MAX. BEND).

TRAFFIC SIGNAL SUBSUMMARY					
REF.	LOCATION		625	625	625
	FROM	TO	CONDUIT, 3", 725.051	PULL BOX, MISC.: 725.06, 17" x 30"	PULL BOX, MISC.: 725.06, 36" x 36"
	FT	EACH	EACH		
	10+13	10+38	30		
PB-1	10+38			1	
	10+38 LT	10+38 RT	66		
PB-2	10+38				1
	10+38	12+40	202		
PB-3	12+40			1	
	12+40	14+40	200		
PB-4	14+40			1	
	14+40	16+40	200		
PB-5	16+40			1	
	16+40	18+40	200		
PB-6	18+40			1	
	18+40	18+50	10		
TOTALS CARRIED TO GENERAL SUMMARY			908	5	1

LIGHTING SUBSUMMARY						
REF.	LOCATION		625	625	625	625
	FROM	TO	CONDUIT, 2", 725.051	PULL BOX, MISC.: 725.06, 13" x 24"	LIGHT POLE FOUNDATION, AS PER PLAN	GROUND ROD, AS PER PLAN
	FT	EACH	EACH	EACH	EACH	
PB-11	10+41			1		
	10+41	18+50	809			
	10+41 LT	10+41 RT	53			
PB-12	10+41			1		
	10+41	14+90	200			
L-1	14+90				1	1
	14+90	15+90	100			
L-2	15+90				1	1
	15+90	16+90	100			
L-3	16+90				1	1
	16+90	17+93	103			
L-4	17+93				1	1
	17+93	18+50	57			
TOTALS CARRIED TO GENERAL SUMMARY			1422	2	4	4

SIDEWALK AND STREETScape SUBSUMMARY													
REF.	LOCATION	LENGTH	WIDTH	AREA	203	204	304	638	608	608	SPEC	SPEC	
					EXCAVATION	SUBGRADE COMPACTION	AGGREGATE BASE	SEEDING AND MULCHING	5" CONCRETE WALK, AS PER PLAN	WALKWAY, MISC.: CONCRETE BASE	BRICK WALKWAY PAVERS	TREE FRAME AND GRATE	
	FROM	TO	FT	FT	SQ FT	CU YD	SQ YD	CU YD	SQ YD	SQ FT	SQ FT	SQ FT	EACH
	14+32	14+51.5	19.5	10	195	5.4	21.7	2.4	4.3	195			
	14+51.5	14+78.5	27	5.5	148.5	4.1	16.5	1.8	6	148.5			
	14+78.5	15+01.5	23	10	230	6.4	25.6	2.8	5.1	230			
	15+01.5	15+28.5	27	5.5	148.5	4.1	16.5	1.8	6	148.5			
	15+28.5	15+51.5	23	10	230	6.4	25.6	2.8	5.1	230			
	15+51.5	15+78.5	27	5.5	148.5	4.1	16.5	1.8	6	148.5			
	15+78.5	16+01.5	23	10	230	6.4	25.6	2.8	5.1	230			
	16+01.5	16+28.5	27	5.5	148.5	4.1	16.5	1.8	6	148.5			
	16+28.5	16+51.5	23	10	230	6.4	25.6	2.8	5.1	230			
	16+51.5	16+78.5	27	5.5	148.5	4.1	16.5	1.8	6	148.5			
	16+78.5	17+01.5	23	10	230	6.4	25.6	2.8	5.1	230			
	17+01.5	17+28.5	27	5.5	148.5	4.1	16.5	1.8	6	148.5			
	17+28.5	17+54.5	26	10	260	7.2	28.9	3.2	5.8	260			
	17+54.5	17+81.5	27	5.5	148.5	4.1	16.5	1.8	6	148.5			
	17+81.5	18+04.5	23	10	230	6.4	25.6	2.8	5.1	230			
	18+04.5	18+31.5	27	5.5	148.5	4.1	16.5	1.8	6	148.5			
	18+31.5	18+50	19.5	10	195	5.4	21.7	2.4	4.3	195			
SS-1	14+65					2.8	10	1.1			90	90	1
SS-2	15+15					2.8	10	1.1			90	90	1
SS-3	15+65					2.8	10	1.1			90	90	1
SS-4	16+15					2.8	10	1.1			90	90	1
SS-5	16+65					2.8	10	1.1			90	90	1
SS-6	17+15					2.8	10	1.1			90	90	1
SS-7	17+68					2.8	10	1.1			90	90	1
SS-8	18+18					2.8	10	1.1			90	90	1
TOTALS CARRIED TO GENERAL SUMMARY						112	438	48	93	3218	720	720	8

OFFICE OF THE CITY ENGINEER
CANTON, OHIO
DANIEL J. MOEGLIN, P.E., CITY ENGINEER
2436 30th STREET N.E. 44705 (330)488-3381

STREETSCAPE AND TRAFFIC CONDUIT
13TH STREET NW RECONSTRUCTION

DATE	BY	DESCRIPTION
3/26/19	NUL	

DRAWN BY: NUL
APPROVED BY:
FIELD BOOK:
FILE NAME: 13th St Streetscape 1

DATE: 3/26/19
H. SCALE:
V. SCALE:
SHEET 15 OF 18

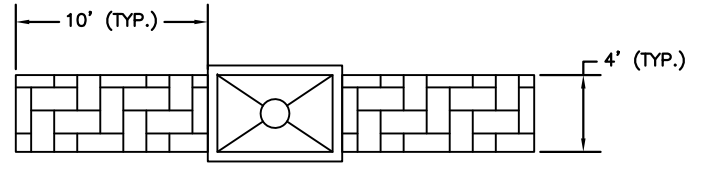
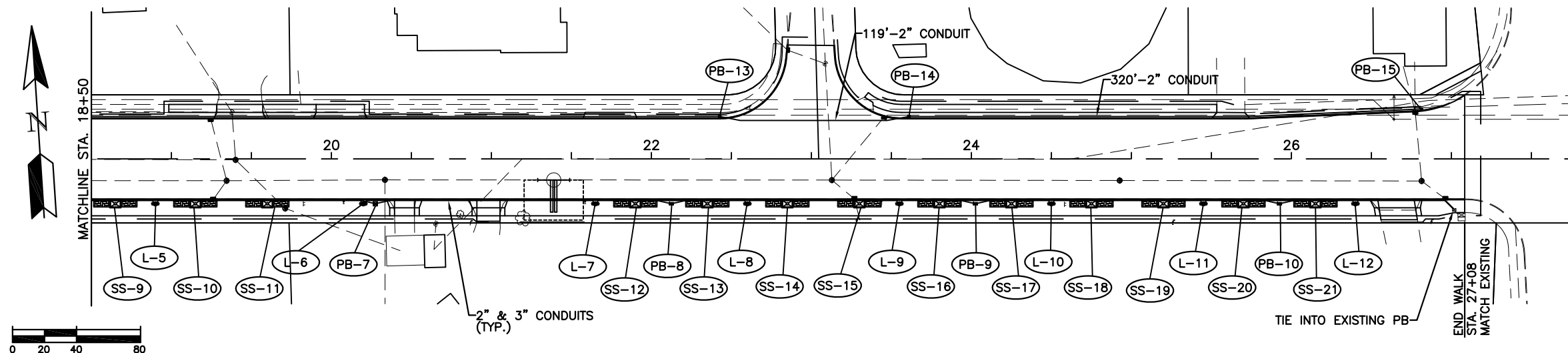

BRICK BOX AND TREE GRATE DETAIL
NOTE: SEE CITY OF CANTON STANDARD DRAWINGS 40-43 FOR ADDITIONAL DETAILS

- NOTES:
1. LONGITUDINAL CONDUITS SHALL BE PLACED DIRECTLY BEHIND THE CURB AND HAVE 12" MINIMUM OF COVER.
 2. 2" LIGHTING CONDUIT ON NORTH SIDE OF 13TH ST. SHALL BE CONTINUOUS BETWEEN PULL BOXES AND IS FOR FUTURE USE.
 3. 2" LIGHTING CONDUIT ON SOUTH SIDE OF 13TH ST. SHALL RUN BETWEEN LIGHT POLE FOUNDATIONS WITH THE EXCEPTION OF THE CONDUIT WEST OF L-1. THIS CONDUIT SHALL BE CONTINUOUS BETWEEN L-1 AND PB-12 FOR FUTURE USE.
 4. 3" INTERCONNECT CONDUIT SHALL RUN BETWEEN PULL BOXES. ALL SWEEPS SHALL BE GRADUAL (157.5' MAX. BEND).

TRAFFIC SIGNAL SUBSUMMARY					
REF.	LOCATION	625		625	
		CONDUIT, 3", 725.051	PULL BOX, MISC.: 725.06, 17" x 30"	PULL BOX, MISC.: 725.06, 36" x 36"	
		FROM	TO	FT	EACH
		18+50	20+27	177	
PB-7		20+27	22+12	185	1
PB-8		22+12	24+02	190	1
PB-9		24+02	25+92	190	1
PB-10		25+92	27+02	110	1
TOTALS CARRIED TO GENERAL SUMMARY				852	3

LIGHTING SUBSUMMARY							
REF.	LOCATION	625		625		625	
		CONDUIT, 2", 725.051	PULL BOX, MISC.: 725.06, 13" x 24"	LIGHT POLE FOUNDATION, AS PER PLAN	GROUND ROD, AS PER PLAN		
		FROM	TO	FT	EACH	EACH	EACH
PB-13		22+42	23+61	119	1		
PB-14		23+61	26+81	320	1		
PB-15		26+81	18+90	40			
L-5		18+90	20+20	130		1	1
L-6		20+20	21+65	145		1	1
L-7		21+65	22+60	95		1	1
L-8		22+60	23+55	95		1	1
L-9		23+55	24+50	95		1	1
L-10		24+50	25+45	95		1	1
L-11		25+45	26+40	95		1	1
L-12		26+40	27+02	62		1	1
TOTALS CARRIED TO GENERAL SUMMARY				1693	3	8	8

SIDEWALK AND STREETScape SUBSUMMARY													
REF.	LOCATION	LENGTH	WIDTH	AREA	EXCAVATION	SUBGRADE COMPACTION	AGGREGATE BASE	SEEDING AND MULCHING	5" CONCRETE WALK, AS PER PLAN	WALKWAY, MISC.: CONCRETE BASE	BRICK WALKWAY PAVERS	TREE FRAME AND GRATE	
													FROM
		18+50	18+51.5	1.5	10	15	0.4	1.7	0.2	0.3	15		
		18+51.5	18+78.5	27	5.5	148.5	4.1	16.5	1.8	6	148.5		
		18+78.5	19+01.5	23	10	230	6.4	25.6	2.8	5.1	230		
		19+01.5	19+28.5	27	5.5	148.5	4.1	16.5	1.8	6	148.5		
		19+28.5	19+46.5	18	10	180	5	20	2.2	4	180		
		19+46.5	19+73.5	27	5.5	148.5	4.1	16.5	1.8	6	148.5		
		19+73.5	21+76.5	203	10	2030	56.4	225.6	25.1	45.1	2030		
		21+76.5	22+03.5	27	5.5	148.5	4.1	16.5	1.8	6	148.5		
		22+03.5	22+21.5	18	10	180	5	20	2.2	4	180		
		22+21.5	22+48.5	27	5.5	148.5	4.1	16.5	1.8	6	148.5		
		22+48.5	22+71.5	23	10	230	6.4	25.6	2.8	5.1	230		
		22+71.5	22+98.5	27	5.5	148.5	4.1	16.5	1.8	6	148.5		
		22+98.5	23+16.5	18	10	180	5	20	2.2	4	180		
		23+16.5	23+43.5	27	5.5	148.5	4.1	16.5	1.8	6	148.5		
		23+43.5	23+66.5	23	10	230	6.4	25.6	2.8	5.1	230		
		23+66.5	23+93.5	27	5.5	148.5	4.1	16.5	1.8	6	148.5		
		23+93.5	24+11.5	18	10	180	5	20	2.2	4	180		
		24+11.5	24+38.5	27	5.5	148.5	4.1	16.5	1.8	6	148.5		
		24+38.5	24+61.5	23	10	230	6.4	25.6	2.8	5.1	230		
		24+61.5	24+88.5	27	5.5	148.5	4.1	16.5	1.8	6	148.5		
		24+88.5	25+06.5	18	10	180	5	20	2.2	4	180		
		25+06.5	25+33.5	27	5.5	148.5	4.1	16.5	1.8	6	148.5		
		25+33.5	25+56.5	23	10	230	6.4	25.6	2.8	5.1	230		
		25+56.5	25+83.5	27	5.5	148.5	4.1	16.5	1.8	6	148.5		
		25+83.5	26+01.5	18	10	180	5	20	2.2	4	180		
		26+01.5	26+28.5	27	5.5	148.5	4.1	16.5	1.8	6	148.5		
		26+28.5	27+02	73.5	10	735	20.4	81.7	9.1	16.3	735		
SS-9		18+65				2.8	10	1.1			90	90	1
SS-10		19+15				2.8	10	1.1			90	90	1
SS-11		19+60				2.8	10	1.1			90	90	1
SS-12		21+90				2.8	10	1.1			90	90	1
SS-13		22+35				2.8	10	1.1			90	90	1
SS-14		22+85				2.8	10	1.1			90	90	1
SS-15		23+30				2.8	10	1.1			90	90	1
SS-16		23+80				2.8	10	1.1			90	90	1
SS-17		24+25				2.8	10	1.1			90	90	1
SS-18		24+75				2.8	10	1.1			90	90	1
SS-19		25+20				2.8	10	1.1			90	90	1
SS-20		25+70				2.8	10	1.1			90	90	1
SS-21		26+15				2.8	10	1.1			90	90	1
TOTALS CARRIED TO GENERAL SUMMARY						230	902	98	189	6941	1170	1170	13

NOTES:

- CONTRACTOR SHALL PROVIDE TEMPORARY BYPASS PUMPING FOR THE EXISTING LIFT STATION DURING THE CONSTRUCTION OF THE PROPOSED FORCE MAIN. THE FLOW RATE TO THE EXISTING LIFT STATION IS A MAXIMUM OF 1400 GPM. THE BYPASS PIPING SHALL BE DIRECTED TO A MANHOLE LOCATED AT THE INTERSECTION OF LAKE ROAD BOULEVARD NW & COLUMBUS AVENUE NW (APPROXIMATELY 600' SOUTH OF EXISTING LIFT STATION) UNLESS OTHERWISE DIRECTED BY THE CITY OF CANTON. CONTRACTOR SHALL BE RESPONSIBLE TO PROVIDE REQUIRED TRAFFIC CONTROL DURING THE TEMPORARY BYPASS PUMPING. CONTRACTOR SHALL SUBMIT A BYPASS PUMPING PLAN TO THE CITY OF CANTON FOR APPROVAL BY THE CITY ENGINEER PRIOR TO BYPASS PUMP MOBILIZATION. CONTRACTOR SHALL ALSO SUBMIT A TRAFFIC CONTROL PLAN TO THE CITY OF CANTON FOR APPROVAL BY THE CANTON TRAFFIC ENGINEER OR CITY ENGINEER PRIOR TO BYPASS PUMPING MOBILIZATION.
- CONTRACTOR SHALL VERIFY ELEVATION OF EXISTING 12" WATER MAIN. IF A CONFLICT BETWEEN THE EXISTING 12" WATER MAIN & THE PROPOSED FORCE MAIN IS DISCOVERED, THE CONTRACTOR SHALL DEFLECT THE PROPOSED FORCE MAIN UNDER THE EXISTING 12" WATER MAIN MAINTAINING 18" OF VERTICAL SEPARATION.
- AFTER THE PROPOSED FORCE MAIN IS IN SERVICE, THE EXISTING FORCE MAIN SHALL BE CUT, CAPPED, FILLED WITH LOW STRENGTH MORTAR TYPE 1 AS PER O.D.O.T. 613.03 & ABANDONED IN PLACE, AS SHOWN.
- FORCE MAIN SHALL BE AWWA C151 DUCTILE IRON PIPE WITH CEMENT-LINING PER AWWA C104.
- FITTINGS SHALL USE RESTRAINED MECHANICAL JOINTS, MEGALUG OR APPROVED EQUAL.
- CONTRACTOR SHALL LOCATE THE EXACT LOCATION & ELEVATION OF THE EXISTING 10" FORCE MAIN PRIOR TO THE PROPOSED 10" FORCE MAIN BEING TIED-IN.
- CONTRACTOR SHALL CAREFULLY REMOVE THE EXISTING TOP FOR THE BRICK WALLED MANHOLE OVER THE EXISTING 4" PLUG VALVE TO BE REPLACED. THE TOP SHALL BE SET ASIDE THEN RE-INSTALLED ONCE CONSTRUCTION IS COMPLETED. ALL LABOR, MATERIAL, EQUIPMENT, BRICK WORK AND INCIDENTAL ITEMS NECESSARY TO REMOVE AND RE-INSTALL THE TOP OF THE MANHOLE SHALL BE INCIDENTAL TO ITEM 611 - CONDUIT, MISC.: 6" DEZURIK ECCENTRIC PLUG VALVE W/ H.D. VALVE BOX.
- CONTRACTOR SHALL USE EXTREME CAUTION TO AVOID THE EXISTING DUCT BANK LOCATED NEAR THE PROPOSED FORCE MAIN TIE-IN TO THE EXISTING FORCE MAIN.

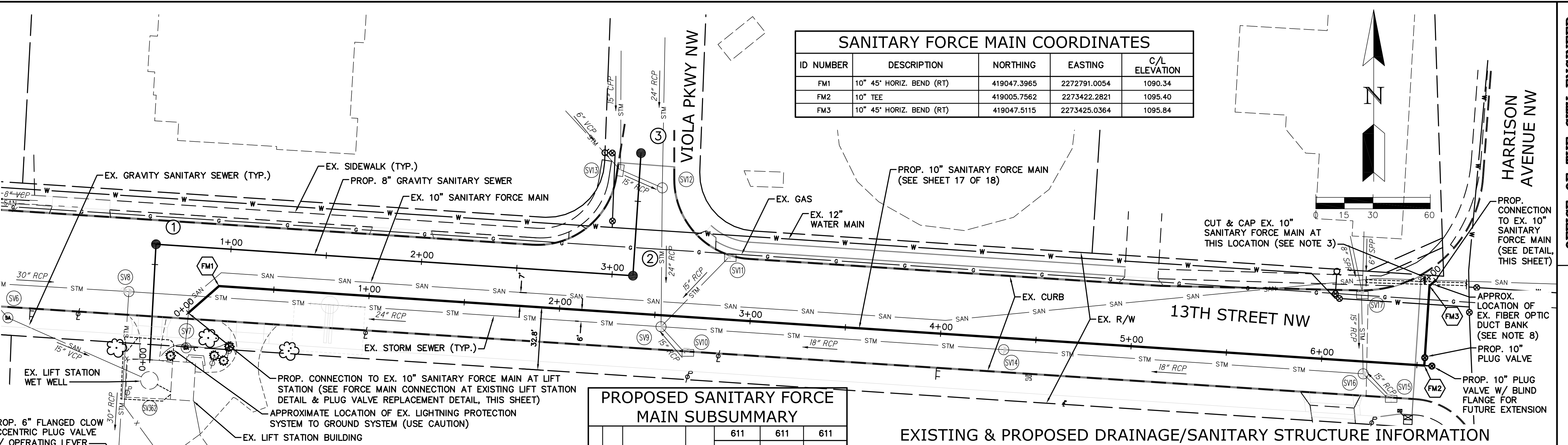

- CONTRACTOR SHALL VERIFY ELEVATION OF EXISTING 12" WATER MAIN. IF A CONFLICT BETWEEN THE EXISTING 12" WATER MAIN & THE PROPOSED FORCE MAIN IS DISCOVERED, THE CONTRACTOR SHALL DEFLECT THE PROPOSED FORCE MAIN UNDER THE EXISTING 12" WATER MAIN MAINTAINING 18" OF VERTICAL SEPARATION.
- AFTER THE PROPOSED FORCE MAIN IS IN SERVICE, THE EXISTING FORCE MAIN SHALL BE CUT, CAPPED, FILLED WITH LOW STRENGTH MORTAR TYPE 1 AS PER O.D.O.T. 613.03 & ABANDONED IN PLACE, AS SHOWN.
- FORCE MAIN SHALL BE AWWA C151 DUCTILE IRON PIPE WITH CEMENT-LINING PER AWWA C104.
- FITTINGS SHALL USE RESTRAINED MECHANICAL JOINTS, MEGALUG OR APPROVED EQUAL.
- CONTRACTOR SHALL LOCATE THE EXACT LOCATION & ELEVATION OF THE EXISTING 10" FORCE MAIN PRIOR TO THE PROPOSED 10" FORCE MAIN BEING TIED-IN.
- CONTRACTOR SHALL CAREFULLY REMOVE THE EXISTING TOP FOR THE BRICK WALLED MANHOLE OVER THE EXISTING 4" PLUG VALVE TO BE REPLACED. THE TOP SHALL BE SET ASIDE THEN RE-INSTALLED ONCE CONSTRUCTION IS COMPLETED. ALL LABOR, MATERIAL, EQUIPMENT, BRICK WORK AND INCIDENTAL ITEMS NECESSARY TO REMOVE AND RE-INSTALL THE TOP OF THE MANHOLE SHALL BE INCIDENTAL TO ITEM 611 - CONDUIT, MISC.: 6" DEZURIK ECCENTRIC PLUG VALVE W/ H.D. VALVE BOX.
- CONTRACTOR SHALL USE EXTREME CAUTION TO AVOID THE EXISTING DUCT BANK LOCATED NEAR THE PROPOSED FORCE MAIN TIE-IN TO THE EXISTING FORCE MAIN.

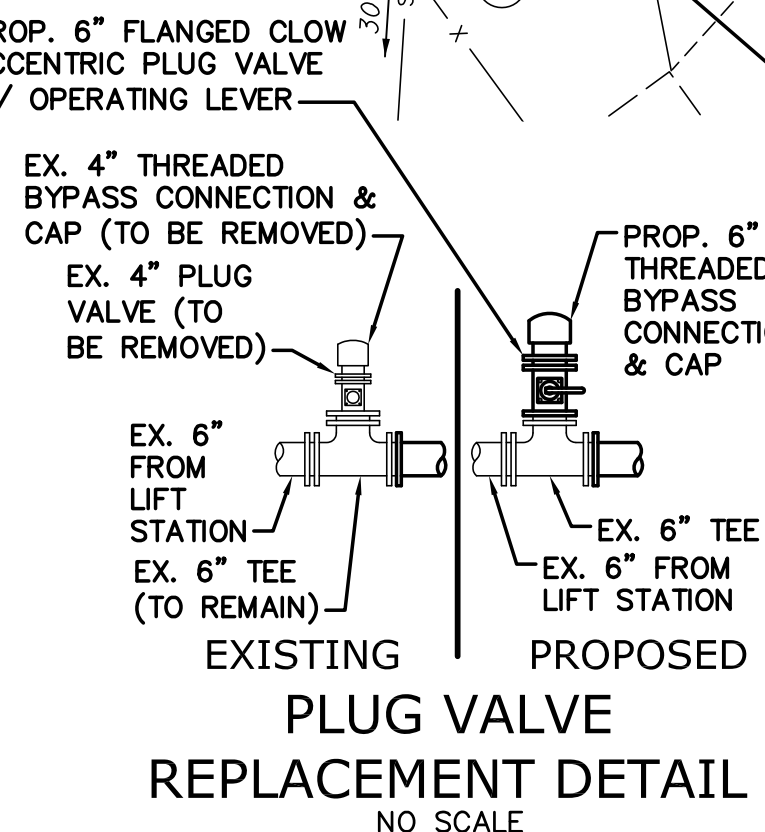

SEQUENCE OF CONSTRUCTION:

- CONSTRUCT PROPOSED 10" FORCE MAIN.
- INSTALL BYPASS PIPING.
- PRESSURE TEST THE PROPOSED FORCE MAIN.
- CCTV PROPOSED FORCE MAIN.
- CONNECT 45° ELBOW TO EXISTING LIFT STATION DISCHARGE PIPING.
- CONNECT 45° ELBOW TO EXISTING FORCE MAIN, AS SHOWN.
- PUT FORCE MAIN INTO SERVICE.
- CUT, CAP & ABANDONED EXISTING FORCE MAIN IN PLACE.
- REMOVE TEMPORARY BYPASS PUMPING SYSTEM.

PROPOSED SANITARY FORCE MAIN SUBSUMMARY

REF. NO.	SHEET NO.	STATION	SIDE	611			
				FT	EACH	EACH	
1	17	0+00	7+00	N/A	700		
2	17	0+01	N/A			1	
3	17	0+05	N/A			1	
4	17	0+54, 4' RT.	N/A			1	
5	17	0+59	N/A			1	
TOTALS CARRIED TO GENERAL SUMMARY					700	3	1

EXISTING & PROPOSED DRAINAGE/SANITARY STRUCTURE INFORMATION

SV2 EX. STM C; RIM ELEV=1093.48 EX. 6" VCP NW=1090.48 EX. 15" RCP SE=1089.13	SV10 EX. STM C; RIM ELEV=1097.91 EX. 15" RCP NW=1093.31	SV15 EX. STM C; RIM ELEV=1102.93 EX. 15" RCP NW=1098.58	1 PROP. SAN MH; RIM ELEV=1094.60 PROP. 8" PVC S=1084.00 PROP. 8" PVC E=1085.90
SV4 EX. STM MH; RIM ELEV=1093.61 EX. 15" RCP SW=1088.61 EX. 15" RCP NW=1088.41 EX. 30" RCP E=1087.31 EX. 30" RCP W=1087.31	SV11 EX. STM C; RIM ELEV=1098.20 EX. 15" RCP SW=1093.60	SV16 EX. STM MH; RIM ELEV=1102.99 EX. 18" RCP W=1096.59 EX. 15" RCP N=1097.19 EX. 15" RCP SE=1097.19	2 PROP. SAN MH; RIM ELEV=1097.20 PROP. 8" PVC W=1088.23 PROP. 8" PVC N=1088.33
SV8 EX. STM MH; RIM ELEV=1094.42 EX. 30" RCP S=1085.92 EX. 30" RCP W=1086.42 EX. 24" RCP E=1086.02	SV12 EX. STM MH; RIM ELEV=1099.98 EX. 15" RCP NW=1094.53 EX. 24" RCP S=1093.68 EX. 24" RCP N=1093.98	SV17 EX. STM C; RIM ELEV=1102.46 EX. 15" RCP S=1099.66 EX. 8" SPP N=1101.46 EX. 6" SPP N=1101.36	3 PROP. SAN MH; RIM ELEV=1101.00 PROP. 8" PVC S=1088.59
SV9 EX. STM MH; RIM ELEV=1098.07 EX. 24" RCP N=1093.17 EX. 24" RCP W=1090.92 EX. 15" RCP NE=1092.87 EX. 18" RCP =1091.02 EX. 15" RCP SE=1092.57	SV13 EX. STM C; RIM ELEV=1100.33 EX. 15" RCP NW=1097.43 EX. 6" VCP NW=1097.83 EX. 15" RCP SE=1094.88	SV6 EX. SAN MH; RIM ELEV=1094.28 EX. 15" VCP NW=1084.08 EX. 15" VCP SE=1083.98	
	SV14 EX. STM MH; RIM ELEV=1100.46 EX. 18" RCP W=1093.66 EX. 18" RCP E=1096.76	SV362 EX. SAN WW; RIM ELEV=1092.48 EX. 15" VCP NW=1082.08	

