

GENERAL NOTES:

1. CONTRACTOR TO FIELD VERIFY ALL MEASUREMENTS.
2. CONTRACTOR TO PROVIDE SHOP DRAWINGS FOR DISTRICT REVIEW PRIOR TO CONSTRUCTION OF CASEWORK.
3. OWNER FURNISHED BACKPACK STORAGE UNITS:

(2) JONTI-CRAFT MODEL #3196JC  
35.5"(H) X 43.5" (W) X 15" (D)

(2) JONTI-CRAFT MODEL #0340JC  
35.5"(H) X 57.5" (W) X 15" (D)

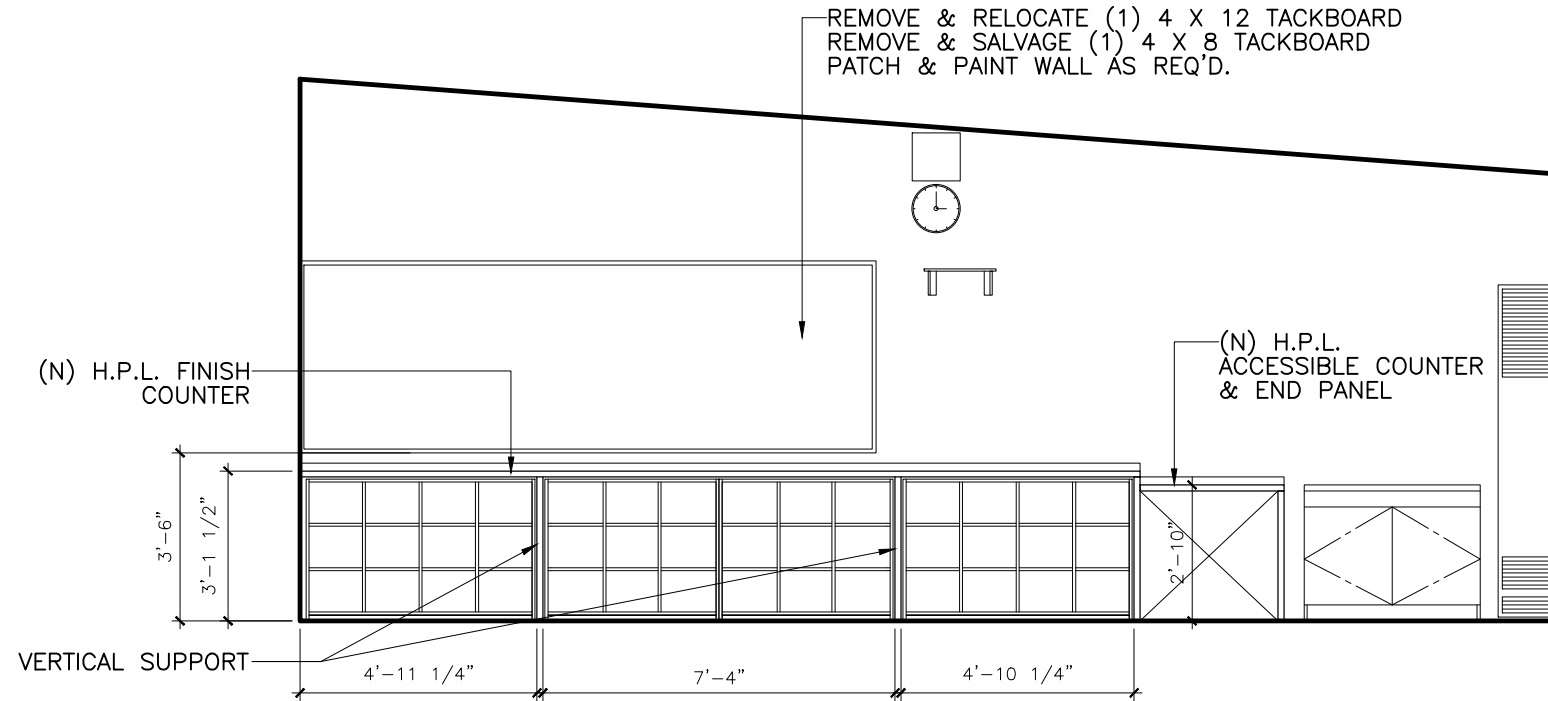

**2** **OPTION 2 - ELEVATION**  
SCALE: 1/4"=1'-0"

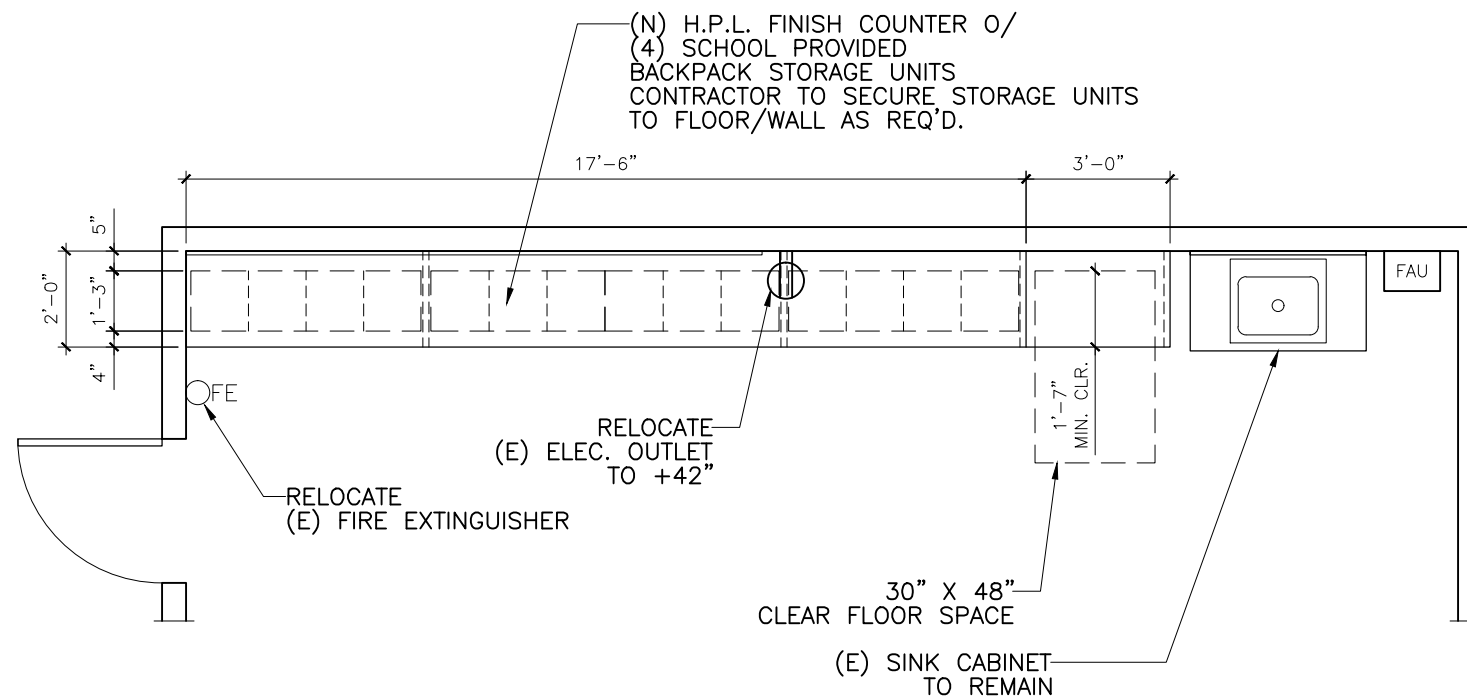

**1** **OPTION 2 - PARTIAL PLAN**  
SCALE: 1/4"=1'-0"

**RICHARDSON MIDDLE SCHOOL**  
**ROOM 19 - BACKPACK STORAGE**  
**OPTION 2: OWNER PROVIDED CUBBIES**

Project	RMS_021419 REV-1
Date	02/21/19
Scale	AS NOTED
Sheet No.	A2