

Source: Escambia County Property Appraiser

[Restore Full Version](#)

General Information Reference: 092S300550000017 Account: 052200134 Owners: STALLWORTH ANGELINA Mail: 803 MASSACHUSETTS AVE PENSACOLA, FL 32505 Situs: 803 MASSACHUSETTS AVE 32505 Use Code: SINGLE FAMILY - TOWNHOME Taxing Authority: COUNTY MSTU Tax Inquiry: Open Tax Inquiry Window Tax Inquiry link courtesy of Scott Lunsford Escambia County Tax Collector	Assessments <table border="1"> <thead> <tr> <th>Year</th> <th>Land</th> <th>Imprv</th> <th>Total</th> <th>Cap Val</th> </tr> </thead> <tbody> <tr> <td>2018</td> <td>\$2,000</td> <td>\$8,240</td> <td>\$10,240</td> <td>\$10,240</td> </tr> <tr> <td>2017</td> <td>\$2,000</td> <td>\$10,000</td> <td>\$12,000</td> <td>\$11,859</td> </tr> <tr> <td>2016</td> <td>\$2,000</td> <td>\$9,616</td> <td>\$11,616</td> <td>\$11,616</td> </tr> </tbody> </table> <p align="center">Disclaimer</p> <p align="center">Tax Estimator</p> <p align="center">> File for New Homestead Exemption Online</p>	Year	Land	Imprv	Total	Cap Val	2018	\$2,000	\$8,240	\$10,240	\$10,240	2017	\$2,000	\$10,000	\$12,000	\$11,859	2016	\$2,000	\$9,616	\$11,616	\$11,616																												
Year	Land	Imprv	Total	Cap Val																																													
2018	\$2,000	\$8,240	\$10,240	\$10,240																																													
2017	\$2,000	\$10,000	\$12,000	\$11,859																																													
2016	\$2,000	\$9,616	\$11,616	\$11,616																																													
Sales Data <table border="1"> <thead> <tr> <th>Sale Date</th> <th>Book</th> <th>Page</th> <th>Value</th> <th>Type</th> <th>Official Records (New Window)</th> </tr> </thead> <tbody> <tr> <td>11/19/2015</td> <td>7439</td> <td>28</td> <td>\$100</td> <td>CJ</td> <td>View Instr</td> </tr> <tr> <td>10/28/2015</td> <td>7454</td> <td>872</td> <td>\$100</td> <td>WD</td> <td>View Instr</td> </tr> <tr> <td>10/28/2015</td> <td>7446</td> <td>776</td> <td>\$100</td> <td>WD</td> <td>View Instr</td> </tr> <tr> <td>04/13/2015</td> <td>7330</td> <td>1223</td> <td>\$100</td> <td>WD</td> <td>View Instr</td> </tr> <tr> <td>04/13/2015</td> <td>7330</td> <td>1222</td> <td>\$10,000</td> <td>QC</td> <td>View Instr</td> </tr> <tr> <td>11/17/2011</td> <td>6791</td> <td>92</td> <td>\$100</td> <td>CJ</td> <td>View Instr</td> </tr> <tr> <td>01/1971</td> <td>564</td> <td>9</td> <td>\$18,000</td> <td>WD</td> <td>View Instr</td> </tr> </tbody> </table> <p>Official Records Inquiry courtesy of Pam Childers Escambia County Clerk of the Circuit Court and Comptroller</p>	Sale Date	Book	Page	Value	Type	Official Records (New Window)	11/19/2015	7439	28	\$100	CJ	View Instr	10/28/2015	7454	872	\$100	WD	View Instr	10/28/2015	7446	776	\$100	WD	View Instr	04/13/2015	7330	1223	\$100	WD	View Instr	04/13/2015	7330	1222	\$10,000	QC	View Instr	11/17/2011	6791	92	\$100	CJ	View Instr	01/1971	564	9	\$18,000	WD	View Instr	2018 Certified Roll Exemptions HOMESTEAD EXEMPTION Legal Description LT 17 VALENCIA ARMS PB 7 P 99 OR 7330 P 1223 OR 7446 P 776 OR 7454 P 872 Extra Features None
Sale Date	Book	Page	Value	Type	Official Records (New Window)																																												
11/19/2015	7439	28	\$100	CJ	View Instr																																												
10/28/2015	7454	872	\$100	WD	View Instr																																												
10/28/2015	7446	776	\$100	WD	View Instr																																												
04/13/2015	7330	1223	\$100	WD	View Instr																																												
04/13/2015	7330	1222	\$10,000	QC	View Instr																																												
11/17/2011	6791	92	\$100	CJ	View Instr																																												
01/1971	564	9	\$18,000	WD	View Instr																																												

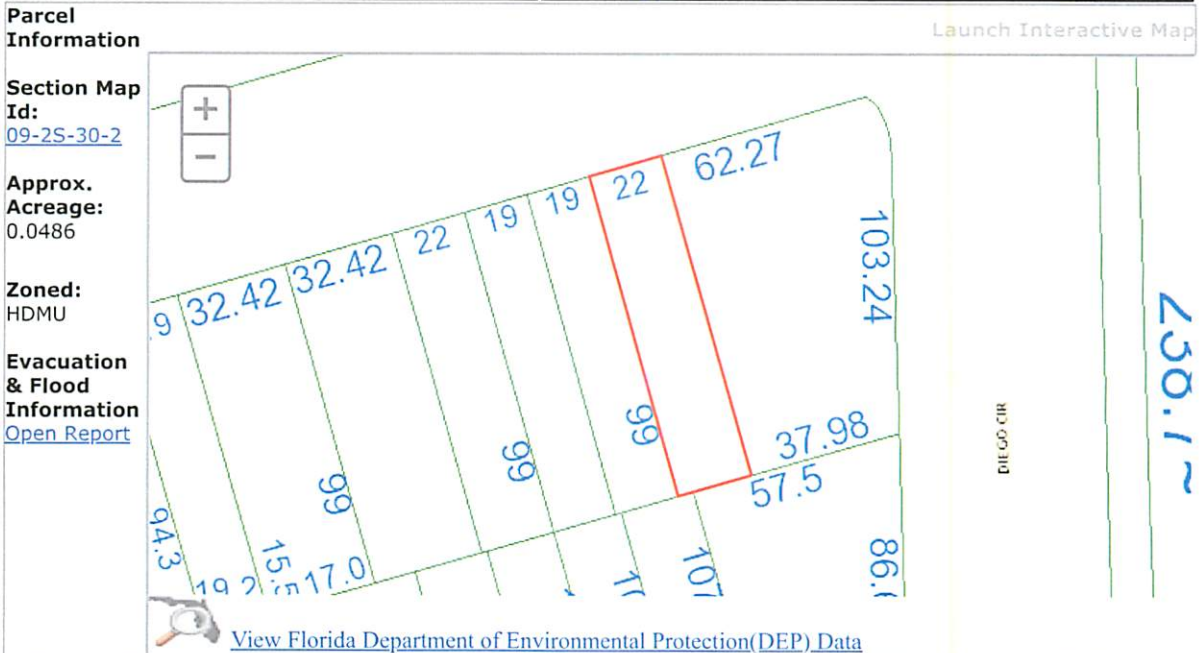

Buildings

Address:803 MASSACHUSETTS AVE, Year Built: 1971, Effective Year: 1971

Structural Elements

DECOR/MILLWORK-AVERAGE

DWELLING UNITS-1

EXTERIOR WALL-BRICK-FACE/VENEER

EXTERIOR WALL-SIDING-SHT.AVG.

FLOOR COVER-CARPET

FOUNDATION-SLAB ON GRADE

HEAT/AIR-CENTRAL H/AC

INTERIOR WALL-DRYWALL-PLASTER

NO. PLUMBING FIXTURES-5

NO. STORIES-2

ROOF COVER-COMPOSITION SHG

ROOF FRAMING-IRR. ROOF DESGN

STORY HEIGHT-0

STRUCTURAL FRAME-WOOD FRAME

Areas - 1452 Total SF

BASE AREA - 626

OPEN PORCH FIN - 12

PATIO - 78

UPPER STORY FIN - 682

UTILITY UNF - 54

Diagram illustrating the layout of the building, showing two main areas: BAS (Basement) and USF (Upper Story Finish). The BAS area is a large rectangle with dimensions 29 by 15, containing sub-areas UTU (6 by 9) and PTO (6 by 13). The USF area is a rectangle with dimensions 31 by 22. A small area labeled OFF (4 by 3) is located between the two main areas. The total area is 1452 SF.

Images

None

The primary use of the assessment data is for the preparation of the current year tax roll. No responsibility or liability is assumed for inaccuracies or errors.