

REFERENCE NOTES

- ① 400A MAIN, 120/208V, 3 PHASE, 4 WIRE.
- ② POWER PULL BOX.
- ③ MAIN TRANSFORMER, SCE #P5517405.
- ④ 2 WALL MOUNTED COMMUNICATION BOXES (ONE LOW LEVEL, OTHER AT CANOPY HEIGHT).
- ⑤ CAMPUS MAIN SWITCHGEAR.
- ⑥ WALL MOUNTED POWER PULL BOX.
- ⑦ LOCATION OF (4) COMMUNICATION CONDUITS STUBBED UP FROM BELOW GRADE TO TOP OF CANOPY. CONTRACTOR TO VERIFY IN FIELD DATA DISTRIBUTION CONDUIT.
- ⑧ WALL MOUNTED DATA PULLBOX.
- ⑨ UNDERGROUND POWER CONDUIT.
- ⑩ UNDERGROUND DATA CONDUIT.
- ⑪ PORTABLE POWER PANEL.
- ⑫ OUTDOOR POWER PANELS FOR EXTERIOR USE.

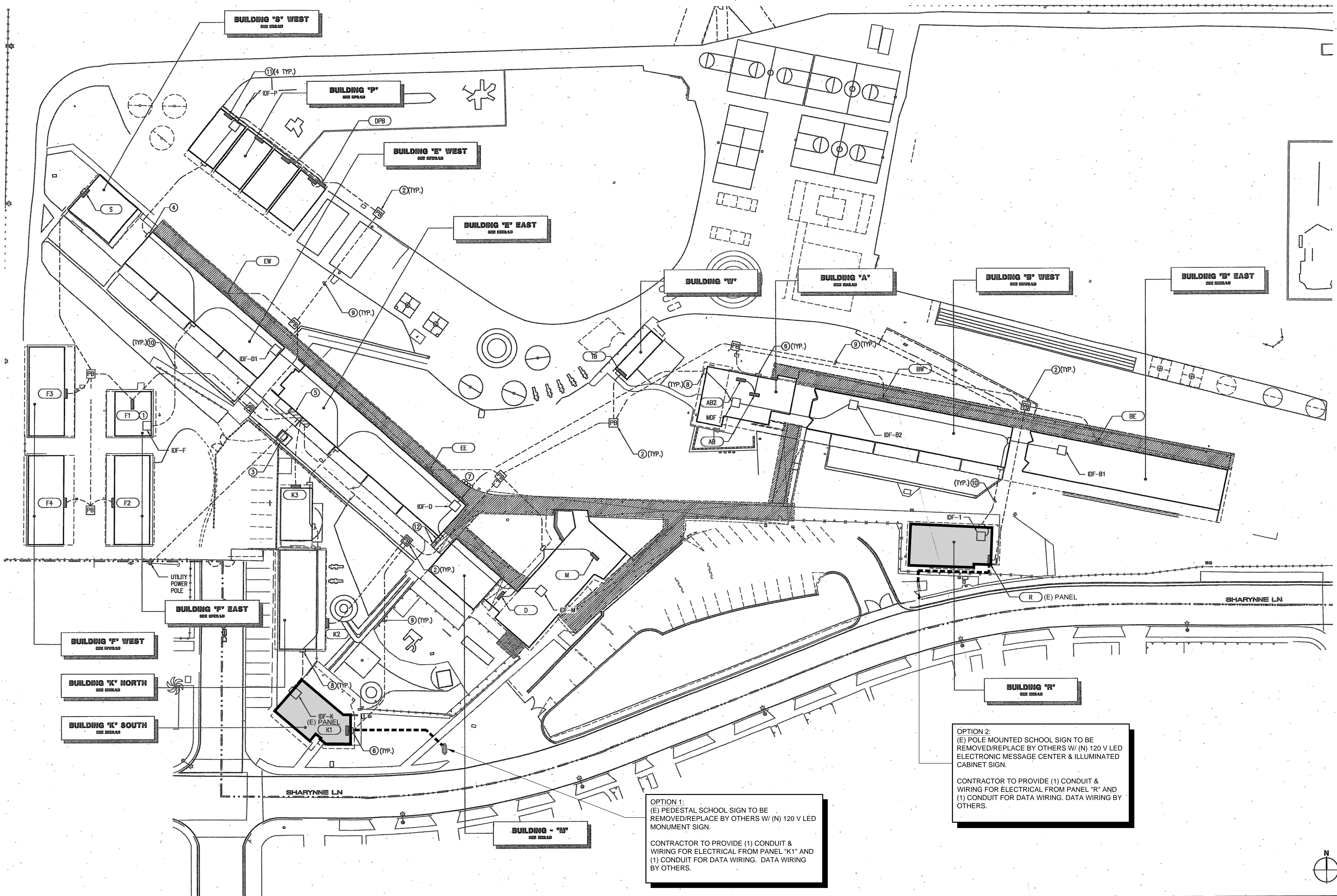

OPTION 1:
(E) PEDESTAL SCHOOL SIGN TO BE REMOVED/REPLACE BY OTHERS W/ (N) 120 V LED MONUMENT SIGN.
CONTRACTOR TO PROVIDE (1) CONDUIT & WIRING FOR ELECTRICAL FROM PANEL "K1" AND (1) CONDUIT FOR DATA WIRING. DATA WIRING BY OTHERS.

OPTION 2:
(E) POLE MOUNTED SCHOOL SIGN TO BE REMOVED/REPLACE BY OTHERS W/ (N) 120 V LED ELECTRONIC MESSAGE CENTER & ILLUMINATED CABINET SIGN.
CONTRACTOR TO PROVIDE (1) CONDUIT & WIRING FOR ELECTRICAL FROM PANEL "R" AND (1) CONDUIT FOR DATA WIRING. DATA WIRING BY OTHERS.

Consultant

Key Plan

Agency Approval

FILE NO. F-19-120
IDENTIFICATION STAMP
DIV. OF THE STATE ARCHITECT
OFFICE OF REGULATION SERVICES
APPL. 03-113463
AC: FLS SD SS
DATE: MAR 3 0 2011

Project Title:

SEASIDE ELEMENTARY SCHOOL MODERNIZATION
4651 SHARYNNE LANE
TORRANCE, CA 90505

No.	Description	Date	No.	Description	Date

Drawing Title:
ELECTRICAL EXISTING SITE POWER & DATA DISTRIBUTION PLAN

Architect's Seal:

Designed: RR/CK	Project No. 153-09-011
Drawn: CAD	Scale: 1" = 30'
QC/DC: DM/MB	Drawing No. E1.0
Date: MARCH 24, 2011	