



ECS Carolinas, LLP

Report of Limited Asbestos Survey

2678 Olympia Avenue
North Charleston, South Carolina
ECS Project Number 49-2970

September 30, 2016



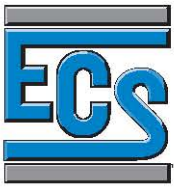

September 30, 2016

Ms. Angela McJunkin, CCEA, CFM
Director of Code Enforcement
City of North Charleston
PO Box 190016
North Charleston, SC 29419

Reference: Report of Limited Asbestos Survey
2678 Olympia Avenue
North Charleston, South Carolina
ECS Project Number: 49-2970

Dear Ms. McJunkin:

ECS Carolinas, LLP (ECS) is pleased to submit this report of our limited asbestos survey at the above referenced site. This report includes a description of our understanding of the project background information, a description of the scope of work performed, including our findings, conclusions and comments.

PROJECT UNDERSTANDING

ECS understands the subject site is located at 2678 Olympia Avenue in North Charleston, Charleston County, South Carolina. The site is further identified as Charleston County Parcel Identification Number (PIN) 4111200197. The site is developed with an approximate 1,136 square-foot single family residence reportedly constructed in 1943. The residence is slated for demolition. ECS was requested to conduct a limited asbestos survey of the interior and exterior portions of the residence prior to demolition activities.

PROCEDURE/METHODOLOGY

Limited Asbestos Containing Materials (ACM) Assessment

ECS was requested to perform a limited asbestos survey of the subject property to identify asbestos-containing materials (ACM) which could be disturbed during demolition or renovation. The National Emission Standard for Hazardous Air Pollutants (NESHAP) requires the identification of friable ACM and non-friable ACM likely to become friable during demolition and/or renovation activities. NESHAP requires that the identified ACM be removed prior to initiating activities likely to disturb the ACM. The EPA defines an ACM as a material containing more than one percent (>1%) asbestos.

The limited asbestos survey was performed on September 13, 2016 by Mr. Justin Roth (South Carolina Asbestos Inspector No. BI-01189). The survey consisted of observing the accessible areas of the building for the presence of suspect materials which may contain asbestos. The survey involved detecting both friable materials (materials which can be pulverized or reduced to a powder by hand pressure when dry) and non-friable materials (materials which pose a hazard when sawn, sanded, drilled or pulverized). Homogeneous materials (based on material type, color, texture, etc.) were identified in various functional spaces during the survey.

As per the South Carolina Department of Health and Environmental Control (SCDHEC), samples were collected from random locations of each homogeneous area, with the material's number of samples based upon the following criteria:

- Thermal Insulation Materials (piping, breeching, boiler insulation, etc.) – A minimum of three (3) samples are required. Patch areas (less than 6 square or linear feet) may have one (1) sample collected.
- Surfacing Materials (plaster, fireproofing, etc.) – A minimum of seven (7) samples are to be taken for areas greater than 5,000 square feet; five (5) for areas greater than 1,000 square feet, but less than 5,000 square feet; three (3) for areas less than 1,000 square feet.
- Miscellaneous Materials (flooring, adhesives, roofing, wallboard, etc.) – A minimum of three (3) samples are required.

In order to determine if the suspect materials observed during the visual survey contained asbestos, representative bulk samples were collected and placed in sealed packages. Samples were placed under chain of custody and submitted to Scientific Analytical Institute, Inc. (SAI) in Greensboro, North Carolina for analysis under standard chain of custody procedures. The analysis was performed using the EPA recommended method of Polarized Light Microscopy (PLM) coupled with dispersion staining (Method No. EPA 600/M4-020-82, Dec. 1982). SAI participates in the National Voluntary Laboratory Accreditation Program (NVLAP). Their NVLAP accreditation number is 200664-0. Samples determined to be negative by PLM but were classified as non-friable organically bound (NOB) materials were reanalyzed by transmission electron microscopy (TEM) using the Chatfield method in accordance with SCDHEC requirements. If a sample of a material from a homogeneous area is found to be positive, then that material is considered positive, regardless of the results of the other samples of that material, within that area. The material type, sample location and analytical results of each bulk sample are also summarized in the attached Asbestos Bulk Analysis report in **Attachments**.

RESULTS

The analytical data indicated that asbestos was detected in the samples obtained by ECS. Some samples are considered multi-layered. These samples were comprised of more than one material, and each one is analyzed separately as per NESHAP requirements. The following table summarizes the samples collected during ECS' site visit and the laboratory analysis data.

SUMMARY OF ASBESTOS-CONTAINING MATERIALS 2678 Olympia Avenue North Charleston, South Carolina ECS Project 49-2970						
Sample #	Materials	Sample Location	Approx. Quantity	Condition/ Friable or Non-Friable	Lab	Asbestos %
2678-1A 2678-1B 2678-1C	Drywall	Interior Walls/ Ceilings	2,000 SF	Good/ Friable	PLM PLM PLM	None Detected None Detected None Detected
2678-2A 2678-2B 2678-2C 2678-2D 2678-2E	Joint Compound	Interior Walls/	2,000 SF	Good/ Friable	PLM PLM PLM PLM PLM	None Detected None Detected None Detected None Detected None Detected
2678-3A-A 2678-3B-A 2678-3C-A 2678-3D-A 2678-3E-A	Plaster - Finish Coat	Hallway Walls	1,000 SF	Fair/ Friable	PLM PLM PLM PLM PLM	None Detected None Detected None Detected None Detected None Detected

SUMMARY OF ASBESTOS-CONTAINING MATERIALS 2678 Olympia Avenue North Charleston, South Carolina ECS Project 49-2970						
Sample #	Materials	Sample Location	Approx. Quantity	Condition/ Friable or Non-Friable	Lab	Asbestos %
2678-3A-B 2678-3B-B 2678-3C-B 2678-3D-B 2678-3E-B	Plaster - Base Coat	Hallway Walls	1,000 SF	Fair/ Friable	PLM PLM PLM PLM PLM	None Detected None Detected None Detected None Detected None Detected
2678-4A-A 2678-4B-A 2678-4C-A	Linoleum Only	Kitchen	400 SF	Good/Non-Friable	PLM PLM TEM	None Detected None Detected None Detected
2678-4C-B	Linoleum Mastic	Kitchen	400 SF	Good/Non-Friable	TEM	None Detected
2678-5A-A 2678-5B-A 2678-5C-A	Linoleum - Layer 1	Bedroom	200 SF	Good/Non-Friable	PLM PLM TEM	None Detected None Detected None Detected
2678-5A-B 2678-5B-B 2678-5C-B	Linoleum - Mastic 1	Bedroom	200 SF	Good/Non-Friable	PLM PLM TEM	None Detected None Detected None Detected
2678-5A-C 2678-5B-C 2678-5C-C	Linoleum - Layer 2	Bedroom	200 SF	Good/Non-Friable	PLM PLM TEM	None Detected None Detected None Detected
2678-5A-D 2678-5B-D 2678-5C-D	Linoleum - Mastic 2	Bedroom	200 SF	Good/Non-Friable	PLM PLM TEM	None Detected None Detected None Detected
2678-6A 2678-6B 2678-6C	Cement Board	Exterior Siding	3,000 SF	Good/Non-Friable	PLM PLM PLM	20% Chrysotile Positive Stop Positive Stop
2678-7A 2678-7B 2678-7C	Felt Paper	Behind Siding	3,000 SF	Good/Non-Friable	PLM PLM TEM	None Detected None Detected None Detected
2678-8A 2678-8B 2678-8C	Gypsum Board	Exterior Wall	3,000 SF	Good/Non-Friable	PLM PLM PLM	None Detected None Detected None Detected
2678-9A-A 2678-9B-A 2678-9C-A	Asphalt Shingles	Roof	1,200 SF	Fair/Non-Friable	PLM PLM TEM	None Detected None Detected None Detected
2678-9A-B 2678-9B-B 2678-9C-B	Felt Paper	Roof	1,200 SF	Good/Non-Friable	PLM PLM TEM	None Detected None Detected None Detected
2678-10A 2678-10B	Window Caulking	Exterior	200 LF	Poor/Non-Friable	PLM PLM	6% Chrysotile Positive Stop

SUMMARY OF ASBESTOS-CONTAINING MATERIALS 2678 Olympia Avenue North Charleston, South Carolina ECS Project 49-2970						
Sample #	Materials	Sample Location	Approx. Quantity	Condition/ Friable or Non-Friable	Lab	Asbestos %
2678-10C					PLM	Positive Stop
2678-11A 2678-11B 2678-11C	Linoleum	Bedroom	200 SF	Good/Non-Friable	PLM PLM TEM	None Detected None Detected None Detected
2678-12A-A 2678-12B-A 2678-12C-A	Linoleum - Layer 1	Bathroom	80 SF	Good/Non-Friable	PLM PLM TEM	None Detected None Detected None Detected
2678-12A-A 2678-12B-A 2678-12C-A	Linoleum - Layer 2	Bathroom	80 SF	Good/Non-Friable	PLM PLM TEM	None Detected None Detected None Detected
2678-12A-B 2678-12B-B 2678-12C-B	Linoleum Mastic	Bathroom	80 SF	Good/Non-Friable	PLM PLM TEM	None Detected None Detected None Detected
2678-13A-A 2678-13B-A 2678-13C-A	Linoleum - Layer 1	Entrance to Kitchen	5 SF	Good/Non-Friable	PLM PLM TEM	None Detected None Detected None Detected
2678-13A-B 2678-13B-B 2678-13C-B	Linoleum - Mastic	Entrance to Kitchen	5 SF	Good/Non-Friable	PLM PLM TEM	None Detected None Detected None Detected
2678-13A-C 2678-13B-C 2678-13C-C	Linoleum - Layer 2	Entrance to Kitchen	5 SF	Good/Non-Friable	PLM PLM TEM	None Detected None Detected None Detected
2678-14A 2678-14B 2678-14C	Black Tar	Roof Chimney	8 LF	Poor/Non-Friable	PLM PLM PLM	8% Chrysotile Positive Stop Positive Stop

Bold = Asbestos-Containing Material

SF = Square Feet

LF = Linear Feet

CONCLUSIONS AND RECOMMENDATIONS

Based on the findings from laboratory analysis, asbestos concentrations in excess of EPA and State levels were identified in the exterior cement board siding, window caulking, and the black tar around the chimney on the roof. ECS estimates approximately 3,000 square feet of siding, 200 linear feet of window caulk, and 8 linear feet of black tar.

ECS recommends the following pertaining to the ACM identified at the residence:

1. Abate the asbestos containing materials in the structure prior to disturbance for demolition or renovation. Notification to the SCDHEC is required for demolitions and renovations including moving a facility off-site and/or the intentional burning of a facility within the state of South Carolina. Notification is required for facilities which do not contain asbestos as well. The starting date for

demolition or renovation must be at least 10 working days from the date of submission of a complete application to SCDHEC.

2. Follow OSHA asbestos regulations during renovation/demolition of the structures. You should be aware that stringent requirements are imposed upon anyone renovating or demolishing a structure in which ACM will be disturbed. This work must be performed in accordance with OSHA asbestos regulations, 29 CFR 1910 & 1926, and NESHAP asbestos regulations 40 CFR 61, subpart M.
3. Conduct a visual assessment and air monitoring as required following abatement to document that ACM has been removed. A licensed air monitor may be required depending on the type of abatement.

This report summarizes our evaluation of the conditions observed at the site. The findings prepared by ECS are based upon testing performed in the buildings. Our recommendations are based on the guidelines presented in EPA, SCDHEC, and/or OSHA asbestos regulations. ACM may exist (undetected) in other areas due to their inaccessibility or due to the limited nature of our testing. The assessment did not include destructive measures to look in chases, above fixed ceilings, behind permanent or attached fixtures, behind walls, etc. Suspect materials observed in inaccessible areas will have to be assumed positive or be evaluated at the time of discovery.

ECS appreciates the opportunity to provide our asbestos services for this project. If you have questions or need additional information, please contact us.

Respectfully,

ECS CAROLINAS, LLP



Braxton B. Dawson
Environmental Scientist
bdawson@ecslimited.com
(910) 686-9114



Lindsey B. Lucas, REM
Environmental Principal
llucas1@ecslimited.com
864-987-1810

Attachments: Figure
Photographs
Laboratory Bulk Asbestos Analysis & Chain of Custody
SC Asbestos Building Inspector License

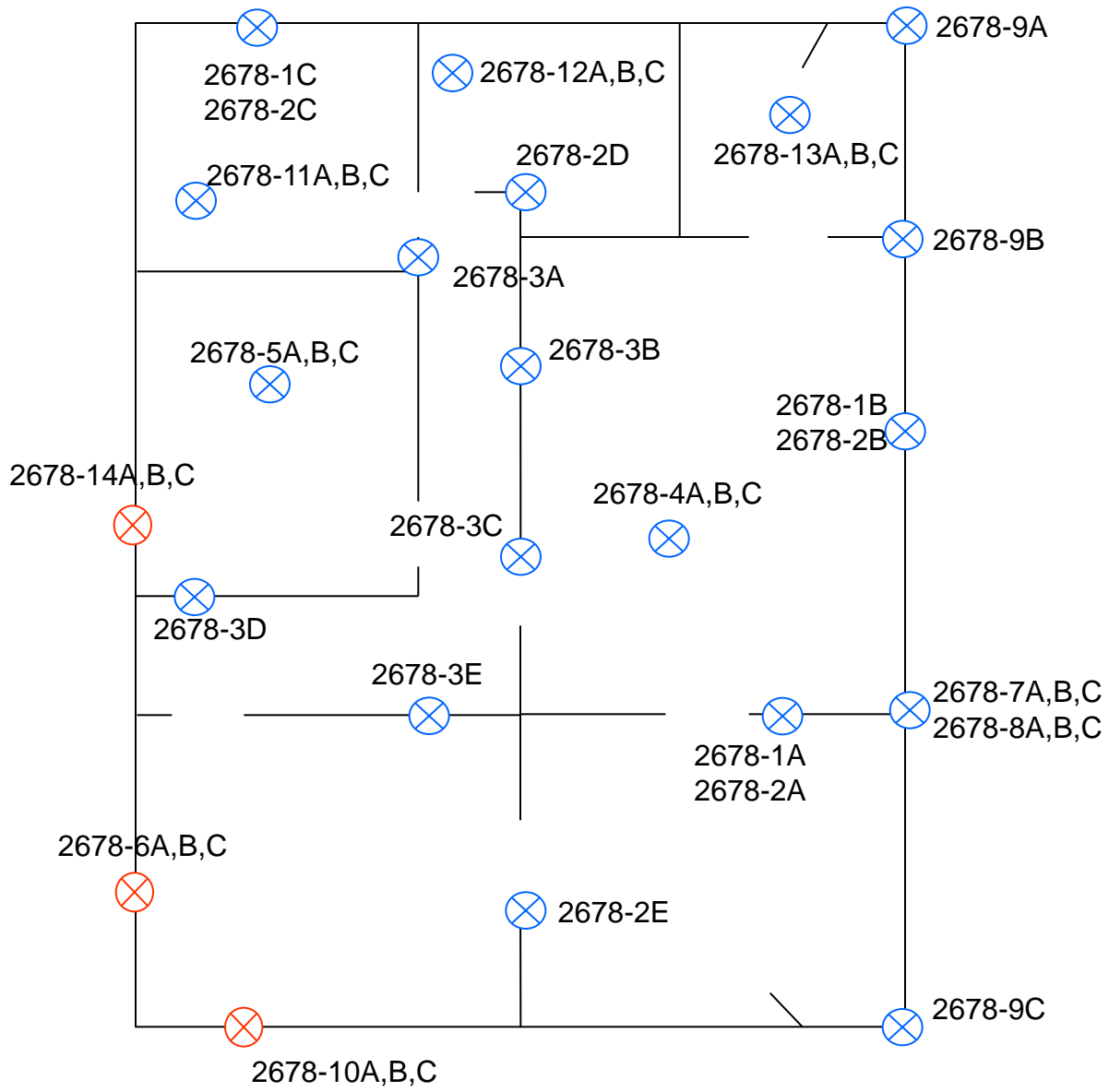

NORTH

LEGEND:



Sample Location



Sample Positive

Sample Locations

ECS Project Number
49-2970

Not to Scale



Limited Asbestos Assessment

2678 Olympia Avenue
North Charleston, Charleston County,
South Carolina



Photo 1: View of the residence at 2678 Olympia Avenue.



Photo 2: Sheet Flooring (Tan Tile Pattern with Brownish Lines).



Photo 3: Sheet Flooring (Square & Diamond Pattern with Gray/Brown Lines).



Photo 4: Sheet Flooring (White Tile Appearance with Black Accents).



Photo 5: Cement Board Exterior Siding.



Photo 6: Drywall & Associated Joint Compound.



Bulk Asbestos Analysis

By Polarized Light Microscopy
EPA Method: 600/R-93/116 and 600/M4-82-020



NVLAP Lab Code: 200664-0

Customer: ECS Carolinas, LLP
3820 Faber Place
North Charleston, SC 29405

Attn: Justin Roth

Lab Order ID: 1618189
Analysis ID: 1618189_PLM
Date Received: 9/14/2016
Date Reported: 9/19/2016

Project: 2678 Olympia

Sample ID	Description	Asbestos	Fibrous Components	Non-Fibrous Components	Attributes
Lab Sample ID	Lab Notes				Treatment
2678-1A	Drywall	None Detected	15% Cellulose	85% Other	Gray Non Fibrous Heterogeneous
1618189PLM_1					Crushed
2678-1B	Drywall	None Detected	15% Cellulose	85% Other	Gray Non Fibrous Heterogeneous
1618189PLM_2					Crushed
2678-1C	Drywall	None Detected	15% Cellulose	85% Other	Gray Non Fibrous Heterogeneous
1618189PLM_3					Crushed
2678-2A	Joint compound	None Detected		100% Other	White Non Fibrous Homogeneous
1618189PLM_4					Crushed
2678-2B	Joint compound	None Detected		100% Other	White Non Fibrous Homogeneous
1618189PLM_5					Crushed
2678-2C	Joint compound	None Detected		100% Other	White Non Fibrous Homogeneous
1618189PLM_6					Crushed
2678-2D	Joint compound	None Detected		100% Other	White Non Fibrous Homogeneous
1618189PLM_7					Crushed
2678-2E	Joint compound	None Detected		100% Other	White Non Fibrous Homogeneous
1618189PLM_8					Crushed

Disclaimer: Due to the nature of the EPA 600 method, asbestos may not be detected in samples containing low levels of asbestos. We strongly recommend that analysis of floor tiles, vermiculite, and/or heterogeneous soil samples be conducted by TEM for confirmation of "None Detected" by PLM. This report relates only to the samples tested and may not be reproduced, except in full, without the written approval of SAL. This report may not be used by the client to claim product endorsement by NVLAP or any other agency of the U.S. government. Analytical uncertainty available upon request. Scientific Analytical Institute participates in the NVLAP Proficiency Testing program. Unless otherwise noted blank sample correction was not performed. Estimated MDL is 0.1%.

Bethany Nichols (76)

Analyst

Approved Signatory



Bulk Asbestos Analysis

By Polarized Light Microscopy
EPA Method: 600/R-93/116 and 600/M4-82-020



NVLAP Lab Code: 200664-0

Customer: ECS Carolinas, LLP
3820 Faber Place
North Charleston, SC 29405

Attn: Justin Roth

Lab Order ID: 1618189
Analysis ID: 1618189_PLM
Date Received: 9/14/2016
Date Reported: 9/19/2016

Project: 2678 Olympia

Sample ID	Description	Asbestos	Fibrous Components	Non-Fibrous Components	Attributes
Lab Sample ID	Lab Notes				Treatment
2678-3A - A	Plaster	None Detected		80% Other 20% Quartz	White Non Fibrous Homogeneous
1618189PLM_9	finish				Crushed
2678-3A - B	Plaster	None Detected		80% Other 20% Quartz	Gray Non Fibrous Homogeneous
1618189PLM_47	base				Crushed
2678-3B - A	Plaster	None Detected		80% Other 20% Quartz	White Non Fibrous Homogeneous
1618189PLM_10	finish				Crushed
2678-3B - B	Plaster	None Detected		80% Other 20% Quartz	Gray Non Fibrous Homogeneous
1618189PLM_48	base				Crushed
2678-3C - A	Plaster	None Detected		80% Other 20% Quartz	White Non Fibrous Homogeneous
1618189PLM_11	finish				Crushed
2678-3C - B	Plaster	None Detected		80% Other 20% Quartz	Gray Non Fibrous Homogeneous
1618189PLM_49	base				Crushed
2678-3D - A	Plaster	None Detected		80% Other 20% Quartz	White Non Fibrous Homogeneous
1618189PLM_12	finish				Crushed
2678-3D - B	Plaster	None Detected		80% Other 20% Quartz	Gray Non Fibrous Homogeneous
1618189PLM_50	base				Crushed

Disclaimer: Due to the nature of the EPA 600 METHOD, asbestos may not be detected in samples containing low levels of asbestos. We strongly recommend that analysis of floor tiles, vermiculite, and/or heterogeneous soil samples be conducted by TEM for confirmation of "None Detected" by PLM. This report relates only to the samples tested and may not be reproduced, except in full, without the written approval of SAL. This report may not be used by the client to claim product endorsement by NVLAP or any other agency of the U.S. government. Analytical uncertainty available upon request. Scientific Analytical Institute participates in the NVLAP Proficiency Testing program. Unless otherwise noted blank sample correction was not performed. Estimated MDL is 0.1%.

Bethany Nichols (76)

Analyst

Approved Signatory



Bulk Asbestos Analysis

By Polarized Light Microscopy
EPA Method: 600/R-93/116 and 600/M4-82-020



NVLAP Lab Code: 200664-0

Customer: ECS Carolinas, LLP
3820 Faber Place
North Charleston, SC 29405

Attn: Justin Roth

Lab Order ID: 1618189
Analysis ID: 1618189_PLM
Date Received: 9/14/2016
Date Reported: 9/19/2016

Project: 2678 Olympia

Sample ID	Description	Asbestos	Fibrous Components	Non-Fibrous Components	Attributes
Lab Sample ID	Lab Notes				Treatment
2678-3E - A	Plaster	None Detected		80% Other 20% Quartz	White Non Fibrous Homogeneous
1618189PLM_13	finish				Crushed
2678-3E - B	Plaster	None Detected		80% Other 20% Quartz	Gray Non Fibrous Homogeneous
1618189PLM_51	base				Crushed
2678-4A	Linoleum	None Detected	15% Cellulose 10% Fiber Glass	75% Other	Yellow Fibrous Heterogeneous
1618189PLM_14	linoleum only				Dissolved, Teased
2678-4B	Linoleum	None Detected	15% Cellulose 10% Fiber Glass	75% Other	Yellow Fibrous Heterogeneous
1618189PLM_15	linoleum only				Dissolved, Teased
2678-4C - A	Linoleum	None Detected	15% Cellulose 10% Fiber Glass	75% Other	Yellow Fibrous Heterogeneous
1618189PLM_16	linoleum				Dissolved, Teased
2678-4C - B	Linoleum	None Detected		100% Other	Yellow Non Fibrous Homogeneous
1618189PLM_52	mastic				Dissolved
2678-5A - A	Linoleum	None Detected	15% Cellulose 5% Fiber Glass	80% Other	Tan, Brown Fibrous Heterogeneous
1618189PLM_17	linoleum 1				Teased
2678-5A - B	Linoleum	None Detected		100% Other	Yellow Non Fibrous Homogeneous
1618189PLM_53	mastic 1				Dissolved

Disclaimer: Due to the nature of the EPA 600 method, asbestos may not be detected in samples containing low levels of asbestos. We strongly recommend that analysis of floor tiles, vermiculite, and/or heterogeneous soil samples be conducted by TEM for confirmation of "None Detected" by PLM. This report relates only to the samples tested and may not be reproduced, except in full, without the written approval of SAL. This report may not be used by the client to claim product endorsement by NVLAP or any other agency of the U.S. government. Analytical uncertainty available upon request. Scientific Analytical Institute participates in the NVLAP Proficiency Testing program. Unless otherwise noted blank sample correction was not performed. Estimated MDL is 0.1%.

Bethany Nichols (76)

Analyst

Approved Signatory



Bulk Asbestos Analysis

By Polarized Light Microscopy
EPA Method: 600/R-93/116 and 600/M4-82-020



NVLAP Lab Code: 200664-0

Customer: ECS Carolinas, LLP
3820 Faber Place
North Charleston, SC 29405

Attn: Justin Roth

Lab Order ID: 1618189
Analysis ID: 1618189_PLM
Date Received: 9/14/2016
Date Reported: 9/19/2016

Project: 2678 Olympia

Sample ID	Description	Asbestos	Fibrous Components	Non-Fibrous Components	Attributes
Lab Sample ID	Lab Notes				Treatment
2678-5A - C	Linoleum	None Detected	15% Cellulose 10% Fiber Glass	75% Other	Yellow Fibrous Heterogeneous
1618189PLM_54	linoleum 2				Dissolved, Teased
2678-5A - D	Linoleum	None Detected		100% Other	Tan Non Fibrous Homogeneous
1618189PLM_55	mastic 2				Dissolved
2678-5B - A	Linoleum	None Detected	15% Cellulose 5% Fiber Glass	80% Other	Tan, Brown Fibrous Heterogeneous
1618189PLM_18	linoleum 1				Dissolved, Teased
2678-5B - B	Linoleum	None Detected		100% Other	Yellow Non Fibrous Homogeneous
1618189PLM_56	mastic 1				Dissolved
2678-5B - C	Linoleum	None Detected	15% Cellulose 10% Fiber Glass	75% Other	Yellow Fibrous Heterogeneous
1618189PLM_57	linoleum 2				Dissolved, Teased
2678-5B - D	Linoleum	None Detected		100% Other	Tan Non Fibrous Homogeneous
1618189PLM_58	mastic 2				Dissolved
2678-5C - A	Linoleum	None Detected	15% Cellulose 5% Fiber Glass	80% Other	Tan, Brown Fibrous Heterogeneous
1618189PLM_19	linoleum 1				Dissolved, Teased
2678-5C - B	Linoleum	None Detected		100% Other	Yellow Non Fibrous Homogeneous
1618189PLM_59	mastic 1				Dissolved

Disclaimer: Due to the nature of the EPA 600 method, asbestos may not be detected in samples containing low levels of asbestos. We strongly recommend that analysis of floor tiles, vermiculite, and/or heterogeneous soil samples be conducted by TEM for confirmation of "None Detected" by PLM. This report relates only to the samples tested and may not be reproduced, except in full, without the written approval of SAL. This report may not be used by the client to claim product endorsement by NVLAP or any other agency of the U.S. government. Analytical uncertainty available upon request. Scientific Analytical Institute participates in the NVLAP Proficiency Testing program. Unless otherwise noted blank sample correction was not performed. Estimated MDL is 0.1%.

Bethany Nichols (76)

Analyst

Approved Signatory



Bulk Asbestos Analysis

By Polarized Light Microscopy
EPA Method: 600/R-93/116 and 600/M4-82-020



NVLAP Lab Code: 200664-0

Customer: ECS Carolinas, LLP
3820 Faber Place
North Charleston, SC 29405

Attn: Justin Roth

Lab Order ID: 1618189
Analysis ID: 1618189_PLM
Date Received: 9/14/2016
Date Reported: 9/19/2016

Project: 2678 Olympia

Sample ID	Description	Asbestos	Fibrous Components	Non-Fibrous Components	Attributes
Lab Sample ID	Lab Notes				Treatment
2678-5C - C	Linoleum	None Detected	15% Cellulose 10% Fiber Glass	75% Other	Yellow Fibrous Heterogeneous
1618189PLM_60	linoleum 2				Dissolved, Teased
2678-5C - D	Linoleum	None Detected		100% Other	Tan Non Fibrous Homogeneous
1618189PLM_61	mastic 2				Dissolved
2678-6A	Cement board	20% Chrysotile		80% Other	Gray Fibrous Homogeneous
1618189PLM_20					Teased
2678-6B	Cement board	Not Analyzed			
1618189PLM_21					
2678-6C	Cement board	Not Analyzed			
1618189PLM_22					
2678-7A	Felt paper	None Detected	70% Cellulose	30% Other	Black Fibrous Heterogeneous
1618189PLM_23					Dissolved, Teased
2678-7B	Felt paper	None Detected	70% Cellulose	30% Other	Black Fibrous Heterogeneous
1618189PLM_24					Dissolved, Teased
2678-7C	Felt paper	None Detected	70% Cellulose	30% Other	Black Fibrous Heterogeneous
1618189PLM_25					Dissolved, Teased

Disclaimer: Due to the nature of the EPA 600 method, asbestos may not be detected in samples containing low levels of asbestos. We strongly recommend that analysis of floor tiles, vermiculite, and/or heterogeneous soil samples be conducted by TEM for confirmation of "None Detected" by PLM. This report relates only to the samples tested and may not be reproduced, except in full, without the written approval of SAL. This report may not be used by the client to claim product endorsement by NVLAP or any other agency of the U.S. government. Analytical uncertainty available upon request. Scientific Analytical Institute participates in the NVLAP Proficiency Testing program. Unless otherwise noted blank sample correction was not performed. Estimated MDL is 0.1%.

Bethany Nichols (76)

Analyst

Approved Signatory



Bulk Asbestos Analysis

By Polarized Light Microscopy
EPA Method: 600/R-93/116 and 600/M4-82-020



NVLAP Lab Code: 200664-0

Customer: ECS Carolinas, LLP
3820 Faber Place
North Charleston, SC 29405

Attn: Justin Roth

Lab Order ID: 1618189
Analysis ID: 1618189_PLM
Date Received: 9/14/2016
Date Reported: 9/19/2016

Project: 2678 Olympia

Sample ID	Description	Asbestos	Fibrous Components	Non-Fibrous Components	Attributes
Lab Sample ID	Lab Notes				Treatment
2678-8A	Gypsum board	None Detected	15% Cellulose	85% Other	Gray Non Fibrous Heterogeneous
1618189PLM_26					Crushed
2678-8B	Gypsum board	None Detected	15% Cellulose	85% Other	Gray Non Fibrous Heterogeneous
1618189PLM_27					Crushed
2678-8C	Gypsum board	None Detected	15% Cellulose	85% Other	Gray Non Fibrous Heterogeneous
1618189PLM_28					Crushed
2678-9A - A	Asphalt & felt	None Detected	20% Fiber Glass	80% Other	Black Fibrous Heterogeneous
1618189PLM_29	shingle				Dissolved, Teased
2678-9A - B	Asphalt & felt	None Detected	70% Cellulose	30% Other	Black Fibrous Heterogeneous
1618189PLM_62	felt				Dissolved, Teased
2678-9B - A	Asphalt & felt	None Detected	20% Fiber Glass	80% Other	Black Fibrous Heterogeneous
1618189PLM_30	shingle				Dissolved, Teased
2678-9B - B	Asphalt & felt	None Detected	70% Cellulose	30% Other	Black Fibrous Heterogeneous
1618189PLM_63	felt				Dissolved, Teased
2678-9C - A	Asphalt & felt	None Detected	20% Fiber Glass	80% Other	Black Fibrous Heterogeneous
1618189PLM_31	shingle				Dissolved, Teased

Disclaimer: Due to the nature of the EPA 600 METHOD, asbestos may not be detected in samples containing low levels of asbestos. We strongly recommend that analysis of floor tiles, vermiculite, and/or heterogeneous soil samples be conducted by TEM for confirmation of "None Detected" by PLM. This report relates only to the samples tested and may not be reproduced, except in full, without the written approval of SAL. This report may not be used by the client to claim product endorsement by NVLAP or any other agency of the U.S. government. Analytical uncertainty available upon request. Scientific Analytical Institute participates in the NVLAP Proficiency Testing program. Unless otherwise noted blank sample correction was not performed. Estimated MDL is 0.1%.

Bethany Nichols (76)

Analyst

Approved Signatory



Bulk Asbestos Analysis

By Polarized Light Microscopy
EPA Method: 600/R-93/116 and 600/M4-82-020



NVLAP Lab Code: 200664-0

Customer: ECS Carolinas, LLP
3820 Faber Place
North Charleston, SC 29405

Attn: Justin Roth

Lab Order ID: 1618189
Analysis ID: 1618189_PLM
Date Received: 9/14/2016
Date Reported: 9/19/2016

Project: 2678 Olympia

Sample ID	Description	Asbestos	Fibrous Components	Non-Fibrous Components	Attributes
Lab Sample ID	Lab Notes				Treatment
2678-9C - B	Asphalt & felt	None Detected	70% Cellulose	30% Other	Black Fibrous Heterogeneous
1618189PLM_64	felt				Dissolved, Teased
2678-10A	Caulking	6% Chrysotile		94% Other	White Non Fibrous Homogeneous
1618189PLM_32					Dissolved
2678-10B	Caulking	Not Analyzed			
1618189PLM_33					
2678-10C	Caulking	Not Analyzed			
1618189PLM_34					
2678-11A	Linoleum	None Detected	15% Cellulose 5% Fiber Glass	80% Other	Pink, Brown Fibrous Heterogeneous
1618189PLM_35					Dissolved, Teased
2678-11B	Linoleum	None Detected	15% Cellulose 5% Fiber Glass	80% Other	Pink, Brown Fibrous Heterogeneous
1618189PLM_36					Dissolved, Teased
2678-11C	Linoleum	None Detected	15% Cellulose 5% Fiber Glass	80% Other	Pink, Brown Fibrous Heterogeneous
1618189PLM_37					Dissolved, Teased
2678-12A - A	Linoleum	None Detected	15% Cellulose 5% Fiber Glass	80% Other	Beige Fibrous Heterogeneous
1618189PLM_38	linoleum 1				Dissolved, Teased

Disclaimer: Due to the nature of the EPA 600 method, asbestos may not be detected in samples containing low levels of asbestos. We strongly recommend that analysis of floor tiles, vermiculite, and/or heterogeneous soil samples be conducted by TEM for confirmation of "None Detected" by PLM. This report relates only to the samples tested and may not be reproduced, except in full, without the written approval of SAL. This report may not be used by the client to claim product endorsement by NVLAP or any other agency of the U.S. government. Analytical uncertainty available upon request. Scientific Analytical Institute participates in the NVLAP Proficiency Testing program. Unless otherwise noted blank sample correction was not performed. Estimated MDL is 0.1%.

Bethany Nichols (76)

Analyst

Approved Signatory



Bulk Asbestos Analysis

By Polarized Light Microscopy
EPA Method: 600/R-93/116 and 600/M4-82-020



NVLAP Lab Code: 200664-0

Customer: ECS Carolinas, LLP
3820 Faber Place
North Charleston, SC 29405

Attn: Justin Roth

Lab Order ID: 1618189
Analysis ID: 1618189_PLM
Date Received: 9/14/2016
Date Reported: 9/19/2016

Project: 2678 Olympia

Sample ID	Description	Asbestos	Fibrous Components	Non-Fibrous Components	Attributes
Lab Sample ID	Lab Notes				Treatment
2678-12A - B	Linoleum	None Detected	15% Cellulose 10% Fiber Glass	75% Other	Yellow Fibrous Heterogeneous
1618189PLM_65	linoleum 2				Dissolved, Teased
2678-12A - C	Linoleum	None Detected		100% Other	Tan Non Fibrous Homogeneous
1618189PLM_66	mastic				Dissolved
2678-12B - A	Linoleum	None Detected	15% Cellulose 5% Fiber Glass	80% Other	Beige Fibrous Heterogeneous
1618189PLM_39	linoleum 1				Dissolved, Teased
2678-12B - B	Linoleum	None Detected	15% Cellulose 10% Fiber Glass	75% Other	Yellow Fibrous Heterogeneous
1618189PLM_67	linoleum 2				Dissolved, Teased
2678-12B - C	Linoleum	None Detected		100% Other	Tan Non Fibrous Homogeneous
1618189PLM_68	mastic				Dissolved
2678-12C - A	Linoleum	None Detected	15% Cellulose 5% Fiber Glass	80% Other	Beige Fibrous Heterogeneous
1618189PLM_40	linoleum 1				Dissolved, Teased
2678-12C - B	Linoleum	None Detected	15% Cellulose 10% Fiber Glass	75% Other	Yellow Fibrous Heterogeneous
1618189PLM_69	linoleum 2				Dissolved, Teased
2678-12C - C	Linoleum	None Detected		100% Other	Tan Non Fibrous Homogeneous
1618189PLM_70	mastic				Dissolved

Disclaimer: Due to the nature of the EPA 600 method, asbestos may not be detected in samples containing low levels of asbestos. We strongly recommend that analysis of floor tiles, vermiculite, and/or heterogeneous soil samples be conducted by TEM for confirmation of "None Detected" by PLM. This report relates only to the samples tested and may not be reproduced, except in full, without the written approval of SAL. This report may not be used by the client to claim product endorsement by NVLAP or any other agency of the U.S. government. Analytical uncertainty available upon request. Scientific Analytical Institute participates in the NVLAP Proficiency Testing program. Unless otherwise noted blank sample correction was not performed. Estimated MDL is 0.1%.

Bethany Nichols (76)

Analyst

Approved Signatory



Bulk Asbestos Analysis

By Polarized Light Microscopy
EPA Method: 600/R-93/116 and 600/M4-82-020



NVLAP Lab Code: 200664-0

Customer: ECS Carolinas, LLP
3820 Faber Place
North Charleston, SC 29405

Attn: Justin Roth

Lab Order ID: 1618189
Analysis ID: 1618189_PLM
Date Received: 9/14/2016
Date Reported: 9/19/2016

Project: 2678 Olympia

Sample ID	Description	Asbestos	Fibrous Components	Non-Fibrous Components	Attributes
Lab Sample ID	Lab Notes				Treatment
2678-13A - A	Linoleum	None Detected	15% Cellulose 10% Fiber Glass	75% Other	Green, White Fibrous Heterogeneous
1618189PLM_41	linoleum 1				Dissolved, Teased
2678-13A - B	Linoleum	None Detected		100% Other	Yellow Non Fibrous Homogeneous
1618189PLM_71	mastic				Dissolved
2678-13A - C	Linoleum	None Detected	15% Cellulose 10% Fiber Glass	75% Other	Green, White Fibrous Heterogeneous
1618189PLM_72	linoleum 2				Dissolved, Teased
2678-13B - A	Linoleum	None Detected	15% Cellulose 10% Fiber Glass	75% Other	Green, White Fibrous Heterogeneous
1618189PLM_42	linoleum 1				Dissolved, Teased
2678-13B - B	Linoleum	None Detected		100% Other	Yellow Non Fibrous Homogeneous
1618189PLM_73	mastic				Dissolved
2678-13B - C	Linoleum	None Detected	15% Cellulose 10% Fiber Glass	75% Other	Green, White Fibrous Heterogeneous
1618189PLM_74	linoleum 2				Dissolved, Teased
2678-13C - A	Linoleum	None Detected	15% Cellulose 10% Fiber Glass	75% Other	Green, White Fibrous Heterogeneous
1618189PLM_43	linoleum 1				Dissolved, Teased
2678-13C - B	Linoleum	None Detected		100% Other	Yellow Non Fibrous Homogeneous
1618189PLM_75	mastic				Dissolved

Disclaimer: Due to the nature of the EPA 600 method, asbestos may not be detected in samples containing low levels of asbestos. We strongly recommend that analysis of floor tiles, vermiculite, and/or heterogeneous soil samples be conducted by TEM for confirmation of "None Detected" by PLM. This report relates only to the samples tested and may not be reproduced, except in full, without the written approval of SAL. This report may not be used by the client to claim product endorsement by NVLAP or any other agency of the U.S. government. Analytical uncertainty available upon request. Scientific Analytical Institute participates in the NVLAP Proficiency Testing program. Unless otherwise noted blank sample correction was not performed. Estimated MDL is 0.1%.

Bethany Nichols (76)

Analyst

Approved Signatory



Bulk Asbestos Analysis

By Polarized Light Microscopy
EPA Method: 600/R-93/116 and 600/M4-82-020



NVLAP Lab Code: 200664-0

Customer: ECS Carolinas, LLP
3820 Faber Place
North Charleston, SC 29405

Attn: Justin Roth

Lab Order ID: 1618189
Analysis ID: 1618189_PLM
Date Received: 9/14/2016
Date Reported: 9/19/2016

Project: 2678 Olympia

Sample ID	Description	Asbestos	Fibrous Components	Non-Fibrous Components	Attributes
Lab Sample ID	Lab Notes				Treatment
2678-13C - C	Linoleum	None Detected	15% Cellulose 10% Fiber Glass	75% Other	Green, White Fibrous Heterogeneous
1618189PLM_76	linoleum 2				Dissolved, Teased
2678-14A	Black tar	8% Chrysotile		92% Other	Black Non Fibrous Homogeneous
1618189PLM_44					Dissolved
2678-14B	Black tar	Not Analyzed			
1618189PLM_45					
2678-14C	Black tar	Not Analyzed			
1618189PLM_46					

Disclaimer: Due to the nature of the EPA 600 method, asbestos may not be detected in samples containing low levels of asbestos. We strongly recommend that analysis of floor tiles, vermiculite, and/or heterogeneous soil samples be conducted by TEM for confirmation of "None Detected" by PLM. This report relates only to the samples tested and may not be reproduced, except in full, without the written approval of SAL. This report may not be used by the client to claim product endorsement by NVLAP or any other agency of the U.S. government. Analytical uncertainty available upon request. Scientific Analytical Institute participates in the NVLAP Proficiency Testing program. Unless otherwise noted blank sample correction was not performed. Estimated MDL is 0.1%.

Bethany Nichols (76)

Analyst

Approved Signatory



Scientific Analytical Institute
 4604 Dundas Dr. Greensboro, NC 27407
 Phone: 336.292.3888 Fax: 336.292.3313
 www.sailab.com lab@sailab.com

Lab Use Only
 Lab Order ID: 1618189
 Client Code: _____

Company Contact Information	
Company: ECS Carolinas, LLP	Contact: Justin Roth
Address: 3820 Faber Place Drive, Suite 500 North Charleston, SC 29405	Phone <input type="checkbox"/> : 843-654-4448 Fax <input type="checkbox"/> : Email <input type="checkbox"/> : jRoth@ecslimited.com

Asbestos Test Types	
PLM EPA 600/R-93/116 (PLM)	<input checked="" type="checkbox"/>
Positive stop	<input checked="" type="checkbox"/>
PLM Point Count 400 (PT4)	<input type="checkbox"/>
PLM Point Count 1000 (PTM)	<input type="checkbox"/>
PCM NIOSH 7400-A Rules (PCM)	<input type="checkbox"/>
B Rules (PCB) <input type="checkbox"/> TWA (PTA) <input type="checkbox"/>	
TEM AHERA (AHE)	<input type="checkbox"/>
TEM Level II (LII)	<input type="checkbox"/>
TEM NIOSH 7402 (TNI)	<input type="checkbox"/>
TEM Bulk Qualitative (TBL)	<input type="checkbox"/>
TEM Bulk Chatfield (TBS)	<input checked="" type="checkbox"/>
TEM Bulk Quantitative (TBQ)	<input type="checkbox"/>
TEM Wipe ASTM D6480-05	<input type="checkbox"/>
TEM Microvac ASTM D5755-02	<input type="checkbox"/>
TEM Water EPA 100.2 (TW1)	<input type="checkbox"/>
Other: _____	<input type="checkbox"/>

Billing/Invoice Information	Turn Around Times	
Company: SAME	90 Min. <input type="checkbox"/>	48 Hours <input type="checkbox"/>
Contact:	3 Hours <input type="checkbox"/>	72 Hours <input type="checkbox"/>
Address:	6 Hours <input type="checkbox"/>	96 Hours <input type="checkbox"/>
	12 Hours <input type="checkbox"/>	120 Hours <input checked="" type="checkbox"/>
	24 Hours <input type="checkbox"/>	144 Hours <input type="checkbox"/>

PO Number: _____
 Project Name/Number: 2678 Olympia

Sample ID #	Volume/Area	Comments
		As per SCDHEC requirements. Please analyze all samples by PLM. For NOB Materials, please analyze one sample from each group by TEM if all of the samples are reported negative by PLM.

Accepted
 Rejected

Total # of Samples 46

Relinquished by	Date/Time	Received by	Date/Time
<i>[Signature]</i>	9/12/16 - 5:00 PM	<i>[Signature]</i>	9/14/16 10A



11/6/18/89
2 of 2

Asbestos Survey Field Data Sheet

Project Name: 2678 Olympia Sampled By: JAC
Project Location: _____ Project Manager: _____
Building Number: _____ Project Number: _____

Sample No.	Homogeneous Area	Sample Description	Quantity	Friable Y/N	Location	Accessibility/Potential for Damage
2678-1A,B,C	walkways	Drywall	2,000SF	Y	Throughout	
2678-2A,B,C,D,E	walk/culiy	Joint Compound	2,000SF	Y	"	
2678-3A,B,C,D,E	walls	Plaster	2,000SF	Y	Hallways	
2678-4A,B,C	Floor	linoleum	400SF	N	Kitchen	
2678-5A,B,C	Floor	linoleum	200SF	N	Bedroom	
2678-6A,B,C	exterior	Cement Sand	3,000SF	N	exterior	
2678-7A,B,C	exterior	felt paper	"	N	exterior	
2678-8A,B,C	exterior	gypsum board	"	N	exterior	
2678-9A,B,C	Roof	Asphalt+felt	2,000SF	N	Roof	
2678-10A,B,C	windows	caulking	200LF	N	exterior	
2678-11A,B,C	floor	linoleum	200SF	N	Bedroom (bullet Room)	
2678-12A,B,C	floor	linoleum	80SF	N	Bathroom	
2678-13A,B,C	floor	linoleum	55F	N	entrance to kitchen	
2678-14A,B,C	Roof	Black tar	82F	N	@ chimney	

Surveyor Signature: _____

Date: 9/13/16



Bulk Asbestos Analysis by Transmission Electron Microscopy

Semi-Quantitative
Chatfield SOP 1988-02 Rev. 1

Customer: ECS Carolinas, LLP
3820 Faber Place
North Charleston, SC 29405

Attn: Justin Roth

Lab Order ID: 1618604

Project: 2678 Olympia

Analysis ID: 1618604_TBS

Date Received: 9/20/2016

Date Reported: 9/27/2016

Sample ID	Description	Organic	Acid Sol.	Asbestos		LCL-UCL
<i>Lab Sample ID</i>	<i>Lab Notes</i>	<i>(Wt. %)</i>	<i>(Wt. %)</i>	<i>(Wt. %)</i>		<i>(Wt. %)</i>
2678-4C-A		55%	-	None Detected		
<i>1618604TBS_1</i>	<i>linoleum</i>					
2678-4C-B		39%	-	None Detected		
<i>1618604TBS_2</i>	<i>mastic</i>					
2678-5C-A		73%	-	None Detected		
<i>1618604TBS_3</i>	<i>linoleum 1</i>					
2678-5C-B		36%	-	None Detected		
<i>1618604TBS_4</i>	<i>mastic 1</i>					
2678-5C-C		59%	-	2.1 %	Chrysotile	1.9% - 2.3%
<i>1618604TBS_5</i>	<i>linoleum 2</i>					
2678-5C-D		39%	-	None Detected		
<i>1618604TBS_6</i>	<i>mastic 2</i>					

Disclaimer: This report relates only to the samples tested and may not be reproduced, except in full, without the written approval of SAI. This report may not be used by the client to claim product endorsement by NVLAP or any other agency of the U.S. government.

Russell Shelton (16)

Analyst

Scientific Analytical Institute, Inc.

Approved Signatory

(336) 292-3888



Bulk Asbestos Analysis by Transmission Electron Microscopy

Semi-Quantitative
Chatfield SOP 1988-02 Rev. 1

Customer: ECS Carolinas, LLP
3820 Faber Place
North Charleston, SC 29405

Attn: Justin Roth

Lab Order ID: 1618604

Project: 2678 Olympia

Analysis ID: 1618604_TBS

Date Received: 9/20/2016

Date Reported: 9/27/2016

Sample ID	Description	Organic	Acid Sol.	Asbestos	LCL-UCL																																				
<i>Lab Sample ID</i>	<i>Lab Notes</i>	<i>(Wt. %)</i>	<i>(Wt. %)</i>	<i>(Wt. %)</i>	<i>(Wt. %)</i>																																				
2678-7C		96%	-	None Detected																																					
1618604TBS_7						2678-9C-A		12%	-	None Detected		1618604TBS_8	<i>shingle</i>	2678-9C-B		47%	-	None Detected		1618604TBS_9	<i>felt</i>	2678-11C		29%	-	None Detected		1618604TBS_10		2678-12C-A		60.%	-	None Detected		1618604TBS_11	<i>linoleum 1</i>	2678-12C-B		56%	-
2678-9C-A		12%	-	None Detected																																					
1618604TBS_8	<i>shingle</i>					2678-9C-B		47%	-	None Detected		1618604TBS_9	<i>felt</i>	2678-11C		29%	-	None Detected		1618604TBS_10		2678-12C-A		60.%	-	None Detected		1618604TBS_11	<i>linoleum 1</i>	2678-12C-B		56%	-	None Detected		1618604TBS_12	<i>linoleum 2</i>				
2678-9C-B		47%	-	None Detected																																					
1618604TBS_9	<i>felt</i>					2678-11C		29%	-	None Detected		1618604TBS_10		2678-12C-A		60.%	-	None Detected		1618604TBS_11	<i>linoleum 1</i>	2678-12C-B		56%	-	None Detected		1618604TBS_12	<i>linoleum 2</i>												
2678-11C		29%	-	None Detected																																					
1618604TBS_10						2678-12C-A		60.%	-	None Detected		1618604TBS_11	<i>linoleum 1</i>	2678-12C-B		56%	-	None Detected		1618604TBS_12	<i>linoleum 2</i>																				
2678-12C-A		60.%	-	None Detected																																					
1618604TBS_11	<i>linoleum 1</i>					2678-12C-B		56%	-	None Detected		1618604TBS_12	<i>linoleum 2</i>																												
2678-12C-B		56%	-	None Detected																																					
1618604TBS_12	<i>linoleum 2</i>																																								

Disclaimer: This report relates only to the samples tested and may not be reproduced, except in full, without the written approval of SAI. This report may not be used by the client to claim product endorsement by NVLAP or any other agency of the U.S. government.

Russell Shelton (16)

Analyst

Scientific Analytical Institute, Inc. 4604 Dundas Dr. Greensboro, NC 27407 (336) 292-3888

Approved Signatory



Bulk Asbestos Analysis by Transmission Electron Microscopy

**Semi-Quantitative
Chatfield SOP 1988-02 Rev. 1**

Customer: ECS Carolinas, LLP
3820 Faber Place
North Charleston, SC 29405

Attn: Justin Roth

Lab Order ID: 1618604

Analysis ID: 1618604_TBS

Date Received: 9/20/2016

Date Reported: 9/27/2016

Project: 2678 Olympia

Sample ID	Description	Organic	Acid Sol.	Asbestos	LCL-UCL
<i>Lab Sample ID</i>	<i>Lab Notes</i>	<i>(Wt. %)</i>	<i>(Wt. %)</i>	<i>(Wt. %)</i>	<i>(Wt. %)</i>
2678-12C-C		30.%	-	None Detected	
1618604TBS_13	<i>mastic</i>				
2678-13C-A		58%	-	None Detected	
1618604TBS_14	<i>linoleum 1</i>				
2678-13C-B		48%	-	None Detected	
1618604TBS_15	<i>mastic</i>				
2678-13C-C		47%	-	None Detected	
1618604TBS_16	<i>linoleum 2</i>				

Disclaimer: This report relates only to the samples tested and may not be reproduced, except in full, without the written approval of SAI. This report may not be used by the client to claim product endorsement by NVLAP or any other agency of the U.S. government.

Russell Shelton (16)

Analyst

Scientific Analytical Institute, Inc. 4604 Dundas Dr. Greensboro, NC 27407 (336) 292-3888

Approved Signatory



Scientific Analytical Institute
 4604 Dundas Dr. Greensboro, NC 27407
 Phone: 336.292.3888 Fax: 336.292.3313
 www.sailab.com lab@sailab.com

1618004

Lab Use Only
 Lab Order ID: 1618004
 Client Code: _____

Company Contact Information	
Company: ECS Carolinas, LLP	Contact: Justin Roth
Address: 3820 Faber Place Drive, Suite 500 North Charleston, SC 29405	Phone <input type="checkbox"/> : 843-654-4448 Fax <input type="checkbox"/> : Email <input type="checkbox"/> : JRoth@ecslimited.com

Asbestos Test Types	
PLM EPA 600/R-93/116 (PLM)	<input checked="" type="checkbox"/>
Positive stap	<input checked="" type="checkbox"/>
PLM Point Count 400 (PT4)	<input type="checkbox"/>
PLM Point Count 1000 (PTM)	<input type="checkbox"/>
PCM NIOSH 7400-A Rules (PCM)	<input type="checkbox"/>
B Rules (PCB) <input type="checkbox"/> TWA (PTA) <input type="checkbox"/>	
TEM AHERA (AHE)	<input type="checkbox"/>
TEM Level II (LII)	<input type="checkbox"/>
TEM NIOSH 7402 (TNI)	<input type="checkbox"/>
TEM Bulk Qualitative (TBL)	<input type="checkbox"/>
TEM Bulk Chatfield (TBS)	<input checked="" type="checkbox"/>
TEM Bulk Quantitative (TBO)	<input type="checkbox"/>
TEM Wipe ASTM D6480-05	<input type="checkbox"/>
TEM Microvac ASTM D5755-02	<input type="checkbox"/>
TEM Water EPA 100.2 (TW1)	<input type="checkbox"/>
Other: _____	<input type="checkbox"/>

Billing/Invoice Information	Turn Around Times	
Company: SAME	90 Min. <input type="checkbox"/>	48 Hours <input type="checkbox"/>
Contact:	3 Hours <input type="checkbox"/>	72 Hours <input type="checkbox"/>
Address:	6 Hours <input type="checkbox"/>	96 Hours <input type="checkbox"/>
	12 Hours <input type="checkbox"/>	120 Hours <input type="checkbox"/>
	24 Hours <input type="checkbox"/>	144 Hours <input type="checkbox"/>

PO Number: _____
 Project Name/Number: 2678 Olympia

Sample ID #	Volume/Area	Comments
		As per SCDHEC requirements. Please analyze all samples by PLM. For NOB Materials, please analyze one sample from each group by TEM if all of the samples are reported negative by PLM.

Accepted
 Rejected

Total # of Samples 46

Relinquished by	Date/Time	Received by	Date/Time
<u>[Signature]</u>	<u>9/12/16 - 5:00pm</u>	<u>[Signature]</u>	<u>9/11/16 10A</u>



~~10/19/18~~ 10/18/04
2 of 2

Asbestos Survey Field Data Sheet

Project Name: 2678 Olympia Sampled By: JPR
Project Location: _____ Project Manager: _____
Building Number: _____ Project Number: _____

Sample No.	Homogeneous Area	Sample Description	Quantity	Friable Y/N	Location	Accessibility/Potential for Damage
2678-1A,B,C	walkways	Drywall	2,000SF	Y	Throughout	
2678-2A,B,C,D,E	walk/corridor	Joint Compound	2,000SF	Y	"	
2678-3A,B,C,D,E	walls	Plaster	2,000SF	Y	Hallways	
2678-4A,B,C	Floor	linoleum	700SF	N	Kitchen	
2678-5A,B,C	Floor	linoleum	200SF	N	Bedroom	
2678-6A,B,C	exterior	Cement Sand	3,000SF	N	exterior	
2678-7A,B,C	exterior	felt paper	"	N	exterior	
2678-8A,B,C	exterior	gypsum board	"	N	exterior	
2678-9A,B,C	Roof	Asphalt+felt	2,000SF	N	Roof	
2678-10A,B,C	windows	caulking	200LF	N	exterior	
2678-11A,B,C	floor	linoleum	200SF	N	Bedroom (bullet room)	
2678-12A,B,C	floor	linoleum	80SF	N	Bathroom	
2678-13A,B,C	floor	linoleum	55SF	N	entrance to kitchen	
2678-14A,B,C	Roof	Black tar	8LF	N	@chimney	

Surveyor Signature: _____ Date: 9/13/16

SCDHEC ISSUED

Asbestos ID Card

Braxton B Dawson III

Expiration Date

CONSULTBI	BI-01194	03/16/17
CONSULTPD	PD-00163	03/16/17



SCDHEC ISSUED
Asbestos ID Card

Lindsey Lucas



Expiration Date

CONSULTBI	BI-00603	06/21/17
CONSULTPD	PD-00140	08/18/16
AIRAMPLER	AS-00176	06/20/17