



Chris Jones Escambia County Property Appraiser

Real Estate Search Tangible Property Search Sale List

[Back](#)

Navigate Mode
 Account
 Reference

[Printer Friendly Version](#)

General Information

Reference: 092S301001000050
Account: 052648000
Owners: GARRETT VIDA KATHERINE
Mail: 3224 NORTH W ST
 PENSACOLA, FL 32505
Situs: 3224 FRANKLIN AVE 32505
Use Code: SINGLE FAMILY RESID
Taxing Authority: COUNTY MSTU
Tax Inquiry: [Open Tax Inquiry Window](#)
 Tax Inquiry link courtesy of Scott Lunsford
 Escambia County Tax Collector

Assessments

Year	Land	Imprv	Total	Cap Val
2019	\$6,938	\$36,169	\$43,107	\$37,137
2018	\$6,938	\$33,976	\$40,914	\$36,445
2017	\$6,938	\$33,067	\$40,005	\$35,696

[Disclaimer](#)

[Tax Estimator](#)

> [File for New Homestead Exemption Online](#)

Sales Data

Sale Date	Book	Page	Value	Type	Official Records (New Window)
04/1995	3759	204	\$100	QC	View Instr

Official Records Inquiry courtesy of Pam Childers
Escambia County Clerk of the Circuit Court and Comptroller

2019 Certified Roll Exemptions
HOMESTEAD EXEMPTION

Legal Description
NLY 99 FT OF LTS 50 51 52 BUDD PROPERTY PB 1 P 46 DB 457
P 201 OR 3759 P 204 LESS OR 971 P 250 STATE RD W ST R/W

Extra Features
BLOCK/BRICK BUILDING
BLOCK/BRICK GARAGE

Parcel Information

[Launch Interactive Map](#)

Section Map Id:
[09-2S-30-4](#)

Approx. Acreage:
0.2269

Zoned:
HC/LI

Evacuation & Flood Information
[Open Report](#)

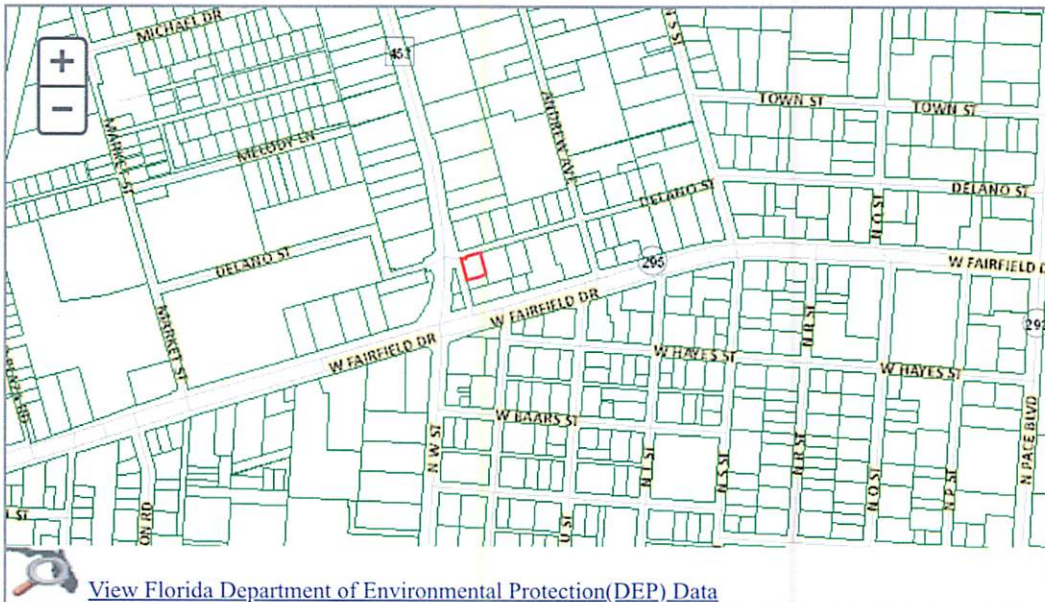

[View Florida Department of Environmental Protection\(DEP\) Data](#)

Buildings

Address: 3224 FRANKLIN AVE, Year Built: 1941, Effective Year: 1941

Structural Elements
DECOR/MILLWORK-AVERAGE
DWELLING UNITS-1
EXTERIOR WALL-SIDING-SHT.AVG.
FLOOR COVER-PINE/SOFTWOOD
FOUNDATION-WOOD/NO SUB FLR
HEAT/AIR-WALL/FLOOR FURN

INTERIOR WALL-DRYWALL-PLASTER
NO. PLUMBING FIXTURES-3
NO. STORIES-1
ROOF COVER-COMPOSITION SHG
ROOF FRAMING-GABLE
STORY HEIGHT-0
STRUCTURAL FRAME-WOOD FRAME

 Areas - 1086 Total SF

BASE AREA - 950

OPEN PORCH FIN - 136

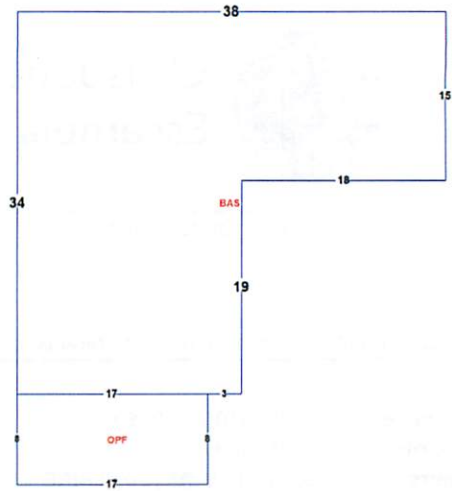

Images



1/9/03

The primary use of the assessment data is for the preparation of the current year tax roll. No responsibility or liability is assumed for inaccuracies or errors.

Last Updated:11/14/2019 (tc.1660)