

LEGEND

 = Buildings Involved



Vacant Land

Service Alley

Vacant Land

Service Alley

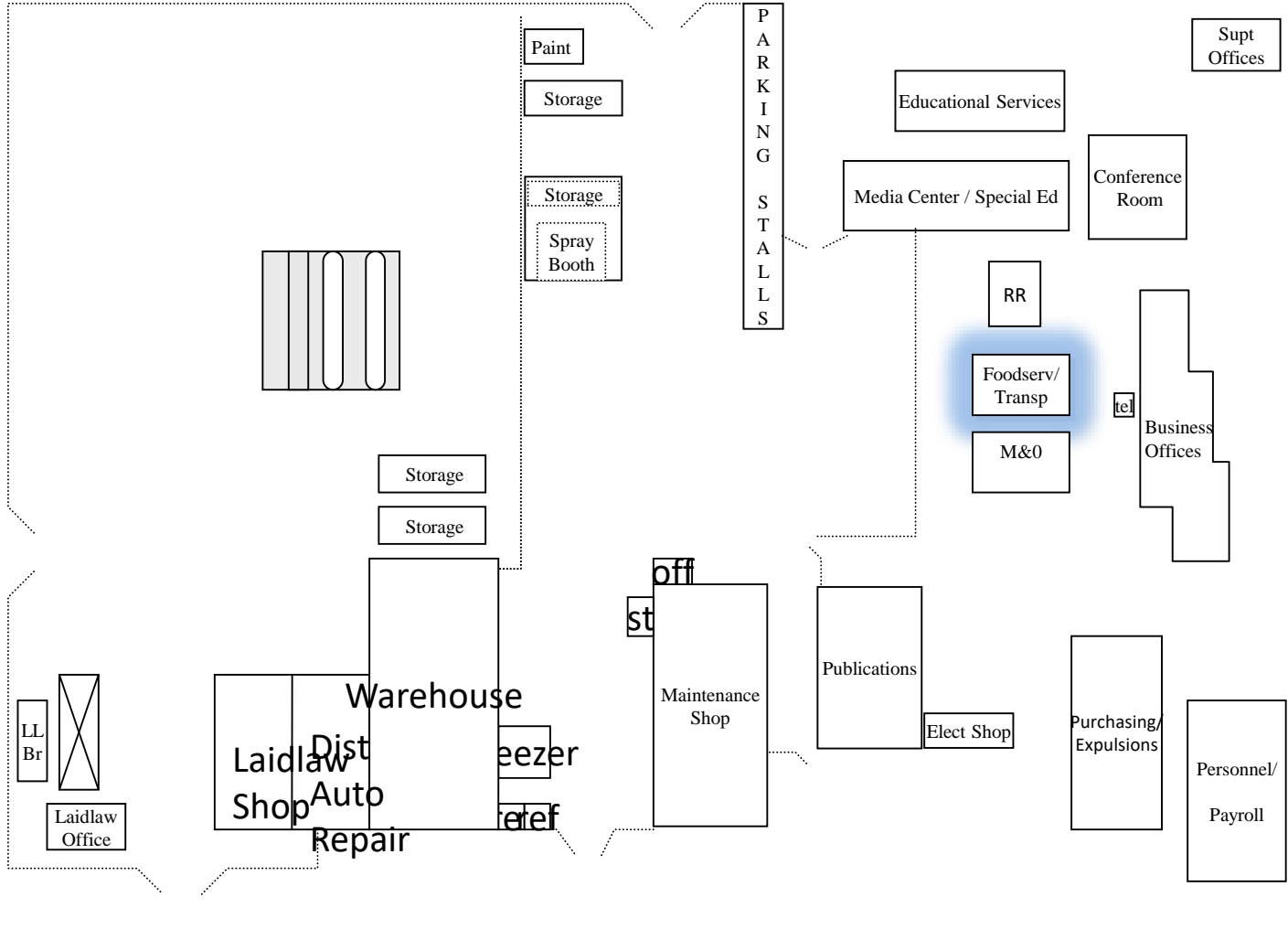

Two Mile Road

Vacant Land

District Office 5715 Utah Trail 29 Palms Ca 92277



Utah Trail

Lucky Park

29 JHS
School

**M&O / Food Services
Facilities/ Transportation
Scale: 1" = 10'**



LEGEND	
	= Carpet and Base
	= Carpet Tile and Base
	= VCT and Base

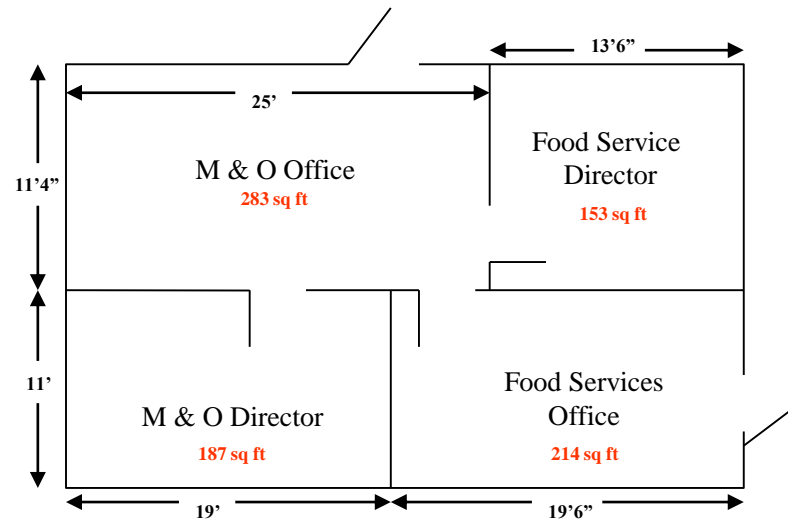
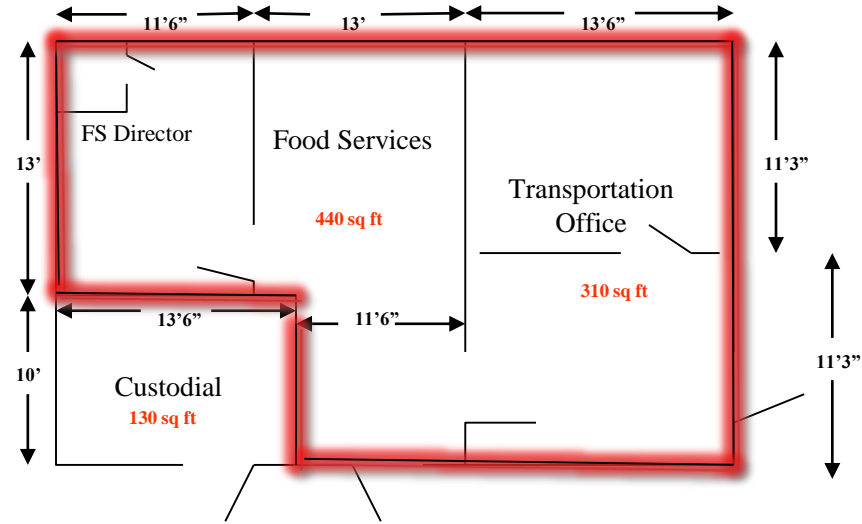

Condor Elementary School Site Plan

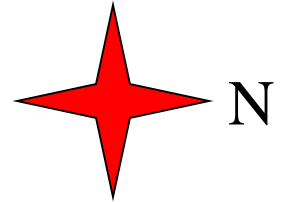

PRR

LEGEND	
	= Buildings Involved

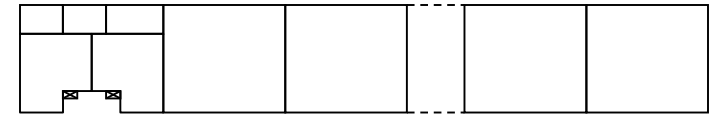
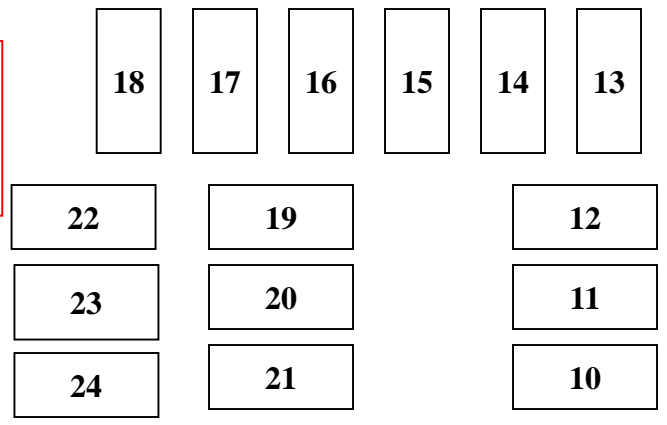

Building B

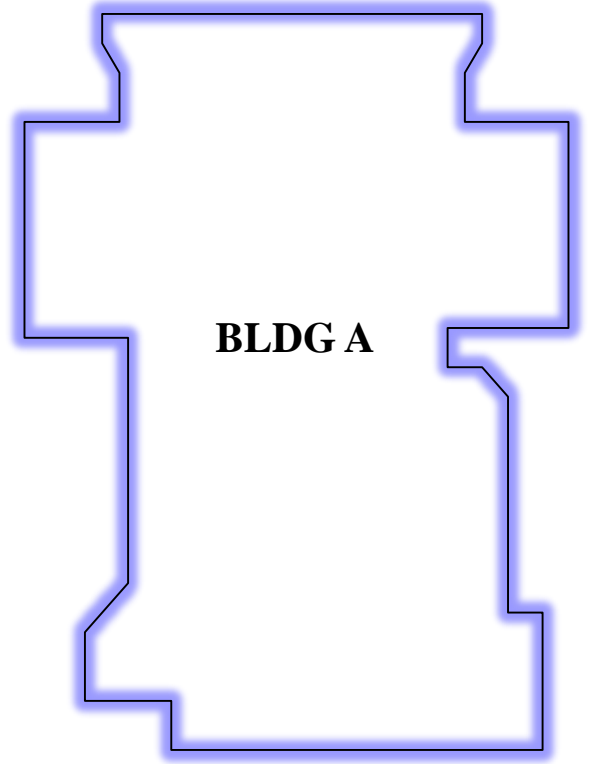

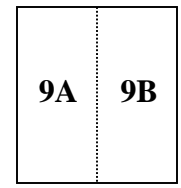
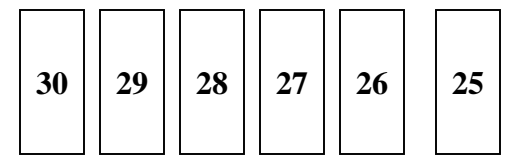

BLDG A



9A 9B

Condor Elementary School Building A Main Building *n.t.s.*

LEGEND	
	= Carpet and Base
	= Carpet Tile and Base
	= VCT and Base

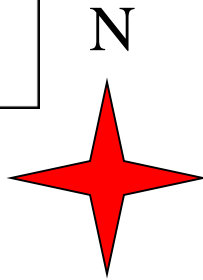

- | | |
|----------------------|-------------------------|
| 1 Reception | 21 Corridor/Gallery |
| 2 Nurse's Office | 22 Conference Room |
| 3 Nurse's Toilet | 23 Principal's Office |
| 4 Teacher's Lounge | 24 N/S Corridor |
| 5 | 25 Activity Center 2 |
| 6 Telephone Room | 26 Room 8 |
| 7 Mechanical Room | 27 Room 7 |
| 8 Electrical Room | 28 S Ext Custodial Room |
| 9 Women's Restroom | 29 Boy's RR AC 2 |
| 10 Men's Restroom | 30 Girl's RR AC 2 |
| 11 Custodial Office | 31 Room 6 |
| 12 RR Corridor | 32 Room 5 |
| 13 Room 9 (K-Room) | 33 Activity Center 1 |
| 14 K-Boy's Restroom | 34 Room 4 |
| 15 K-Girl's Restroom | 35 Room 3 |
| 16 Storage | 36 Girl's RR AC 1 |
| 17 MPR | 37 Boy's RR AC 1 |
| 18 Kitchen | 38 N Ext Storage |
| 19 Kitchen Storage | 39 Room 2 |
| 20 Library | 40 Room 1 |

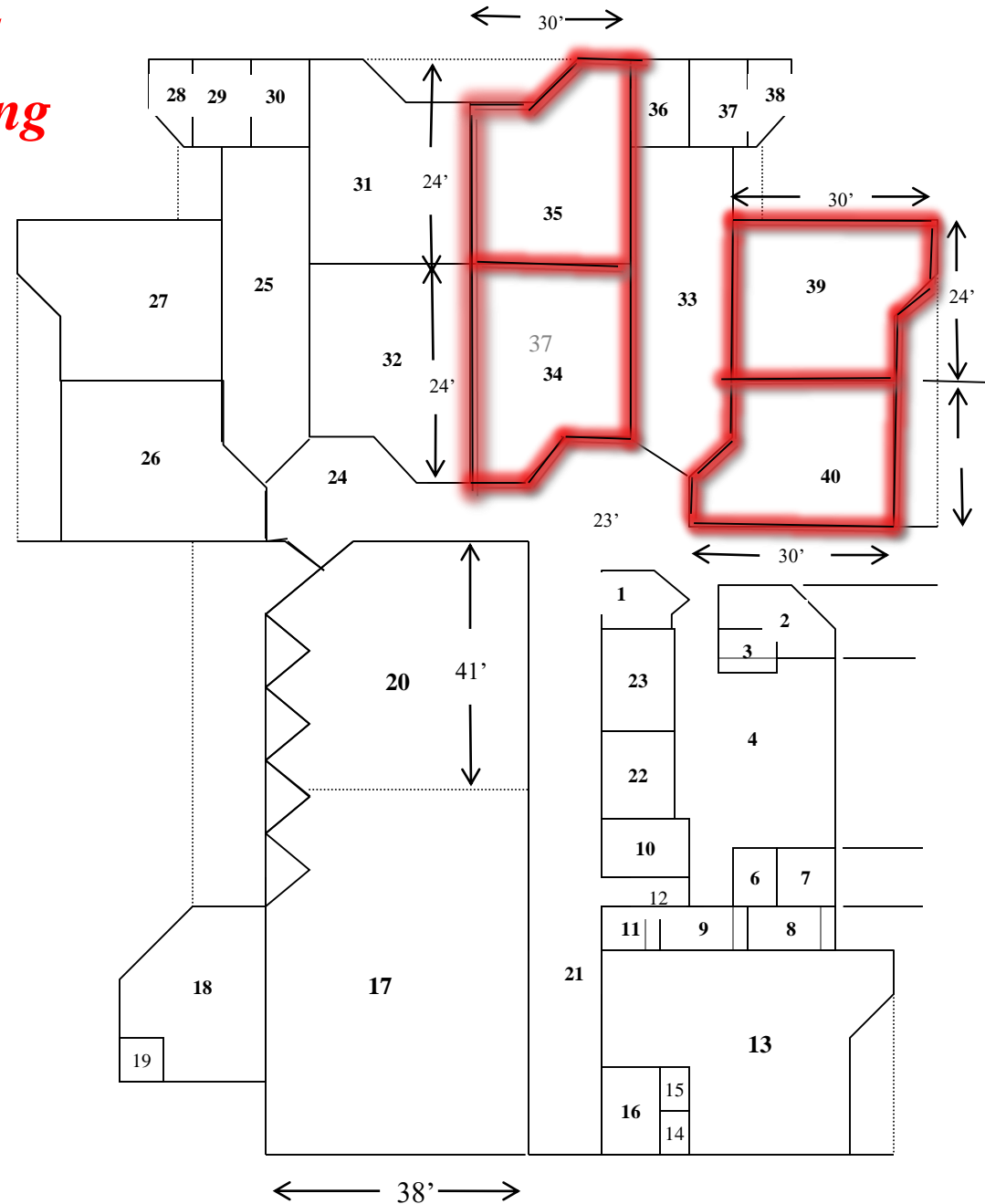



Oasis Elementary School Site Plan

Drawn by Glenn R. Addis

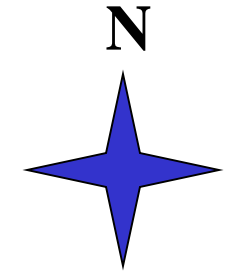
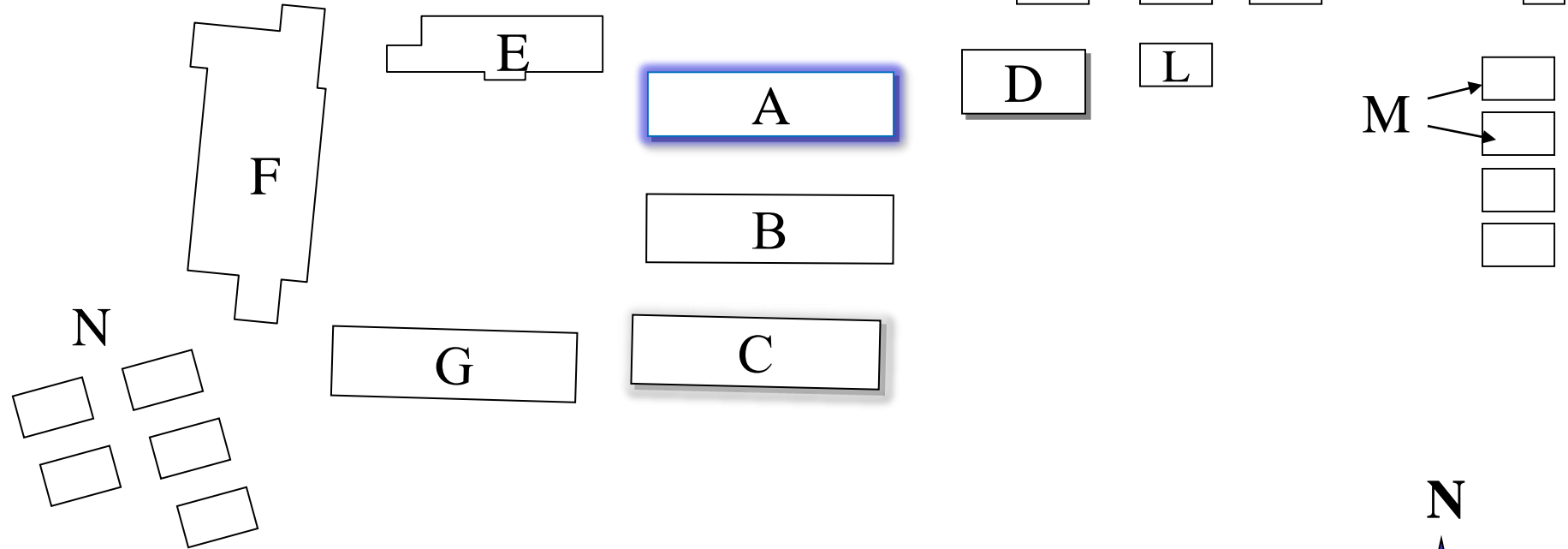
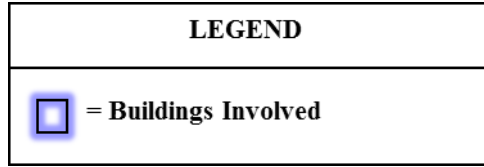
(n.l.s.)



*Oasis Elementary School
Building A Wing 1
n.t.s.*

LEGEND	
	= Carpet and Base
	= Carpet Tile and Base
	= Linoleum

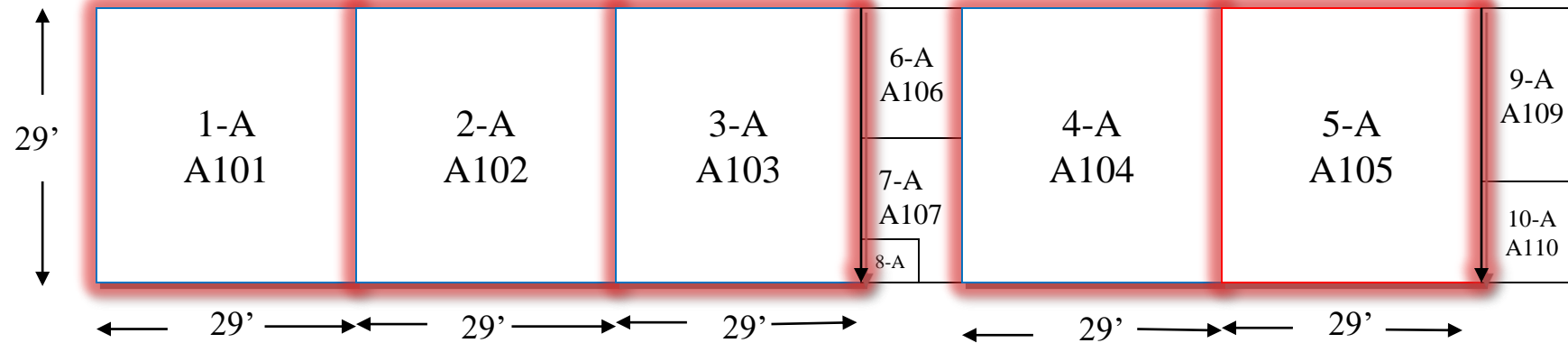
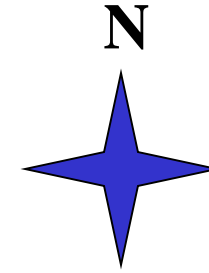

<u>Orig Const #</u>	<u>New Const #</u>	<u>Current Designation</u>
1-A	A101	Room 1
2-A	A102	Room 2
3-A	A103	Room 3
4-A	A104	Room 4
5-A	A105	Room 5
6-A	A106	Electrical/Signal Room
7-A	A107	Boy's Restroom
8-A	A108	Custodial
9-A	A109	Book Storage
10-A	A110	Girl's Restroom

Friendly Hills Elementary School Site Plan



LEGEND

 = Buildings Involved

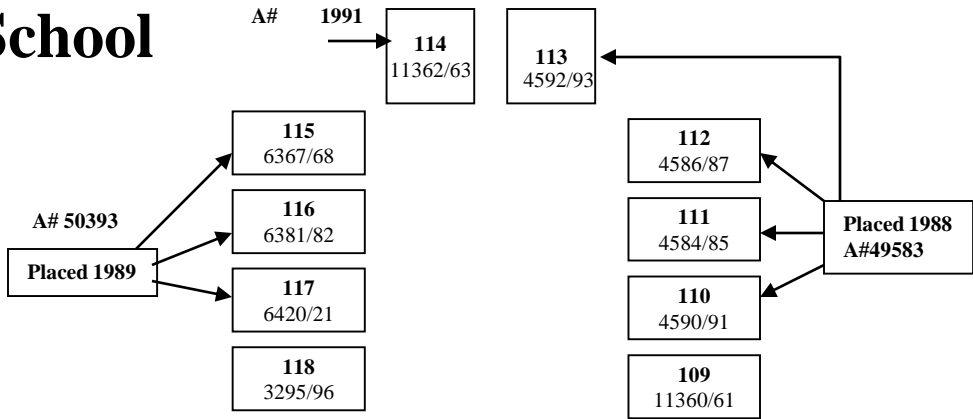

PRR
1993

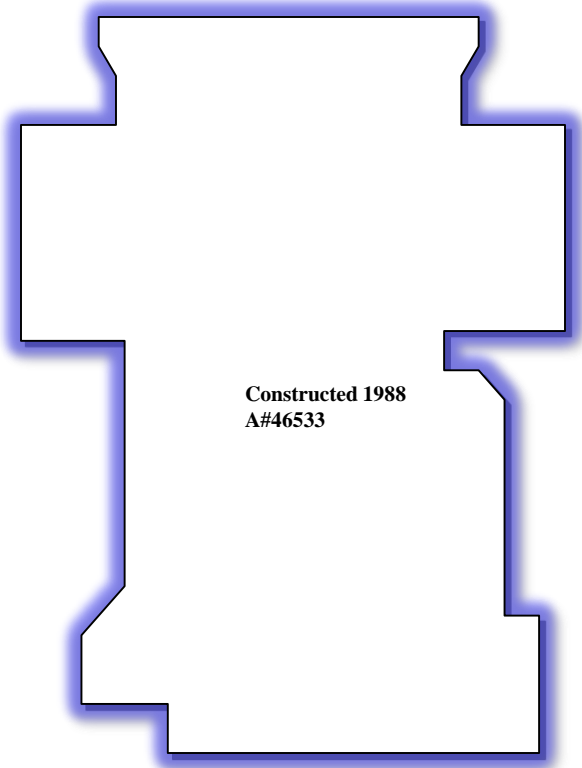

PRR

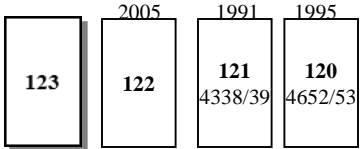

Friendly Hills Elementary School Building A Main Building

Drawn by Glenn R. Addis

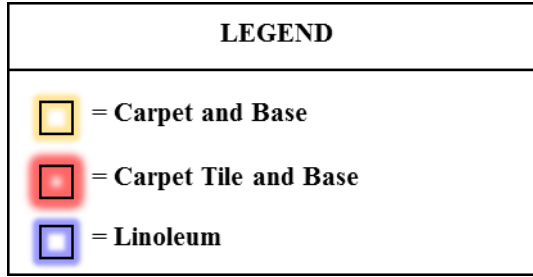

- | | |
|----------------------|-------------------------|
| 1 Reception | 21 Corridor/Gallery |
| 2 Nurse's Office | 22 Conference Room |
| 3 Nurse's Toilet | 23 Principal's Office |
| 4 Teacher's Workroom | 24 E/W Corridor |
| 5 Teacher Lounge | 25 Activity Center 2 |
| 6 Telephone Room | 26 Room 6 |
| 7 Mechanical Room | 27 Room 8 |
| 8 Electrical Room | 28 W Ext Custodial Room |
| 9 Women's Restroom | 29 Boy's RR AC 2 |
| 10 Men's Restroom | 30 Girl's RR AC 2 |
| 11 Custodial Office | 31 Room 7 |
| 12 RR Corridor | 32 Room 5 |
| 13 Room 9 (K-Room) | 33 Activity Center 1 |
| 14 K-Boy's Restroom | 34 Room 2 |
| 15 K-Girl's Restroom | 35 Room 4 |
| 16 K-Storage | 36 Girl's RR AC 1 |
| 17 MPR | 37 Boy's RR AC 1 |
| 18 Kitchen | 38 E Ext Storage |
| 19 Kitchen Storage | 39 Room 3 |
| 20 Library | 40 Room 1 |

(n.t.s.)

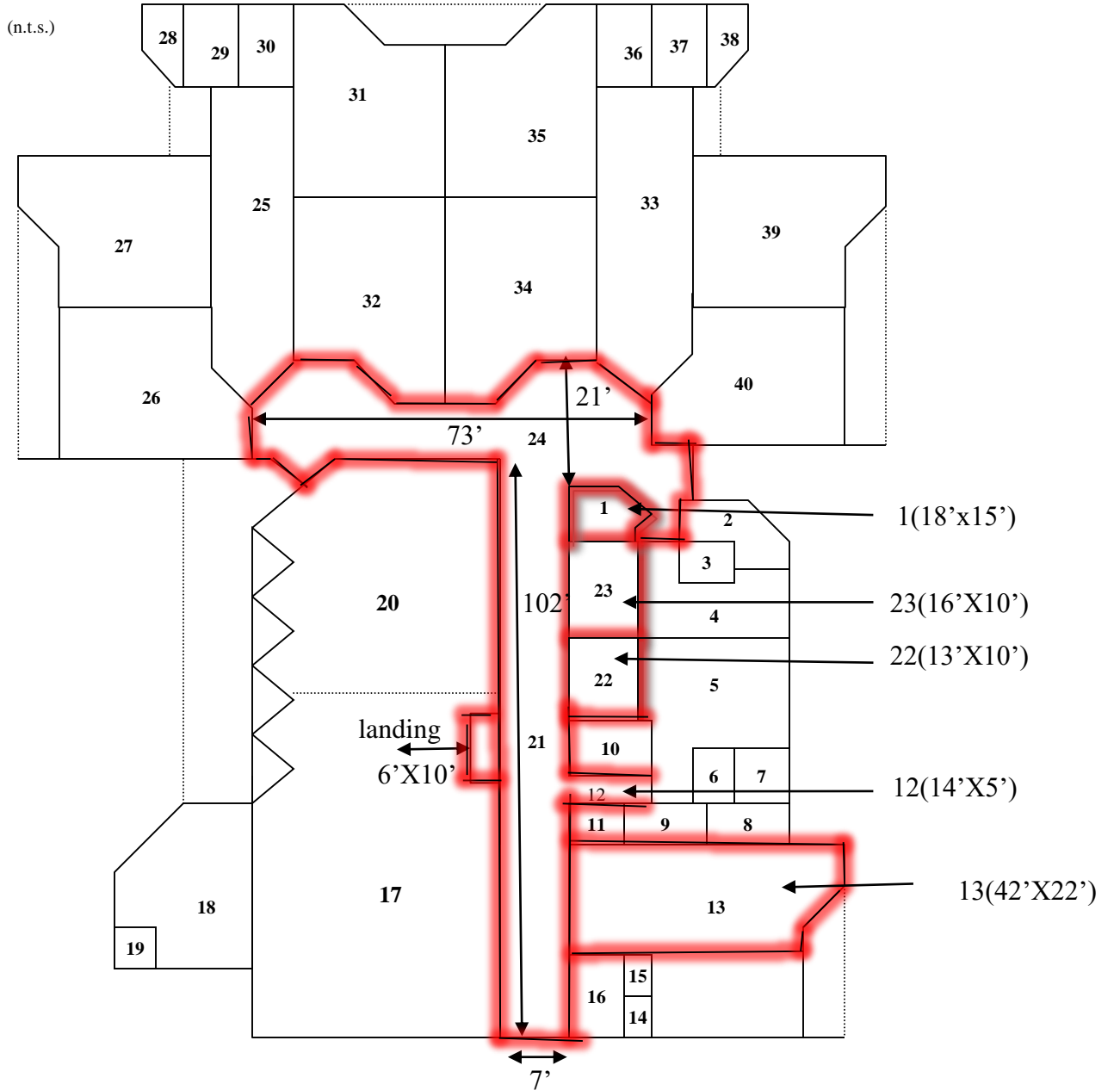

Friendly Hills Elementary School

Portable Buildings Rooms 109-118

Drawn by Glenn R. Addis

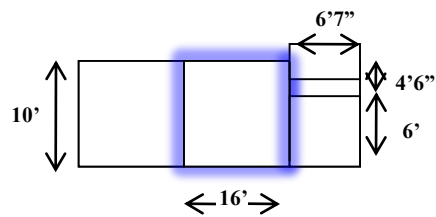
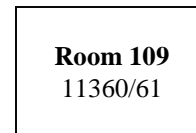
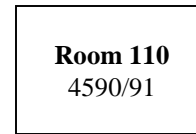
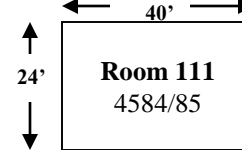
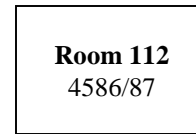
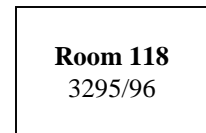
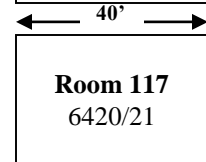
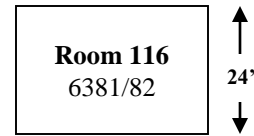
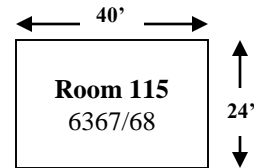
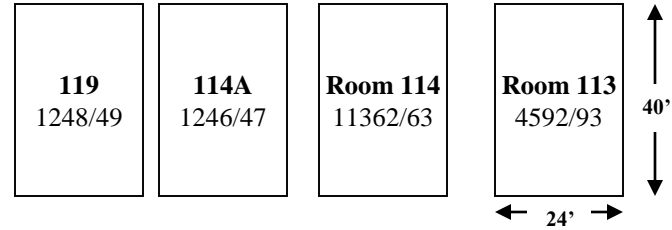

LEGEND	
	= Carpet and Base
	= Carpet Tile and Base
	= Linoleum

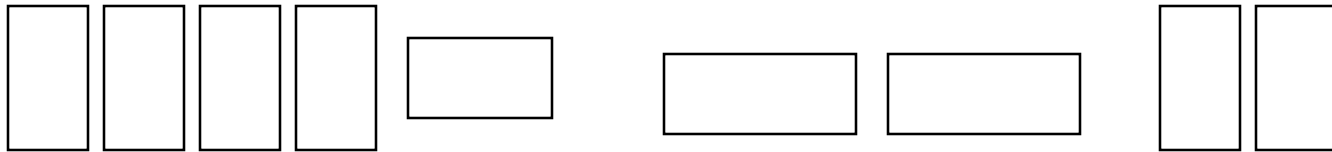

LEGEND	
	= Buildings Involved

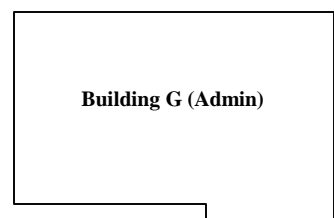
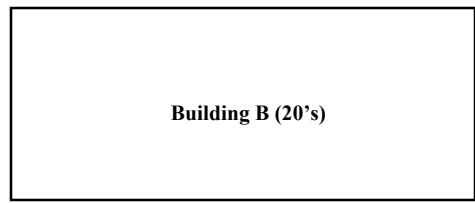
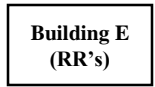
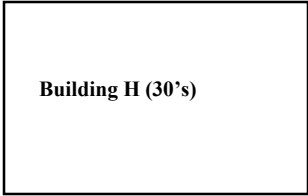
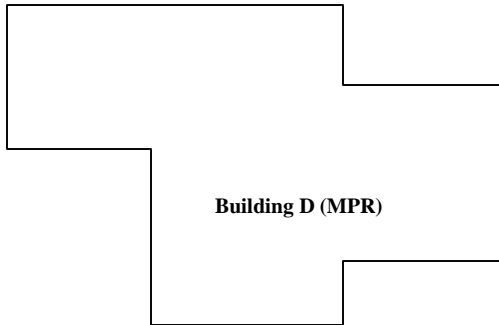
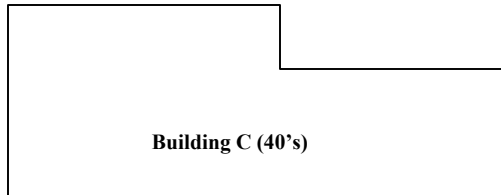
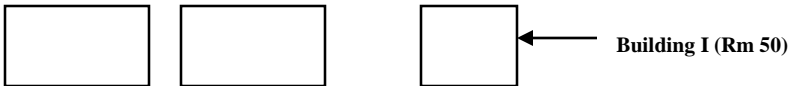

La Contenta Middle School Site Plan

Drawn by Glenn R. Addis

(n.t.s.)



La Contenta Middle School

Building F

Drawn by Glenn R. Addis

Library

(n.t.s.)

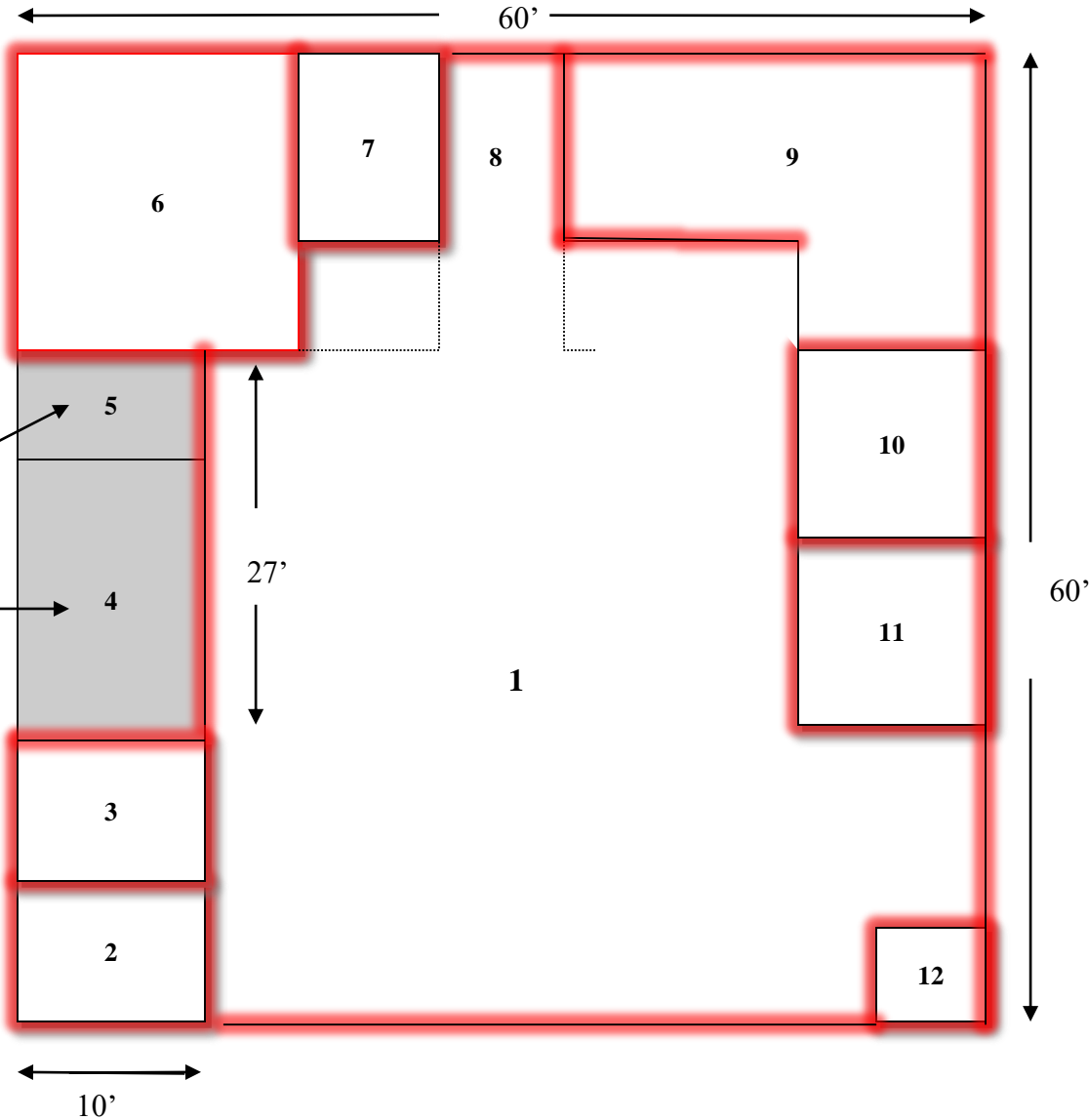

LEGEND	
	= Carpet and Base
	= Carpet Tile and Base
	= Linoleum

VCT TO REMAIN

- 1 Main Library
- 2 South Computer Rm
- 3 North Computer Rm
- 4 South Storage
- 5 North Storage
- 6 Work Room
- 7 Library Office
- 8 entry
- 9 Room 1 Computer Lab
- 10 North Conference/Office
- 11 South Conference/Office

Monument Continuation High School Building A Main Building n.t.s.

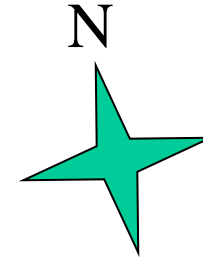

LEGEND	
	RESILIENT TILE

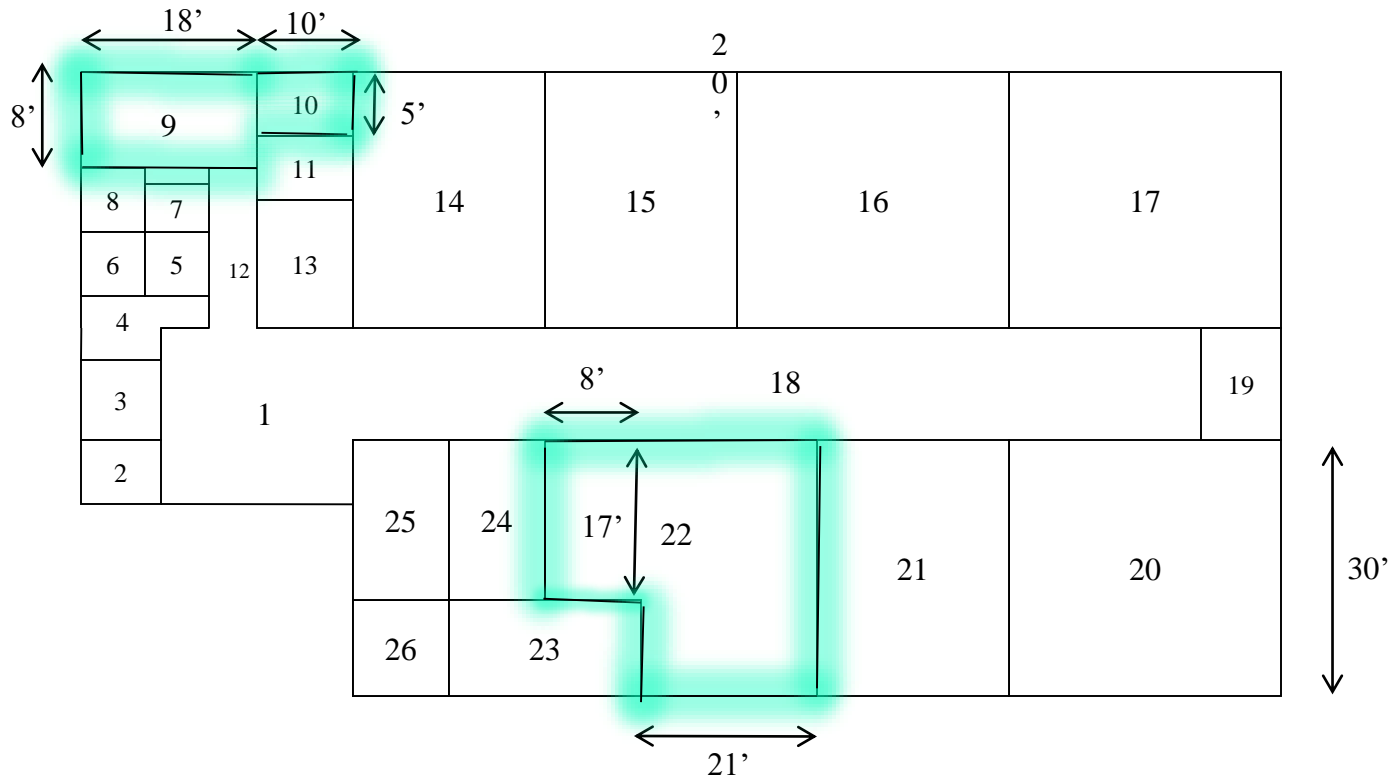

- 1 Reception
- 2 Mechanical Room
- 3 Storage (reception)
- 4 Cot Room
- 5 Shower
- 6 Cot Room Toilet
- 7 Custodial Closet
- 8 Work Room Toilet
- 9 Work Room
- 10 Storage (work room)
- 11 Counseling Office
- 12 Corridor
- 13 Principal's Office
- 14 Room 101
- 15 Room 103
- 16 Room 105
- 17 Room 107
- 18 Main Corridor
- 19 East Vestibule
- 20 Room 106
- 21 Room 104
- 22 Room 102
- 23 Utility Room (102)
- 24 Girl's Restroom
- 25 Boy's Restroom
- 26 Electrical Room

Morongo Valley Elementary School Site Plan

LEGEND	
	= Buildings Involved

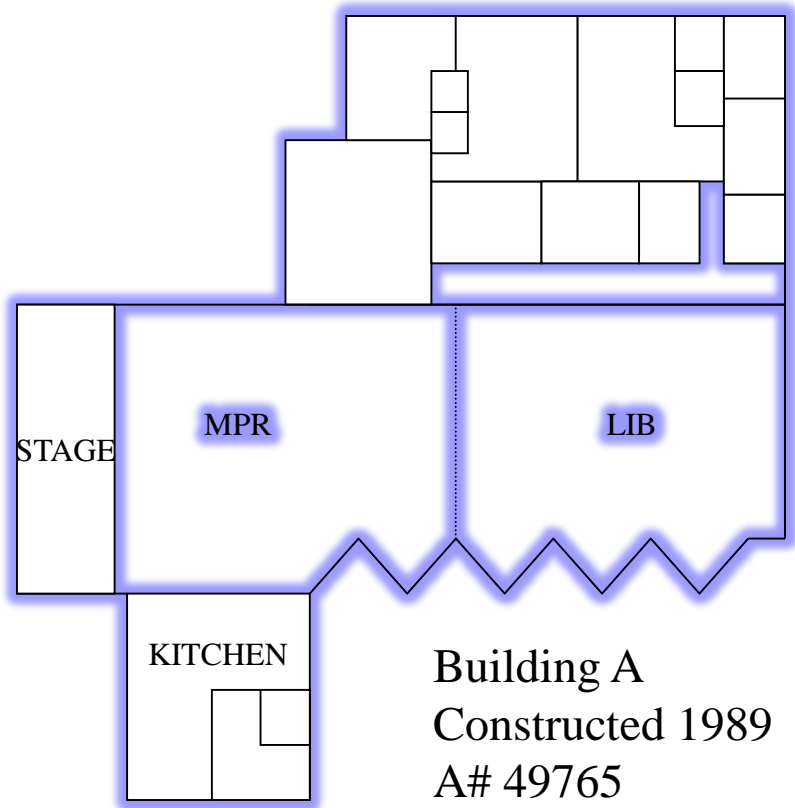
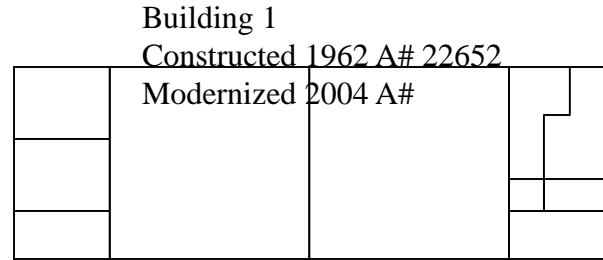

Building A
Constructed 1989
A# 49765

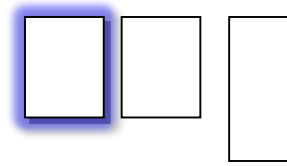

Building 3
Relocated During Constructing 1989
A# 49765

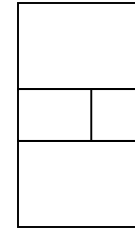

Building 2
Constructed 1967
A# 28017

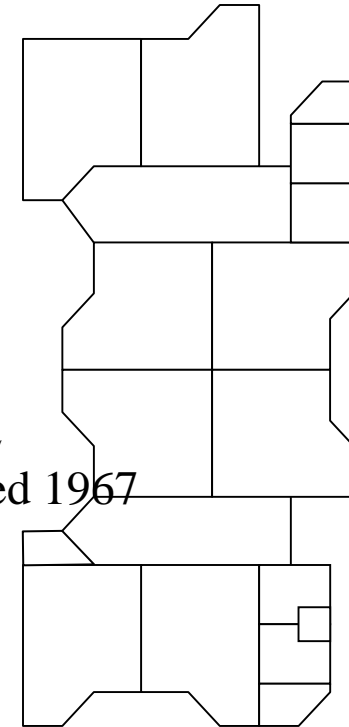



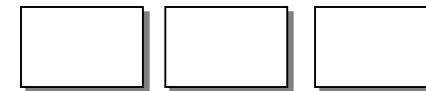

Building B
Constructed 1989
A# 49765

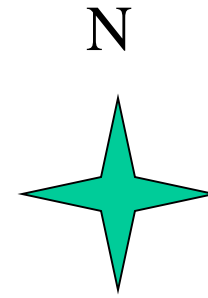

Building C
Constructed 1989

Morongo Valley Elementary School Building A Admin/Library/MPR n.t.s.





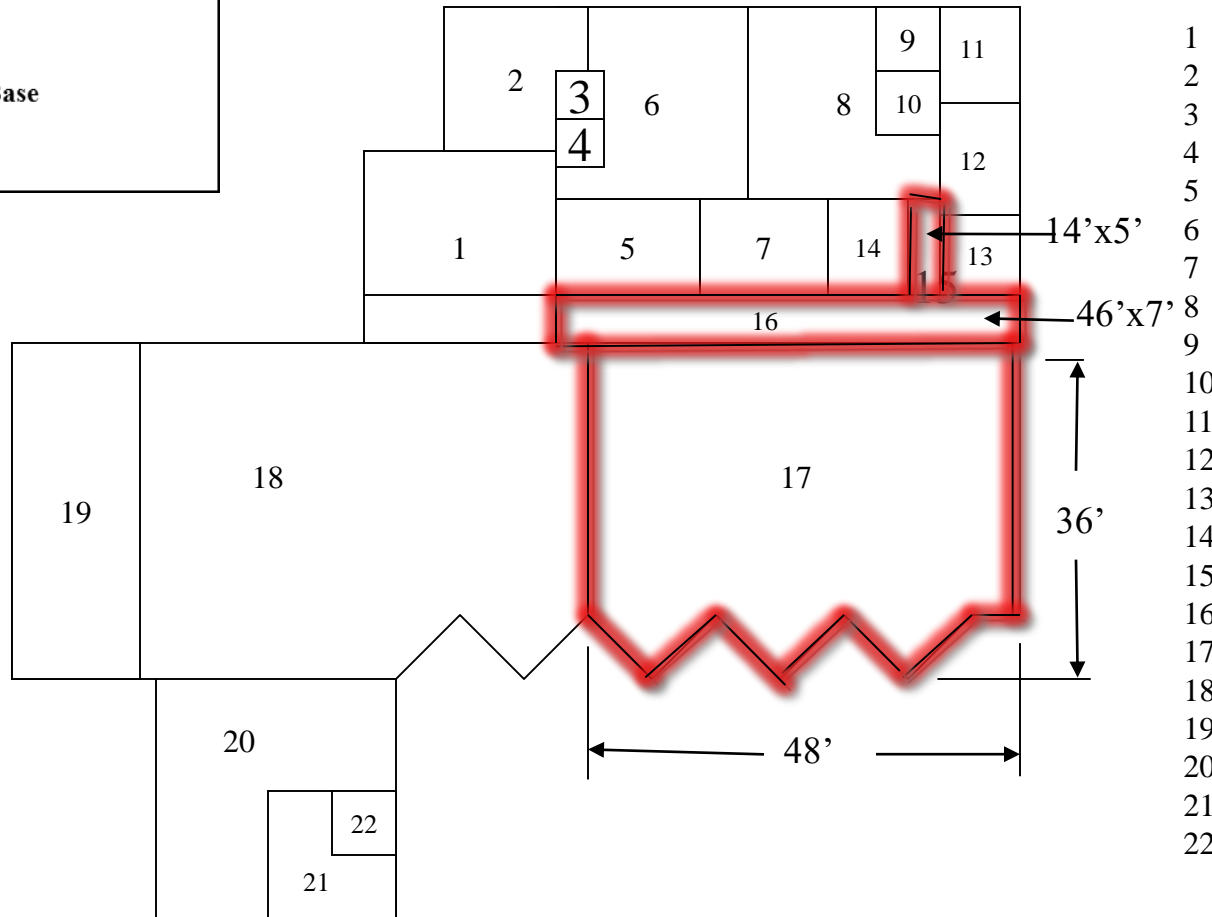

LEGEND	
	= Carpet and Base
	= Carpet Tile and Base
	= Linoleum

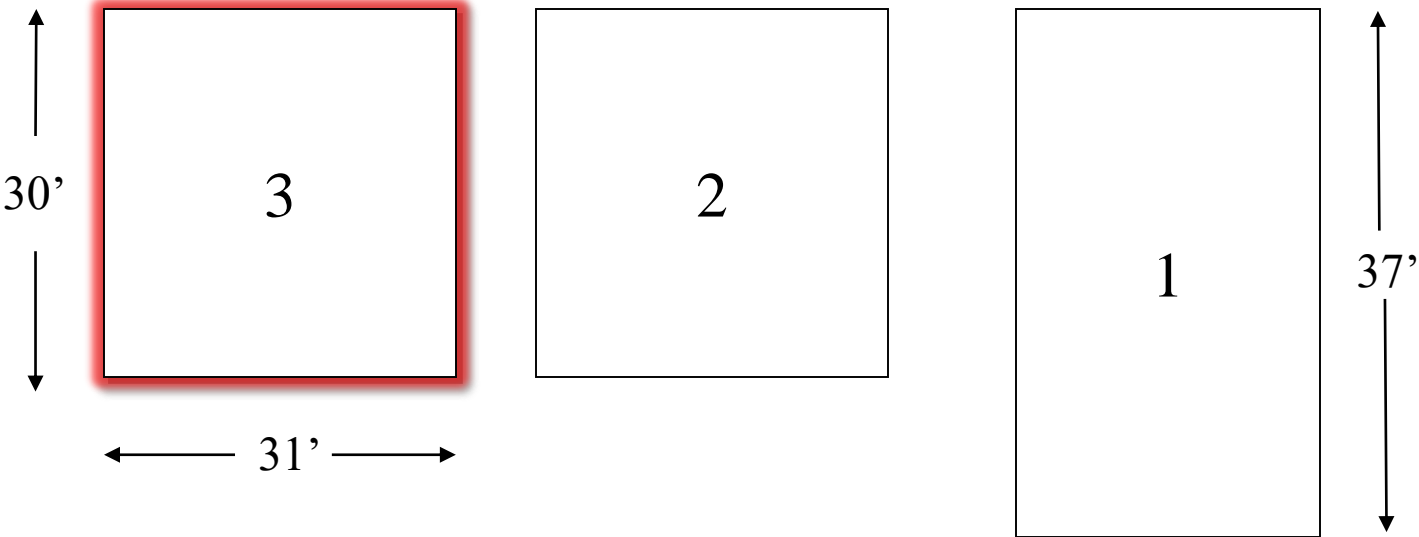
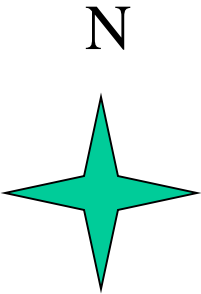

- 1 Reception
- 2 Nurses Office
- 3 Nurses Toilet
- 4 Custodial Closet (workroom)
- 5 Principal's Office
- 6 Work Room
- 7 Principal Conference Room
- 8 Teacher's Lounge
- 9 Water Heater Closet
- 10 Teacher Telephone
- 11 Electrical Room
- 12 Women's Restroom
- 13 Storage (across Men's RR)
- 14 Men's Restroom
- 15 Restroom Hallway
- 16 Corridor/Gallery
- 17 Library
- 18 MPR
- 19 Stage
- 20 Kitchen
- 21 Kitchen Storage
- 22 Exterior Custodial Closet

Morongo Valley Elementary School
 Building Unit 3 Relocatables
 Classrooms 112-114 n.t.s.



LEGEND	
	= Carpet and Base
	= Carpet Tile and Base
	= Linoleum

- 1 Room 112
- 2 Room 113
- 3 Room 114

Twentynine Palms Elementary School

Drawn by Glenn R. Addis



LEGEND	
	= Buildings Involved

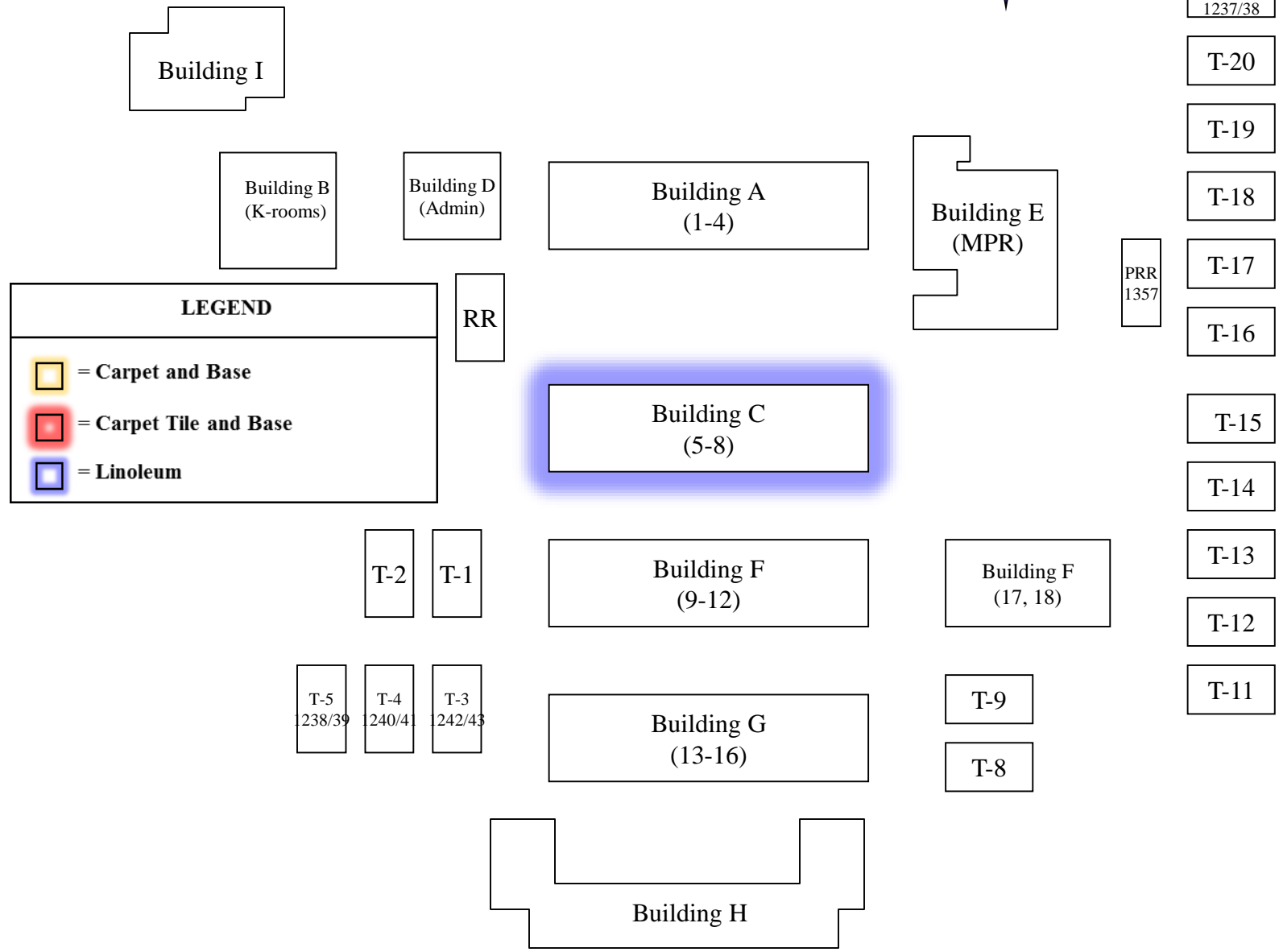

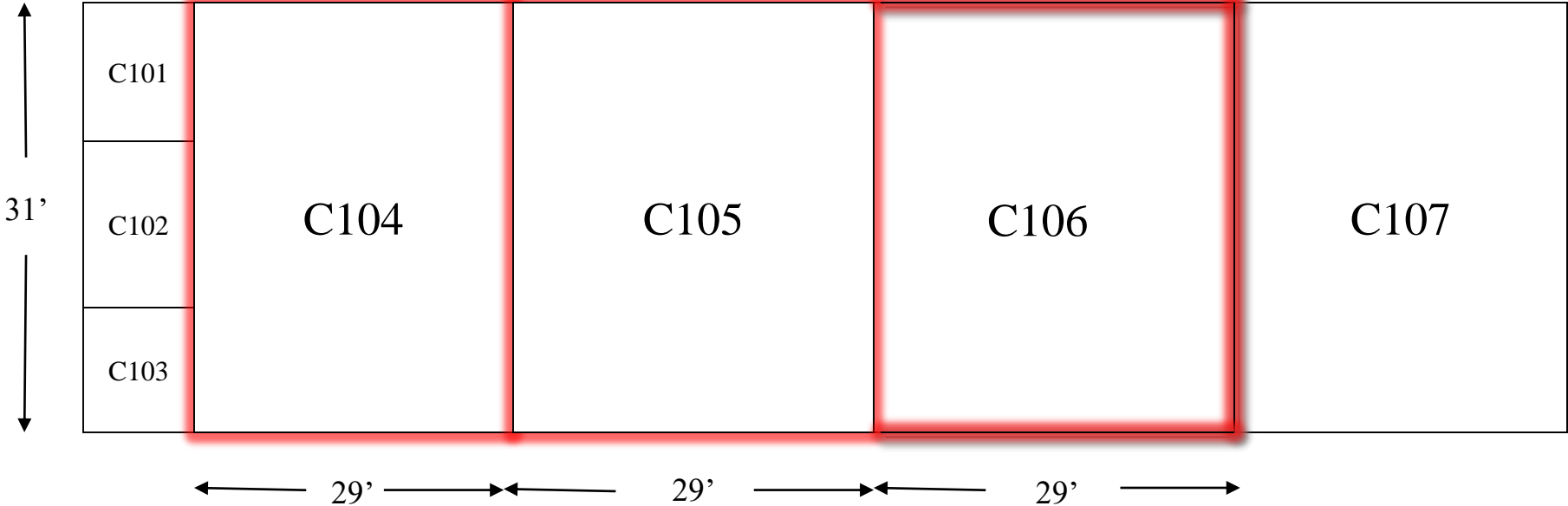
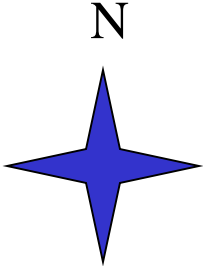

Twentynine Palms Elementary School

Building C Wing 2 Classrooms



- C101 Electronics Closet
- C102 Storage
- C103 Custodial
- C104 Room 5
- C105 Room 6
- C106 Room 7
- C107 Room 8

LEGEND	
	= Carpet and Base
	= Carpet Tile and Base
	= Linoleum

Palm Vista Elementary School

Site Plan

Drawn by Glenn R. Addis

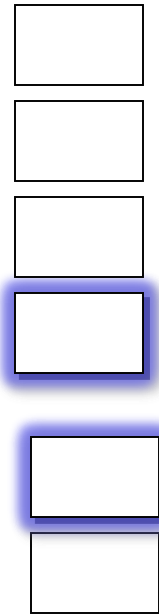
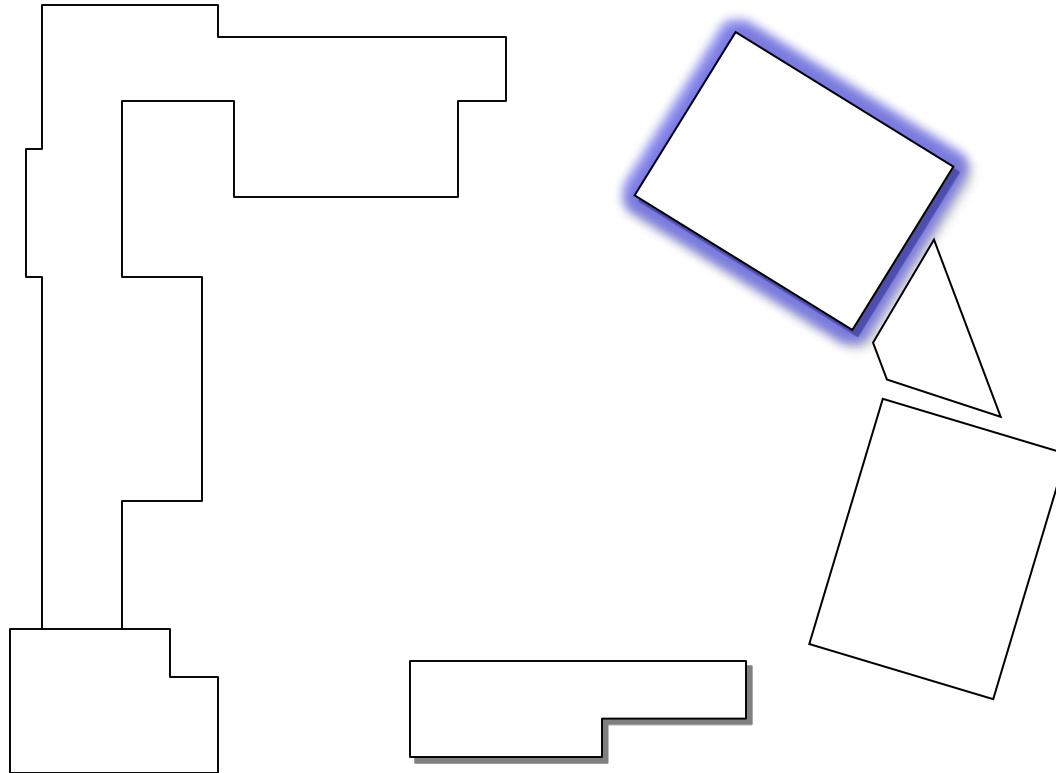

(n.t.s.)

LEGEND	
	= Buildings Involved

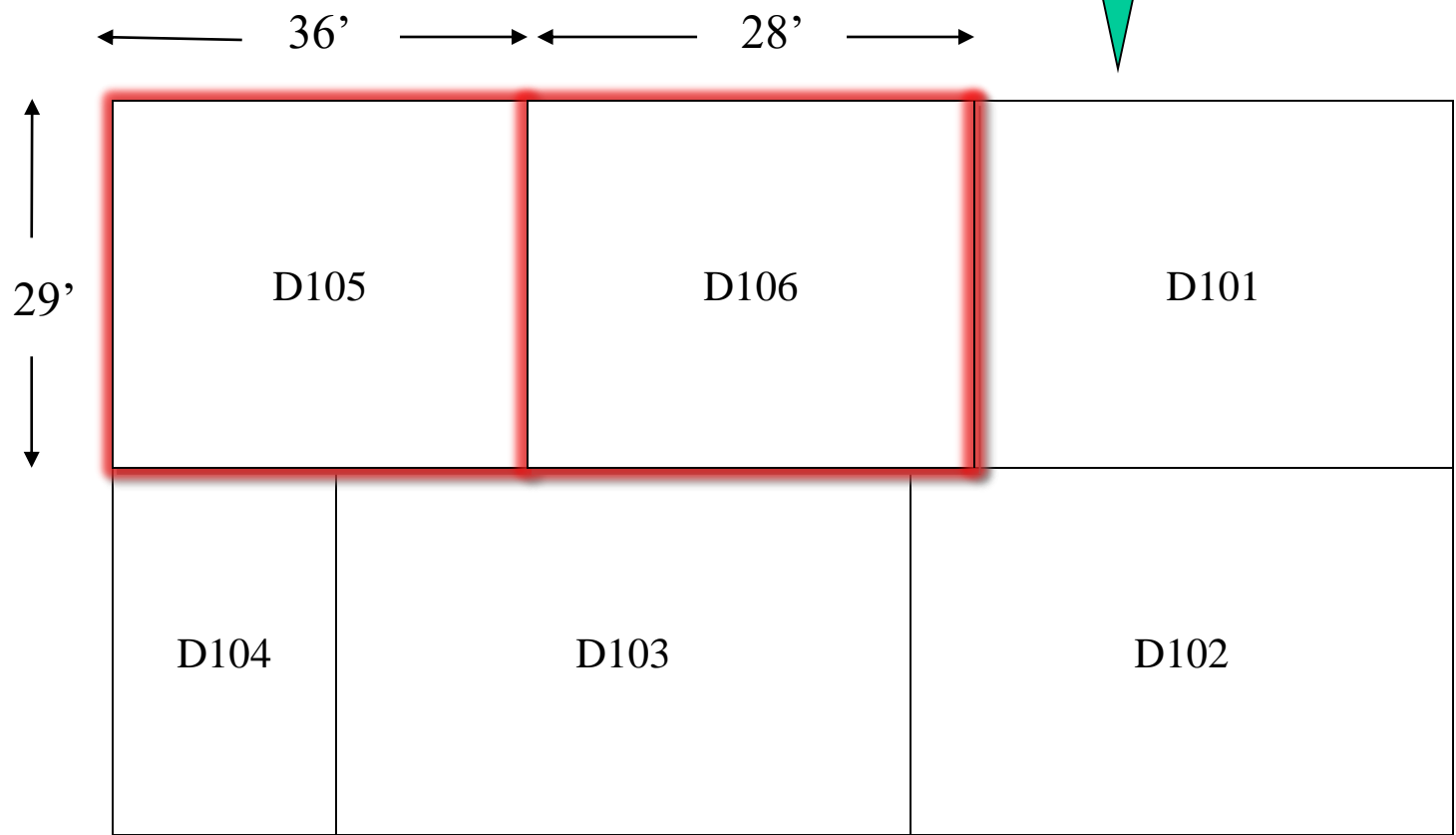
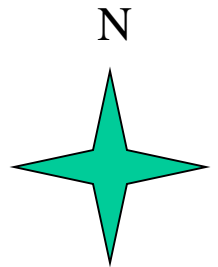

Palm Vista Elementary School
 Building D North Classrooms
 n.t.s.





LEGEND	
	= Carpet and Base
	= Carpet Tile and Base
	= Linoleum

D101	Room 110	D104	Teacher Workroom
D102	Room 106	D105	Room 108
D103	Room 107	D106	Room 109

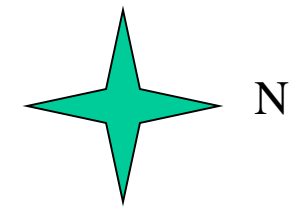
Palm Vista Elementary School
Buildings G & J Relocatables
n.t.s



- 4403/04 P1
- 4405/06 P2
- 5886/87 P3
- 3618/19 P4
- 3617/20 P5
- P6

LEGEND	
	= Carpet and Base
	= Carpet Tile and Base
	= Linoleum

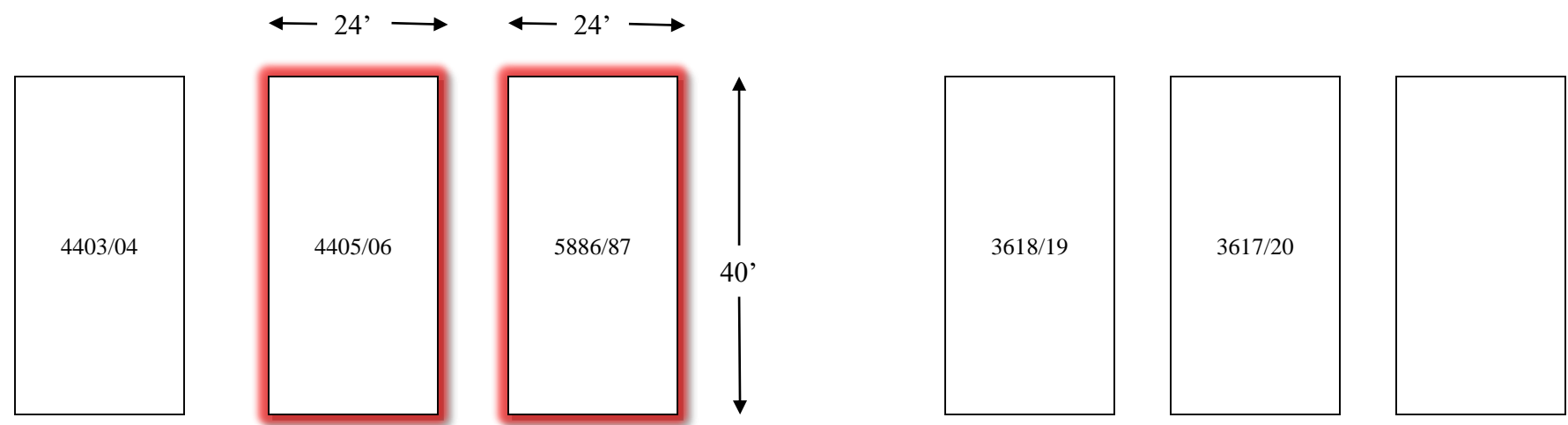

Twentynine Palms Junior High School Site Plan

Drawn by Glenn R. Addis (n.t.s.)

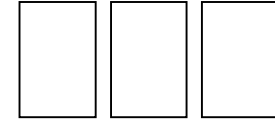
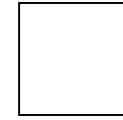

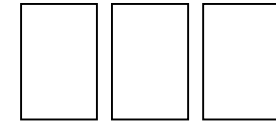
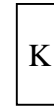
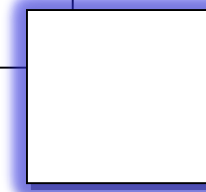
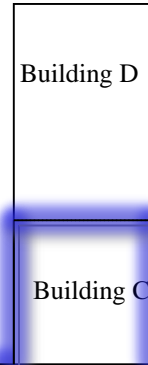
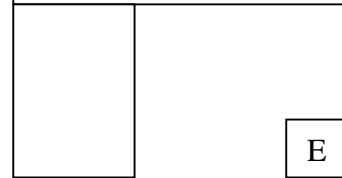
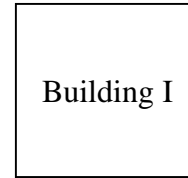
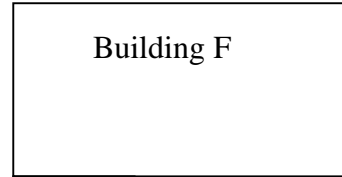
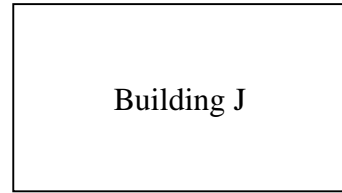

M Buildings

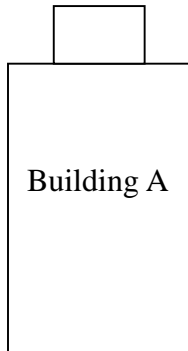
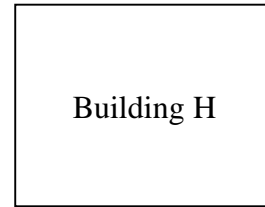
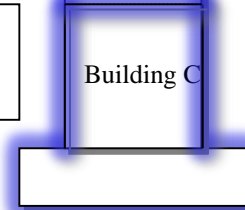

L Buildings



Twentynine Palms Junior High School Building C Administration Building

LEGEND	
	= Carpet and Base
	= Carpet Tile and Base
	= Linoleum

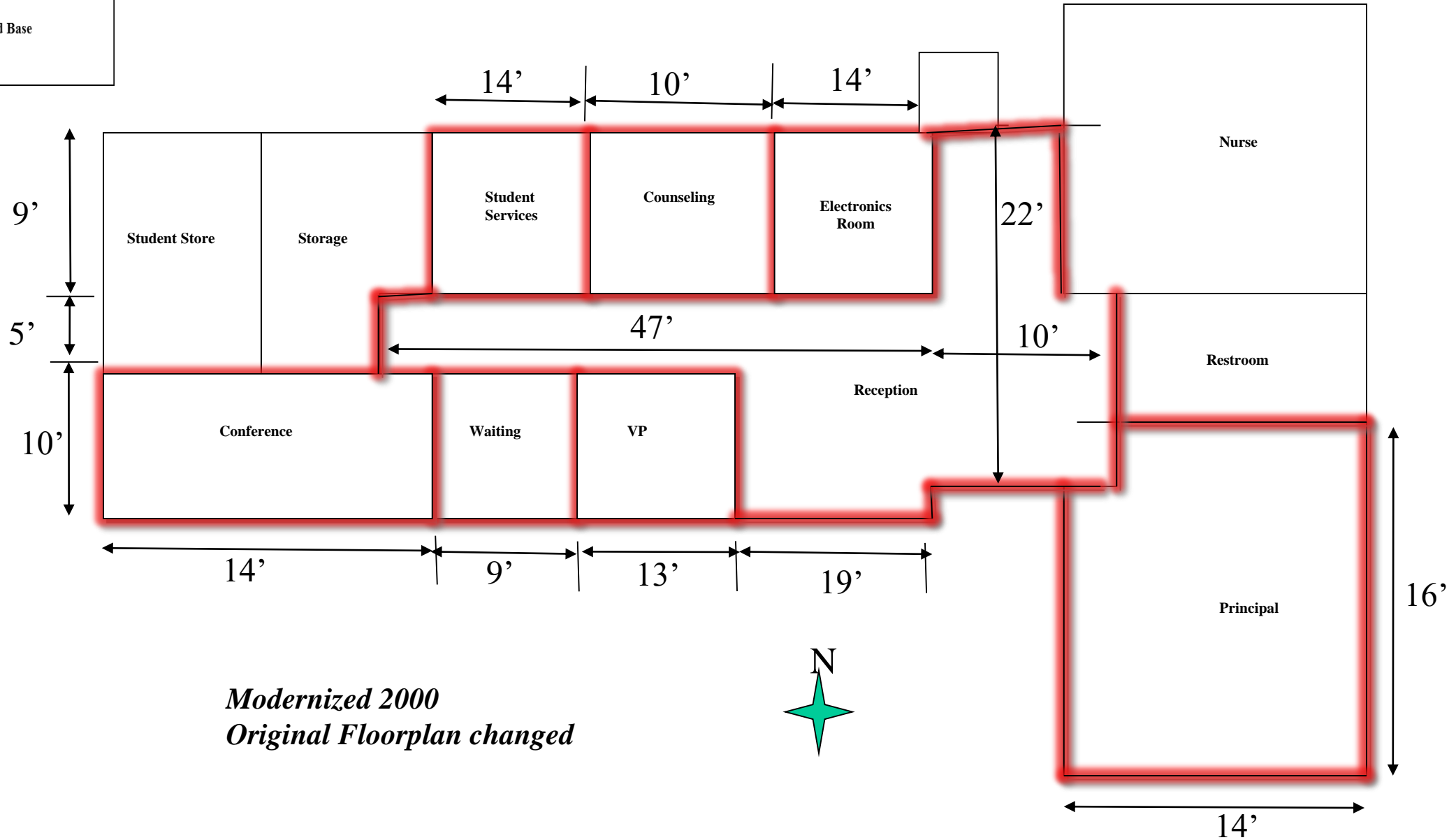

*Modernized 2000
Original Floorplan changed*



Twentynine Palms Junior High School
 Building G Art Room and Tech Lab

LEGEND	
	RESILIENT TILE

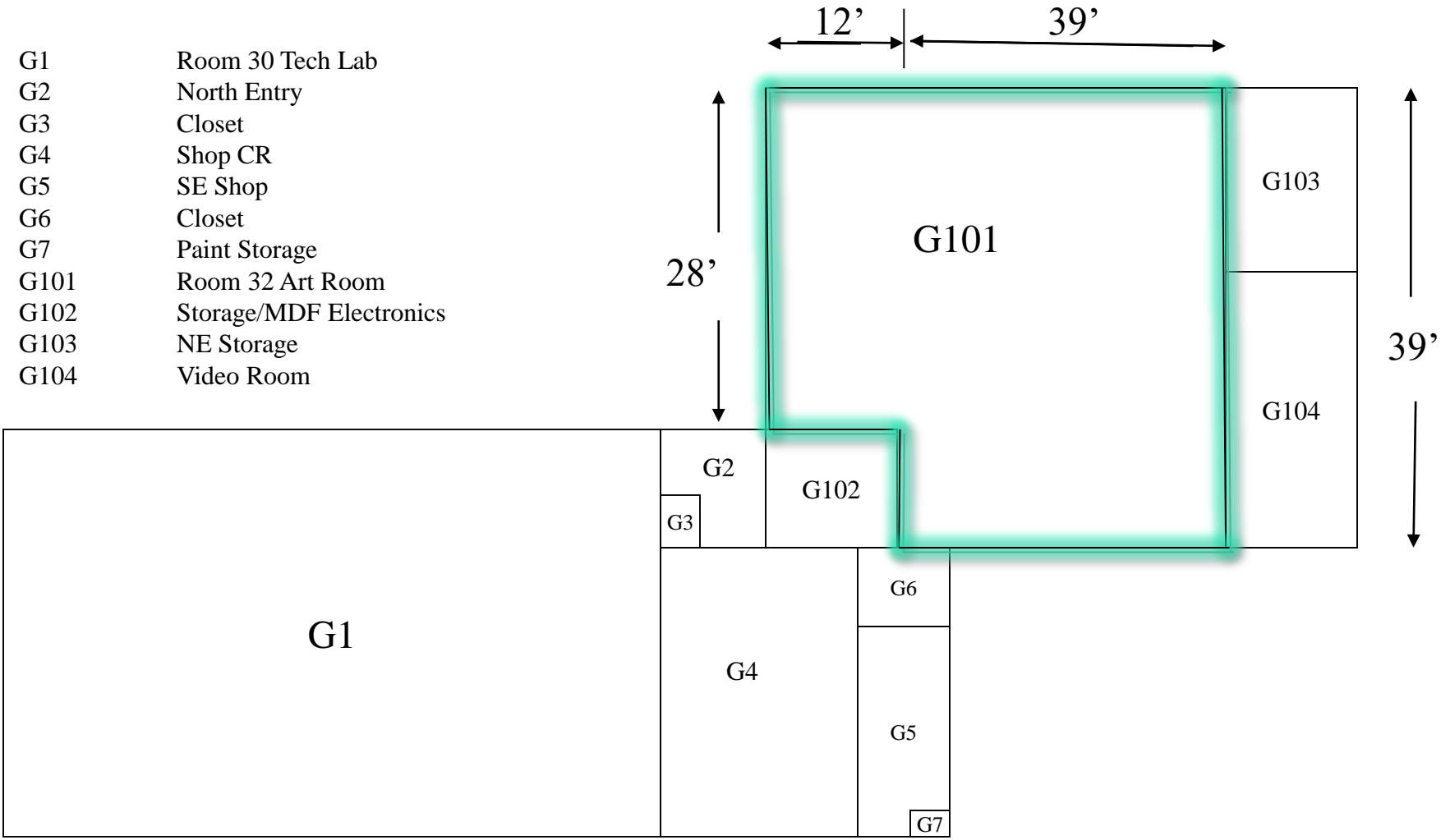
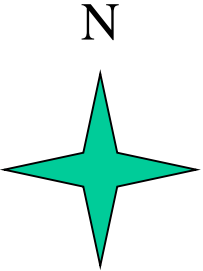

- G1 Room 30 Tech Lab
- G2 North Entry
- G3 Closet
- G4 Shop CR
- G5 SE Shop
- G6 Closet
- G7 Paint Storage
- G101 Room 32 Art Room
- G102 Storage/MDF Electronics
- G103 NE Storage
- G104 Video Room



Yucca Valley Elementary School Site Plan

Drawn by Glenn R. Addis

LEGEND	
	= Buildings Involved

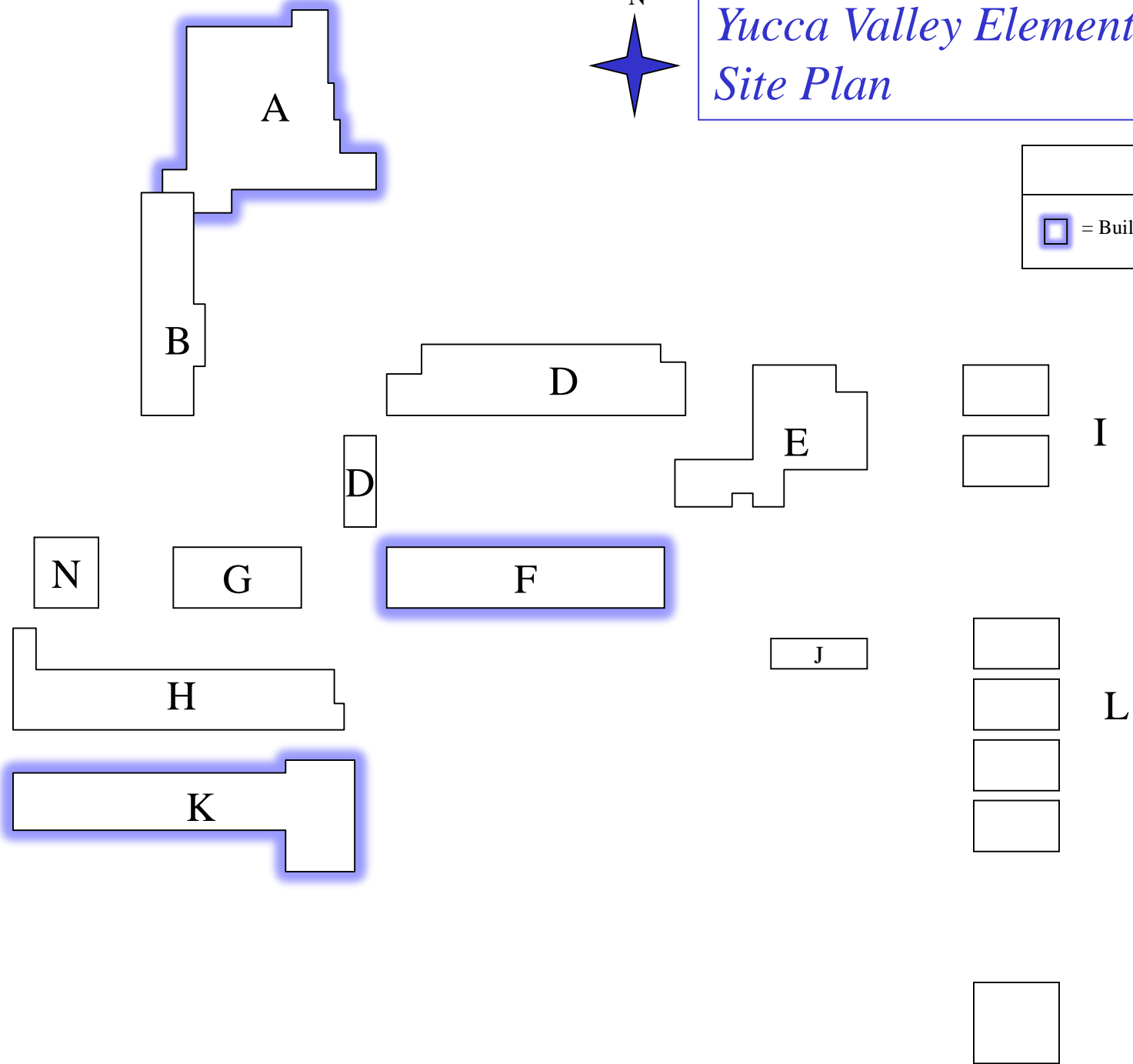

Yucca Valley Elementary School Building A MPR/Kitchen

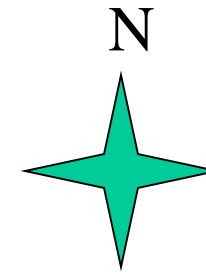

LEGEND	
	EPOXY FLOORING

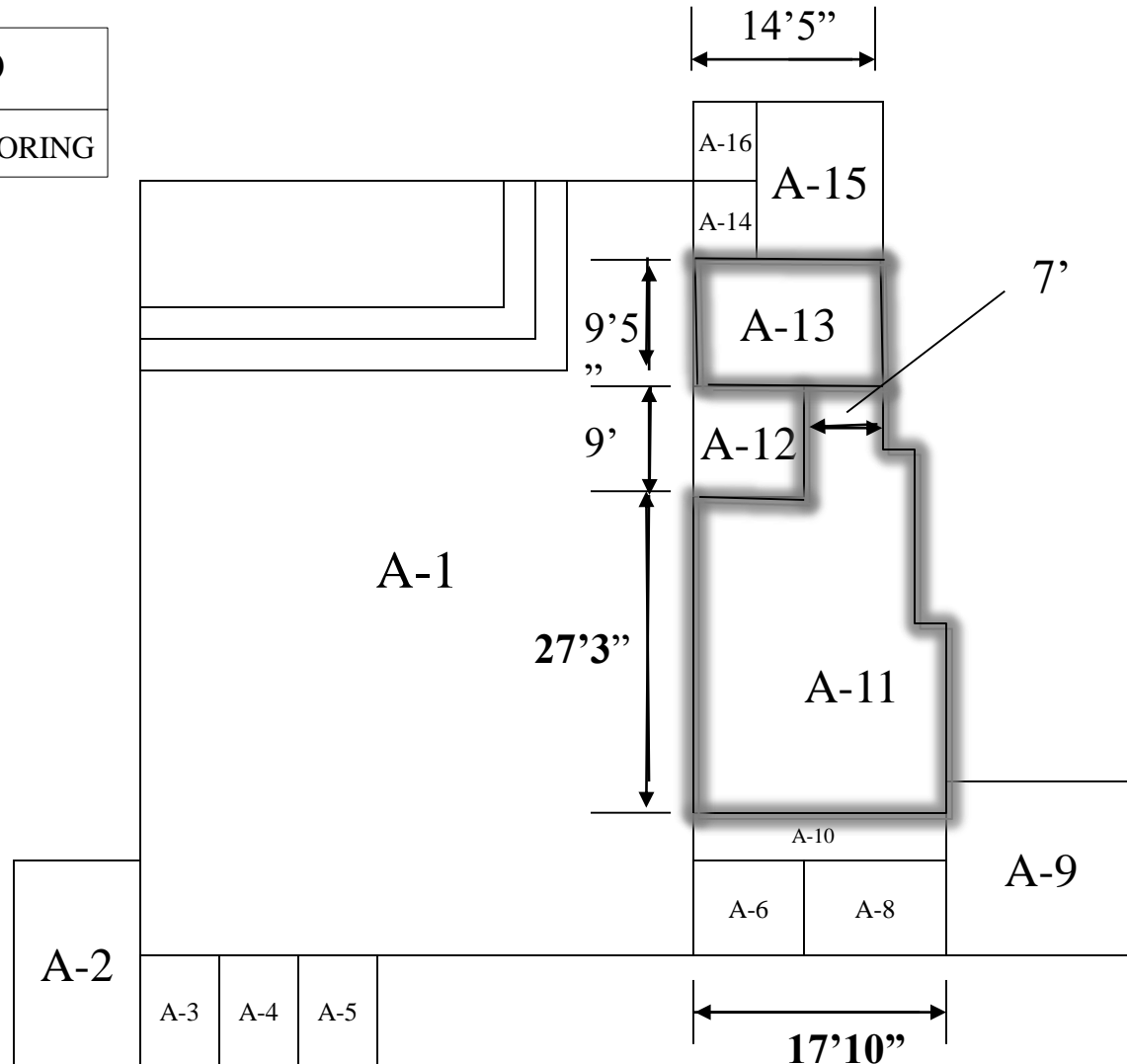

- A-1 MPR
- A-2 Remedial Instruction
- A-3 Custodial Room
- A-4 Women's Exterior Restroom
- A-5 Men's Exterior Restroom
- A-6 Kitchen Office
- A-7 Conf Closet (Deleted)
- A-8 Unisex Restroom
- A-9 Conference Room
- A-10 Corridor
- A-11 Kitchen
- A-12 Walk-in Freezer
- A-13 Kitchen Storage
- A-14 NE MPR Storage
- A-15 Mechanical/Electrical Room
- A-16 Water Heater Closet



Yucca Valley Elementary School

Building F & G

Wing 2 (Rms 5-10)

Drawn by Glenn R. Addis



LEGEND	
	= Carpet and Base
	= Carpet Tile and Base
	= VCT and Base

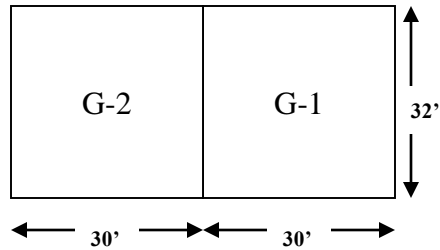



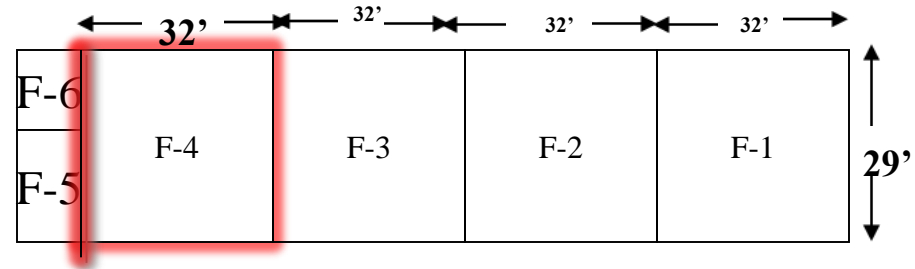

G-1 Room 9
G-2 Room 10

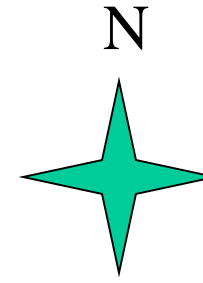

F-1 Room 5
F-2 Room 6
F-3 Room 7
F-4 Room 8
F-5 Storage
F-6 Custodial

Yucca Valley Elementary School Building K Upper Wing n.t.s.



LEGEND	
	= Carpet and Base
	= Carpet Tile and Base
	= VCT and Base

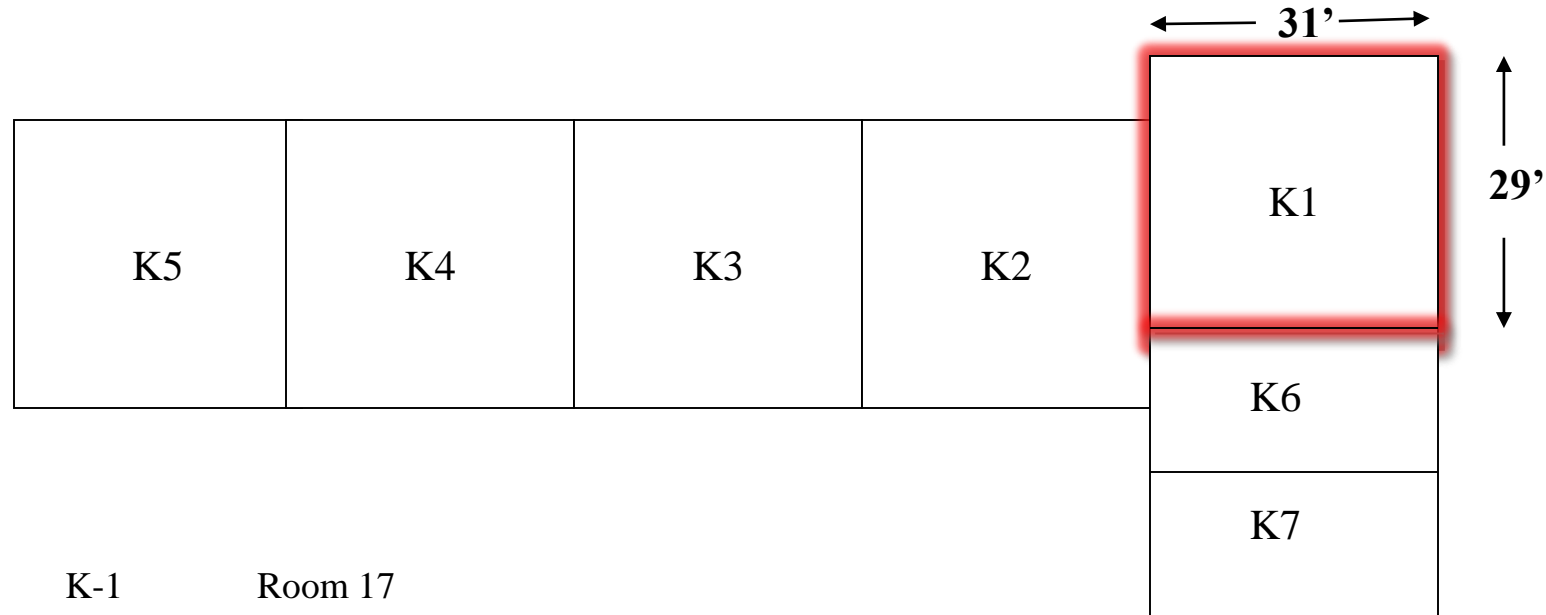

K-1	Room 17
K-2	Room 18
K-3	Room 19
K-4	Room 20
K-5	Room 21
K-6	Room 30
K-7	Room 31

Portable
Classroom
L-18

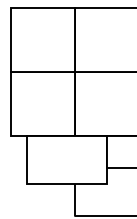
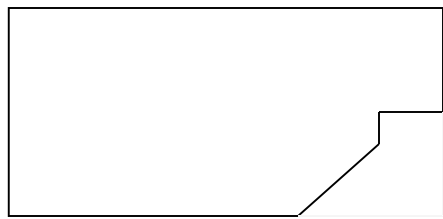
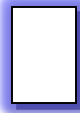

M & N
Constructed 1991
A#55231

Yucca Valley High School Site Plan

Drawn by Glenn R. Addis (n.t.s.)

Building L
Constructed 2014
A#04-110464

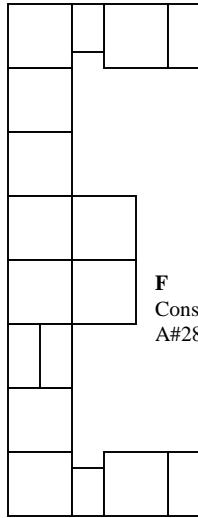

Building S
Constructed 1991
A#55231

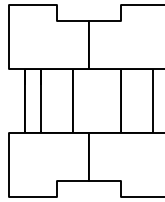

Building T
Constructed 1991
A#55231

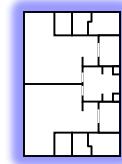
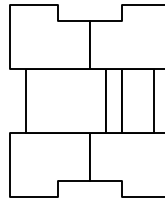

X
Constructed 2004
A#04-104224

LEGEND

 = Buildings Involved

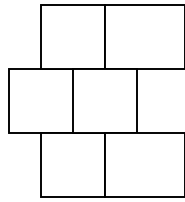

R
Constructed 1991
A#55231

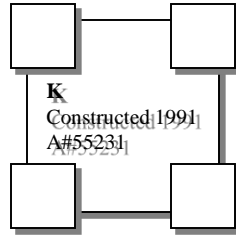

K
Constructed 1991
A#55231

Kitchen
Constructed 1991
A#55231



MPR /Kitch
Constructed 1964
A#25328

F
Constructed 1968
A#28773

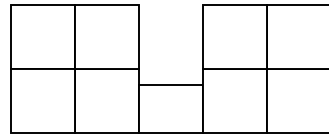

G
Constructed 1965
A#26598

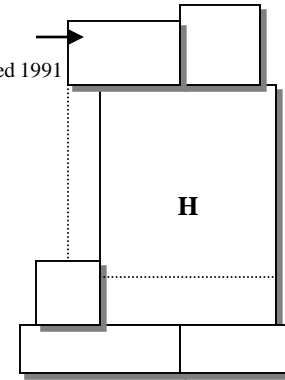

Performing Arts
Constructed 1968
A#28773

Pool A#22323

U
Constructed 1991
A#55231

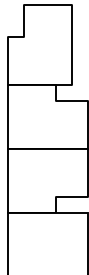

W
Constructed 1991 A#55231

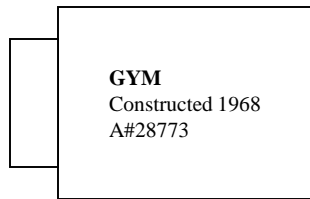

GYM
Constructed 1968
A#28773

C
Const 1961
A#21616
Mod 1968
A#28773

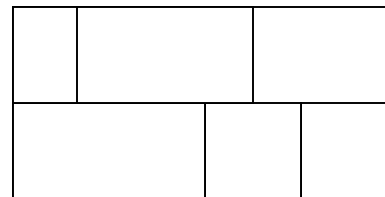

B
Constructed 1961
A#21616



A
Constructed 1991
A#55231

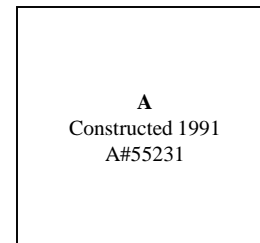

E
Const 1961
A#21616
Mod 1968
A#28773

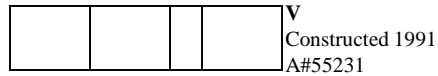

V
Constructed 1991
A#55231

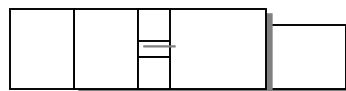

D Constructed 1968 A#28773

THE CAMPUSES OF THE MORONGO UNIFIED SCHOOL DISTRICT

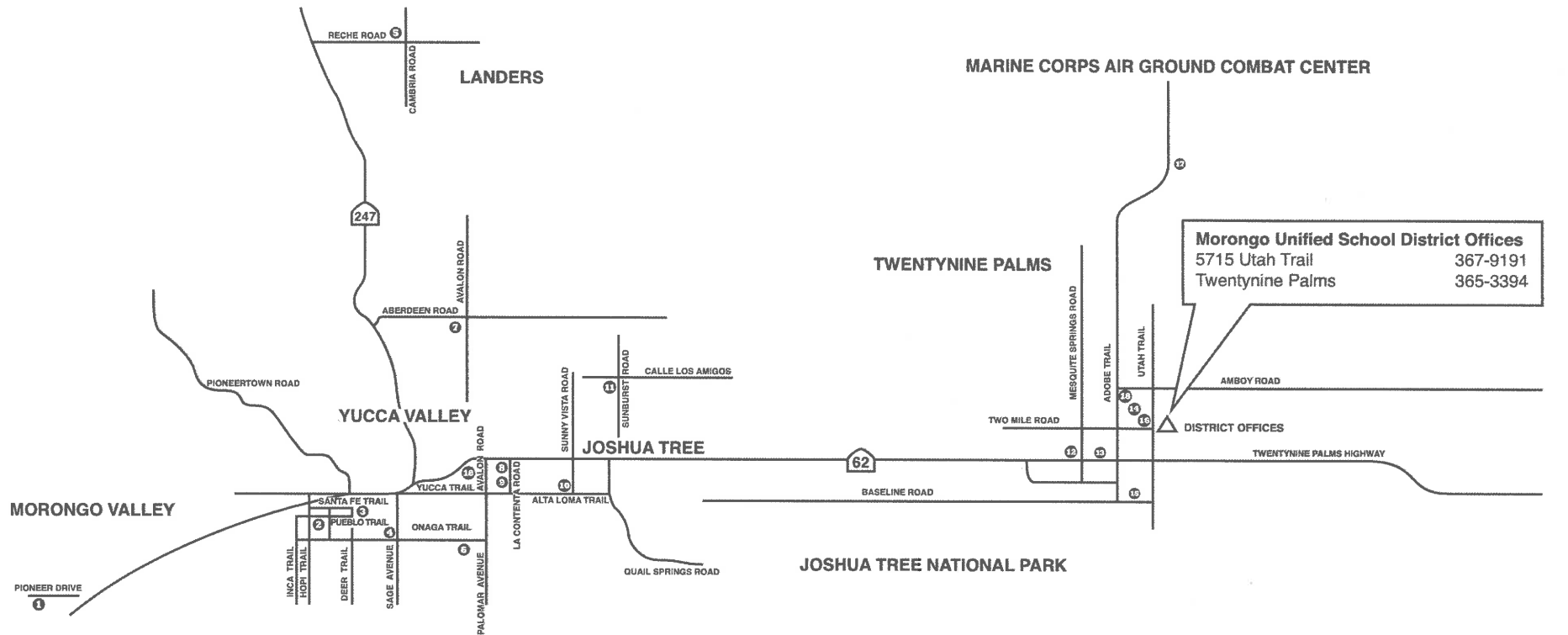

Morongo Unified School District Offices
 5715 Utah Trail 367-9191
 Twentynine Palms 365-3394

- | | | | |
|--|--|---|--|
| <p>1 Morongo Valley Elementary School
 10951 Hess Boulevard
 Morongo Valley
 Grades K-6
 363-6216</p> | <p>6 Onaga Elementary School
 58001 Onaga Trail
 Yucca Valley
 Grades K-6
 369-6333</p> | <p>11 Joshua Tree Elementary School
 4950 Sunburst Avenue
 Joshua Tree
 Grades K-6
 366-8459</p> | <p>16 Twentynine Palms Junior High School
 5798 Utah Trail
 Twentynine Palms
 Grades 7 and 8
 367-9507</p> |
| <p>2 Yucca Valley Elementary School
 7601 Hopi Trail
 Yucca Valley
 Grades K-6
 365-3381</p> | <p>7 Yucca Mesa Elementary School
 3380 Avalon Road
 Yucca Valley
 Grades K-6
 228-1777</p> | <p>12 Twentynine Palms High School
 72750 Wildcat Way
 Twentynine Palms
 Grades 9-12
 367-9591</p> | <p>17 Condor Elementary School
 2551 Condor Road
 Twentynine Palms
 Grades K-6
 367-0750</p> |
| <p>3 Yucca Valley Community School
 56020 Santa Fe Trail, Suite T
 Yucca Valley
 Grades 7-12 (County Program)
 228-1501/1132</p> | <p>8 Black Rock High School
 59273 Sunnyslope Drive
 Yucca Valley
 Continuation (Alternative) High
 369-6310</p> | <p>13 Oasis Elementary School
 73175 El Paseo Drive
 Twentynine Palms
 Grades K-6
 367-3595</p> | <p>18 Independent Continuing Education
 59269 Sunnyslope Drive
 Yucca Valley
 3455 Luckie Avenue
 Twentynine Palms
 363-6216
 367-3709</p> |
| <p>4 Yucca Valley High School
 7600 Sage Avenue
 Yucca Valley
 Grades 9-12
 365-3391</p> | <p>9 La Contenta Middle School
 7050 La Contenta Road
 Yucca Valley
 Grades 7-8
 228-1802</p> | <p>14 Twentynine Palms Elementary School
 74350 Playa Vista Drive
 Twentynine Palms
 Grades K-6
 367-3545</p> | |
| <p>5 Landers Elementary School
 56450 Reche Road
 Landers
 Grades K-6
 364-2382</p> | <p>10 Friendly Hills Elementary School
 7252 Sunny Vista Road
 Joshua Tree
 Grades K-6
 366-3812</p> | <p>15 Palm Vista Elementary School
 74350 Baseline Road
 Twentynine Palms
 Grades K-6
 367-7538</p> | |